

24

2410 06

USB and IEEE 1394 connectors



USB 2.0 chassis socket type A, angular version, for printed circuit boards, surface mounting technology (SMT)

24 2410 06

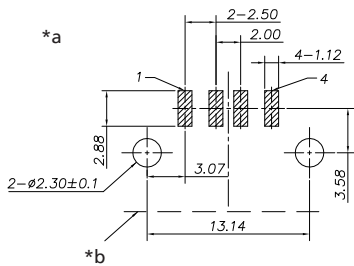
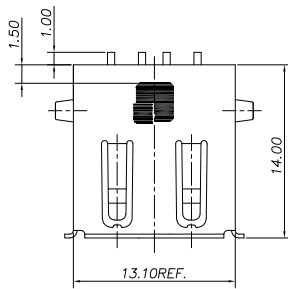
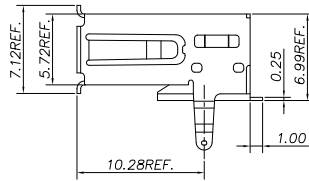
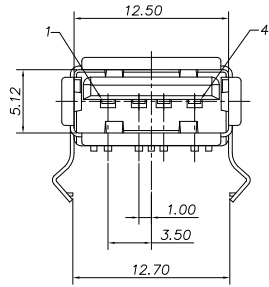

\*a printed circuit board layout, components side view  
\*b printed circuit board edge

### Environmental conditions

Temperature range x

### Materials

Insulating body LCP GF, V-0 according to UL94  
Contact spring Cu alloy, pre-nickel and gold-plated, tin-plated in solder area  
Housing Cu alloy, nickel-plated

### Mechanical data

Mating cycles 1500  
Insertion force  $\leq 35$  N  
Withdrawal force  $\geq 10$  N

### Electrical data (at $T_{amb}$ 20 °C)

Contact resistance  $\leq 30$  m $\Omega$   
Rated current 1 A  
Rated voltage 30 V AC  
Rated impulse voltage 750 V/60 s  
Insulation resistance  $\geq 1$  G $\Omega$

### Associated products

Counterparts  
 ☞ 2410 07      ☞ 2410 08      ☞ 2431  
 ☞ 2480      ☞ 2482

Accessories  
 ☞ 2412 01

24

2410 06

Designation	Pole Number	PU (Pieces)	MDQ (Pieces)
2410 06	4	150	600

**Packaging:**

in a tray