

16

1636 05

Power supply connectors



Power supply plug acc. to JEITA RC-5320A JSBP5, straight version, with solder eyes and bend protection

State: Active

16

1636 05

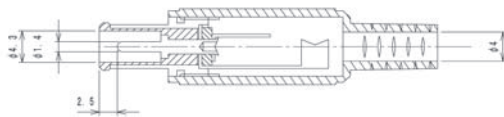
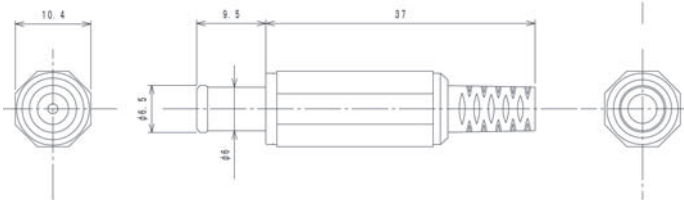

Environmental conditions

Temperature range -20 °C/+70 °C

Materials

Insulating body	PF, HB according to UL94
Contact	CuZn, nickel-plated
Lötkontakt	steel, pre-copper and nickel-plated
Insulation	POM, HB according to UL94
Housing	PE

Mechanical data

Outer diameter	6,5 mm
Inner diameter	4,3 mm
Diameter center pin	1,4 mm

Connectable conductors for solder area

Cable diameter 4 mm

Electrical data (at T_{amb} 20 °C)

Rated current	2 A
Rated voltage	18 V DC
Rated impulse voltage	500 V/60 s
Insulation resistance	≥ 100 MΩ

Associated products

Counterparts
 ↗ 1613 11 ↗ 1614 05

16

1636 05

Designation	Pole Number	PU (Pieces)	MDQ (Pieces)
1636 05	2	100	500

Packaging:

in bulk, in a cardboard box or a plastic bag