

16

1613 14

Power supply connectors



Power supply chassis socket, angular version, with break contacts, for printed circuit boards, surface mounting technology (SMT)

---

State: Active

---

16

1613 14

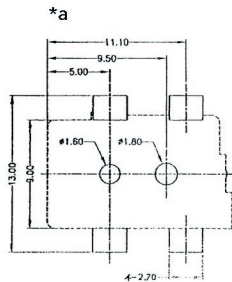
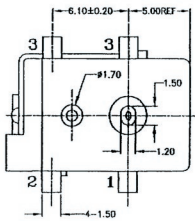
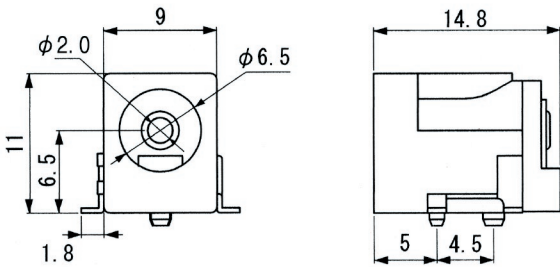

\*a printed circuit board layout, components side view

#### Environmental conditions

Temperature range -25 °C/+85 °C

#### Materials

Insulating body PA, V-0 according to UL94  
Contact CuZn/CuSn, silver-plated

#### Mechanical data







Diameter opening 6,5 mm  
Diameter center pin 2,0 mm  
Mating cycles  $\geq 5000$   
Insertion force 1,96–19,6 N<sup>1</sup>  
Withdrawal force 1,96–19,6 N<sup>1</sup>

<sup>1</sup> measured with a gauge plug

#### Electrical data (at T<sub>amb</sub> 20 °C)

Contact resistance  $\leq 30$  m $\Omega$   
Rated current 2,5 A  
Rated voltage 13,5 V DC  
Rated impulse voltage 500 V/60 s  
Insulation resistance  $\geq 100$  M $\Omega$

#### Associated products

Counterparts  
 1633 02       1633 03       NES/J 21  
 NES/J 21 W       NES/J 210       XNES/J 210

16

1613 14

Designation	Pole Number	PU (Pieces)	MDQ (Pieces)
1613 14 VP3	2	350	350

**Packaging:**

on reel