

開発中  
Under  
Development

## 新製品 MS621R

# New Reflowable MS-type Lithium Rechargeable Batteries リフロー対応MS系リチウム二次電池

Vol. 20190605

## 1. 特長・Features

- リフロー実装可能な高容量小形コイン二次電池  
High capacity small size coin battery that can be mounted by reflow soldering
- サイクル特性に優れる（当社製ML414H比較）  
Excellent cycle characteristics (Compared with our ML414H)

Type	Reflow	Maximum Charge Voltage	Standard Charge Voltage	Nominal Voltage	Nominal Capacity	Internal Impedance	Operating Temperature	Cycle Time		Size		weight
								100% D.O.D	20% D.O.D	Diameter	Height	
MS621R	OK	3.3 V	3.1 V	3 V	3mAh	400Ω	-20°C~+60°C	TBD	TBD	6.8mm	2.1mm	0.24g

Cycle Time is under measuring . サイクルは現在測定中

## 2. 特性・Characteristics

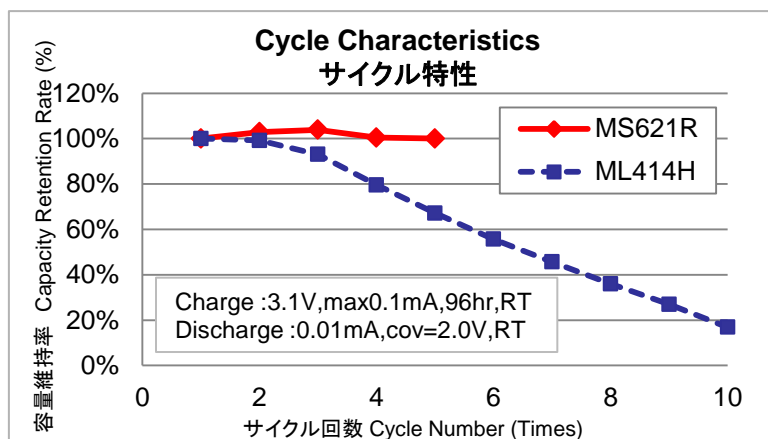

## 3. 端子形状・Tabs

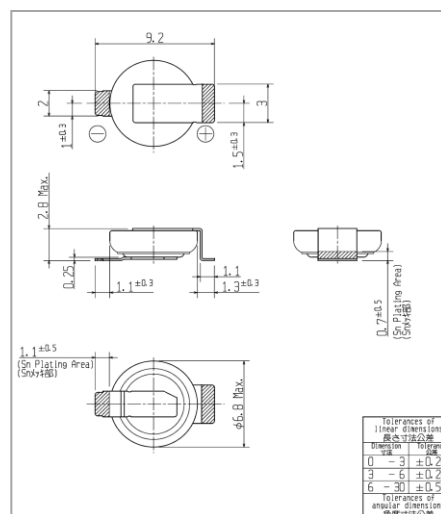

## 4. サンプル・量産時期・Schedule

- サンプル提供開始予定 2019年8月～ Sample distribution Aug., 2019
- 量産予定 2019年10月～ Mass production Oct., 2019

\*こちらに掲載の情報は予告なく変更することがございます。

Notice: All specifications in this leaflet are subject to change without notice.  
Prior to the purchase, please contact us.

開発中  
Under  
Development

## 新製品 MS421R

# New Reflowable MS-type Lithium Rechargeable Batteries リフロー対応MS系リチウム二次電池

Vol. 20190605

## 1. 特長・Features

- リフロー実装可能な高容量小形コイン二次電池  
High capacity small size coin battery that can be mounted by reflow soldering
- サイクル特性に優れる（当社製ML414H比較）  
Excellent cycle characteristics (Compared with our ML414H)

Type	Reflow	Maximum Charge Voltage	Standard Charge Voltage	Nominal Voltage	Nominal Capacity	Internal Impedance	Operating Temperature	Cycle Time		Size		weight
								100% D.O.D	20% D.O.D	Diameter	Height	
MS421R	OK	3.3 V	3.1 V	3 V	1.5 mAh	600Ω	-20℃~+60℃	TBD	TBD	4.8mm	2.1mm	0.1g

Cycle Time is under measuring . サイクルは現在測定中

## 2. 特性・Characteristics

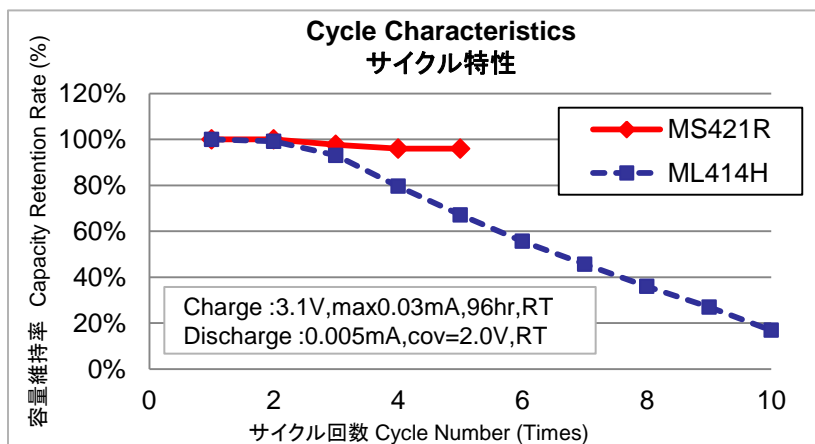

## 3. 端子形状・Tabs

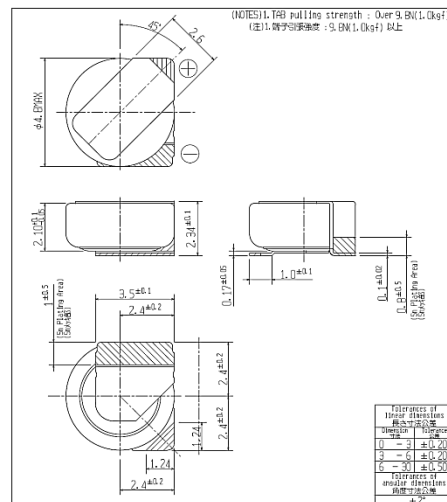

## 4. サンプル・量産時期・Schedule

- サンプル提供開始予定 2019年10月～ Sample distribution Oct., 2019
- 量産予定 2019年12月～ Mass production Dec., 2019

\*こちらに掲載の情報は予告なく変更することがございます。  
Notice: All specifications in this leaflet are subject to change without notice.  
Prior to the purchase, please contact us.