

IEC Appliance Connector C14 or C18, 70°C



C14



70° C

C18



70° C

**Description**

- Panel Mount, Screw-on from rear-side
- Inlet, Pin temperature 70 °C, protection class I or II
- For PCB mounting

Other versions on request

- Ground terminal with quick-connect terminal 6,3 x 0,8 mm
- With solder terminals

WeblinksApprovals: <http://www.schurter.com/approvals>RoHS: <http://www.schurter.com/rohs>**Technical Data**

Ratings IEC	10 A / 250 VAC; 50 Hz
Ratings UL/CSA	15 A / 250 VAC; 60 Hz
Dielectric Strength	> 3 kVAC between L-N > 3 kVAC between L/N-PE (1 min/50 Hz)
Allowable Operation Temp.	-25 °C to 70 °C
Degree of Protection	from front side IP 40 acc. to IEC 60529
Protection Class	Suitable for appliances with protection class I or II acc. to IEC 61140
Terminal	For PCB mounting ; Ground terminal: Quick connect terminals 4.8 x 0.8 mm angled or straight Solder terminal on request
Panel Thickness s	Screw-on: max 3 mm Mounting screw torque max 0.5 Nm
Material: Housing	Thermoplastic, black, UL 94V-0

Appliance-Inlet /-Outlet	C14/C18 acc. to IEC/EN 60320-1, UL 498, CSA C22.2 no. 42 (for cold condition) pin-temperature 70 °C, 10 A, Protection class I or II
--------------------------	--

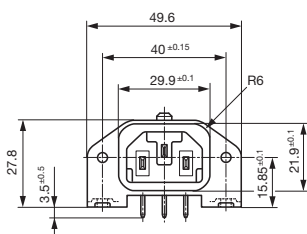
DimensionsLength  49.6 mm

without insulation cover

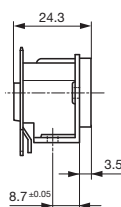

with insulation cover

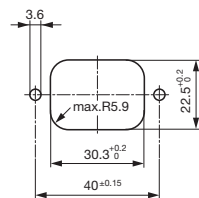
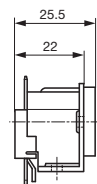

Ground terminal

Ground terminal

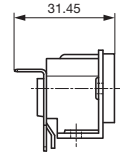
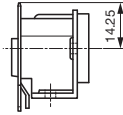
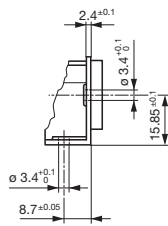

straight

angled

Drilling diagrams

PCB Layout

Ground terminal angled

PCB Layout

Ground terminal straight

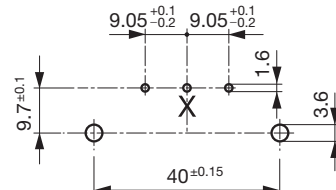
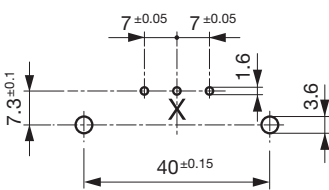

X deleted for protection class II

X deleted for protection class II

Variants

Protection Class	PCB terminal spacing	Mounting flange with	Ground terminal 4.8 x 0.8 mm	Cover	Order Number
I	7/7.3	holes for screws M3	angled to pin axis		GSP1.9103.1
I	7/7.3	holes for screws M3	angled to pin axis	●	GSP1.9113.1
I	7/7.3	holes for screws M3	straight		GSP1.9101.1
I	7/7.3	holes for self-tapping screws 3mm, 4 screws enclosed	angled to pin axis		GSP1.9503.1
I	7/7.3	pre-inserted nuts M3, 4 pcs.	angled to pin axis		GSP1.9203.1
I	9.05/9.7	holes for screws M3	angled to pin axis		GSP1.8101.1
I	9.05/9.7	holes for screws M3	straight		GSP1.8401.1
I	9.05/9.7	holes for screws M3	straight	●	GSP1.8111.1
I	9.05/9.7	holes for self-tapping screws 3mm, 4 screws enclosed	straight		GSP1.8501.1
I	9.05/9.7	pre-inserted nuts M3, 4 pcs.	straight		GSP1.8201.1
II	7/7.3	holes for screws M3	angled to pin axis		GSP1.9100.1
II	7/7.3	holes for screws M3	angled to pin axis	●	GSP1.9110.1
II	7/7.3	holes for self-tapping screws 3mm, 4 screws enclosed	angled to pin axis		GSP1.9500.1
II	7/7.3	pre-inserted nuts M3, 4 pcs.	angled to pin axis		GSP1.9200.1
II	9.05/9.7	holes for screws M3	straight		GSP1.8100.1
II	9.05/9.7	holes for screws M3	straight	●	GSP1.8110.1
II	9.05/9.7	holes for self-tapping screws 3mm, 4 screws enclosed	straight		GSP1.8500.1
II	9.05/9.7	pre-inserted nuts M3, 4 pcs.	straight		GSP1.8200.1

Packaging unit

50 Pcs