



TECHNICAL INFORMATION

Wireless Frequency:	2.4Ghz
Watts:	4.5
Equivalence Watts:	35
Color:	3IN1
Lumens:	300
Beam Angle:	110°
Dimmable:	Yes
Input Power:	AC:220-240V, 50Hz
Long Life:	30,000 Hours
Unit Color:	White
Body Type:	Plastic
Dimension:	50x55mm
PF:	>0.4
CRI:	>80
Operation Temperature:	-20°C to +45°C
LED Chip Type:	SMD



FEATURES

- Wi-Fi enabled smart lamp
- Easy to install and pair with the V-TAC Smart Light App
- 2.4Ghz Wi-Fi frequency
- Switch lights off, change colours, dim the lights and more using the V-TAC app
- Wireless standard: IEEE 802.11 b/g/n
- Can be controlled via V-TAC Smart Light app or Alexa and Google Home
- Suitable for residential, commercial, living rooms, bedrooms, hotels etc.
- Recommended daily usage: 10 - 12 hours *Exceeding recommended daily usage will void warranty

SPOTLIGHT SMART LIGHT

WiFi-supported home solutions to convert any device into a smart device, and ultimately convert any home into a smart home. Have a systematic, unified control on all your smart devices through the official V-TAC app, Amazon Alexa, and Google Home.

One brand, endless solutions..testing

SKU: 2750 - 1547 940

[View more details](#)

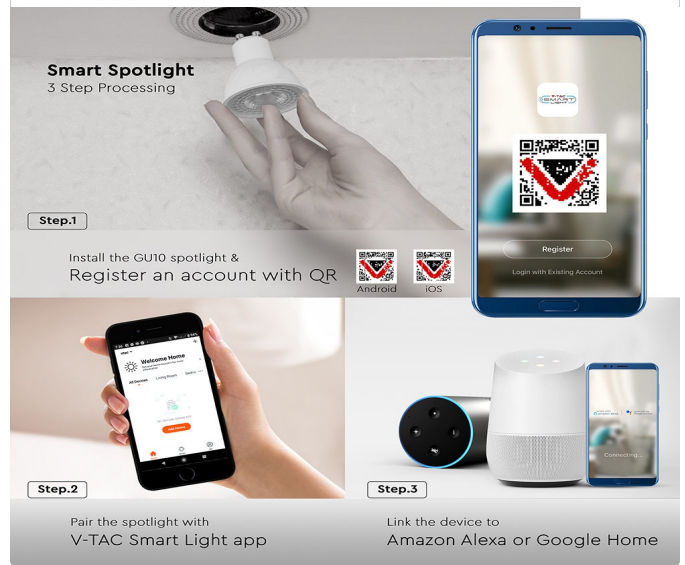

Smart Spotlight
3 Step Processing

Step.1

Install the GU10 spotlight &
Register an account with QR



Step.2

Pair the spotlight with
V-TAC Smart Light app

Step.3

Link the device to
Amazon Alexa or Google Home

PACKAGING

Gross Weight (Kgs): 0.044
Unit CBM: 0.000166375
Dimension: 50x55mm

MASTER BOX PACKAGING

Box Qty: 200
Qty Per Pallet: 7200
Length (Box) mm: 55
Width (Box) mm: 55
Height (Box) mm: 55

LISTING DETAILS

Commodity Code: 9405403990
EanCode: 3800157646550