

EAO – Your Expert Partner for Human Machine Interfaces

82-5151.1123.B002 - Illuminated pushbutton 19 mm stainless-steel Stand-By Symbol

82-5151.1123.B002 - Illuminated pushbutton 19 mm stainless-steel, momentary, Stand-By Symbol



Mounting

Mounting cut-out Design Ø 19 mm
flush

Front

Front dimension Ø 22 mm
Front shape round
Front ring shape flush
Front bezel material Stainless steel

Other Attributes

Operating voltage (LED) 12 V AC/DC
Weight 0,018 kg
Operation current (LED) 7 mA

Operating-/Indication part

Lens optics opaque
Lens material Stainless steel
Lens profile flat
Lens illumination illuminative
Lens colour Stainless steel

IP-Rating

Front protection IP65, IP67

Connection Method

Terminal Solder 2.8 x 0.5 mm

Actuator

Switching action Momentary

Switching element

Switching current 3 A
Contact material Silver
Contacts 1 C
Switching system Snap-action switching element
Switching voltage 240 V AC/DC

Illumination

Illumination Ring with blue LED

Function

Illuminated pushbutton

EAO – Your Expert Partner for Human Machine Interfaces

82-5151.1123.B002 □ Illuminated pushbutton 19 mm stainless-steel Stand-By Symbol

Dimensions

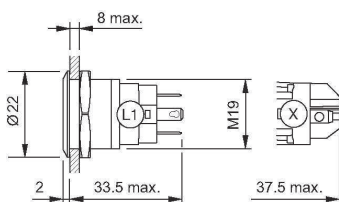

Mounting cut-outs

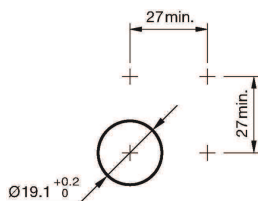

Wiring diagram

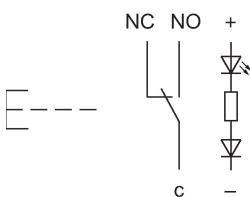

Component layout

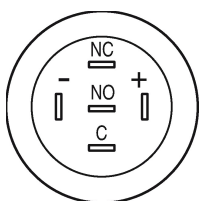

Legend

Switching action: B = Momentary

Contacts: C = Changeover