

Flush-type connector - SACC-DSI-M12FSL-4CON-M16XL/0,2 - 1425589

Please be informed that the data shown in this PDF Document is generated from our Online Catalog. Please find the complete data in the user's documentation. Our General Terms of Use for Downloads are valid (<http://phoenixcontact.com/download>)



Flush-type connector, Power, 4-position, Socket, M12, L - Power, Rear mounting, M16 x 1.5, Individual wires, cable length: 0.2 m, 2.50 mm², PEX litz wire

Your advantages

- ✓ For compact devices: transmit high power in a confined space
- ✓ Easy-to-install, optimized XL housing contour with wrench size 19
- ✓ Mechanical tightening limitation for long-term-stable gasket
- ✓ Pre-assembled with litz wires for immediate use
- ✓ Customer-specific assemblies and litz wire lengths available
- ✓ Sealed on the litz wire side for optimum leak-tightness
- ✓ For high transmission safety: shield connection to the housing with optional EMC nut



Key Commercial Data

| | |
|--------------------------------------|---------------------------------------------------------------------------------------------------------|
| Packing unit | 1 pc |
| GTIN |  4 055626 424385 |
| GTIN | 4055626424385 |
| Weight per Piece (excluding packing) | 40.000 g |
| Custom tariff number | 85444290 |
| Country of origin | Germany |

Technical data

Dimensions

| | |
|-----------------|-------|
| Length of cable | 0.2 m |
|-----------------|-------|

Ambient conditions

Flush-type connector - SACC-DSI-M12FSL-4CON-M16XL/0,2 - 1425589

Technical data

Ambient conditions

| | |
|---------------------------------|----------------------------------|
| Ambient temperature (operation) | -25 °C ... 85 °C (Plug / socket) |
| | -25 °C ... 85 °C (Plug / socket) |
| Degree of protection | IP67 |

General

| | |
|-----------------------------|----------------------------------------------------------------------------------------------------------------------------------------------------------------------------------------------------------------------------------------------------------------------------------------------------------------------------------------------------|
| Note | The electrical and mechanical data specified assume that the connector pair is correctly locked and mounted. If the connector is unlocked and if there is a danger of contamination, the connector must be sealed using a protective cap > IP54. Influences arising from litz wires, cables or PCB assembly must also be taken into consideration. |
| Rated current at 40°C | 16 A |
| Rated voltage | 63 V |
| Rated surge voltage | 1.5 kV |
| Number of positions | 4 |
| Coding | L - Power |
| Standards/regulations | M12 connector IEC 61076-2-111 In line with |
| Signal type/category | Power |
| Status display | No |
| Overvoltage category | III |
| Degree of pollution | 3 |
| Test voltage | 1.5 kV |
| Connection method | Individual wires |
| Insertion/withdrawal cycles | > 100 |
| Mounting type | Rear mounting M16 x 1.5 Tightening limitation |
| Assembly instructions | Tightening limitation |
| Thread type | M16 x 1.5 |
| Halogen-free | according to IEC 60754-1 |
| Flame resistance | in acc. with UL FT-2 |

Material

| | |
|----------------------------------------|------------------------------|
| Flammability rating according to UL 94 | V0 |
| Contact material | CuZn |
| Contact surface material | Au |
| Contact carrier material | PA |
| Material, knurls | Zinc die-cast, nickel-plated |
| Sealing material | FKM |
| Additional material specifications | PU 2K (Grout material) |

Cable

| | |
|------------|---------------|
| Cable type | PEX litz wire |
|------------|---------------|

Flush-type connector - SACC-DSI-M12FSL-4CON-M16XL/0,2 - 1425589

Technical data

Cable

| | |
|---------------------------------|--------------------------------------------------|
| Conductor cross section | 2.5 mm ² |
| AWG signal line | 14 |
| Wire colors | Brown 1, white 2, blue 3, black 4 |
| Material conductor insulation | PE-X |
| Conductor material | Tin-plated Cu litz wires |
| Standards/specifications | M12 connector IEC 61076-2-111 In line with |
| Ambient temperature (operation) | -40 °C ... 85 °C (without mechanical actuation) |
| | -40 °C ... 105 °C (cable, fixed installation) |
| | -25 °C ... 105 °C (cable, flexible installation) |

Standards and Regulations

| | |
|----------------------------------------|--------------------------------------------|
| Standards/specifications | M12 connector IEC 61076-2-111 In line with |
| Flame resistance | in acc. with UL FT-2 |
| Halogen-free | according to IEC 60754-1 |
| Flammability rating according to UL 94 | V0 |

Environmental Product Compliance

| | |
|------------|-----------------------------------------------------------------------------------------------------|
| REACH SVHC | Lead 7439-92-1 |
| China RoHS | Environmentally Friendly Use Period = 50 years |
| | For details about hazardous substances go to tab "Downloads", Category "Manufacturer's declaration" |

Drawings

Dimensional drawing

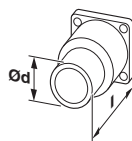

Schematic diagram

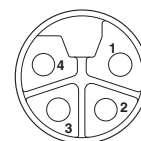

Technical drawings can be found under Downloads

Pin assignment of M12 socket, 4-pos., L-coded, socket side view

Classifications

eCl@ss

| | |
|---------------|----------|
| eCl@ss 10.0.1 | 27440102 |
| eCl@ss 11.0 | 27440102 |
| eCl@ss 5.1 | 27143423 |
| eCl@ss 6.0 | 27143423 |
| eCl@ss 8.0 | 27440102 |

Flush-type connector - SACC-DSI-M12FSL-4CON-M16XL/0,2 - 1425589

Classifications

eCl@ss

| | |
|------------|----------|
| eCl@ss 9.0 | 27440102 |
|------------|----------|

Approvals

Approvals

Approvals

EAC / cULus Recognized

Ex Approvals

Approval details

| | | |
|-----|--|---------|
| EAC | | B.01687 |
|-----|--|---------|

| | | | |
|------------------|--|-------------------------------------------------------------------------------------------------------------------------------------------------------|------------------|
| cULus Recognized | | http://database.ul.com/cgi-bin/XYV/template/LISEXT/1FRAME/index.htm | E468743-20180113 |
|------------------|--|-------------------------------------------------------------------------------------------------------------------------------------------------------|------------------|

| | |
|----------------------------|------|
| Nominal voltage UN | 63 V |
| Nominal current IN | 16 A |
| mm ² /AWG/kcmil | 14 |

Accessories

Accessories

Screw plug - PROT M12 MS PWR - 1092802



An M12 screw plug for the unoccupied M12 females of the M12 POWER connectors, boxes, and flush-type connectors

