

# Series 80 Mighty Mouse Contacts and Tools

## Size #23 Non-Removable Crimp Contacts



### Size #23 crimp contacts for AWG #20 wire (Non-Removable)

Standard size #23 contacts accept #22 to #28 AWG wire. Choose "large bore" versions for #20 to #22 AWG wire. Contacts are bulk packaged. Terminate with standard M22520 crimper with special positioner. **Note contacts are installed with standard size #23 insertion tools.**

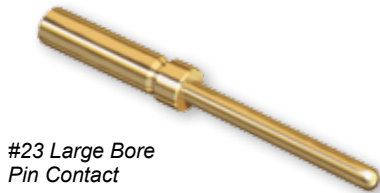

#23 Large Bore  
Pin Contact



#23 Small Bore  
Socket Contact

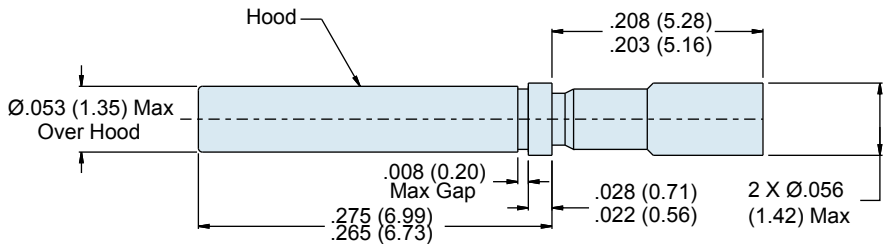
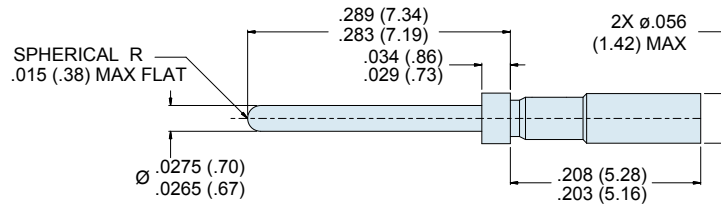

#### NOTES

##### Material and Finish

- Contact: beryllium copper alloy per ASTM B 196 or ASTM B 197, 50 microinches gold plated per ASTM B488 Type II Code C Class 1.25 over nickel underplate
- Socket contact hood: stainless steel, passivated per AMS-QQ-P-35.

##### Specifications

- Current Rating: 5 Amps maximum
- Voltage Drop (at 5 Amps and 25° C): 70 millivolts maximum
- Temperature Range: -65° to + 175° C
- Socket Contact Minimum Separation Force: 0.5 ounces

##### Crimp Tools and Insertion/Removal Tools

- Crimper: M22520/2-01 Pin/Socket
- Positioner: 809-301 (large bore).

Size #23 Non-Removable Crimp Contacts					
Contact Type	Wire Size	Material	Part Number	Color Band	Tool Code
Pin	#23 - #20	BeCu	809-299	None	A, S
Socket	#23 - #20	BeCu	809-300	None	A, S

Crimp Tensile Strength (Values are in pounds and are minimums.)	
Wire Gage	Axial Load
#20	20
#22	12

Dimensions in Inches (millimeters) are subject to change without notice.