

PRODUCT DATA SHEET

Part Number : **1110**

Type	Size	Rating	Description
Incandescent	T5	24V 30mA	T-1½ Wedge Base lamp

Dimensions(mm):

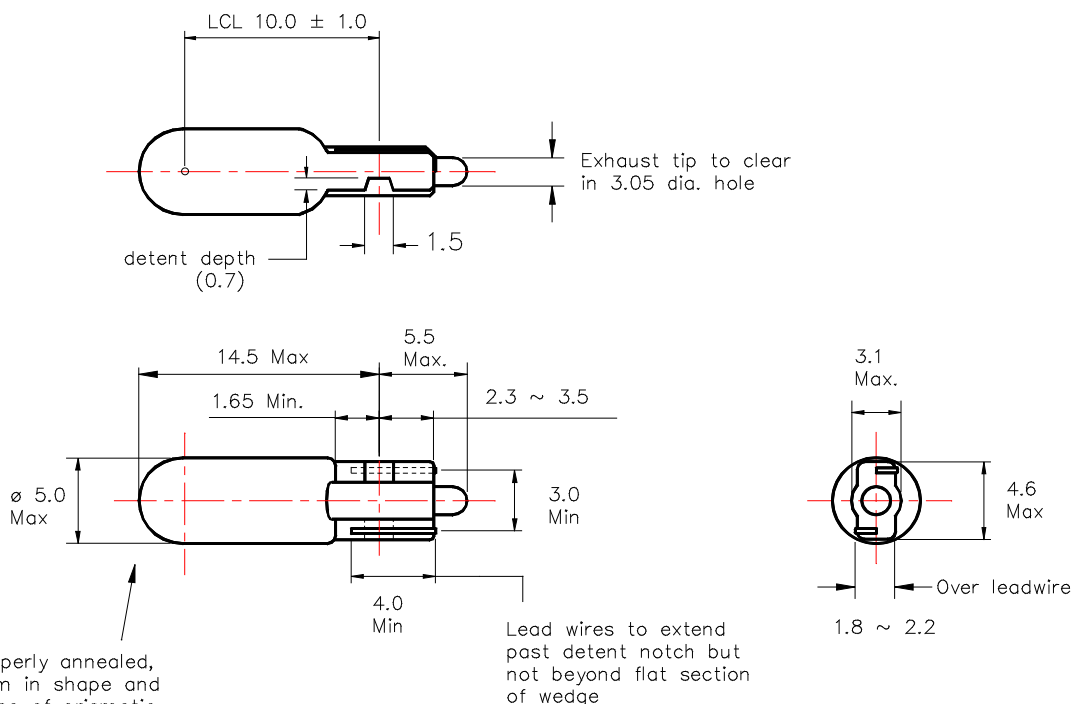

Clear glass properly annealed, shall be uniform in shape and substantially free of prismatic action.

TEST VOLTS	CURRENT (mA)			LIGHT OUTPUT (Lm)			LIFE Hours
	Min.	Nom.	Max.	Min.	Nom.	Max.	
24	27	30	33	0.95	1.25	1.55	5000

Notes:

- 1 W2x4.6d in accordance with IEC 61-1, (BS EN 60061-1), sheet 7004-94-x.
- 2 C-2F filament shape
- 3 Bead colour: White or Clear
- 4 RoHS and REACH SVHC compliant
- 5 Lamp marking CML 24V 30mA

Issue # 1 : 16Dec15