

Part Number: 379

| Type | Size | Rating | Description |
|--------------|------|------------|--|
| Incandescent | T6 | 6.3V 200mA | T-1 ³ / ₄ Midget Groove Lamp |

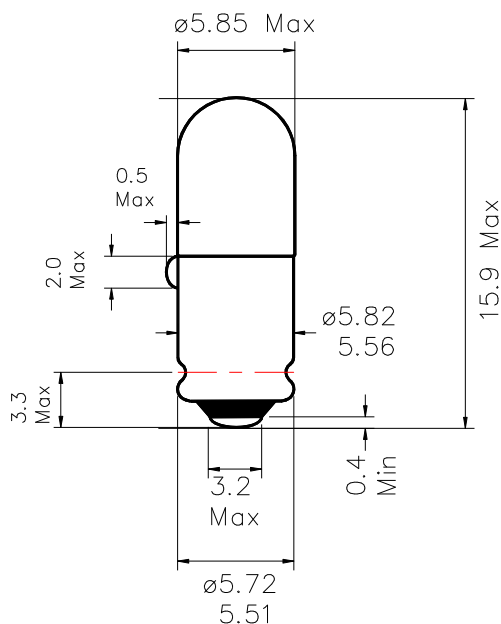

Dimensions in millimetres

| TEST VOLTS | CURRENT (mA) | | | LIGHT OUTPUT (Lm) | | | LIFE Hours |
|------------|--------------|------|------|-------------------|------|------|------------|
| | Min. | Nom. | Max. | Min. | Nom. | Max. | |
| 6.3 | 180 | 200 | 220 | 3.8 | 5.0 | 6.2 | 20,000 |

Notes:

- 1 **Base Type** Nickel plated S5.7s
- 2 **Filament Shape** C-2F
- 3 **Lamp Marking** CML 379 6.3V 200mA or 6.3V 200mA
- 4 **Environmental** RoHS & REACH SVHC compliant