

Bimetal Cutouts, Temperature Regulators Temperature Limiters R22 R32 R40

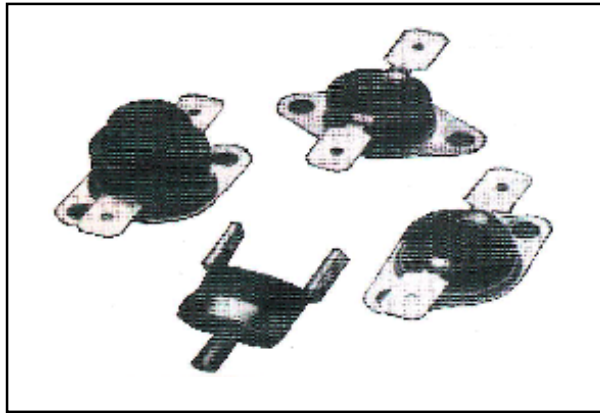

DESCRIPTION

Types R22/R40 are **bimetal detectors** and **temperature regulators**.

Types R32 are **temperature limiters** (manual reset) without trip free mechanism.

The thermal response works via a bimetal snap element electrically connected to the switch contact.

The switch system is **current insensitive**.

The thermal switches react only to external thermal effects. Double contacts ensure high switch performance and long service life.

The housing, base and the mounting brackets are voltage-free (Standard version: base and mounting brackets are aluminium-plated steel).

Heat transfer occurs directly through the metallic base via connection, radiation and conduction in gaseous and solid media.

DIMENSIONS

R22/R40

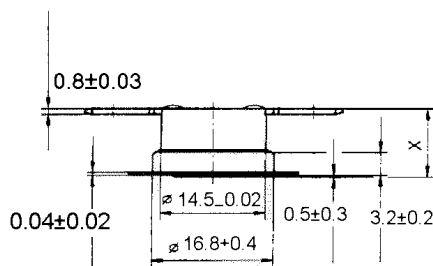

R32

