



## JOINTS

### GEL CONNECTION

Micro-joints IP68/IP69K



**Electrical performance:**  
CEI EN 50393  
as applicable

**Gel:** UL 94-HB

Operating temperature

Installation temperature:   
-40°C / +50°C

Fully submersible

Can be used underground

**IP69K** OFFICIALLY TESTED **IP68** OFFICIALLY TESTED **IMQ**

## LV

# Little Joint Line



The IP68 / IP69K micro-joints, gel pre-filled, complete with connector, suitable for any type of installation, even the most extreme.

Extremely compact and space-saving, pre-filled with soft, highly conformable gel. With minimal aesthetic impact and visually pleasing. Equipped with integrated cable glands for IP68 and IP69K degree of ingress protection and cable retention.

- Pre-filled with classified non-toxic gel
- Extremely compact and ready to install
- Ideal for connections in lighting systems for gardens, steps and stairways, pedestrian crossings, etc.
- Halogen Free & UV resistant
- Always re-enterable



**IP68:** (6) protected against dust and solid objects over 1 mm.  
(8) Protected from permanent immersion in water.  
**IP69K:** (9K) protected against close-range high pressure, high temperature spray downs.

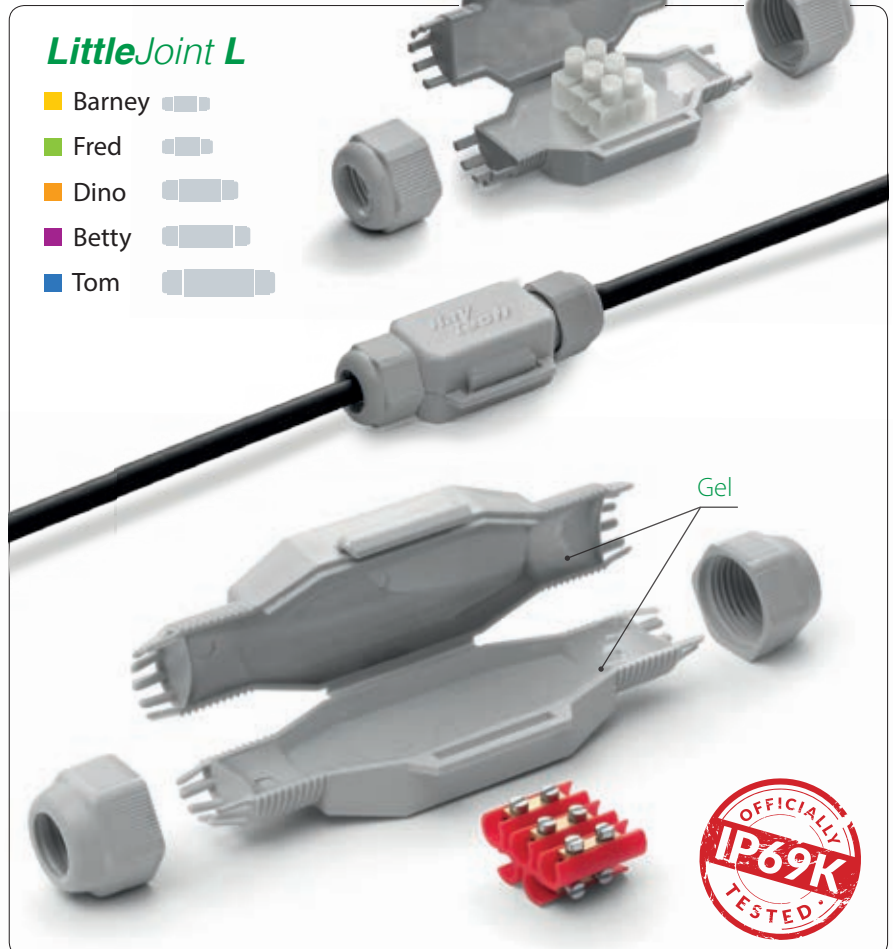

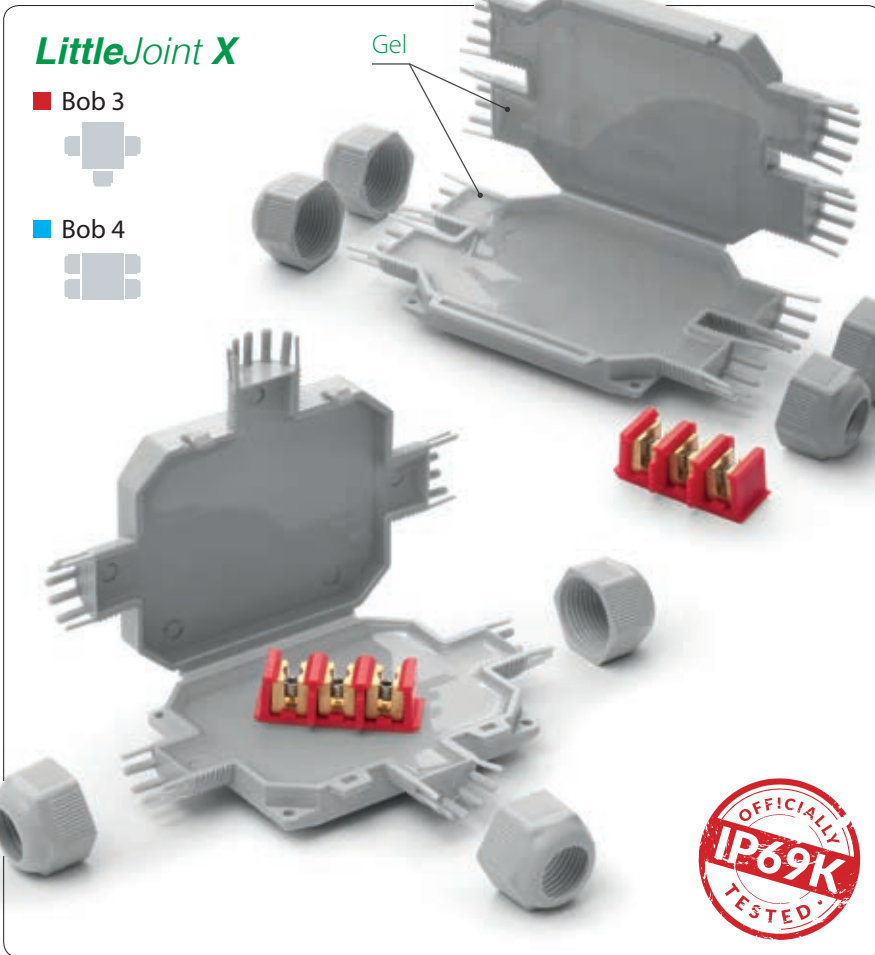
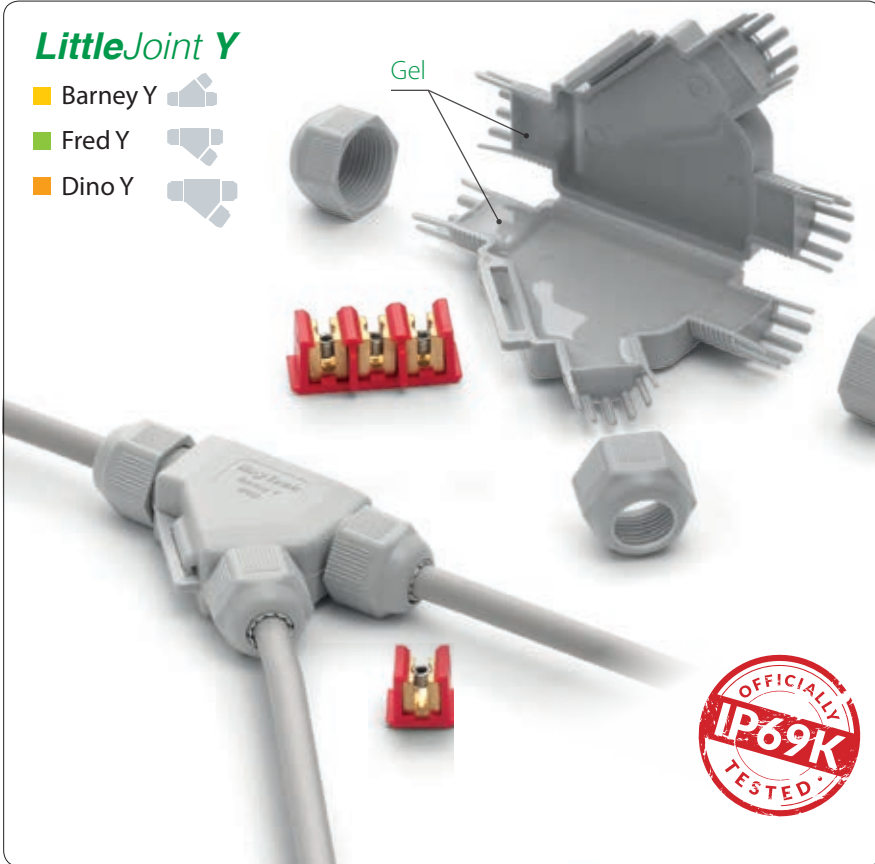



# JOINTS

## GEL CONNECTION

Micro-joints IP68/IP69K

### LV



#### LittleJoint L

Product	Colour	Connector	Cable formation max (N° x mm²)		Ø cables min - max (mm)	Pieces / Pack	A x B x C (mm)
			Through	Branch			
Barney	●		2 x 2,5	6 - 10	1 / Blister	75 x 28 x 19	
Barney - N	●				1 / Blister		
Barney MP	●				10 / Multipack		
Fred	●		3 x 2,5	8 - 13	1 / Blister	80 x 36 x 23	
Fred - N	●				1 / Blister		
Fred MP	●				10 / Multipack		
Fred/4	●		3 x 4	8 - 13	1 / Blister	80 x 36 x 23	
Fred/4 - N	●				1 / Blister		
Dino	●		4 x 4	10 - 16	1 / Blister	125 x 43 x 35	
Dino - N	●				1 / Blister		
Betty/4	●		5 x 4	10 - 16	1 / Blister	145 x 46 x 35	
Betty/4 - N	●				1 / Blister		
Betty/6	●		5 x 6	14 - 19	1 / Blister	145 x 46 x 35	
Betty/6 - N	●				1 / Blister		
Tom	●		5 x 16	19 - 23	1 / Blister	180 x 53 x 42	
Tom-N	●				1 / Blister		

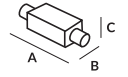

#### LittleJoint Y

Product	Colour	Connector	Cable formation max (N° x mm²)		Ø cables min - max (mm)	Pieces / Pack	A x B x C (mm)
			Through	Branch			
Barney Y	●		1 x 4 1 x 2,5	1 x 1,5 1 x 2,5	6 - 10	1 / Blister	85 x 55 x 22
Barney Y - N	●				1 / Blister		
Fred Y	●		3 x 4 3 x 2,5	3 x 1,5 3 x 2,5	8 - 13	1 / Blister	110 x 72 x 25
Fred Y - N	●				1 / Blister		
Dino Y	●		5 x 6 5 x 4 *	5 x 1,5 5 x 2,5 *	14 - 19	1 / Blister	160 x 75 x 37
Dino Y - N	●				1 / Blister		



\* section for rigid cables

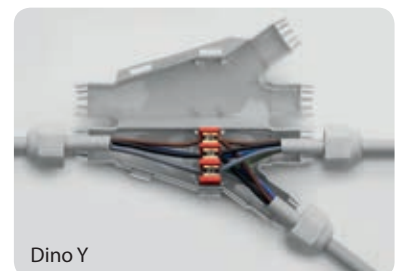



**LittleJoint X**

Product	Colour	Connector	Cable formation max (N° x mm <sup>2</sup> )		Ø cables min - max (mm)	Pieces / Pack	A x B x C (mm)
			Through	Branch			
Bob 3	●		1 cable 3 x 4	2 cables 3 x 4	8 - 13	1 / Blister	105 x 80 x 25
Bob 3 - N	●		3 x 2,5	2 cables 3 x 2,5			
Bob 4	●		1 cable 3 x 4	2 cables 3 x 4	8 - 13	1 / Blister	105 x 65 x 25
Bob 4 - N	●		3 x 2,5	3 cables 3 x 2,5			

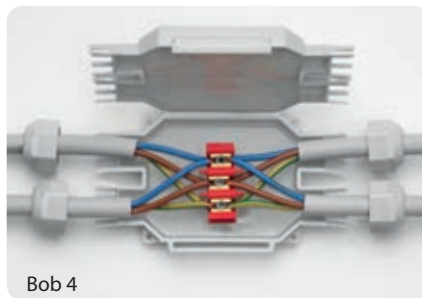
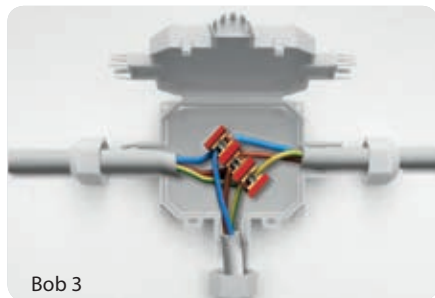
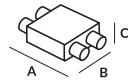

Some installation possibilities for **Bob 4**

Parallel branch system with 3 three-core cables up to 3 x 4 mm<sup>2</sup>

Parallel branch system with 4 three-core cables up to 3 x 2.5 mm<sup>2</sup>

---

Parallel 5-lamp connection system

---

**Can be installed with Mammut type connector (not included)**

3-LED spotlight in-series system

3-LED RGB spotlight parallel system with four-core cables



For use in traps. The ideal accessory for branch connections from a through cable to light fittings and spotlights. Suitable in applications where there is presence of water and moisture.

