

**nominal voltage:** 1,2V  
**max. charge voltage:** 1,5V

conditions

at standard charge  
 (0,1C / 20°C)

**capacity**  
 nominal : 350mAh  
 typical: 320mAh  
 400mAh

discharge at 0,2C  
 discharge at 1C  
 discharge at 0,2C  
 1,0V end discharge voltage  
 ambient temperature 20°C

**max. discharge current:** 1050mA

ambient temperature  
 20....50°C

**charge**  
 standard charge: 35mA  
 quick charge: 175mA  
 fast charge: 350mA

charge current charge time  
 15hrs at 20°C  
 2,5hrs for empty battery  
 1,25hrs for empty battery

recommended charge termination control parameters:  
 -dV: 10mV  
 dT/dt: 0,8....1°C per min  
 TCO: 45....50°C

trickle charge current: 5....20mA (recommended)

continuous overcharge: <35mA no conspicuous deformation, no leakage

**internal resistance:** <60mOhms at 1000Hz, battery fully charged

**life expectancy:** 500 cycles IEC standard

**ambient temperature range:** 0....45°C standard charge  
 10....45°C fast charge  
 -20....50°C discharge  
 -20....35°C storage

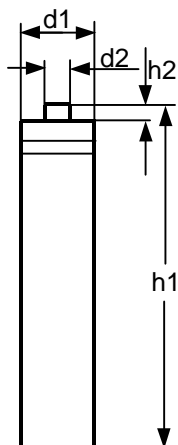
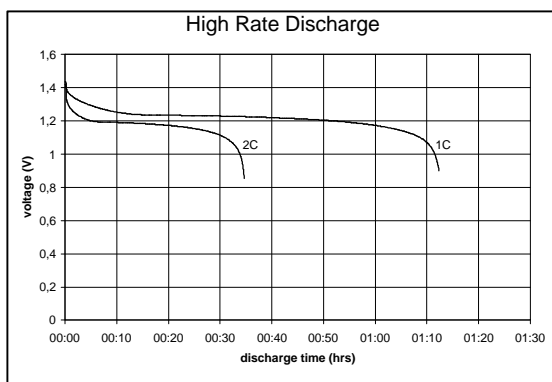
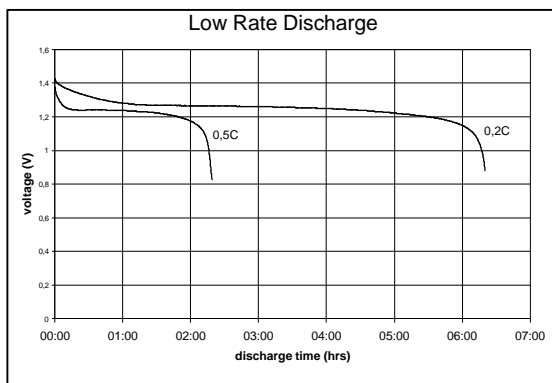
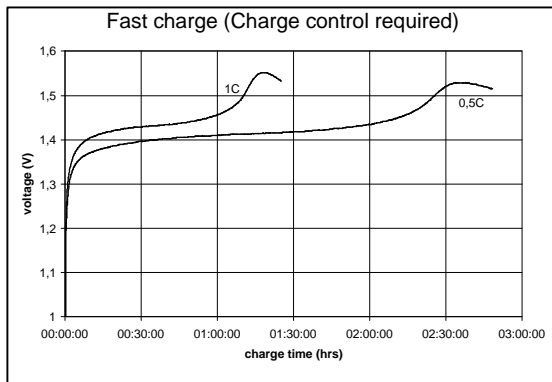
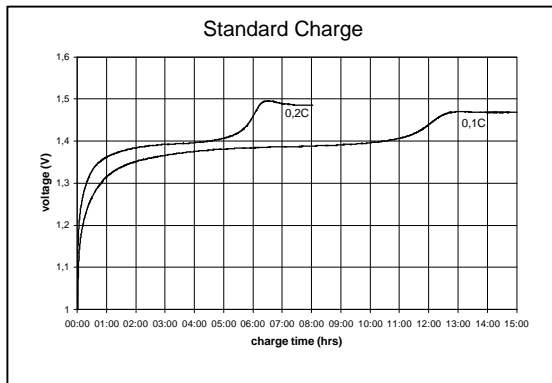

**mechanical specifications**

cell dimensions (with sleeve)  
 diameter d1: 10+/-0,2mm  
 diameter d2: 3,3+/-0,1mm  
 height h1: 44+/-0,3mm  
 height h2: 2+/-0,2mm  
 weight: approx. 11g

	specifications for model/type:	AAA – NiCd 350mAh
	Ansmann drawing number / part number:	5003011
	drawn by / date:	Gramlich / 16.10.2002