

**NEW**



microSD™ Memory Card Connector

CONNECTOR

MB-0142-2

June 2006

## ST2 Series

**RoHS Compliant**

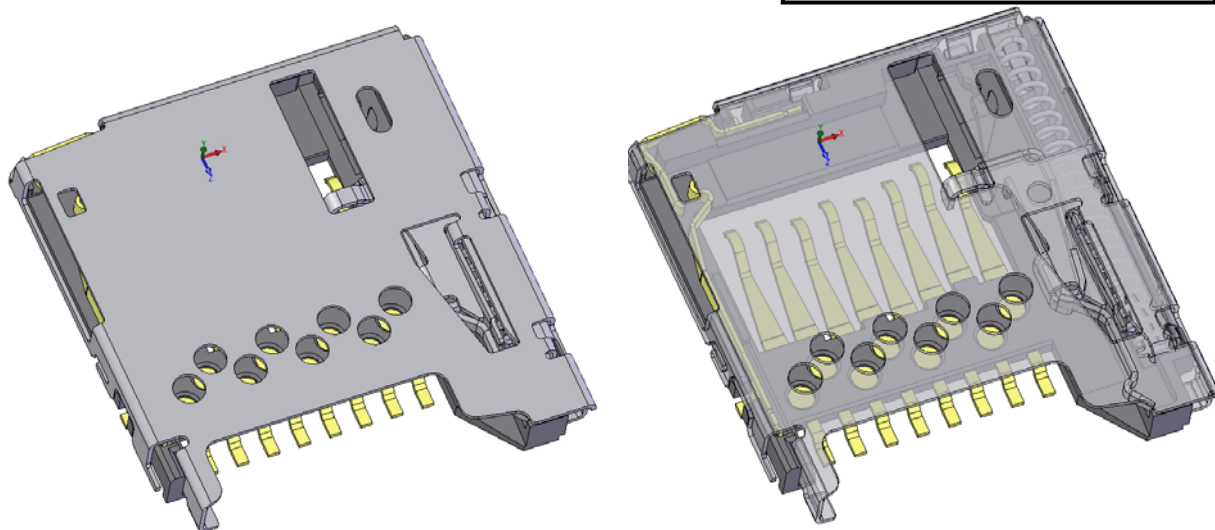

### < Outline >

The ST2 Series are one-piece type external connectors for microSD™ card.

High density SMT mounting type low profile connector compatible with microSD™ cards, standardized by SDA™ (SD Card Association) as a compact card for various portable devices.

\* microSD™ is a trademark of SD Card Association. z

### Features

- Push-push type connector for microSD™ memory cards with 1mm push stroke and 3.3mm card eject length.
- Shield characteristic is secured by the 4 ground connection points.
- Compact slim design with 1.7mm height, 15.5mm depth and 14.5mm width (depth including card: 17.5mm)
- Pb-free products (RoHS directive)
- Card insertion detection structure (D-SW)
- Ensured ejection of card with metallic eject bar

### General Specifications

- |  |   |
|--|---|
| ■ No. of contacts : 8 pos.+2pos. (D-SW)                        | ■ Rated current: 0.5A/ per pin          |
| ■ Contact resistance: 100m ohm max.                            | ■ Rated voltage: 10V/ per pin           |
| ■ Dielectric withstanding voltage :<br>AC500Vr.m.s. per minute | ■ Insulation resistance: 1000M ohm min. |
| ■ Operating temperature:<br>-25 Deg. C to +85 Deg. C           | ■ Lifetime: 10,000 times                |
| ■ Storage temperature:<br>-10 Deg. C to +60 Deg. C             | ■ Temperature rise: 30 Deg. C max.      |

Materials and Finishes

| Components   | Materials /Finishes   |
|--------------|---|
| Contact      | Copper Alloy/<br>Contact: 0.1um min. Au plating over Ni<br>Terminal: Au flash plating over Ni |
| Housing      | Synthetic resin/ No (UL 94V-0)  |
| Cover        | Stainless steel/ none   |
| Eject bar    | Stainless steel/ none   |
| Spring       | Piano wire/ Ni plating  |
| D-SW contact | Plating: Compliant to finish of signal contact  |

Ordering Information

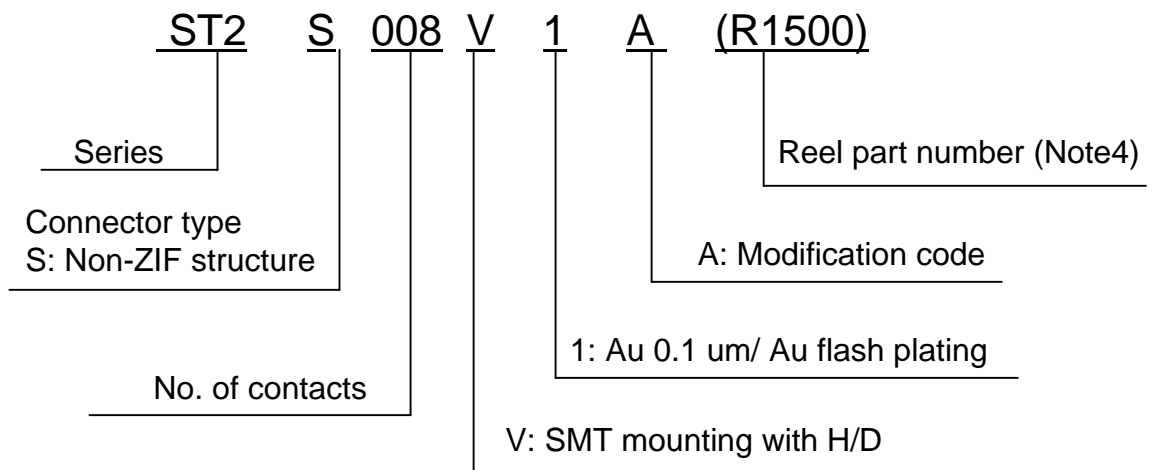



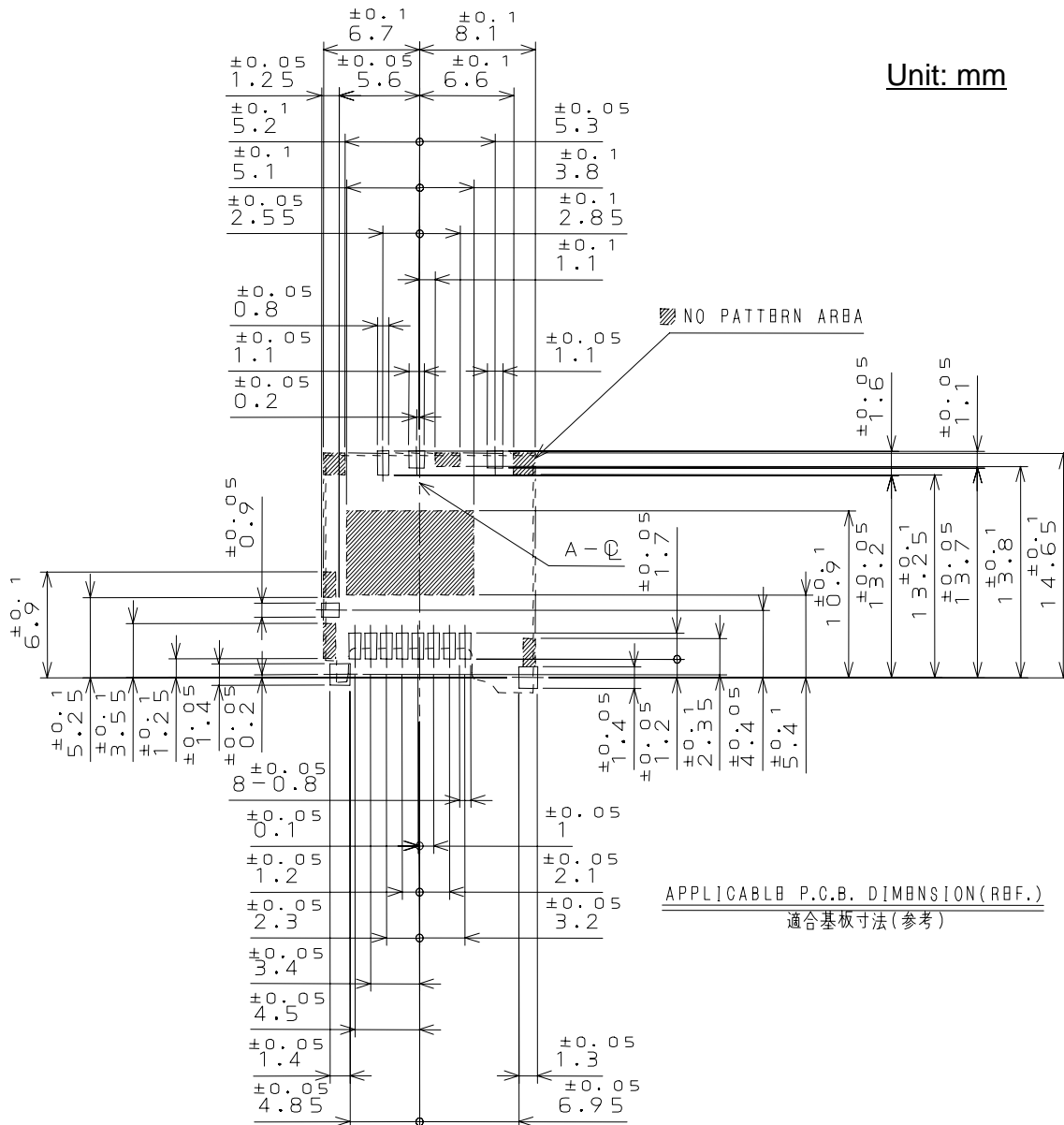

Note1) Vacuum area.

Note2) Including cover testing frame testing holes.

Cover frame testing holes tolerance: +9.15, -9.15

Note3) Detection switch circuit: Table 1

Note4) An embossed tape reel contains 1500 pcs.

Please contact us for details on embossed tape specifications.

**Notice:** Products shown in this leaflet are made for the applications listed below. However, if the above-mentioned products are to be used in aerospace devices, marine cable-connection devices, atomic power control systems, medical equipment for life-support systems, or any other specific application requiring extremely high reliability, please contact JAE for further information.  
Recommended applications: computers, office machines, measuring devices, telecommunication devices (terminals, mobile devices), AV devices, household applications, FA devices, etc.

## Japan Aviation Electronics Industry, Limited

Product Marketing Division  
Aobadai Building, 3-1-19, Aobadai, Meguro-ku, Tokyo 153-8539  
Phone: +81-3-3780-2787 FAX: +81-3-3780-2946