

# PULSE

## Portable PA System

**Model: TREKKER 8BT**



**INFORMATION ON WASTE DISPOSAL FOR CONSUMERS OF ELECTRICAL & ELECTRONIC EQUIPMENT.**

When this product has reached the end of its life it must be treated as Waste Electrical & Electronic Equipment (WEEE). Any WEEE marked products must not be mixed with general household waste, but kept separate for the treatment, recovery and recycling of the materials used. Contact your local authority for details of recycling schemes in your area.

Made in China.  
PO Box 13362 Dublin 2  
PR2 9PP

[www.pulse-audio.co.uk](http://www.pulse-audio.co.uk)

## 1. IMPORTANT SAFETY INSTRUCTIONS



**CAUTION:** To reduce the risk of electric shock, do not remove the top cover (or the rear section). No user serviceable parts inside; refer servicing to qualified personnel.

**WARNING:** To reduce the risk of fire or electric shock, do not expose this appliance to rain and moisture.



This symbol, wherever it appears, alerts you to the presence of uninsulated dangerous voltage inside the enclosure—voltage that may be sufficient to constitute a risk of shock.



This symbol, wherever it appears, alerts you to important operating and maintenance instructions in the accompanying literature. Please read the manual.

## 2. DETAILED SAFETY INSTRUCTIONS:

- (1) Read these instructions.
- (2) Keep these instructions.
- (3) Heed all warnings.
- (4) Follow all instructions.
- (5) Do not use this device near water.
- (6) Clean only with a dry cloth.
- (7) Do not block any ventilation openings. Install in accordance with the manufacturer's instructions.
- (8) Do not install near any heat sources such as radiators, heat registers, stoves, or other apparatus (including amplifiers) that produce heat.
- (9) Do not defeat the safety purpose of the polarized or grounding-type plug. A polarized plug has two blades with one wider than the other. A grounding type plug has two blades and a third grounding prong. The wide blade or the third prong are provided for your safety. If the provided plug does not fit into your outlet, consult an electrician for replacement of the obsolete outlet.

## 6. IMPORTANT NOTE

Use this troubleshooting guide if: **The sound is distorted at high volumes.**

**Input is clipping:** Try lowering the input gain or the volume control on your sound source or music instrument.

**Output is clipping:** Lower the main volume level.

**There is too much bass:** Try adjusting the tone or EQ control on your sound source to lower bass level. This will allow you to play the music louder before clipping (distortion) occurs.

**The link cable:** is being plugged into the instrument or MIC input instead of the RCA line input.

## 7. SPECIFICATIONS

Output power: . . . . . 20Wrms, 40Wmax

Speaker: . . . . . 2-way system

Frequency range: . . . . . 70-20000Hz  
inputs

(input sensitivity,connection)

MIC IN: . . . . . 6mV,  
6.3mm jack/XLR

CD/TAPE IN: . . . . . 600mV,RCA

Output LINK

output level: . . . . . 380mV  
connection: . . . . . 6.3mm jack

Equalizer

BASS: . . . . .  $\pm 15$ dB at 100Hz

MIDDLE: . . . . .  $\pm 15$ dB at 2.5kHz

TREBLE: . . . . .  $\pm 15$ dB at 10kHz

Power supply

mains operation: . . . . . 230V~/50Hz

power consumption: . max.60VA

battery operation: . . . . . approx.6hours  
at max.volume

battery type: . . . . . rechargeable lead  
gel battery,  
12V~/7.2Ah

Ambient temperature: . . . 0-40 °C

Dimensions(W x H x D): 410 x 470 x 310 mm

Weight: . . . . . 17.2kg

Subject to technical modification.

## 5. CONNECTION EXAMPLES

**Important:** with all large speakers, an initial “break-in” period is needed to perform at optimal levels. To properly “break-in” your system, play an audio source at medium volume for a few hours.

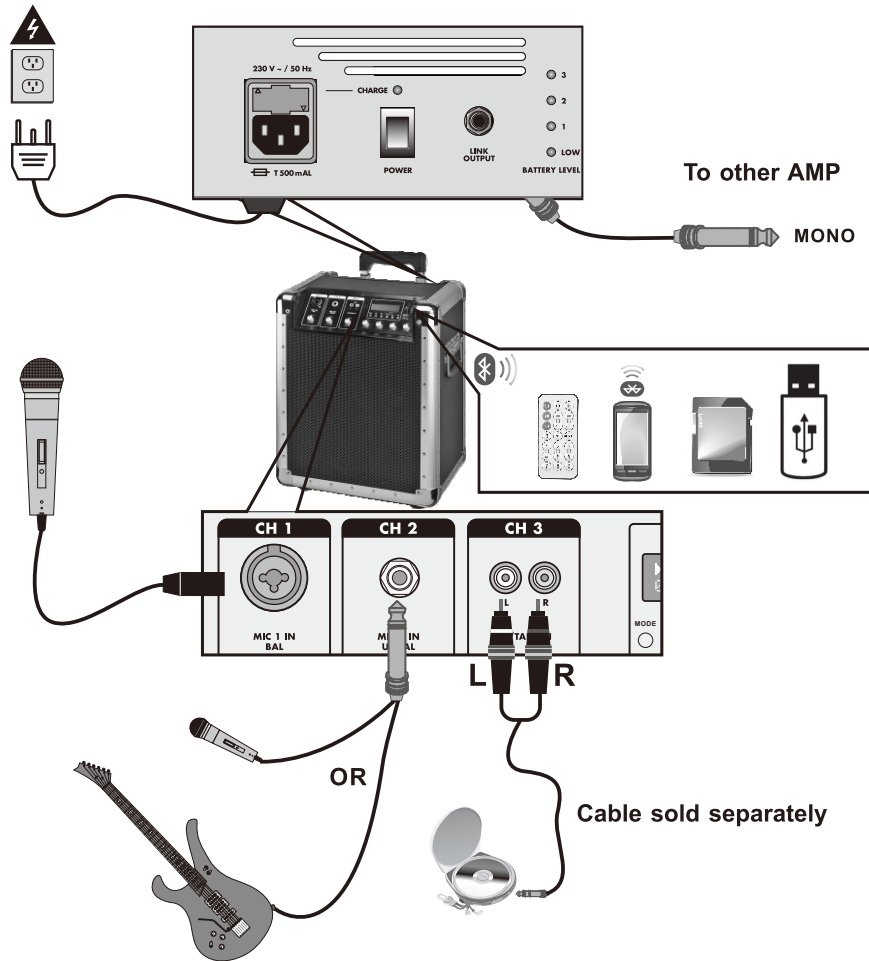

- (10) Protect the power cord from being walked on or pinched particularly at plugs, extension cords, and the point at which they exit the unit.
- (11) Only use attachments/accessories specified by the manufacturer.
- (12) Use only with the cart, stand, tripod, bracket, or table specified by the manufacturer, or sold with the device. When a cart is used, use caution when moving the cart/ device combination to avoid injury from stumbling over it.



- (13) Unplug this device during lightning storms or when not used for long periods of time.
- (14) Refer all servicing to qualified service personnel. Servicing is required when the unit has been damaged in any way, such as power supply cord or plug is damaged, liquid has been spilled or objects have fallen into the device, the unit has been exposed to rain or moisture, does not operate normally, or has been dropped.

## 3. INTRODUCTION

### FULLY CHARGE THE BATTERY BEFORE FIRST USE FOR MAXIMUM BATTERY LIFE

1. Make sure all items.
2. **READ SAFETY INSTRUCTION BOOKLET BEFORE USING THE PRODUCT.**
3. **MAKE SURE THAT YOU HAVE COMPLETELY CHARGED THE BATTERY.**
4. Study this setup diagram.
5. Place product in an appropriate position for operation.
6. Make sure all input devices such as microphones, CD or SD players, USB players, MP3 players, and linked amplifiers/PAS are turned off and volume settings are set at “zero”
7. Connect all devices as shown above.
8. Connect the outputs to the power amplifier(s), tape decks, and / or audio sources.
9. Switch everything on in the following order.
  - \* audio input sources (i.e. Microphones, instruments, CD players,USB or SD players,MP3 players)
  - \* last, any amplifiers.
10. When turning off ,always reverse this operation by ,
  - \* turning off amplifiers
  - \* last, any input devices.

## 4. FEATURES

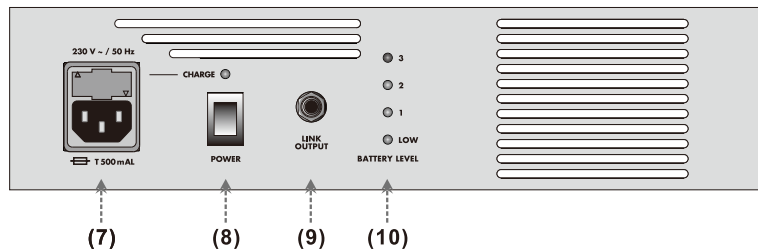
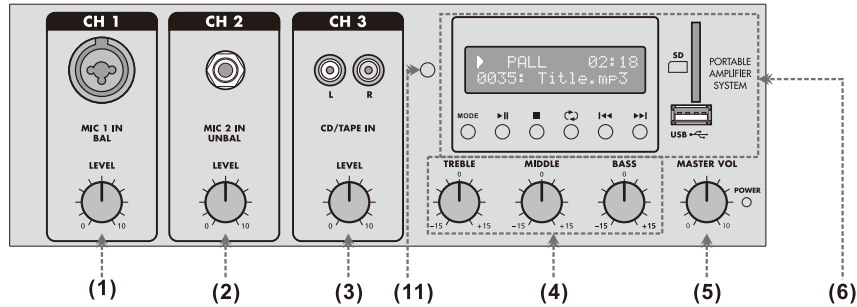

### (1). Microphone 1 Balanced Input with Level Control (1/4" and XLR):

This jack can either take a 1/4" balanced or a XLR balanced cable. An XLR Cable is included with the microphone.

### (2). Instrument/Microphone 2 Input with Level Control (1/4"):

This mono input accepts a 1/4" input such as a microphone, guitar, or other musical instrument.

### (3). CD/Tape input with Level Control (Stereo RCA):

This knob controls the level of the CD and the RCA input. This stereo RCA input can be used to connect a CD, MP3, or other audio source. To connect to a portable device with a 1/8" headphone jack, you need a standard (1/8" to RCA) adapter which is NOT included.

### (4). EQUALIZATION CONTROL(EQUALIZATION)

This is a 3-band equalizer that allows you to adjust the frequency response of the MAIN bus signal.

### (5). Master Volume Control:

This knob controls the master volume of the system.

### (6). MP3 player

Three audio source are available, USB, SD card and Bluetooth.

### (7). Power Adapter (IEC)

Insert the included power cable here to charge the unit. Note that the system can run off the power adapter while it simultaneously charges the battery. The charge indicator illuminates when the battery is charging.

### (8). Power Switch:

Turns this apparatus ON/OFF.

### (9). Link Output:

This 1/4" jack can be connected to the system input of an amplifier or amplified loudspeaker such as another system.

### (10). Battery level indicator:

while the unit is powered ON, these four lights indicate the power left in the battery. Battery life varies based on volume and usage.

### (11). Infrared Receiver

To receive the remote control. (This function is optional.)

