

For mating dimensions see MIL-DTL-38999 Series III

Reference MIL-STD-1560 for insert arrangement details. For non-MS arrangements consult Amphenol.

PANEL THICKNESS  
.067-.130  
[1,71-3,30]

PCB Stickout .150  
[3,81]

For rear shell features and accessories see MIL-DTL-38999 Series III

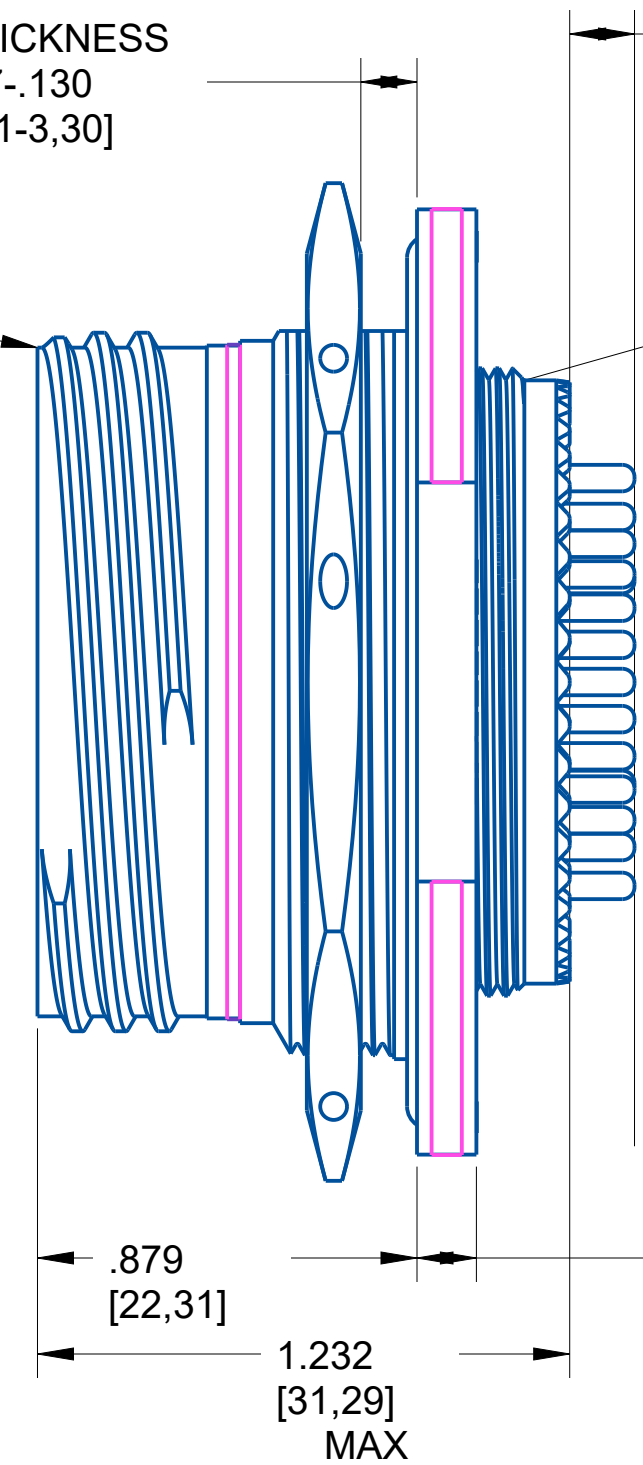

**NOTE:**  
-DRAWING NOT TO SCALE  
-DIMENSIONS SUBJECT TO CHANGE  
-DIMENSIONS ARE IN INCHES [MM]

PROPERTY OF AMPHENOL AEROSPACE. ALL RIGHTS RESERVED.

Meets applicable requirements of MIL-DTL-38999  
Base Material: Aluminum  
Plating: AP-93

<b>AMPHENOL CORPORATION</b> <small>40-60 DELAWARE AVENUE SIDNEY, N.Y. 13838</small>			
<b>RECEPTACLE</b> Electrical Connector TVS07			<b>U</b>
SIZE <b>C</b>	CAGE CODE <b>77820</b>	CODED NUMBER <b>TVS07DS-25-37P(P15)</b>	REV <b>X1</b>
SHEET 1 OF 1			

# Insert Arrangement

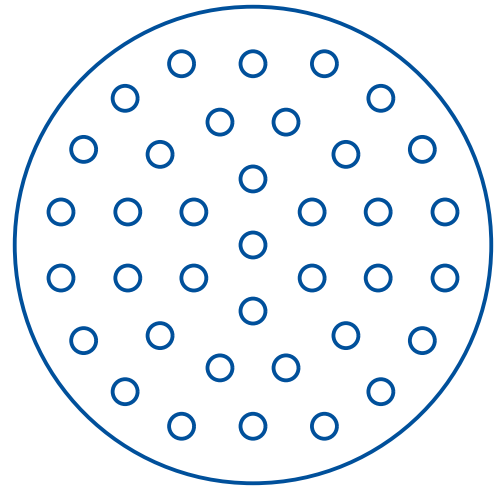

No. of Contacts	37
Contact Size	16
Wire Size	20, 18, 16

Shell Size	25
Arrangement	37
Service Rating	I
Test Current	(16)13 AMPS

**NOTE:**  
 -DRAWING NOT TO SCALE  
 -DIMENSIONS SUBJECT TO CHANGE  
 -DIMENSIONS ARE IN INCHES [MM]

PROPERTY OF AMPHENOL AEROSPACE. ALL RIGHTS RESERVED.

<b>AMPHENOL CORPORATION</b> <small>40-60 DELAWARE AVENUE SIDNEY, N.Y. 13838</small>			
RECEPTACLE Electrical Connector TVS07			U
<small>SIZE</small> <b>C</b>	<small>CAGE CODE</small> <b>77820</b>	<small>CODED NUMBER</small> <b>TVS07DS-25-37P(P15)</b>	<small>REV</small> <b>X1</b>
SHEET 1 OF 1			