

# Data sheet Pushbutton Ø 16 mm silver contact.

## Part No.: 82-4552.2000

### Technical data



|                       |  |
|-----------------------|--|
| Terminal              | Screw terminal                               |
| Operating Travel      | ca. 3 mm                                     |
| Lens illumination     | non illuminative                             |
| Lens colour           | Nature                                       |
| Lens shape            | flush  |
| Lens material         | Aluminium                                    |
| Lens surface          | anodised                                     |
| Lens optics           | opaque                                       |
| Front bezel shape     | flush  |
| Front bezel material  | Aluminium                                    |
| Weight                | 0.018 kg                                     |
| Contact material      | Silver                                       |
| Switching action      | Maintained                                   |
| Switching system      | Snap-action switching element                |
| Contacts              | 1 FS   |
| Operating temperature | - 30 °C ... + 70 °C                          |
| Approbations          | CB, CCC, C UL, UL                            |
| Operating force       | 4 ... 7 N                                    |
| Climate resistance    | Damp heat, 21 days according to IEC 60512-11 |

### Dimensions

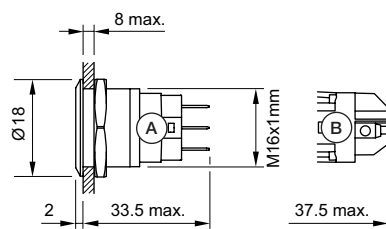

A = Solder terminal  
B = Screw terminal

### Mounting cut-outs

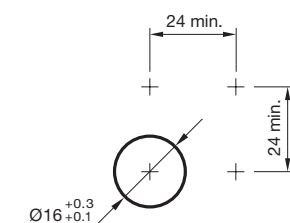

## Wiring diagrams

---

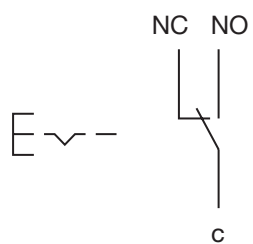

## Component layouts

---

