

Data sheet Pushbutton Ø 22 mm silver contact.

Part No.: 82-6162.2000.B001

Technical data



| | |
|-----------------------|--|
| Terminal | Screw terminal |
| Operating Travel | ca. 3 mm |
| Lens illumination | non illuminative |
| Lens colour | Silver |
| Lens shape | raised |
| Lens material | Stainless steel |
| Lens optics | opaque |
| Front bezel shape | flush |
| Front bezel material | Stainless steel |
| Weight | 0.02 kg |
| Contact material | Silver |
| Switching action | Maintained |
| Switching system | Snap-action switching element |
| Symbol | ON/OFF |
| Contacts | 1 FS |
| Operating temperature | - 30 °C ... + 70 °C |
| Approbations | CB, CCC, C UL, UL |
| Operating force | 4 ... 7 N |
| Climate resistance | Damp heat, 21 days according to IEC 60512-11 |

Dimensions

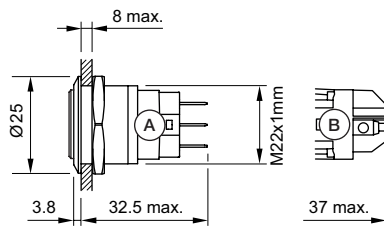

A = Solder terminal
B = Screw terminal

Mounting cut-outs

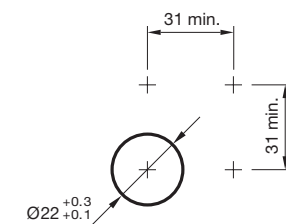

Wiring diagrams

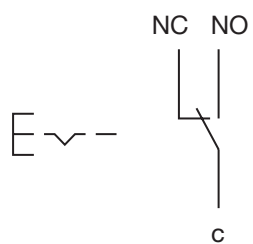

Component layouts

