

Data sheet Illuminated pushbutton Ø 22 mm silver contact.

Part No.: 82-6152.2114.B002

Technical data



Terminal	Screw terminal
Shape of illumination	Ring
Operating voltage	24 V AC/DC
Operating Travel	ca. 3 mm
Lens illumination	illuminative
Lens colour	Silver
Lens shape	flush
Lens material	Stainless steel
Lens optics	opaque
Front bezel shape	flush
Front bezel material	Stainless steel
Weight	0.018 kg
Contact material	Silver
Illumination colour	Red
Kind of illumination	Single-LED
Switching action	Maintained
Switching system	Snap-action switching element
Symbol	Standby
Contacts	1 FS
Operating temperature	- 30 °C ... + 70 °C
Approbations	CB, CCC, C UL, UL
Operating force	4 ... 7 N
Climate resistance	Damp heat, 21 days according to IEC 60512-11

Dimensions

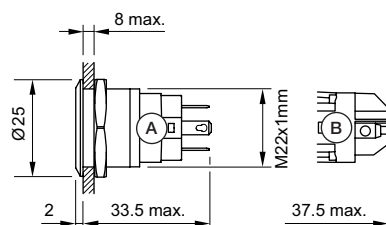

A = Solder terminal
B = Screw terminal

Mounting cut-outs

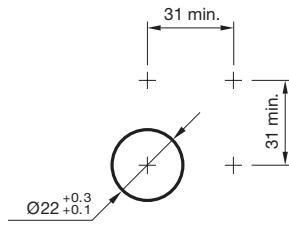

Wiring diagrams

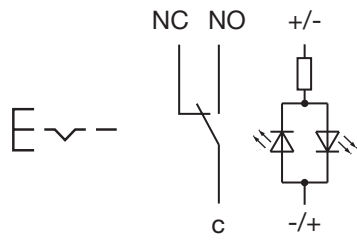

Component layouts

