

REVISIONS		REVISED BY	DATE
SYM	DESCRIPTION		

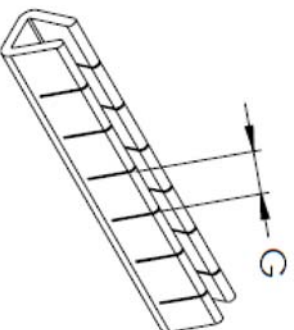
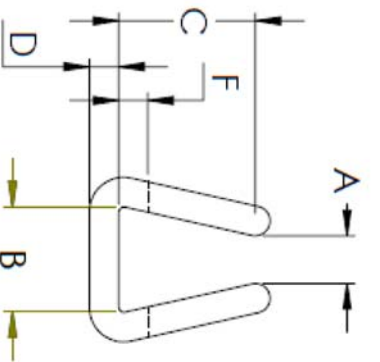

PART NUMBER	PANEL THICKNESS	A	B	C	D	F	G
2692-100	0.036-0.062 (0.91-1.57)	0.037 (0.94)	0.109 (1.77)		0.031 (0.79)	0.015 - 0.060 (0.38 - 1.52)	0.156 (4.0)
2693-100	0.062-0.099 (1.57-2.51)	0.060 (1.52)	0.109 (2.77)	0.141 (3.58)	0.031 (0.79)	0.015 - 0.060 (0.38 - 1.52)	0.156 (4.0)
2694-100	0.099-0.144 (2.51-3.66)	0.106 (2.69)	0.156 (3.96)		0.047 (1.19)	0.015 - 0.060 (0.38 - 1.52)	0.156 (4.0)

NOTE:
1. ALL DIMENSIONS IN INCH(mm)
2.
3.

MATERIAL: POLYETHYLENE		FINISH: ---	
DIMENSIONAL TOLERANCES UNLESS OTHERWISE SPECIFIED		TITLE: 2692,3,4-100	
.XX	.XXX	CATERPILLAR GROMMETS	
±.010	±.005	DRAWN: JJF DATE: 12/22/21	
FRACTIONS	ANGLES	CHECKED:	DATE:
SCALE	SCALE	APPROVED:	DATE:
±1/64	±1°		
HEAT TREAT:		SIZE: B	DRAWING NUMBER: SMP-00424
PLOT SCALE:		ISSUE: O	

ABBATRON
Electronic Connectors and Hardware
13680 S. MOSIERTOWN RD
MEADVILLE, PA 16335