

SIDE VIEW

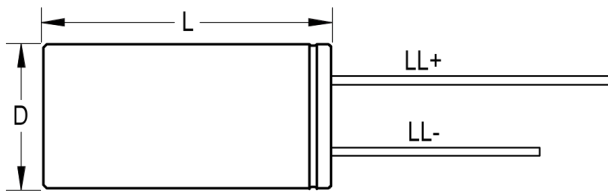

TERMINAL END VIEW

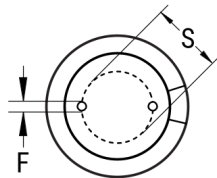

Click [here](#) for the 3D model.

| Dimensions  |                |
|-------------|----------------|
| D           | 8mm +/-0.5mm   |
| L           | 11.5mm +2.0mm  |
| S           | 3.5mm +/-0.5mm |
| LL Negative | 15mm MIN       |
| LL Positive | 20mm MIN       |
| F           | 0.6mm NOM      |

| Packaging Specifications |           |
|--------------------------|-----------|
| Packaging                | Bulk, Bag |
| Packaging Quantity       | 6000      |

| General Information |                                    |
|---------------------|------------------------------------|
| Series              | ESL                                |
| Dielectric          | Aluminum Electrolytic              |
| Description         | Single Ended Aluminum Electrolytic |
| RoHS                | Yes                                |
| Lead                | Wire Leads                         |
| AEC-Q200            | No                                 |

| Specifications          |                          |
|-------------------------|--------------------------|
| Capacitance             | 4.7 uF                   |
| Capacitance Tolerance   | 20%                      |
| Voltage DC              | 400 VDC, 450 VDC (Surge) |
| Temperature Range       | -40/+105°C               |
| Rated Temperature       | 105°C                    |
| Life                    | 10000 Hrs                |
| Dissipation Factor      | 20%                      |
| Resistance              | 12 Ohms (100kHz 20C)     |
| Ripple Current          | 110 mAmps (100kHz 105C)  |
| Leakage Current         | 47.6 uA (2min 20°C)      |
| Impedance Ratio at -40C | 7                        |