

REVISIONS			
REV	DESCRIPTION, ECN, EAR NO.	DATE	APP'D
A	NEW PROPOSAL	JUL19/22	KELVIN

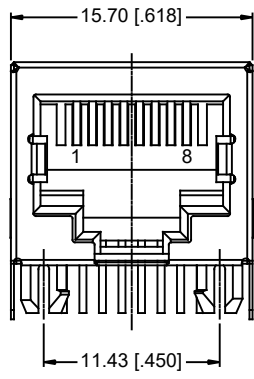

FRONT VIEW

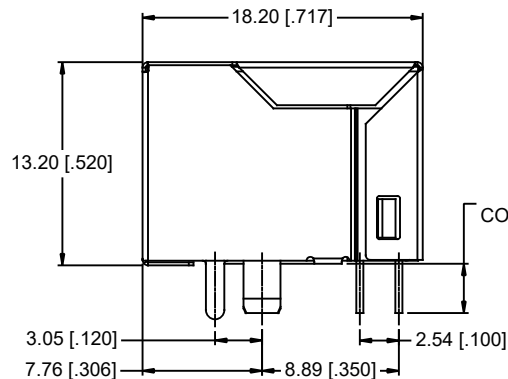

SIDE VIEW

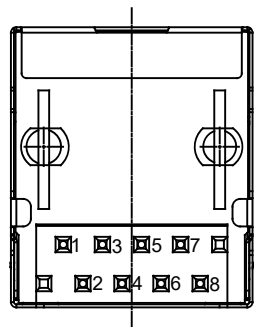

BOTTOM VIEW

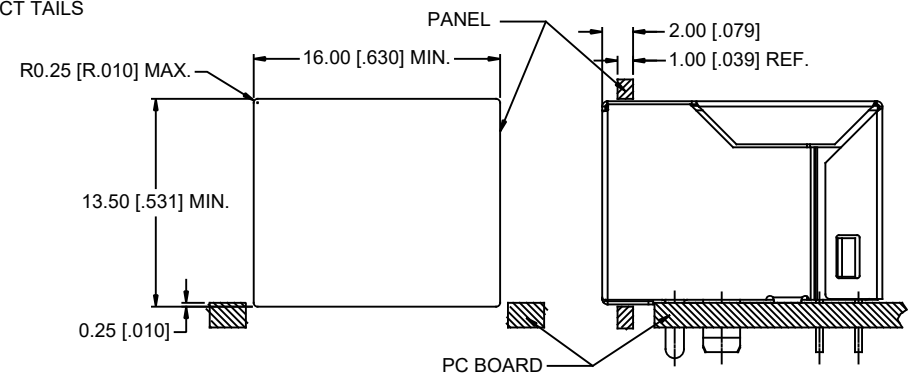

RECOMMENDED PANEL CUTOUT

**NOTES:**

- MATERIALS:**  
 CONTACTS: PHOSPHOR BRONZE, 0.46MM DIAMETER,  
 PLATING: 6 $\mu$  "[0.152 MICRONS] MIN. GOLD PLATING,  
 30 $\mu$  "[0.762 MICRONS] MIN. NICKEL OVERALL.  
 HOUSING: ENGINEERING THERMOPLASTIC, FLAMMABILITY RATING UL 94V-0  
 COLOR - BLACK.  
 SHIELD: BRASS WITH NICKEL PLATING
- MECHANICAL:**  
 MATING FORCE: 5.0 LBS MAXIMUM
- ELECTRICAL:**  
 CONTACT RESISTANCE: 20 MILLIOHMS MAXIMUM  
 INSULATION RESISTANCE: 500 MEGOHMS MINIMUM  
 CURRENT RATING: 1.5 AMPS  
 VOLTAGE RATING: 125 VOLTS AC
- ENVIRONMENTAL:**  
 STORAGE TEMPERATURE: -40°C TO +85°C
- RECOMMENDED SOLDERING TEMPERATURE:**  
 WAVE SOLDERING PEAKED AT 260°C FOR 5 TO 8 SECONDS.

AMPHENOL PART NUMBER: RJE09-188-4111-A

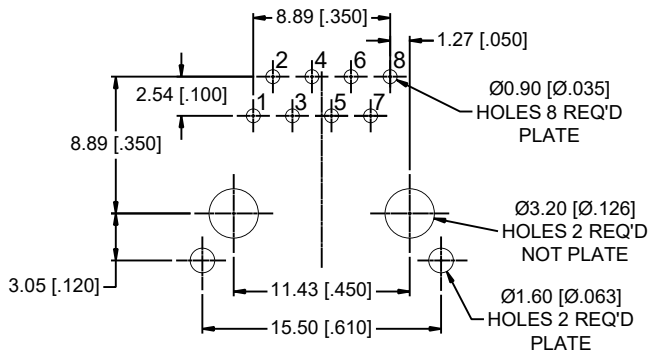

RECOMMENDED P.C.B LAYOUT  
 (TOLERANCE:  $\pm 0.05[\pm 0.002]$ )  
 (COMPONENT SIDE OF PC BOARD)



UNLESS SPECIFIED OTHERWISE	DRAWN RONNIE.C	JUL19/22
PRIMARY UNITS MILLIMETERS	CHECKED KELVIN.T	JUL19/22
SECONDARY INCHES	M.E. APP'D	
REFERENCE IN PARENTHESES	Q.A. APP'D	
GENERAL TOLERANCES	DWG APP'D	
1 DECIMAL PLACE $\pm 0.30$	ENG. REL. NO.	
2 DECIMAL PLACES $\pm 0.20$	REF.	
3 DECIMAL PLACES $\pm 0.13$		
ANGULAR DEGREES $\pm 2.0^\circ$	THIRD ANGLE PROJECTION	DO NOT SCALE DRAWING

Amphenol Canada Corp. Commercial Products	
SINGLE PORT MODULAR JACK, TAB DOWN, 8 POSITION, 8 CONTACTS, SHIELDED -RoHS COMPLIANT	
DWG NO. P-RJE09-188-4111-A	REV A
CODE ID NO. 03554	DWG SIZE X SCALE N/A SHEET 1 OF 1