

# TECHNICAL DATA SHEET

**PRO-SIGNAL**

RoHS  
Compliant

## 10mm Clear Water LEDs



Part No.	Pack Size	Colour	Wave Length at IF = 20mA			Forward Voltage (VF) at IF =20mA		Luminous Intensity at IF = 20mA	
			Min.	Typ.	Max.	Min.	Max.	Min.	Max.
PSG91902	10	Red	620nm		630nm	1.9V	2.1V	1800mcd	2000mcd
PSG91903		Green	568nm		570nm	2V	2.2V	600mcd	800mcd
PSG91904		Pure Green	520nm		525nm	3V	3.2V	8000mcd	10000mcd
PSG91905		Yellow	588nm		592nm	1.9V	2.1V	1800mcd	2000mcd
PSG91906		Blue	455nm		465nm	3V	3.2V	1800mcd	2000mcd
PSG91907		Warm White	2800k		3200k	3V	3.2V	10000mcd	12000mcd
PSG91908		Cool White	6500k		7000k	3V	3.2V	10000mcd	12000mcd
PSG91909		Blue	455nm		465nm	3V	3.2V	1800mcd	2000mcd
PSG91910	50	Red	620nm		630nm	1.9V	2.1V	1800mcd	2000mcd
PSG91911		Green	568nm		570nm	2V	2.2V	600mcd	800mcd
PSG91912		Pure Green	520nm		525nm	3V	3.2V	8000mcd	10000mcd
PSG91913		Yellow	588nm		592nm	1.9V	2.1V	1800mcd	2000mcd
PSG91914		Warm White	2800k		3200k	3V	3.2V	10000mcd	12000mcd
PSG91915		Cool White	6500k		7000k	3V	3.2V	10000mcd	12000mcd

**Important Notice:** This data sheet and its contents (the "Information") belong to pro-SIGNAL. No licence is granted for the use of it other than for information purposes in connection with the products to which it relates. No licence of any intellectual property rights is granted. The Information is subject to change without notice and replaces all data sheets previously supplied. The Information supplied is believed to be accurate but pro-SIGNAL assumes no responsibility for its accuracy or completeness, any error in or omission from it or for any use made of it. Users of this data sheet should check for themselves the Information and the suitability of the products for their purpose and not make any assumptions based on information included or omitted. Liability for loss or damage resulting from any reliance on the Information or use of it (including liability resulting from negligence or where pro-SIGNAL was aware of the possibility of such loss or damage arising) is excluded. This will not operate to limit or restrict pro-SIGNAL's liability for death or personal injury resulting from its negligence.

**PRO-SIGNAL**

# TECHNICAL DATA SHEET

**PRO-SIGNAL**

**RoHS  
Compliant**

Cont.

Part No.	Pack Size	Colour	Viewing Angle	Max. Power Dissipation	Max. Forward Current (IFM)	Recommended Operating Forward Current	Reverse Voltage
PSG91902	10	Red	45°	120mW	15mA to 18mA	30mA	5V
PSG91903		Green	30°				
PSG91904		Pure Green	45°				
PSG91905		Yellow	45°				
PSG91906		Blue	45°				
PSG91907		Warm White	45°				
PSG91908		Cool White	45°				
PSG91909		50	Blue				
PSG91910	Red		45°				
PSG91911	Green		30°				
PSG91912	Pure Green		45°				
PSG91913	Yellow		45°				
PSG91914	Warm White		45°				
PSG91915	Cool White		45°				

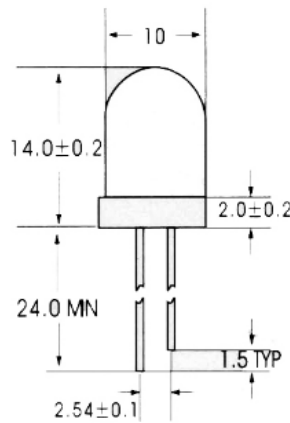
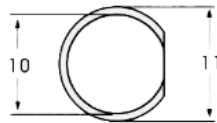

□ 0.5 SQUARE\*2



**Important Notice:** This data sheet and its contents (the "Information") belong to pro-SIGNAL. No licence is granted for the use of it other than for information purposes in connection with the products to which it relates. No licence of any intellectual property rights is granted. The Information is subject to change without notice and replaces all data sheets previously supplied. The Information supplied is believed to be accurate but pro-SIGNAL assumes no responsibility for its accuracy or completeness, any error in or omission from it or for any use made of it. Users of this data sheet should check for themselves the Information and the suitability of the products for their purpose and not make any assumptions based on information included or omitted. Liability for loss or damage resulting from any reliance on the Information or use of it (including liability resulting from negligence or where pro-SIGNAL was aware of the possibility of such loss or damage arising) is excluded. This will not operate to limit or restrict pro-SIGNAL's liability for death or personal injury resulting from its negligence.

**PRO-SIGNAL**