

construction

Industrial electron

NS

性Pe

ange

Range

6.3 -

160 -

urrent

3  $\mu$  A

$I < 0.0$

of rated

20

CV or 3  $\mu$  A

(fa

)20°C

5

35

rat

## 鋁電解電容器

ALUMINUM ELECTROLYTIC CAPACITOR(CD110X WP)

- 紋波倍乘因子MULTIPLIER FOR RIPPLE CURRENT  
頻率因子Frequency Coefficient

VV(V)	CV(μF.V)	Freq(Hz)			
		50(60)	100(120)	1K	10K
6.3 ~ 35		0.8	1	1.1	1.2
50 ~ 63	> 1000	0.8	1	1.2	1.3
	≤ 1000	0.8	1	1.5	1.7
100 ~ 250	> 1000	0.8	1	1.2	1.3
	≤ 1000	0.8	1	1.6	1.9
350 ~ 450		0.8	1	1.3	1.5

- 溫度因子TEMPERATURE COEFFICIENT

環境溫度(°C)Ambient Temperature	+85	+70	+50
倍乘因子 Factor	1.0	1.6	2.0

- 外形圖及尺寸表 CASE SIZE TABLE

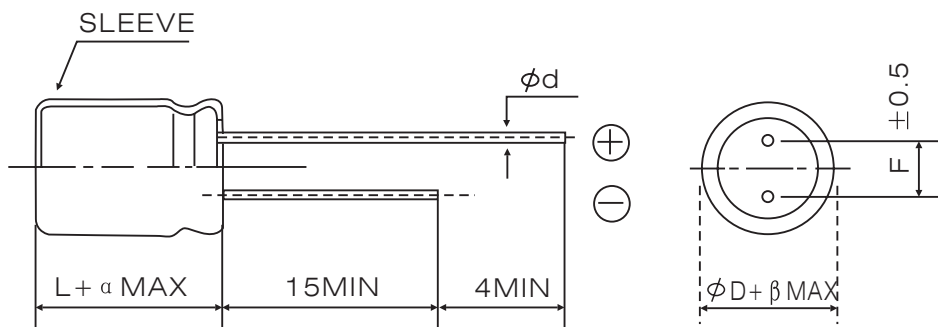

$\beta$	0.5		1.0					
$\phi D$	5	6.3	8	10	13	16	18	
$F \pm 0.5$	2.0	2.5	3.5	5		7.5		
$\phi d \pm 0.1$	0.5		0.6			0.8		
L	11		12	12 16 20	20 25	25 30 35	30 35 40	
$\alpha$	1.0		L < 16; 1.5			L ≥ 16; 2.0		

梅  
印

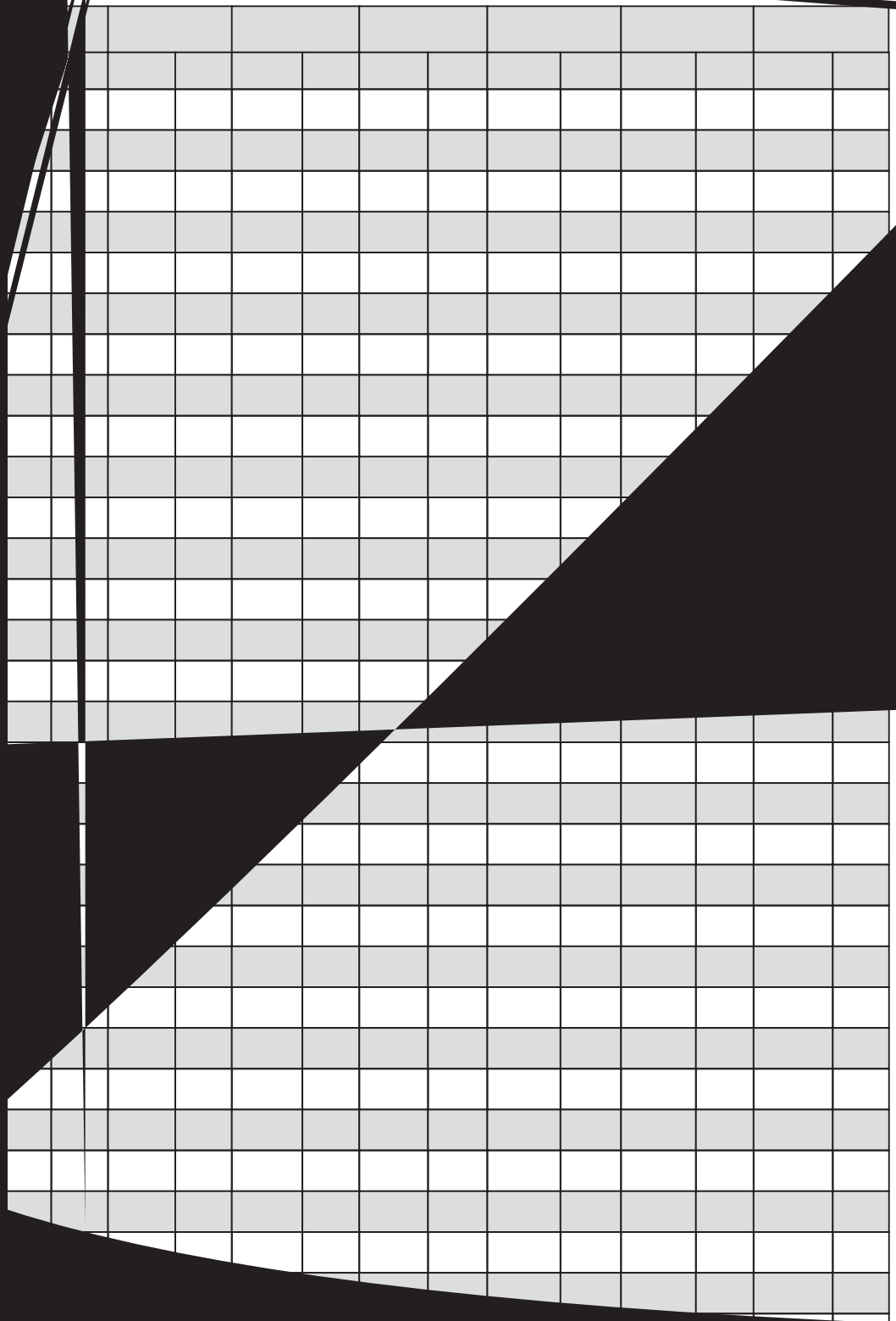

## 鋁電解電容器

### ALUMINUM ELECTROLYTIC CAPACITOR(CD110 WP)

WV(V) Cap ( $\mu$ F)	160(MB)		200(MC)		250(MD)		350(MF)		400(VA)		450(VB)	
	(1)	(2)	(1)	(2)	(1)	(2)	(1)	(2)	(1)	(2)	(1)	(2)
1(1R0)	(5X11) 6.3x11	(15) (15)	6.3X11	15	6.3X11	17	8X12	20	8X12	20	8X12	21
1.5(1R5)	6.3X11	20	6.3X11	20	6.3X11	23	8X12	23	8X12	23	8X12	24
2.2(2R2)	6.3X11	26	6.3X11	27	8X12	30	8X12	31	(8X12) 10X12	(31) 31	(8X12) 10X12	(29)29
3.3(3R3)	6.3X11	34	6.3X11	36	8X12	45	10X12	45	10X12	43	(10X12) 10X16	(40)40
4.7(4R7)	(6.3X11) 8X12	(45) 50	8X12	51	8X12	54	(10X12) 10x16	(56) 69	(10X12) 10X16	(56) 56	(10X16) 10X20	(56) 56
6.8(6R8)	8X12	63	10X12	65	10X12	69	10X20	76	10X20	69	10X20	64
10(100)	(8X12) 10X12	(83) 90	(10X12) 10X16	(85) 85	(10x12) 10X16	(90) 90	10X20	100	(10X20) 13X20	(90) 90	13X20	84
15(150)	10X16	102	10X16	103	10X20	115	13X20	142	13X20	128	13X25	107
22(220)	10X16	125	(10x16) 10X20	(135) 135	(10x20) 13X20	(130) 150	(13X20) 13x25	(185) 187	13X25	180	(13X25) 16X25	(140) 140
33(330)	10X20	180	(10x20) 13X20	(205) 205	13X20	205	16X25	230	16X25	230	(16X25) 16X30	(180)180
47(470)	(10x20) 13X20	(230) 230	13X20	230	(13x20) 13X25	(260) 260	(16x25) 16X30	(270) 280	(16X25) 16X30	(270) 280	(16X30) 18X30	(220) 220
68(680)	13X25	296	13X25	307	16X25	346	18X30	370	16X30	350		
100(101)	(13x25) 16X25	(320) 385	16X25	400	(16x25) 16X30	(450) 450	(18X35) 18X40	(420) 420	(18X35) 18X40	(420) 420		
150(151)	16X30	496	18X30	496								
220(221)	(16x30) 16X35	(645) 645	(16x35) 18X35	(645) 645								
330(331)	18x35	760										

(1)外形尺寸Case Size D × L(mm)

(2)最大允許紋波電流 Max allowable ripple current (mA r.m.s./85°C 120Hz)