



PART NO.

MCRH/RM Series

REVISIONS

ECN #	REV	DESCRIPTION	DRAWN	DATE	CHECKD	DATE	APPRVD	DATE
-	A	RELEASED	Kiran	20/06/09	Suresh	20/06/09	Farnell	06/07/09

MCRH2

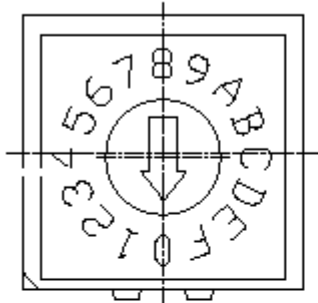

MCRH2A-16R

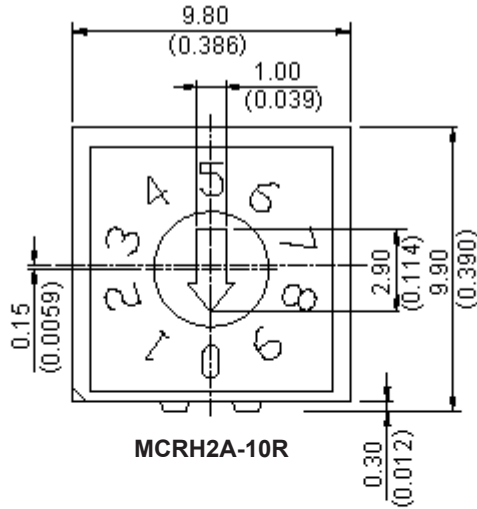

MCRH2A-10R

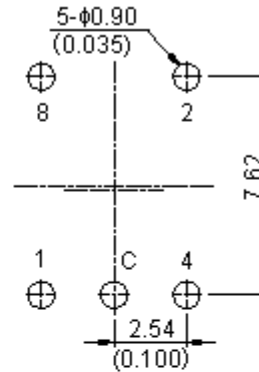

PCB Layout

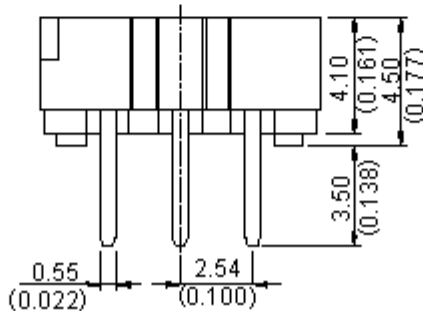
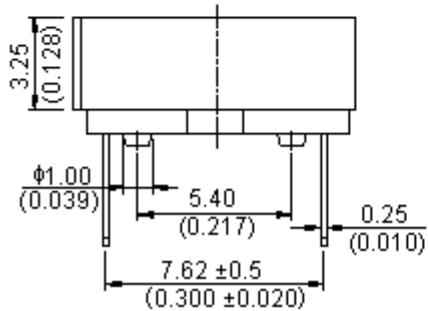

Dimensions : Millimetres (Inches)

Truth Table

○ Real Code

Position	Code			
	1	2	4	8
0	●	●	●	●
1	○	●	●	●
2	●	○	●	●
3	○	○	●	●
4	●	●	○	●
5	○	●	○	●
6	●	○	○	●
7	○	○	○	●
8	●	●	●	○
9	○	●	●	○
A	●	○	●	○
B	○	○	●	○
C	●	●	○	○
D	○	●	○	○
E	●	○	○	○
F	○	○	○	○

This data sheet and its contents (the "Information") belong to the Premier Farnell Group (the "Group") or are licensed to it. No licence is granted for the use of it other than for information purposes in connection with the products to which it relates. No licence of any intellectual property rights is granted. The Information is subject to change without notice and replaces all data sheets previously supplied. The Information supplied is believed to be accurate but the Group assumes no responsibility for its accuracy or completeness, any error in or omission from it or for any use made of it. Users of this data sheet should check for themselves the Information and the suitability of the products for their purpose and not make any assumptions based on information included or omitted. Liability for loss or damage resulting from any reliance on the Information or use of it (including liability resulting from negligence or where the Group was aware of the possibility of such loss or damage arising) is excluded. This will not operate to limit or restrict the Group's liability for death or personal injury resulting from its negligence. SPC MULTICOMP is the registered trademark of the Group. © Premier Farnell plc 2009.

TOLERANCES:

UNLESS OTHERWISE SPECIFIED, DIMENSIONS ARE FOR REFERENCE PURPOSES ONLY.

DRAWN BY:

Kiran

CHECKED BY:

Suresh

APPROVED BY:

Farnell

DATE:

20/06/09

DATE:

20/06/09

DATE:

06/07/09

DRAWING TITLE:

Rotary Switches - Dual In Line Type

SIZE
A

DWG NO.

M10002262

ELECTRONIC FILE
33007_DWG

REV
A

SCALE: NTS

U.O.M.: mm (Inches)

SHEET: 1 OF 8



PART NO.

MCRH/RM Series

REVISIONS

ECN #	REV	DESCRIPTION	DRAWN	DATE	CHECKD	DATE	APPRVD	DATE
-	A	RELEASED	Kiran	20/06/09	Suresh	20/06/09	Farnell	06/07/09

MCRH4

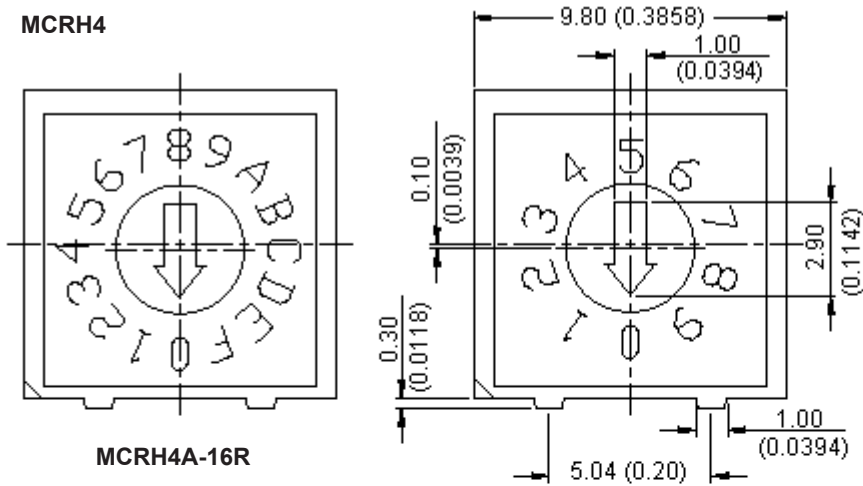

MCRH4A-16R

MCRH4A-10R

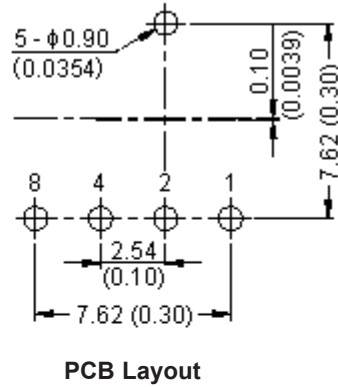

PCB Layout

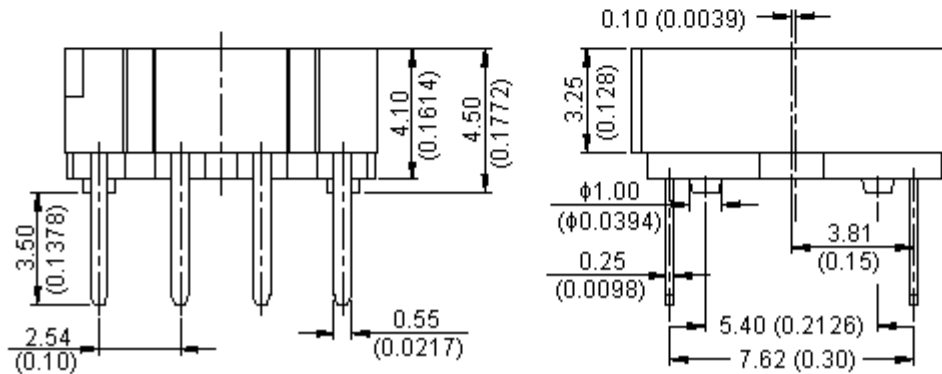

Dimensions : Millimetres (Inches)

This data sheet and its contents (the "Information") belong to the Premier Farnell Group (the "Group") or are licensed to it. No licence is granted for the use of it other than for information purposes in connection with the products to which it relates. No licence of any intellectual property rights is granted. The Information is subject to change without notice and replaces all data sheets previously supplied. The Information supplied is believed to be accurate but the Group assumes no responsibility for its accuracy or completeness, any error in or omission from it or for any use made of it. Users of this data sheet should check for themselves the Information and the suitability of the products for their purpose and not make any assumptions based on information included or omitted. Liability for loss or damage resulting from any reliance on the Information or use of it (including liability resulting from negligence or where the Group was aware of the possibility of such loss or damage arising) is excluded. This will not operate to limit or restrict the Group's liability for death or personal injury resulting from its negligence. SPC MULTICOMP is the registered trademark of the Group. © Premier Farnell plc 2009.

TOLERANCES:

UNLESS OTHERWISE SPECIFIED, DIMENSIONS ARE FOR REFERENCE PURPOSES ONLY.

DRAWN BY:

Kiran

CHECKED BY:

Suresh

APPROVED BY:

Farnell

DATE:

20/06/09

DATE:

20/06/09

DATE:

06/07/09

DRAWING TITLE:

Rotary Switches - Dual In Line Type

SIZE
A

DWG NO.

M10002262

ELECTRONIC FILE
33007_DWG

REV
A

SCALE: NTS

U.O.M.: mm (Inches)

SHEET: 2 OF 8



PART NO.

MCRH/RM Series

REVISIONS

ECN #	REV	DESCRIPTION	DRAWN	DATE	CHECKD	DATE	APPRVD	DATE
-	A	RELEASED	Kiran	20/06/09	Suresh	20/06/09	Farnell	06/07/09

MCRH3

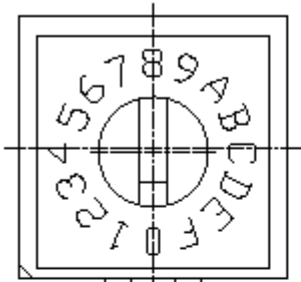

MCRH3A-16R

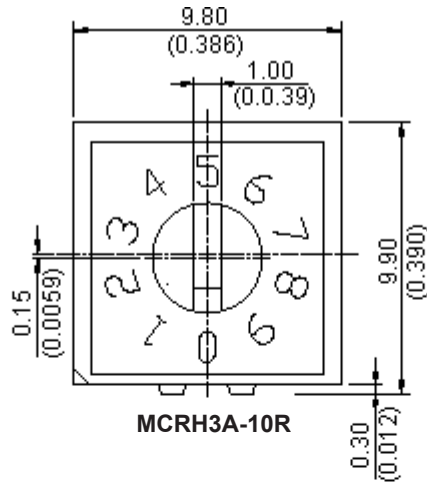

MCRH3A-10R

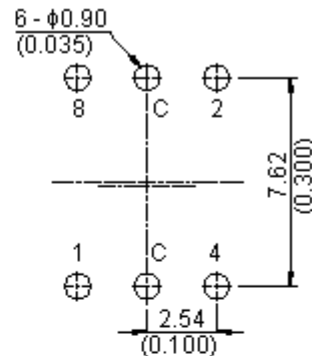

PCB Layout

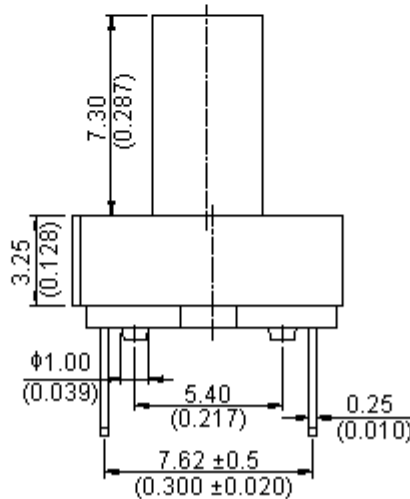
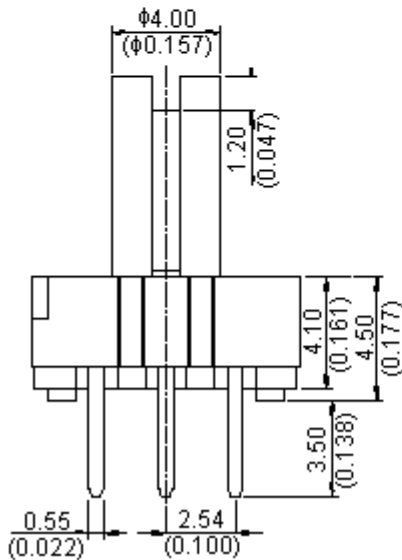

Dimensions : Millimetres (Inches)

This data sheet and its contents (the "Information") belong to the Premier Farnell Group (the "Group") or are licensed to it. No licence is granted for the use of it other than for information purposes in connection with the products to which it relates. No licence of any intellectual property rights is granted. The Information is subject to change without notice and replaces all data sheets previously supplied. The Information supplied is believed to be accurate but the Group assumes no responsibility for its accuracy or completeness, any error in or omission from it or for any use made of it. Users of this data sheet should check for themselves the Information and the suitability of the products for their purpose and not make any assumptions based on information included or omitted. Liability for loss or damage resulting from any reliance on the Information or use of it (including liability resulting from negligence or where the Group was aware of the possibility of such loss or damage arising) is excluded. This will not operate to limit or restrict the Group's liability for death or personal injury resulting from its negligence. SPC MULTICOMP is the registered trademark of the Group. © Premier Farnell plc 2009.

TOLERANCES:

UNLESS OTHERWISE SPECIFIED, DIMENSIONS ARE FOR REFERENCE PURPOSES ONLY.

DRAWN BY:	DATE:
Kiran	20/06/09
CHECKED BY:	DATE:
Suresh	20/06/09
APPROVED BY:	DATE:
Farnell	06/07/09

DRAWING TITLE:

Rotary Switches - Dual In Line Type

SIZE	DWG NO.	ELECTRONIC FILE	REV
A	M10002262	33007_DWG	A
SCALE: NTS	U.O.M.: mm (Inches)	SHEET: 3 OF 8	



PART NO.

MCRH/RM Series

REVISIONS

ECN #	REV	DESCRIPTION	DRAWN	DATE	CHECKD	DATE	APPRVD	DATE
-	A	RELEASED	Kiran	20/06/09	Suresh	20/06/09	Farnell	06/07/09

MCRM3

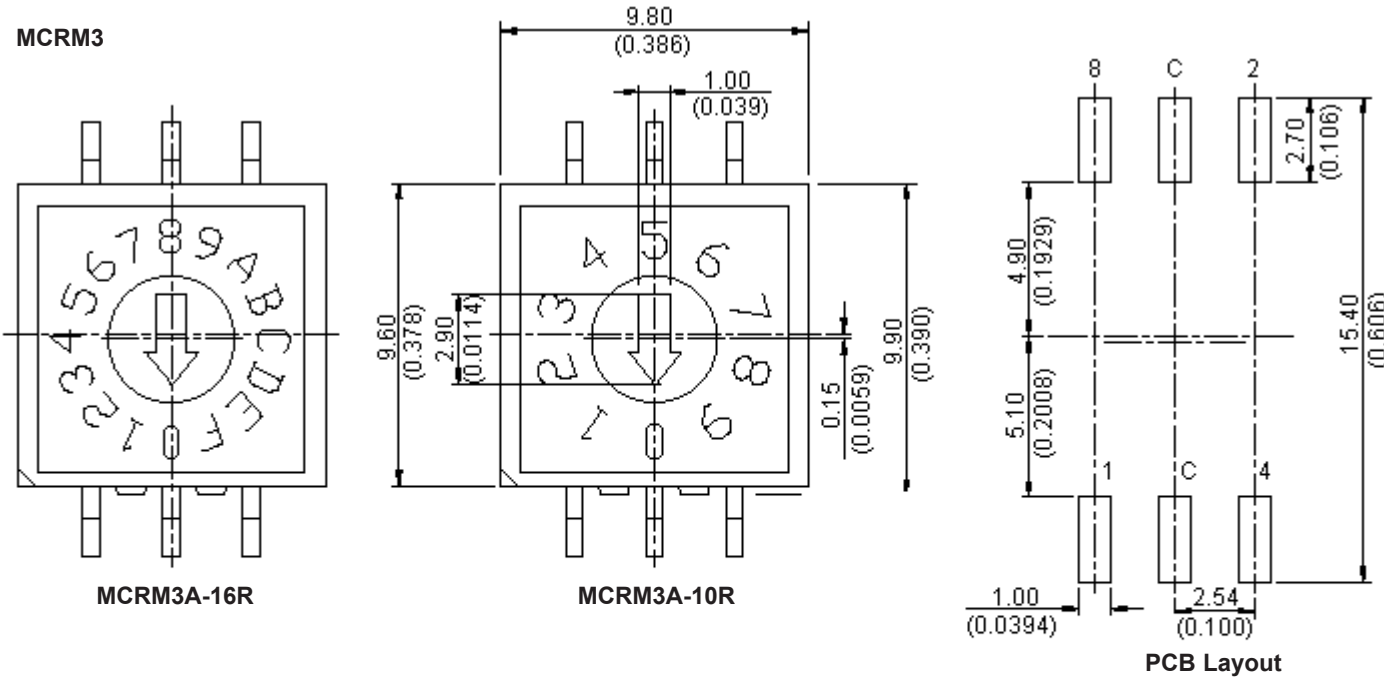

Dimensions : Millimetres (Inches)

This data sheet and its contents (the "Information") belong to the Premier Farnell Group (the "Group") or are licensed to it. No licence is granted for the use of it other than for information purposes in connection with the products to which it relates. No licence of any intellectual property rights is granted. The Information is subject to change without notice and replaces all data sheets previously supplied. The Information supplied is believed to be accurate but the Group assumes no responsibility for its accuracy or completeness, any error in or omission from it or for any use made of it. Users of this data sheet should check for themselves the Information and the suitability of the products for their purpose and not make any assumptions based on information included or omitted. Liability for loss or damage resulting from any reliance on the Information or use of it (including liability resulting from negligence or where the Group was aware of the possibility of such loss or damage arising) is excluded. This will not operate to limit or restrict the Group's liability for death or personal injury resulting from its negligence. SPC MULTICOMP is the registered trademark of the Group. © Premier Farnell plc 2009.

TOLERANCES:

UNLESS OTHERWISE SPECIFIED, DIMENSIONS ARE FOR REFERENCE PURPOSES ONLY.

DRAWN BY:

Kiran

CHECKED BY:

Suresh

APPROVED BY:

Farnell

DATE:

20/06/09

DATE:

20/06/09

DATE:

06/07/09

DRAWING TITLE:

Rotary Switches - Dual In Line Type

SIZE
A

DWG NO.

M10002262

ELECTRONIC FILE
33007_DWG

REV
A

SCALE: NTS

U.O.M.: mm (Inches)

SHEET: 4 OF 8



PART NO.

MCRH/RM Series

REVISIONS

ECN #	REV	DESCRIPTION	DRAWN	DATE	CHECKD	DATE	APPRVD	DATE
-	A	RELEASED	Kiran	20/06/09	Suresh	20/06/09	Farnell	06/07/09

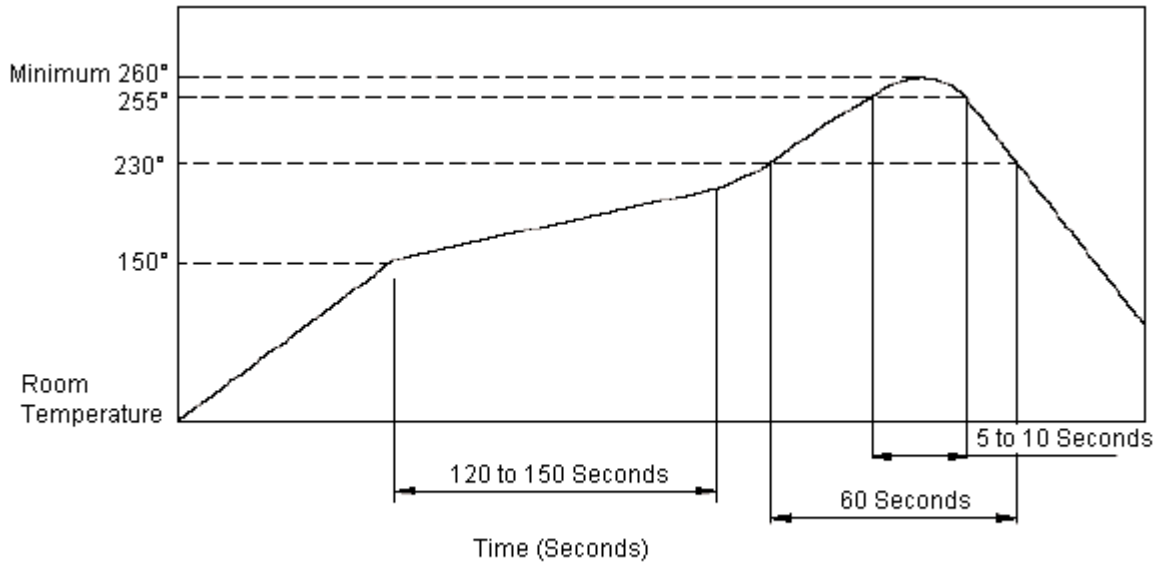

Reflow Temperature Profile

Soldering Process:

- Hand Soldering :** Use a soldering iron of 30 watts, controlled at (350°C) approximately maximum 5 seconds.
- Wave Soldering :** Recommended temperature at 500°F (260°C) maximum of 5 seconds (for through hole type).
- Reflow Soldering :** When applying reflow soldering, the peak temperature or the reflow oven should be set at 260°C maximum.

This data sheet and its contents (the "Information") belong to the Premier Farnell Group (the "Group") or are licensed to it. No licence is granted for the use of it other than for information purposes in connection with the products to which it relates. No licence of any intellectual property rights is granted. The Information is subject to change without notice and replaces all data sheets previously supplied. The Information supplied is believed to be accurate but the Group assumes no responsibility for its accuracy or completeness, any error in or omission from it or for any use made of it. Users of this data sheet should check for themselves the Information and the suitability of the products for their purpose and not make any assumptions based on information included or omitted. Liability for loss or damage resulting from any reliance on the Information or use of it (including liability resulting from negligence or where the Group was aware of the possibility of such loss or damage arising) is excluded. This will not operate to limit or restrict the Group's liability for death or personal injury resulting from its negligence. SPC MULTICOMP is the registered trademark of the Group. © Premier Farnell plc 2009.

TOLERANCES:
UNLESS OTHERWISE SPECIFIED, DIMENSIONS ARE FOR REFERENCE PURPOSES ONLY.

DRAWN BY:	DATE:
Kiran	20/06/09
CHECKED BY:	DATE:
Suresh	20/06/09
APPROVED BY:	DATE:
Farnell	06/07/09

DRAWING TITLE:			
Rotary Switches - Dual In Line Type			
SIZE	DWG NO.	ELECTRONIC FILE	REV
A	M10002262	33007_DWG	A
SCALE: NTS		U.O.M.: mm (Inches)	SHEET: 6 OF 8



PART NO.

MCRH/RM Series

REVISIONS

ECN #	REV	DESCRIPTION	DRAWN	DATE	CHECKD	DATE	APPRVD	DATE
-	A	RELEASED	Kiran	20/06/09	Suresh	20/06/09	Farnell	06/07/09

Part Number Table

Description	Part Number
Rotary Dip Switch	MCRH4AF-10R
Rotary Dip Switch	MCRH3AF-10R
Rotary Dip Switch	MCRH2AF-10R
Rotary Dip Switch	MCRH4AF-16R
Rotary Dip Switch	MCRH3AF-16R
Rotary Dip Switch	MCRH2AF-16R
Rotary Dip Switch, SMD	MCRM4AF-10R
Rotary Dip Switch, SMD	MCRM3AF-10R
Rotary Dip Switch, SMD	MCRM2AF-10R
Rotary Dip Switch, SMD	MCRM4AF-16R
Rotary Dip Switch, SMD	MCRM3AF-16R
Rotary Dip Switch, SMD	MCRM2AF-16R

This data sheet and its contents (the "Information") belong to the Premier Farnell Group (the "Group") or are licensed to it. No licence is granted for the use of it other than for information purposes in connection with the products to which it relates. No licence of any intellectual property rights is granted. The Information is subject to change without notice and replaces all data sheets previously supplied. The Information supplied is believed to be accurate but the Group assumes no responsibility for its accuracy or completeness, any error in or omission from it or for any use made of it. Users of this data sheet should check for themselves the Information and the suitability of the products for their purpose and not make any assumptions based on information included or omitted. Liability for loss or damage resulting from any reliance on the Information or use of it (including liability resulting from negligence or where the Group was aware of the possibility of such loss or damage arising) is excluded. This will not operate to limit or restrict the Group's liability for death or personal injury resulting from its negligence. SPC MULTICOMP is the registered trademark of the Group. © Premier Farnell plc 2009.

**TOLERANCES:
UNLESS OTHERWISE SPECIFIED, DIMENSIONS ARE FOR REFERENCE PURPOSES ONLY.**

DRAWN BY:	DATE:
Kiran	20/06/09
CHECKED BY:	DATE:
Suresh	20/06/09
APPROVED BY:	DATE:
Farnell	06/07/09

DRAWING TITLE:			
Rotary Switches - Dual In Line Type			
SIZE	DWG NO.	ELECTRONIC FILE	REV
A	M10002262	33007_DWG	A
SCALE: NTS		U.O.M.: mm (Inches)	SHEET: 7 OF 8



PART NO.

MCRH/RM Series

REVISIONS

ECN #	REV	DESCRIPTION	DRAWN	DATE	CHECKD	DATE	APPRVD	DATE
-	A	RELEASED	Kiran	20/06/09	Suresh	20/06/09	Farnell	06/07/09

Part Number Explanation:

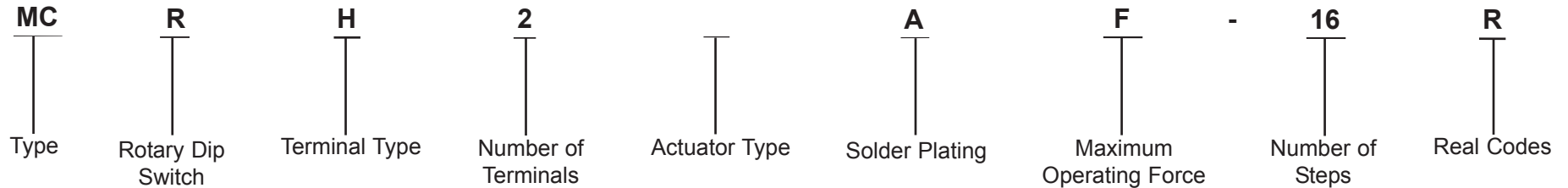

- Terminal Type** : H = Through Hole.
M = SMT.
- Number of Terminals** : 2 = 3 x 2
3 = 3 x 3
4 = 4 x 1.
- Actuator Type** : □ = Recessed Actuator.
- Solder Plating** : A = Terminal : Gold Plated Over Nickel.
- Maximum Operating Force** : 200gf cm.
- Number of Steps** : 10 = 10 Steps.
16 = 16 Steps.

<http://www.farnell.com>
<http://www.newark.com>
<http://www.cpc.co.uk>

This data sheet and its contents (the "Information") belong to the Premier Farnell Group (the "Group") or are licensed to it. No licence is granted for the use of it other than for information purposes in connection with the products to which it relates. No licence of any intellectual property rights is granted. The Information is subject to change without notice and replaces all data sheets previously supplied. The Information supplied is believed to be accurate but the Group assumes no responsibility for its accuracy or completeness, any error in or omission from it or for any use made of it. Users of this data sheet should check for themselves the Information and the suitability of the products for their purpose and not make any assumptions based on information included or omitted. Liability for loss or damage resulting from any reliance on the Information or use of it (including liability resulting from negligence or where the Group was aware of the possibility of such loss or damage arising) is excluded. This will not operate to limit or restrict the Group's liability for death or personal injury resulting from its negligence. SPC MULTICOMP is the registered trademark of the Group. © Premier Farnell plc 2009.

TOLERANCES:
UNLESS OTHERWISE SPECIFIED, DIMENSIONS ARE FOR REFERENCE PURPOSES ONLY.

DRAWN BY:	DATE:
Kiran	20/06/09
CHECKED BY:	DATE:
Suresh	20/06/09
APPROVED BY:	DATE:
Farnell	06/07/09

DRAWING TITLE:			
Rotary Switches - Dual In Line Type			
SIZE	DWG NO.	ELECTRONIC FILE	REV
A	M10002262	33007_DWG	A
SCALE: NTS		U.O.M.: mm (Inches)	SHEET: 8 OF 8