

## Modul-Compete 50 modular Signal tower

- Cost-optimised modular 50 mm Ø signal tower
- for classic 24V DC applications in industry
- Up to 5 positions possible
- Low soiling due to flat-flush smooth exterior design
- Maximum product availability due to minimum number of articles (only 23 order numbers)
- LED multifunction and LED continuous light modules in 6 colours
- Efficient sound module selectable up to 95 dB – 8 tones
- Optimised 'resilient' bayonet system enables high stability, even without sealing rings
- five-pole M12 base with automatic contacting push-in system
- All common mounting types

### TECHNICAL DATA

|                            |  |
|----------------------------|--|
| Housing                    | Ø 50 mm, black (RAL 9005)  |
| Lens                       | Polycarbonate, ribbed inside   |
| Type of mounting           | horizontal, vertical, Tube mounting or NPT 1/2"                        |
| Beacon type                | LED steady light, flashing light, strobe light and double strobe light |
| Light source               | LEDs   |
| Tone                       | see tone table   |
| Volume                     | 95 dB  |
| Duty cycle                 | 100 %  |
| Service life               | Light source: 100.000 h  |
| Number of possible modules | max. 5   |
| Operating temperature      | 30 °C / +60 °C   |
| Operating temperature      | -30°C / +60°C  |
| Degree of protection       | IP65 & UL Type 4/4x/13   |
| Impact resistance          | IK07   |
| Weight (modules)           | 26-149 g   |



## Modul-Compete 50 pre-assembled Signal towers



Order no.: CT5-Q01  
Colours: red/amber/green  
Function: LED steady beacon  
Nominal voltage: 24 V DC  
Type of mounting: Tube mounting  
(100 mm tube length)



Order no.: CT5-Q02  
Colours: red/green  
Function: LED steady beacon  
Nominal voltage: 24 V DC  
Type of mounting: Tube mounting  
(100 mm tube length)



Order no.: CT5-Q05  
Colours: red/amber/green/blue  
Function: LED steady beacon  
Nominal voltage: 24 V DC  
Type of mounting: Tube mounting  
(100 mm tube length)

# Modul-Compete 50 Dimension Drawing

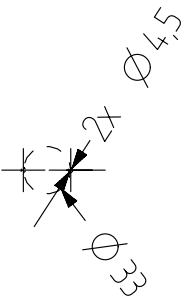
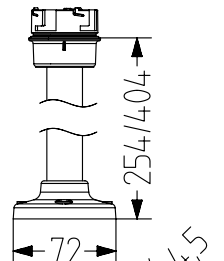
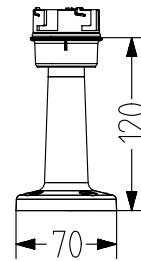
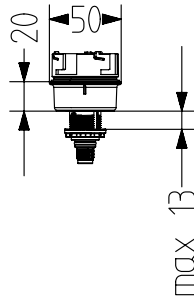
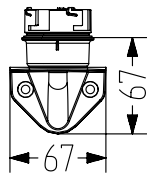
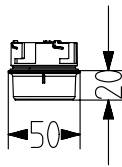
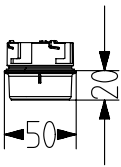
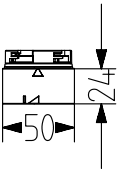
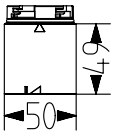
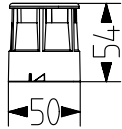
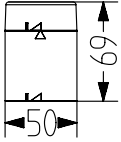

STANDARD  
NPT TUBE

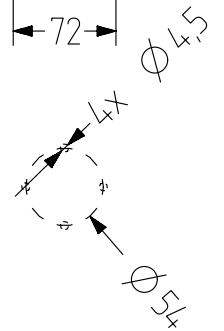
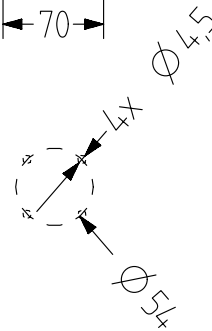
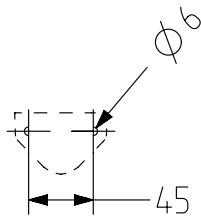

# Modul-Compete 50 Order numbers



## LIGHT MODULES

| Type  | Product                     | orange      | red         | clear       | blue        | green       | yellow      |
|-------|-----------------------------|-------------|-------------|-------------|-------------|-------------|-------------|
| CT5DC | LED continuous light module | 915 011 005 | 915 012 005 | 915 014 005 | 915 015 005 | 915 016 005 | 915 017 005 |
| CT5DF | LED multifunctional module  | 915 021 005 | 915 022 005 | 915 024 005 | 915025005   | 915 026 005 | 915 027 005 |



## SOUND MODULES

| Type  | Product                 | Description  | Article number |
|-------|-------------------------|--|----------------|
| CT5ZM | Top Piezo Summer Module | one of eight tones can be selected with a dip switch | 915 510 005    |



## BASES

| Type   | Product  | Description                 | Article number |
|--------|--|-----------------------------|----------------|
| CT5MW  | Base for horizontal and external tube mounting suitable for Ø 25mm tubes |                             | 915 710 900    |
| CT5MC5 | Base with integrated M12 five-pin connector                              |                             | 915 781 005    |
| CT5NPT | Base for NPT 1/2" conduit mounting                                       |                             | 915 715 900    |
| CT5MV  | Base for vertical mounting   | with closed cable insertion | 915 730 900    |
| CT5KR1 | Tube base on 100 mm plastic tube with integrated foot                    |                             | 915 742 910    |
| CT5MR2 | Tube base on 250 mm aluminium tube with plastic foot                     |                             | 915 743 900    |
| CT5MR3 | Tube base on 400 mm aluminium tube with plastic foot                     |                             | 915 744 900    |



## ACCESSORIES

| Type  | Product  | Description  | Article number |
|-------|--|--|----------------|
| CT5SK | Screw set for external tube mounting                               | two mounting screws and one seal for external tube mounting of the base CT5MW                          | 915 710 910    |
| CT5BR | Metal bracket for external cable insertion                         | for use with base CT5NPT and cable connection CKV as cable relief                                      | 915 735 900    |
| WM22  | Metal bracket for products with M22 mounting thread                | for base CT5MC5 and M22 products   | 812 100 900    |
| XWR   | Plastic bracket for vertical mounting of tubes with a plastic base | for all tubes with a plastic base, incl. mounting screws   | 900 600 900    |
| BDW   | Junction box for horizontal mounting, M20, incl. mounting screws   | for all tubes with a plastic base, for lateral cable insertion   | 841 501 900    |
| BDV   | Junction box for vertical mounting, M20                            | for all tubes with plastic base, for lateral cable insertion, separate screw set to match signal tower | 841 511 900    |
| BDM   | Junction box for magnet mounting, M20                              | for all tubes with plastic base, for lateral cable insertion, separate screw set to match signal tower | 841 521 900    |
| SKE   | Screw set for junction boxes                                       | for mounting of PC7, CT5, ECO70/60/40 and Compact70 tube feet on BDV and BDM junction boxes            | 841 000 900    |
| CKV   | Cable connection NPT 1/2"  | for use with CT5NPT  | 698 800 045    |