

M12

1210 ... 0...

Actuator/Sensor Cordsets M12



Actuator/sensor cordset with overmolded connector

Cable end 1:

M12 male, straight, A-coded, IP67

Cable end 2:

blunt cut

Cable:

PVC, black

Approvals:



M12

1210 ... 0...

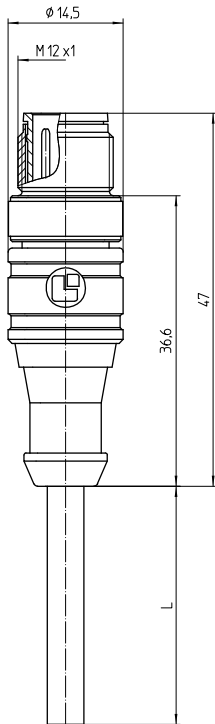

Environmental conditions

Temperature range -25 °C/+80 °C

Materials

| | |
|--------------------|----------------------------------|
| Insulating body | TPU GF, HB according to UL94 |
| Contact pin | CuZn, pre-nickel and gold-plated |
| Overmolding/handle | PVC, HB according to UL94 |
| Knurled screw | CuZn, nickel-plated |

Mechanical data

| | |
|------------------|---------------------|
| Mating cycles | ≥ 100 |
| Insertion force | ≤ 10 N ¹ |
| Withdrawal force | ≤ 15 N ¹ |
| Protection class | IP67 ² |

¹ measured with a proper counterpart

² according to IEC DIN EN 60529, only in locked condition with an appropriate counterpart

Connected cable

Construction PVC, black

Pin assignments for male M12 connectors, A-coded, front view

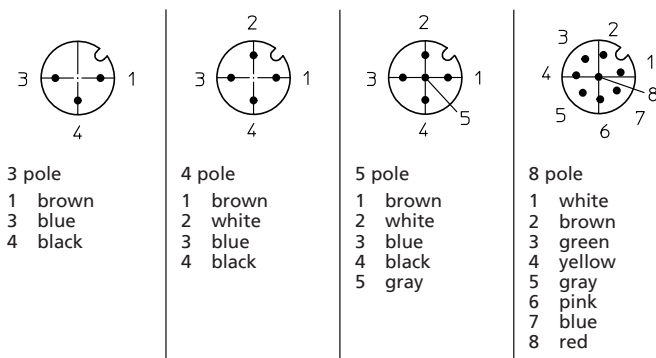

Electrical data (at T_{amb} 20 °C)

| | |
|-----------------------|--|
| Contact resistance | ≤ 10 mΩ |
| Rated current | 4 A (3–5 poles) 2 A (8 poles) 1.5 A (12 poles) (T _{amb} 40 °C) |
| Rated voltage | 250 V AC/DC (3–4 poles) 60 V AC/DC (5 poles) 30 V AC/DC (8–12 poles) |
| Rated impulse voltage | 2500 V (3–4 poles) 1500 V (5 poles) 800 V (8–12 poles) |
| Material group | I (IEC)/0 (UL) (CTI = 600) |
| Insulation resistance | > 100 MΩ |

Associated products

Counterparts

| | | |
|-------------------------|-------------------------|-------------------------|
| ☞ 1200 ... 0... | ☞ 1200 ... 3... | ☞ 1205 ... 0... |
| ☞ 1205 ... 3... | ☞ 1206 ... L1 0... | ☞ 1206 ... L1 3... |
| ☞ 1206 ... L2 0... | ☞ 1206 ... L2 3... | ☞ 1210 1200 ... 0... |
| ☞ 1210 1200 ... 3... | ☞ 1210 1205 ... 3... | ☞ 1210 1206 ... L1 0... |
| ☞ 1210 1206 ... L1 3... | ☞ 1210 1206 ... L2 0... | ☞ 1210 1206 ... L2 3... |
| ☞ 1220 ... T16CW ... | ☞ 1220 ... T20CW100 ... | ☞ 1220 ... T20CW101 ... |

M12

1210 ... 0...

-
- | | | |
|---------------------------------------|---------------------------------------|---------------------------------------|
| 1220 ... T20CW102 ... | 1220 ... T20CW103 ... | 1220 ... T20CW104 ... |
| 1220 ... T20CW105 ... | 1221 ... T16CW100 ... | 1221 ... T9CP |
| 1240 ... T...CR | 1245 ... T9CR | 5500 04DL1 3... |
| 5500 04L1 3... | 5500 08DL1 3... | 5500 08L1 3... |
| 5512 04DL1 | 5512 04L1 | 5512 08L1 |

Accessories

- | | | |
|---------------------------|---------------------------|---------------------------|
| 9912 CPM0 | 9912 MRBU | 9912 MRGN |
| 9912 MRRD | 9912 MRWH | 9912 MRYE |
-

M12

1210 ... 0...

| Designation | Pole Number | Connected Cable | PU (Pieces) | MDQ (Pieces) | Dimensions L (mm) |
|-----------------|-------------|--|-------------|--------------|----------------------|
| 1210 03 001 2m | 3 | PVC, black, 3 x 0.34 mm ² (AWG 22), 910001, UL-style 2464 | 5 | 10 | 2000 |
| 1210 04 002 2m | 4 | PVC, black, 4 x 0.34 mm ² (AWG 22), 910002, UL-style 2464 | 5 | 10 | 2000 |
| 1210 04 002 5m | 4 | PVC, black, 4 x 0.34 mm ² (AWG 22), 910002, UL-style 2464 | 1 | 10 | 5000 |
| 1210 04 002 10m | 4 | PVC, black, 4 x 0.34 mm ² (AWG 22), 910002, UL-style 2464 | 1 | 10 | 10000 |
| 1210 08 004 2m | 8 | PVC, black, 8 x 0.25 mm ² (AWG 24), 910004, UL-style 2464 | 1 | 10 | 2000 |

Packaging:
in a plastic bag