

16

1614 09

## Power supply connectors



Power supply chassis socket, straight version, with solder eyes, for front side mounting

---

State: Obsolete

---

16

1614 09

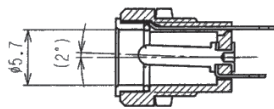
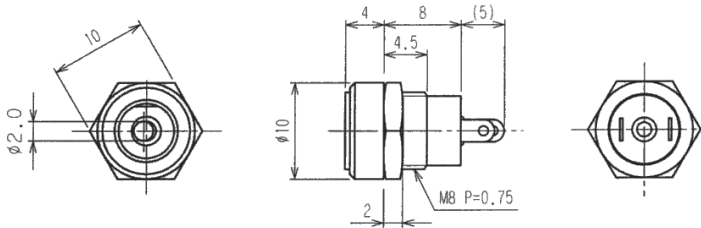

#### Environmental conditions

Temperature range -20 °C/+70 °C

#### Materials

Insulating body	PA
Contact spring	CuSn, nickel-plated
Contact pin	CuZn, nickel-plated
Lötkontakt	CuZn, nickel-plated
Hexagonal nut	steel, nickel-plated

#### Mechanical data

Diameter opening	5,7 mm
Diameter center pin	2,0 mm
Mating cycles	≥ 5000 <sup>1</sup>
Insertion force	≤ 30 N (initial value)
Withdrawal force	3–30 N (initial value)

<sup>1</sup> gemessen mit einem Lehrenstecker

#### Electrical data (at T<sub>amb</sub> 20 °C)

Contact resistance	≤ 30 mΩ
Rated current	2 A
Rated voltage	24 V DC
Rated impulse voltage	500 V/60 s
Insulation resistance	≥ 100 MΩ

#### Associated products

Counterparts			
☞ 1633 02	☞ 1633 03	☞ NES/J 21	
☞ NES/J 21 W	☞ NES/J 210	☞ XNES/J 210	

16

1614 09

Designation	Pole Number	PU (Pieces)	MDQ (Pieces)
1614 09	2	250	500

**Packaging:**

in bulk, in a cardboard box or a plastic bag