



Ledinaire floodlights gen3

BVP164 LED11/830 PSU 10W SWB MDU CE

Ledinaire floodlights gen3, 10 W, 1100 lm, 3000 K, CRI80, Symmetrical wide beam, MDU1, IP65

This Ledinaire floodlights range contains a selection of popular off-the-shelf LED luminaires that comes with the Philips high quality levels at a competitive price. Reliable, energy-efficient and affordable – just what you need.

Product data

General information		Light source colour	
Lighting Technology	LED	Light source colour	830 warm white
Driver included	Yes	Optical cover/lens type	Glass
Number of gear units	Unit	Luminaire light beam spread	110° x 110°
Lamp family code	-	Optic type outdoor	Symmetrical wide beam
Light source engine type	LED	Operating and electrical	
Light source replaceable	No	Input Voltage	220 to 240 V
Light technical		Line Frequency	50 or 60 Hz
Upwards light output ratio	0	Input frequency	50 or 60 Hz
Luminous Flux	1,100 lm	Initial CLO power consumption	- W
Standard tilt angle post-top	-	Average CLO power consumption	10 W
Standard tilt angle side entry	-	End CLO power consumption	- W
Correlated Colour Temperature	3000 K	Inrush current	0.78 A
Luminous Efficacy (rated) (Nom)	110 lm/W	Inrush time	0.00648 ms
Colour rendering index (CRI)	>80	Power Consumption	10 W
Flickering value (PstLM)	1	Power Factor (Fraction)	0.7
Stroboscopic effect	5	Connection	Flying leads/cables
		Cable	Cable 1.0 m without plug

Ledinaire floodlights gen3

Number of products on MCB of 16 A type B	175
Temperature	
Ambient temperature range	-20 to +40 °C
Controls and dimming	
Dimmable	No
Driver/power unit/transformer	Power supply unit (On/Off)
Constant light output	No
Mechanical and housing	
Housing material	Aluminium die cast
Reflector material	Polycarbonate
Optic material	Glass
Optical cover/lens material	Tempered glass
Fixation material	Steel
Housing Colour	Grey
Mounting device	Mounting bracket adjustable
Optical cover/lens shape	Flat
Optical cover/lens finish	Clear
Overall length	79 mm
Overall width	155 mm
Overall height	52 mm
Effective projected area	0.005 m ²
Dimensions (height x width x depth)	52 x 155 x 79 mm
Approval and application	
Ingress protection code	IP65 [Dust penetration-protected, jet-proof]
Mech. impact protection code	IK07 [2 J reinforced]
Surge Protection (Common/Differential)	Luminaire surge protection level up to 2 kV differential mode and 2 kV common mode
Sustainability rating	-
Protection class IEC	Safety class I
Glow-wire test	Temperature 650 °C, duration 30 s
Flammability mark	-
CE mark	Yes

ENEC mark	-
Warranty period	3 years
Photobiological risk	Photobiological risk group 1 @200mm to EN62778
Photobiological risk specification	0.2 m
EU RoHS compliant	Yes
Initial performance (IEC compliant)	
Luminous flux tolerance	+/-10%
Initial chromaticity	(0.440, 0.403) SDCM <5
Power consumption tolerance	+/-10%
Init. Color Rendering Index Tolerance	+/-2
Over time performance (IEC compliant)	
Control gear failure rate at median useful life 50,000 h	5 %
Lumen maintenance at median useful life* 50,000 h	80
Application conditions	
Performance ambient temperature Tq	25 °C
Maximum dim level	Not applicable
Product data	
Full EOC	871951453482799
Order product name	BVP164 LED11/830 PSU 10W SWB MDU CE
Order code	53482799
SAP numerator – quantity per pack	1
Numerator – packs per outer box	24
Material number (12NC)	911401883683
Full product name	BVP164 LED11/830 PSU 10W SWB MDU CE
EAN/UPC - Case	8719514534926



Dimensional drawing

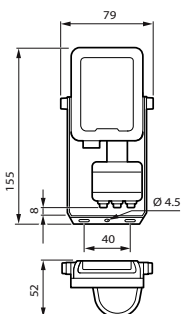

Ledinaire floodlights gen3

