

**RoHS
Compliant**



Specification

Voltage Rating	: 58V DC
Interrupting Rating	: 1000A 58V DC
Operating Temperature Range	: -40°C to +125°C
Housing Material	: PA66+GF Cover Material:PA66
Insertion Force	: 45N Max.
Extraction Force	: 4N Min. / 35N Max

Diagram

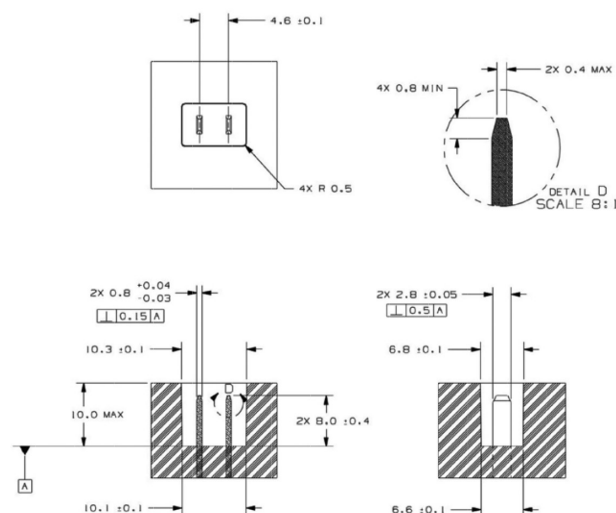
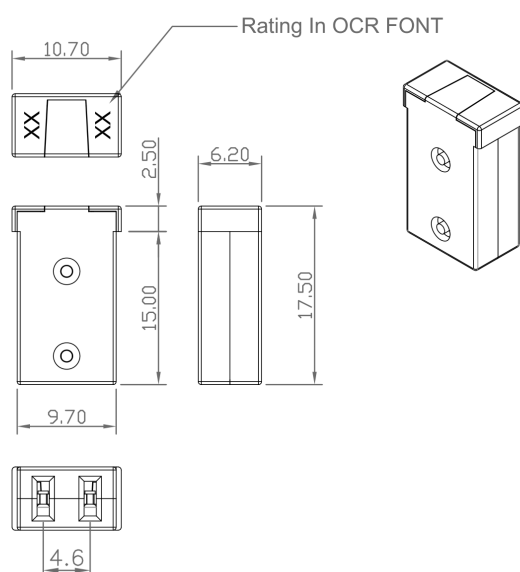

% of Rated Current	Opening Time
110%	>4 hr.
135%	60 - 1800 s.
200%	2 - 60 s.
350%	2 - 7 s.
600%	0.04 - 1 s.

Part Number Table

Description	Ampere (A)	Voltage(V DC)	Color Code	Part Number
Mini Fuse Link, Female	15A	32V	Blue	MP012558
	20A		White	MP012559
	25A		Pink	MP012560
	30A		Green	MP012561
	40A		Gray	MP012562

Important Notice : This data sheet and its contents (the "Information") belong to the members of the AVNET group of companies (the "Group") or are licensed to it. No licence is granted for the use of it other than for information purposes in connection with the products to which it relates. No licence of any intellectual property rights is granted. The Information is subject to change without notice and replaces all data sheets previously supplied. The Information supplied is believed to be accurate but the Group assumes no responsibility for its accuracy or completeness, any error in or omission from it or for any use made of it. Users of this data sheet should check for themselves the Information and the suitability of the products for their purpose and not make any assumptions based on information included or omitted. Liability for loss or damage resulting from any reliance on the Information or use of it (including liability resulting from negligence or where the Group was aware of the possibility of such loss or damage arising) is excluded. This will not operate to limit or restrict the Group's liability for death or personal injury resulting from its negligence. Multicomp Pro is the registered trademark of Premier Farnell Limited 2019.