

Part Number: TOM-1545P-R



Features

Omnidirectional
Super clarity, distortion-free response
Pin type mounting
This part is RoHS 2002/95/EC Compliant

Electrical Specifications

Directivity	Omnidirectional
Impedance	2.2 kOhm
Operating Voltage	2 Vdc
Package Size	4 x 1.5 mm
Sensitivity	-45 +/- 3 dB

Environmentally friendly

Mechanical

Dimensions are in millimeters, tolerance is ± 0.5 unless otherwise specified.

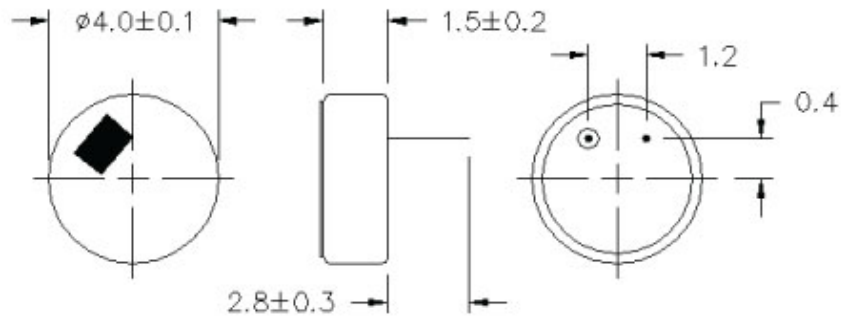

Performance

Typical SPL vs. Frequency

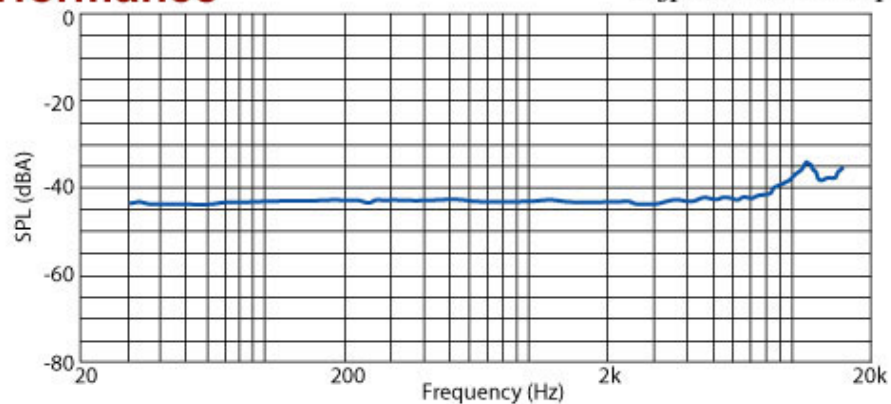

For application notes and detail drawing specifications, please consult www.projectsunlimited.com.

Specifications subject to change without notice.

© 2006, Projects Unlimited Inc., All Rights Reserved.