



EX-RMLHWS

- **Illuminated signal**
- Ex-Zone 1 and 21

Data

Ordering data

Product type description	EX-RMLHWS
Article number (order number)	101197361
EAN (European Article Number)	4030661532554
eCl@ss number, version 12.0	27-37-12-11
eCl@ss number, version 11.0	27-37-12-11
eCl@ss number, version 9.0	27-37-12-11
ETIM number, version 7.0	EC000223
ETIM number, version 6.0	EC000223

Approvals - Standards

Certificates	TÜV IEC Ex
--------------	---------------

Explosion protection

Explosion protection: regulations	EN IEC 60079-0 EN 60079-11 EN 60079-14 EN 60079-31
-----------------------------------	---

Explosion protection zones	1 21 2 22
Explosion protection category	2G 2D
Explosion protection designation	 II 2G Ex ib IIC Gb  II 2D Ex ib IIIC Db

General data

Standards	EN ISO 13849-1 EN IEC 60947-5-1 EN IEC 60947-5-5
Design	Round
Material of the identification label	Stainless steel (V4A)
Material of the front ring	Aluminium
Gross weight	60 g

Safety classification

Mission time	20 Year(s)
--------------	------------

Safety classification - Safety outputs

B _{10D} Normally-closed contact (NC)	100,000 Operations
---	--------------------

Mechanical data

Actuating stroke	4 mm
------------------	------

Mechanical data - Dimensions

Mounting diameter	22.3 mm
Thickness of the front panel, maximum	6 mm

Ordering code

Product type description:

EX-R(1)

(1)

DT(2)-(7)	Pushbutton, Ø 28 mm, buttons in MS, coated
DM(2)-(7)	Pushbutton with diaphragm, Ø 28 mm, buttons in MS, coated
DL(3)-(7)	Illuminated pushbutton, Ø 28 mm, swivel in impact-resistant plastic
DLM(3)-(7)	Illuminated pushbutton with diaphragm, Ø 28 mm, swivel in impact-resistant plastic
MLH(3)-(7)	Indicator lights for LED´s, protruding swivel in impact-resistant plastic
DP40(2)-(7)	Mushroom head impact button without latching, button Ø 37 mm in MS, coated
DRZ45(2)(3)(5)	Mushroom head impact button with latching, device head in MS, coated, pull to unlock
WT21	Spring-return rotary selector switch with 2 positions
WT21.1	Spring-return rotary selector switch with 2 positions, long gag
WS21	Selector switch with 2 latched positions
WS21.1	Selector switch with 2 latched positions, long gag
WT32	Spring-return rotary selector switch with 3 positions
WT32.1	Spring-return rotary selector switch with 3 positions, long gag
WST32	Spring-return rotary selector switch, 3 positions; right: latching, left: switching
WST32.1	Spring-return rotary selector switch, 3 positions; right: latching, left: switching; long gag
WS32	Selector switch with 3 latched positions
WS32.1	Selector switch with 3 latched positions, long gag
WTS32	Maintained spring-return rotary selector switch, 3 positions, right: switching, left: latching
WTS32.1	Maintained spring-return rotary selector switch, 3 positions, right: switching, left: latching; long gag
SS21S2	Key-operated selector switch with 2 latched positions, key withdrawal left only
SS21S12	Key-operated selector switch with 2 latched positions, key withdrawal right only

SS21S12	Key-operated selector switch with 2 latched positions, key withdrawal in both positions
SS32S2	Key-operated selector switch with 3 latched positions, key withdrawal left only
SS32S2	Key-operated selector switch with 3 latched positions, key withdrawal in the middle
SS32S3	Key-operated selector switch with 3 latched positions, key withdrawal right
SS32S123	Key-operated selector switch with 3 latched positions, key withdrawal in all 3 positions
ST21S1	Key-operated spring-return selector switch with 1 touch position, automatic return to the zero position, latch position 55°, key withdrawal left only
ST32S2	Key-operated spring-return selector switch with 2 touch positions left and right, automatic return to the zero position, key withdrawal only in the middle
SST32S1	Key-operated selector switch pushbutton with 3 positions, touch position 35°, latch position 55°, left switching, right latching, key withdrawal left only
SST32S2	Key-operated selector switch pushbutton with 3 positions, touch position 35°, latch position 55°, left switching, right latching, key withdrawal only in the middle
STS32S2	Key-operated selector switch pushbutton with 3 positions, touch position 35°, latch position 55°, left switching, right latching, key withdrawal only in the middle
STS32S3	Key-operated selector switch pushbutton with 3 positions, touch position 35°, latch position 55°, left switching, right latching, key withdrawal right only
F 03	Contact element with screw connection, 1 NO contact, Contact Label 3, 4
F 10	Contact element with screw connection, 1 NC contact, Contact Label 1, 2
LDE WS 24	White luminous element with integrated LED for illuminated pushbutton RDL / RDLM and indicator light RMLH
B	Blanking plug
(2)	
SW	Black

(3)	
GB	Yellow
(4)	
RT	Red
(5)	
GN	Green
(6)	
WS	White
(7)	
BL	Blue

Pictures

Product picture (catalogue individual photo)



ID: krmlhf06

| 518.5 kB | .jpg | 352.425 x 367.594 mm - 999 x 1042 px - 72 dpi

| 41.5 kB | .png | 73.731 x 76.906 mm - 209 x 218 px - 72 dpi

| 66.6 kB | .jpg | 118.533 x 123.472 mm - 336 x 350 px - 72 dpi

Dimensional drawing basic component

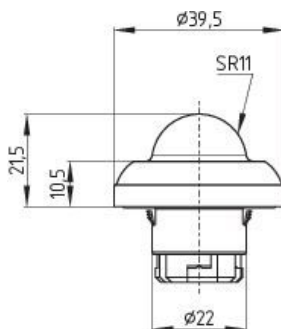

ID: krml-g01

| 17.6 kB | .png | 64.558 x 74.436 mm - 183 x 211 px - 72 dpi

| 17.5 kB | .png | 15.494 x 17.865 mm - 183 x 211 px - 300 dpi

| 6.0 kB | .jpg | 64.558 x 74.436 mm - 183 x 211 px - 72 dpi

| 10.9 kB | .jpg | 64.558 x 74.436 mm - 183 x 211 px - 72 dpi

| 3.1 kB | .jpg | 35.278 x 35.278 mm - 100 x 100 px - 72 dpi

| 14.0 kB | .jpg | 64.558 x 74.436 mm - 183 x 211 px - 72 dpi

Schmersal Ltd., Sparrowhawk Close, WR14 1GL Malvern

The details and data referred to have been carefully checked. Images may diverge from original. Further technical data can be found in the manual. Technical amendments and errors possible.

Generated on: 05/02/2024, 09:19