

Please note that the data given here has been taken from the online catalog. For comprehensive information and data, please refer to the user documentation at <http://www.download.phoenixcontact.com>. The General Terms and Conditions of Use apply to Internet downloads.

▶ Extract from the online catalog



Electronic housing consisting of: Housing shells left and right, front plate, transparent cover, metal foot catch and spring, open housing, 16-pos. (4 x 4 pos.), width: 22.5 mm, color: Light gray

The illustration shows the housing versions

| | |
|--------------------------|----------------------|
| Order No. | 2713625 |
| Ord designation | ME MAX 22,5 2-2 KMGY |
| EAN | 4017918917401 |
| Pack | 10 Pcs. |
| Customs tariff | 85369010 |
| Weight/Piece | 0,05757 KG |
| Catalog page information | Page 139 (NTK-2005) |

▶ Product notes

WEEE/RoHS-compliant since: 04/12/2005



IMPORTANT : This date is valid for Customers in Germany only. Date Format is MM/DD/YYYY. Please contact your local in-country Phoenix Contact location or designated business partner for a Logistics Compliant date in your area. In order to guarantee delivery of RoHS-Compliant product, please purchase Phoenix Contact parts from authorized Phoenix Contact representatives and distributors.

ME MAX 22,5 2-2 KMGY



▶ **Technical data**

General

| | |
|------------------|--------|
| Housing material | PA 6.6 |
| Color | gray |

Dimensions / positions

| | |
|-----------------------|----------|
| Length | 99 mm |
| Constructional height | 114.5 mm |
| Width | 22.5 mm |
| Number of positions | 16 |

Technical data

| | |
|------------------------------------|----|
| Inflammability class acc. to UL 94 | V0 |
|------------------------------------|----|

► Drawings

Explosion drawing

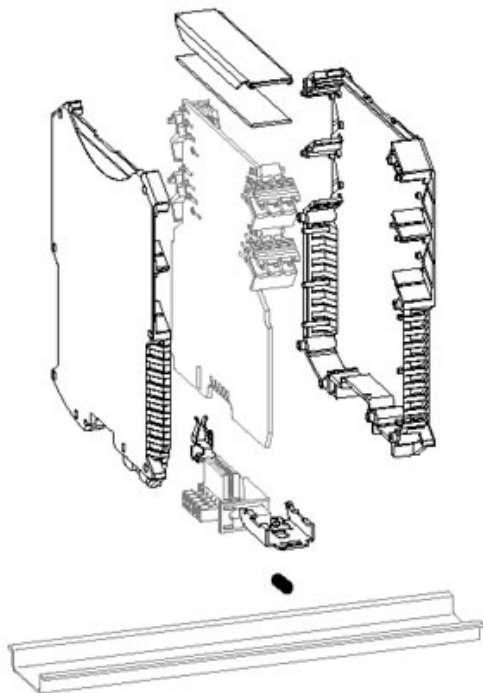

The illustration shows a version of the product
(open housing) with accessories

Dimensioned drawing

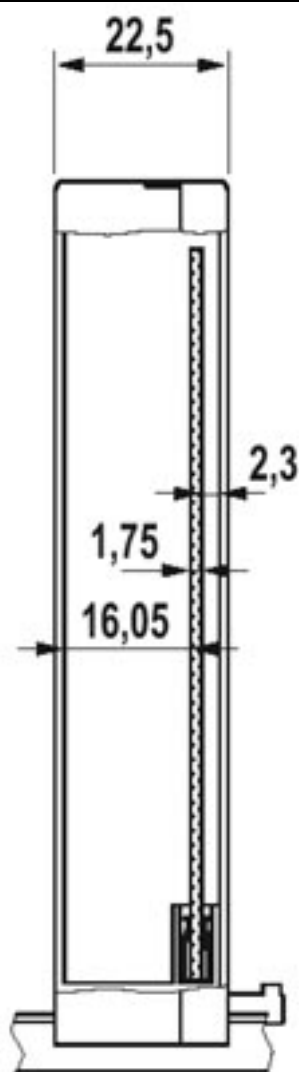
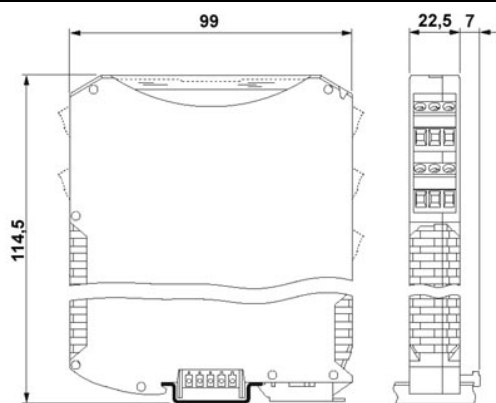

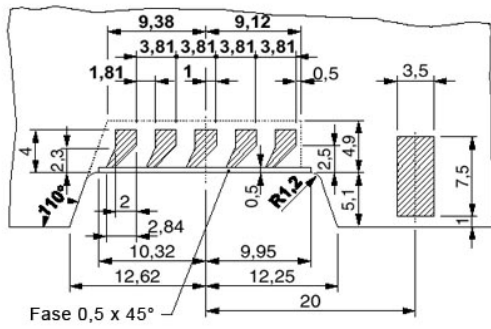

Detailed dimensional drawing of the mounting rail bus connector contact pads

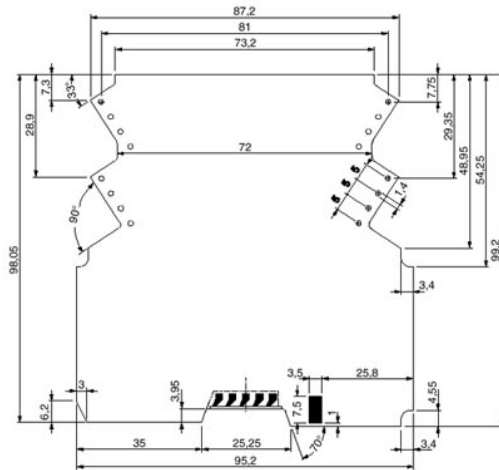

Dimensional drawing of the ME MAX 2-2 printed circuit board, for printed circuit terminal block connection (MKDSO), view: component side

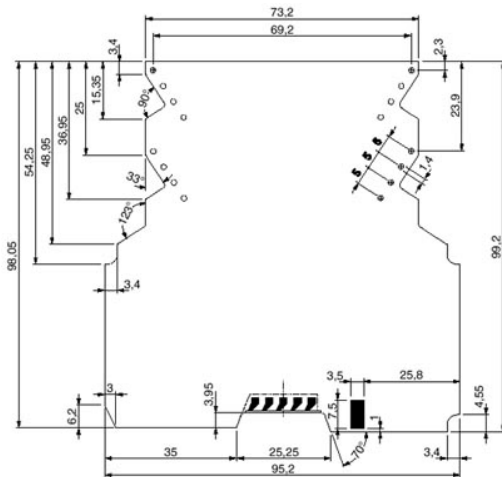

Dimensional drawing of the ME MAX 2-2 printed circuit board for plug connection (MSTBO), view: component side

► Accessories

| Item | Designation | Description |
|---------------------|----------------------------------|--|
| General | | |
| 0813789 | BMKLT 14X12 WH | Label sheet for laser printer, rounded label corners, sheet format: DIN A4, 1 sheet , labeling field: 14 x 12 mm, color: White |
| 2713722 | ME 22,5 TBUS 1,5/ 5-ST-3,81 KMGY | DIN rail bus connector, 5-pos., color: Light gray |
| 2707929 | ME MAX B-22,5 KMGY | Cover cap for unoccupied terminal points, color: Light gray |
| 2713777 | ME MAX LP SAMPLE MSTBO 2-2 | PCB, for custom fitting for COMBICON connection system |
| 2713751 | MKDSO 2,5/4-6 SET KMGY | |
| 2713764 | MSTBO 2,5/4-6 ST SET KMGY | Kit consisting of COMBICON header and screw connectors for 6 x 4 positions (24-pos.), color: Light gray |
| Plug/Adapter | | |
| 2908294 | ME FE-CONTACT | Functional earth ground contact, for intermediate elements. |

► Address

PHOENIX CONTACT GmbH & Co. KG
Flachsmarktstr. 8
32825 Blomberg
Germany
Phone +49 5235 3 00
Fax +49 5235 3 41200
<http://www.phoenixcontact.com>
Phoenix Contact
Technical modifications reserved;