

REVISIONS			
REV	DESCRIPTION, ECN, EAR NO.	DATE	APP'D
A	PROPOSAL DRAWING (EAR 14908)	NOV30/20	K.L.

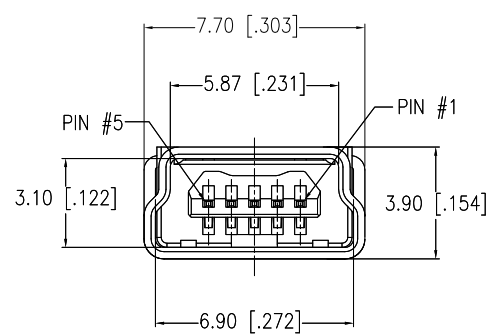

TOP VIEW  
CAP OMITTED FOR CLARITY

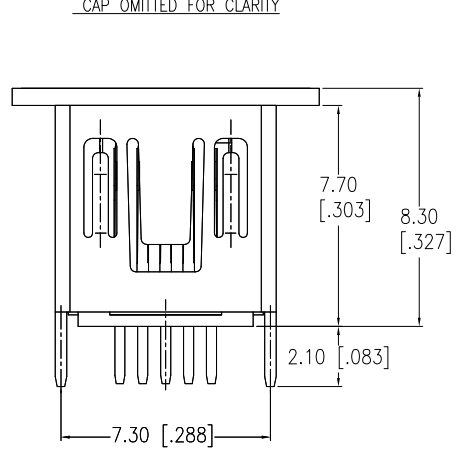

FRONT VIEW  
ASSEMBLY WITH CAP

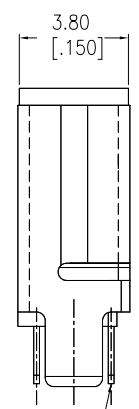

CONTACT TAILS FOR  
POSITIONS 1, 3 & 5  
IN THIS ROW

SIDE VIEW

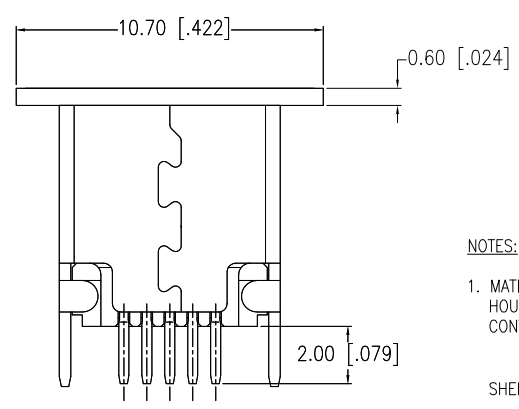

BACK VIEW

NOTES:

1. MATERIALS: ALL MATERIALS MUST BE RoHS COMPLIANT.  
HOUSING & CAP: HIGH TEMPERATURE THERMOPLASTIC, GLASS FILLED.  
CONTACTS: COPPER ALLOY,  
PLATING: 30u" [0.76 MICRONS] GOLD PLATING ON CONTACT MATING AREA.  
MATTE TIN ON CONTACT TAILS. NICKEL UNDERPLATE.  
SHELL: COPPER ALLOY, NICKEL PLATED.
2. OPERATING TEMPERATURE: -40°C TO +105°C.
3. CAP PROVIDES A FLAT SURFACE FOR VACUUM PICK UP OF PART AND  
MAY BE REMOVED AFTER SOLDERING IS COMPLETE.
4. PARTS PACKAGED IN TAPE AND REEL FORMAT, SEE SHEET 2 FOR DETAILS.

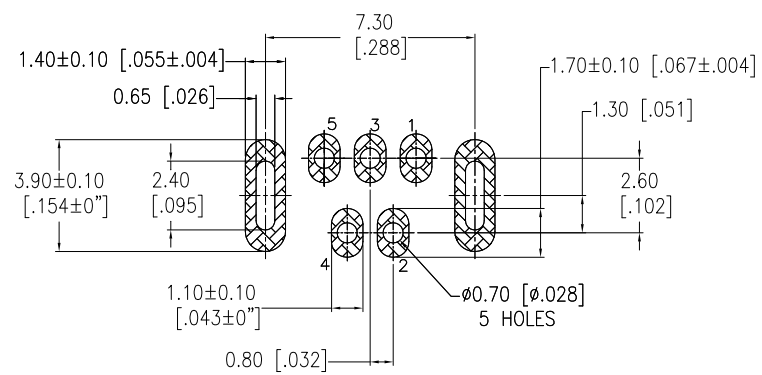

RECOMMENDED P.C.B. LAYOUT  
(COMPONENT SIDE OF BOARD)

TOLERANCE: ±0.05mm

AMPHENOL PART NO. UE25-BE55-10CTR

THIS DOCUMENT CONTAINS PROPRIETARY INFORMATION AND SUCH INFORMATION MAY NOT BE DISCLOSED TO OTHERS FOR ANY PURPOSE OR USED FOR MANUFACTURING PURPOSES WITHOUT WRITTEN PERMISSION FROM AMPHENOL CANADA CORP.

UNLESS SPECIFIED OTHERWISE PRIMARY UNITS MILLIMETERS SECONDARY INCHES REFERENCE IN PARENTHESES GENERAL TOLERANCES 1 DECIMAL PLACE 2 DECIMAL PLACES 3 DECIMAL PLACES ANGULAR DEGREES	DRAWN EDWIN Q.	NOV30/20	<b>Amphenol Canada Corp.</b> Commercial Products	
	CHECKED			
	M.E. APP'D		UE25 SERIES UNIVERSAL SERIAL BUS MINI-B RECEPTACLE, VERTICAL PCB TAIL, TAPE & REEL PACKAGING, RoHS COMPLIANT	
	Q.A. APP'D			
THIRD ANGLE PROJECTION	DWG APP'D K.LAMBIE	NOV30/20	DWG NO. P-UE25-BE55-10CTR	
	ENG. REL. NO. EAR 14908			
REF.			REV A	
DO NOT SCALE DRAWING			CODE ID NO. 03554   DWG SIZE X   SCALE XX:1   SHEET 1 OF 2	

REV		DESCRIPTION, ECN, EAR NO.	DATE	APP'D
A		PROPOSAL DRAWING (EAR 14908)	NOV30/20	K.L.

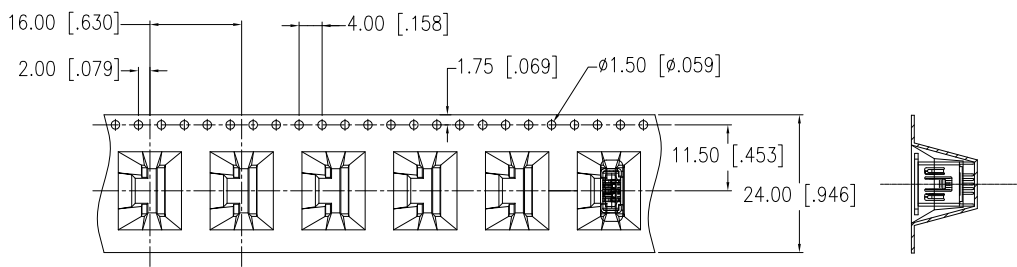

TAPE & REEL LAYOUT

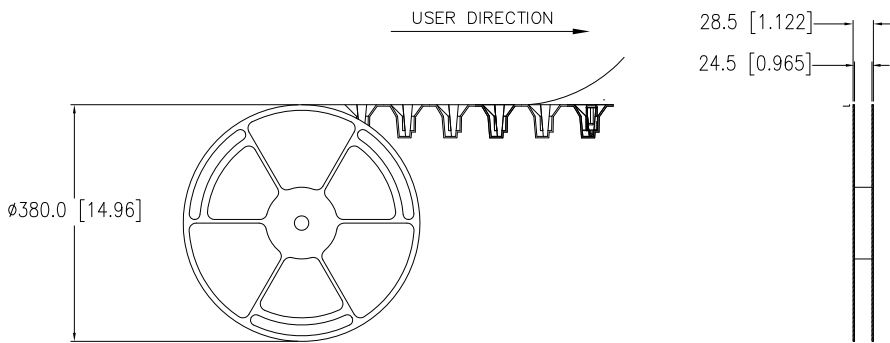
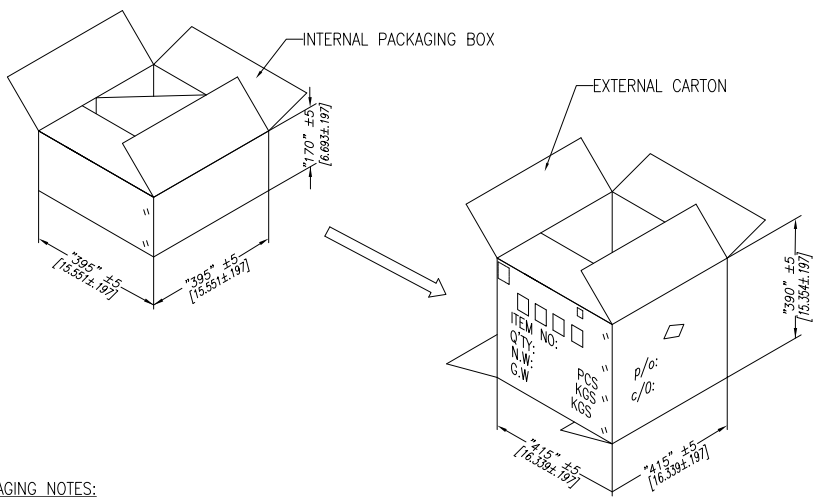
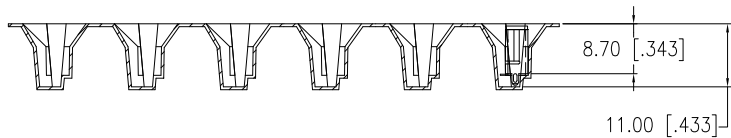

PACKAGING NOTES:

- ONE REEL SHALL HOLD 500 CONNECTORS.
- 30 EMPTY CAVITIES AT THE BEGINNING OF CARRIER AND 15 EMPTY CAVITIES AT THE END OF CARRIER.
- EACH FULLY LOADED BOX SHALL CONTAIN 5 REELS (2500 CONNECTORS).
- FULLY LOADED CARTON WILL CONTAIN 2 PACKAGING BOXES FOR A TOTAL OF 5000 CONNECTORS.
- APPROXIMATE CARTON SIZE: 415 [16.34] SQ. X 390 [15.36].

THIS DOCUMENT CONTAINS PROPRIETARY INFORMATION AND SUCH INFORMATION MAY NOT BE DISCLOSED TO OTHERS FOR ANY PURPOSE OR USED FOR MANUFACTURING PURPOSES WITHOUT WRITTEN PERMISSION FROM AMPHENOL CANADA CORP.

UNLESS SPECIFIED OTHERWISE	DRAWN	EDWIN.Q	NOV30/20	<b>Amphenol Canada Corp.</b> Commercial Products	
PRIMARY UNITS MILLIMETERS	CHECKED				
SECONDARY INCHES	M.E. APP'D			UE25 SERIES UNIVERSAL SERIAL BUS MINI-B RECEPTACLE, VERTICAL PCB TAIL, TAPE & REEL PACKAGING, RoHS COMPLIANT	
REFERENCE IN PARENTHESES	Q.A. APP'D				
GENERAL TOLERANCES	DWG APP'D	K.LAMBIE	NOV30/20	DWG NO. P-UE25-BE55-10CTR	
1 DECIMAL PLACE	ENG. REL. NO.	EAR 14908			
2 DECIMAL PLACES	REF.			REV A	
3 DECIMAL PLACES	THIRD ANGLE PROJECTION				
ANGULAR DEGREES	DO NOT SCALE DRAWING			CODE ID NO. 03554   DWG SIZE X   SCALE XX:1   SHEET 2 OF 2	