

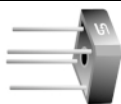

SB801 THRU SB807

Single Phase 8.0 AMPS. Silicon Bridge Rectifiers



Voltage Range
50 to 1000 Volts
Current
8.0 Amperes

SB-10

Features

- ✧ UL Recognized File # E-96005
- ✧ Surge overload rating 250 amperes peak
- ✧ Low forward voltage drop
- ✧ High temperature soldering guaranteed:
250°C / 10 seconds / 0.375" (9.5mm)
lead length at 5 lbs., (2.3 kg) tension
- ✧ Small size, simple installation
- ✧ Leads solderable per MIL-STD-202
Method 208

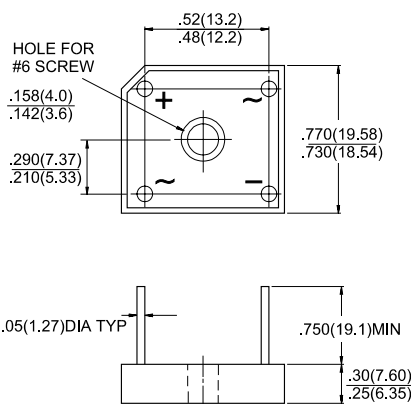

Dimensions in inches and (millimeters)

Maximum Ratings and Electrical Characteristics

Rating at 25°C ambient temperature unless otherwise specified.

Single phase, half wave, 60 Hz, resistive or inductive load.

For capacitive load, derate current by 20%

Type Number	SB801	SB802	SB803	SB804	SB805	SB806	SB807	Units
Maximum Recurrent Peak Reverse Voltage	50	100	200	400	600	800	1000	V
Maximum RMS Voltage	35	70	140	280	420	560	700	V
Maximum DC Blocking Voltage	50	100	200	400	600	800	1000	V
Maximum Average Forward Rectified Current @ T _A = 50°C	8.0							A
Peak Forward Surge Current, 8.3 ms Single Half Sine-wave Superimposed on Rated Load (JEDEC method)	250							A
Maximum Instantaneous Forward Voltage @ 4.0A	1.0							V
Maximum DC Reverse Current @ T _A =25°C at Rated DC Blocking Voltage @ T _A =100°C	10 500							μA μA
Typical Thermal Resistance (Note) R _{θJC}	6							°C
Operating Temperature Range T _J	-55 to +125							°C
Storage Temperature Range T _{STG}	-55 to +150							°C

Note: Thermal Resistance from Junction to Case Mounted on 5.5 x 6.0 x 0.11" thick (14 x 15 x 0.3cm)
Al. Plate.

RATINGS AND CHARACTERISTIC CURVES (SB801 THRU SB807)

FIG.1- MAXIMUM NON-REPETITIVE FORWARD SURGE CURRENT PER BRIDGE ELEMENT

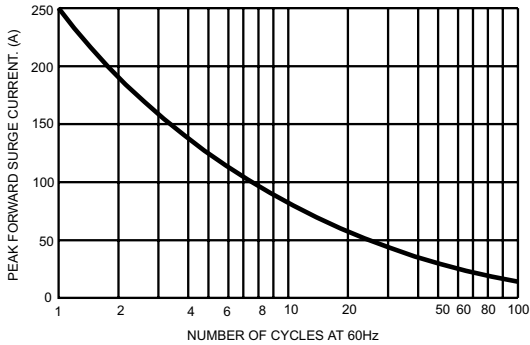

FIG.2- MAXIMUM FORWARD CURRENT DERATING CURVE

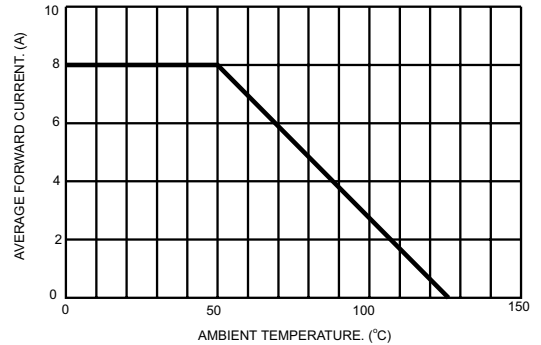

FIG.3- TYPICAL INSTANTANEOUS FORWARD CHARACTERISTICS PER BRIDGE ELEMENT

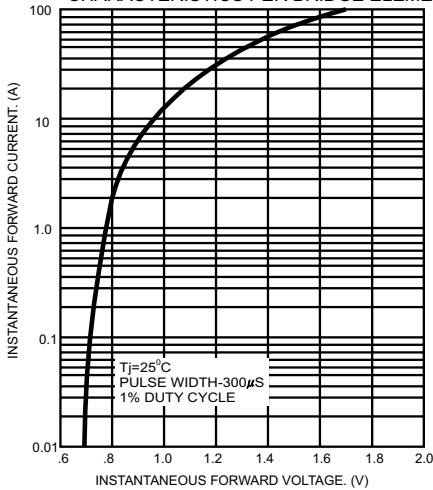

FIG.4- TYPICAL REVERSE CHARACTERISTICS PER BRIDGE ELEMENT

