



MULTICOMP PRO

Pushbutton Switches

Sub-miniature Sealed Pushbutton switches
for a wide range of applications

farnell.com/multicomp-pro

The Engineer's
Choice

multicomp PRO

About us

/ Our brands

A network of over 3,300 employees, 60 offices, 8 distribution centres, 5 brands and 3 stores.

We are committed to providing you with dedicated support at every stage of your design journey. from prototyping, through production to repair and maintenance – we will work with you to deliver tailored support based on the needs of your project.

We have five key brands within our network, operating across the world that give you access to a global inventory, leading technical support and bespoke services.



With over 80 years in high-service electronics components distribution, Farnell's global businesses distribute a comprehensive portfolio of products, supported by an international supply chain and an inventory profile developed to anticipate and meet its customers' needs.

Experience working with the largest manufacturers designing and manufacturing development kits and boards provides customers of all sizes with experience which can be applied at any stage to accelerate time to market – from research and design support, to prototype and test right through to production services.

This extensive range of products and services is delivered by 3,300 employees in 60 countries as [Farnell](#) in EMEA, [Newark](#) in North America and [element14](#) in Asia Pacific. Consumers in the UK can purchase from its CPC business. Farnell has over 950,000 products in stock covering 2,000 manufacturer brands and supplying over two million customer contacts in more than 150 global industries.

We have 9 distribution centres across the world, local transactional websites in 46 countries and a dedicated community of over 750,000 engineers.

As part of [Avnet](#) since October 2016, customers can now also access the latest products in stock from across Avnet.

Farnell is also a global leader in legislation including RoHS, WEEE and REACH

/ Our online stores

Europe, Middle East & Africa

Americas

Asia Pacific



The Engineer's Choice

multicomp PRO

Easy access to Product information

- Up-to-date Datasheets
- Embedded Product selectors to quickly find your desired needs
- Accurate product images and technical descriptions
- Certified products
- Attached Operating and Programming manuals
- Free product delivery on the next business day

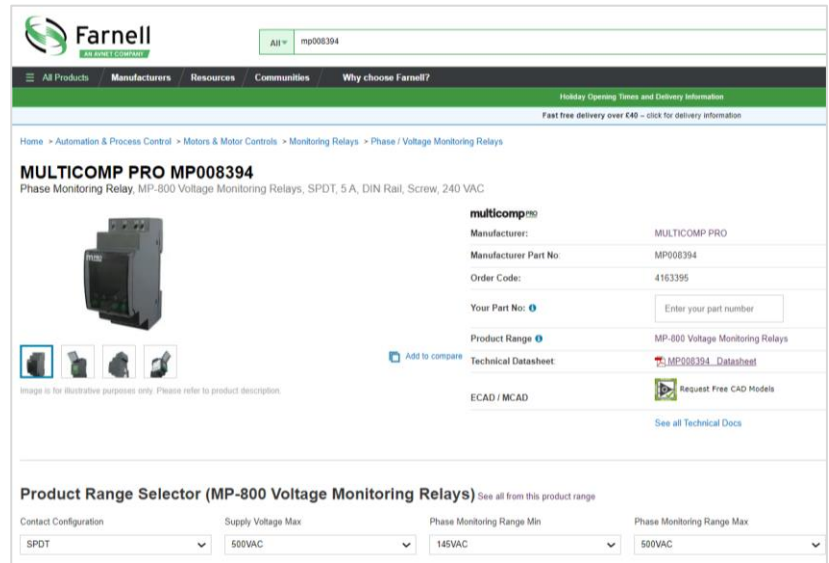

Explore your Industrial needs

- All your Industrial needs in one place at the best price
- Our segmented classification system makes it easy to find the right product quickly and hassle-free
- 24/5 Technical support available for all product related queries

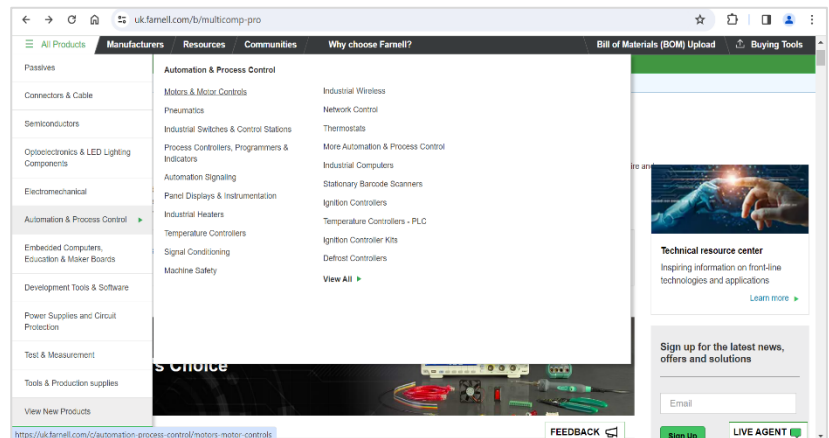

MULTICOMP PRO

Developed by our engineers for engineers like you. Multicomp Pro products and components have been designed to meet the quality standards and the value you need.

- **Quality** - 97% would "recommend to a colleague"
- **Value** - Savings now and over the life of the product
- **Range** - Over 50K products for engineers, technicians and production facilities



The Engineer's
Choice

multicomp PRO

General Contents

Pushbutton Switches

Product Range	<i>page 1</i>
Round Flat Pushbutton Switches	<i>page 2</i>
Round Domed Pushbutton Switches	<i>page 3</i>
High Raised Pushbutton Switches	<i>page 4</i>
Technical Data	<i>page 5</i>
Switch Function	<i>page 5</i>
Mounting	<i>page 6</i>
Hardware	<i>page 6</i>
Wire Options	<i>page 7</i>
Terminal Options	<i>page 8</i>
Selection Guide	<i>page 9</i>
Reference Index	<i>page 10</i>

Pushbutton Switches

Product Range

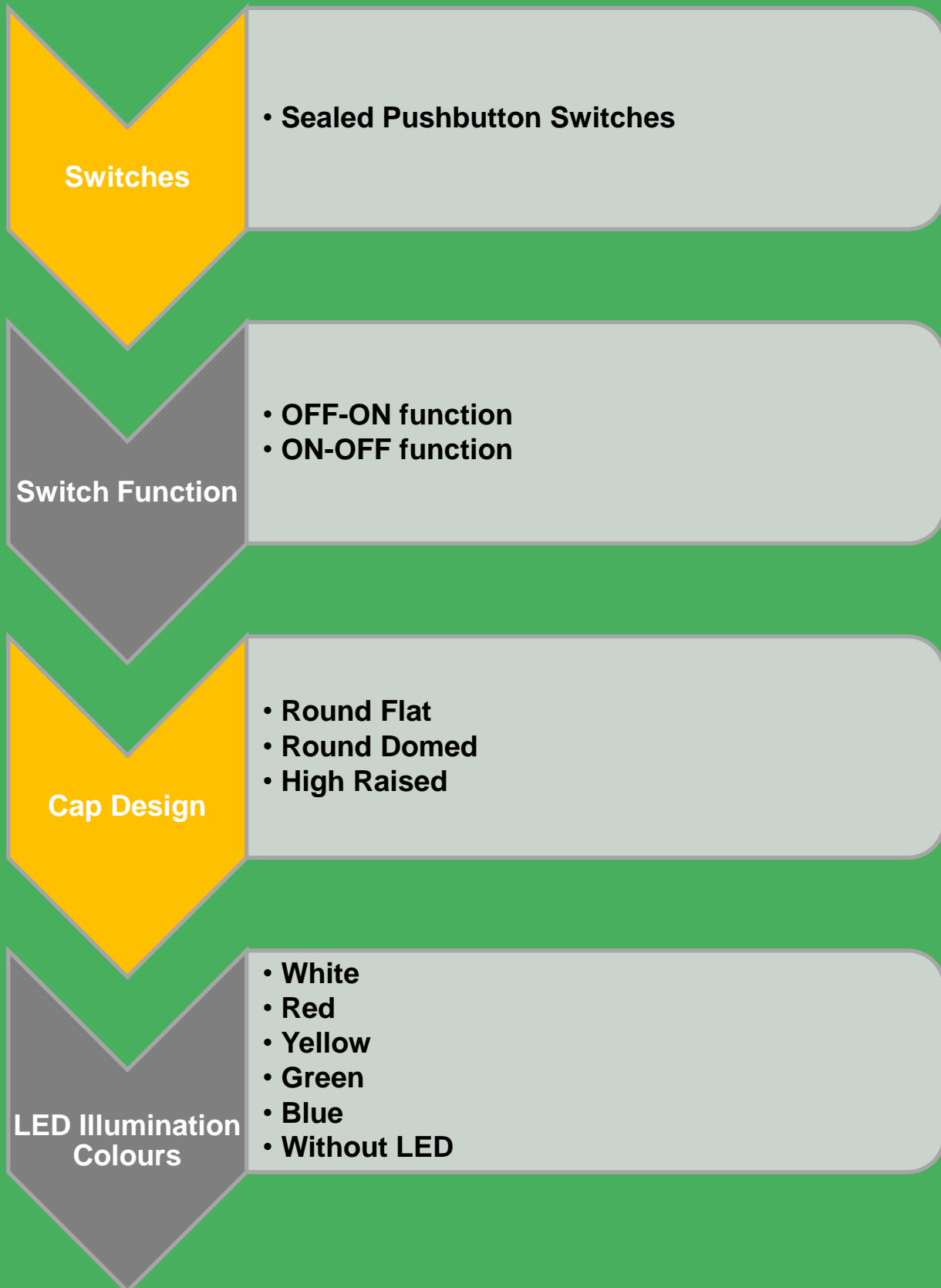

Round Flat Pushbutton Switches



- Momentary (Normally Open and Normally Closed) type Pushbutton Switches
- SPST contact configuration
- 4 Terminal Options available (Solder lug & Through hole)
- Wide operating temperature range for diverse industrial usage and demanding conditions
- Applications include instrumentation, automotive controls, machinery, industrial control panels, consumer electronics and appliances
- Illuminated and Non-illuminated pushbutton switches
- LED Colours include White, Red, Yellow, Green and Blue
- 5 Cap colour options available
- Easy Panel mount options
- Standard hardware includes 1 nut, 1 O-ring, 1 lock washer
- IP68 dust and waterproof products

MULTICOMP PRO Industrial Pushbutton switches are certified as per IP68 standards offering superior protection

Round Domed Pushbutton Switches



- Momentary (Normally Open and Normally Closed) type Pushbutton Switches
- SPST contact configuration
- 4 Terminal Options available (Solder lug & Through hole)
- Wide operating temperature range
- Applications include industrial control panels, automotive control, machinery, appliances, consumer electronics and instrumentation
- Non-illuminated pushbutton switches
- 5 Cap colour options available with long electrical and mechanical life
- Easy Panel mount options
- Standard hardware includes 1 nut, 1 O-ring, 1 lock washer
- IP68 dust and waterproof products that comply with industry standards and regulations

Exceptional electrical properties and operating reliably in demanding environments across a wide range of applications

High Raised Pushbutton Switches









- Momentary (Normally Open and Normally Closed) type Pushbutton Switches
- SPST contact configuration
- 4 Terminal Options available (Solder lug & Through hole)
- Wide operating temperature range
- Wide range of applications including industrial control panels, automotive controls, machinery, appliances, and instrumentation
- Non-illuminated pushbutton switches
- 5 Cap colour options available with long electrical and mechanical life
- Easy Panel mount options
- Standard hardware includes 1 nut, 1 O-ring, 1 lock washer
- IP68 dust and waterproof products that comply with industry standards and regulations

Explore our wide range of MULTICOMP PRO Switches at farnell.com/c/switches-relays/switches?brand=multicomp-pro

Technical Data

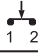
Switch Function

NO. POLES	MODEL NO.	SWITCH FUNCTION		CONNECTED TERMINALS / SCHEMATIC	
		POS.1	POS.2	POS.1	POS.2
					
SP	MPP12-6	OFF	(ON)	OPEN 	CLOSE 
SP	MPP12-7	ON	(OFF)	CLOSE 	OPEN 

()=MOMENTARY

Cap design

Round Flat

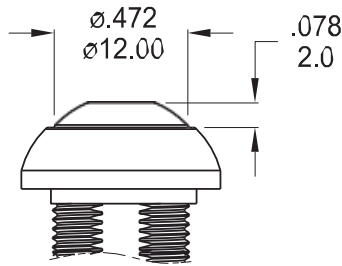

Round Domed

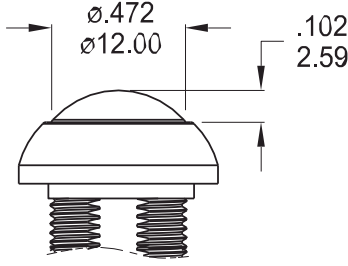

High Raised

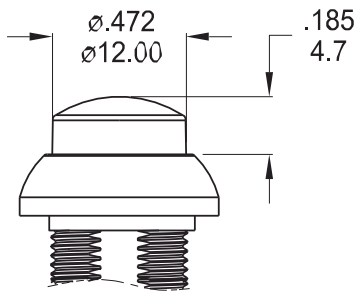

Rubber Hood

Transparent rubber hood (Std.)



Black rubber hood

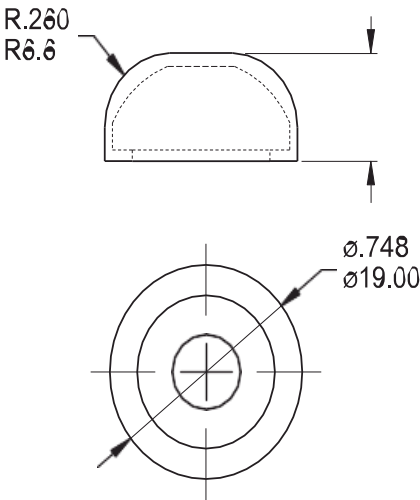

Technical Data

Panel Mounting

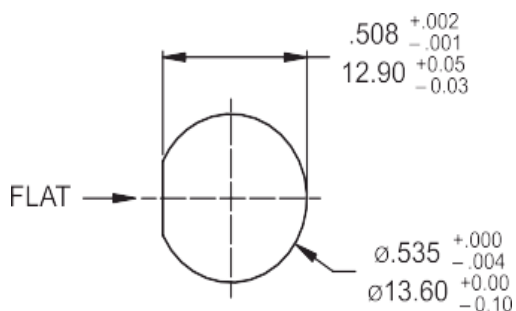

Panel thickness:
1.5 mm (.059inch) min. -4 mm (.157inch) max.

Dimensions: Millimetres

Dimensions

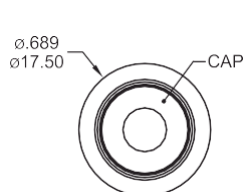

Dimensions: Millimetres

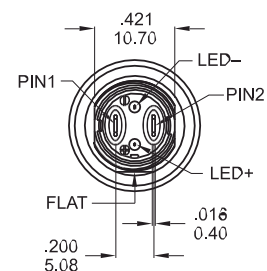
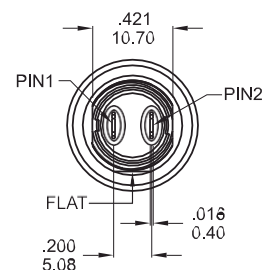
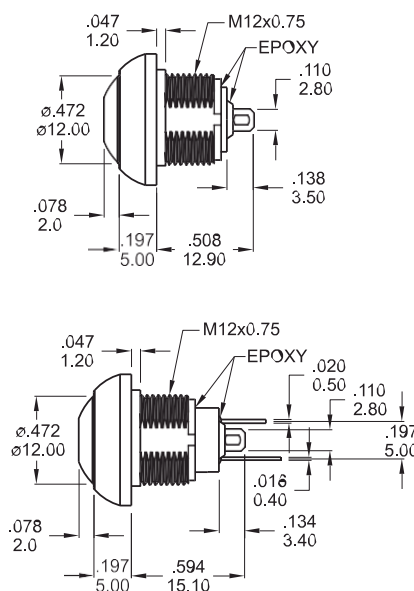
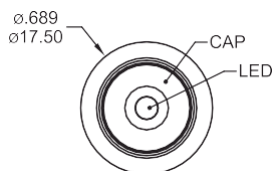

Hardware

- * Standard hardware: 1 nut, 1 O-ring, 1 lock washer
- * For further information please consult sales representative.

NUT (Std.)

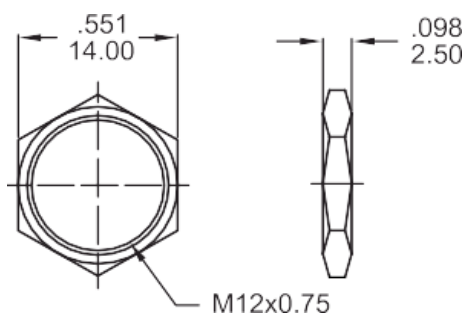

Lockwasher (Std.)

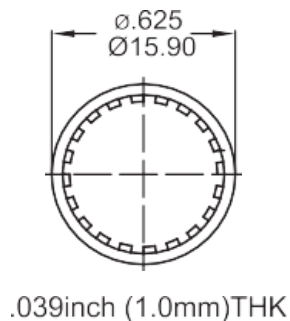

O-Ring (Std.)

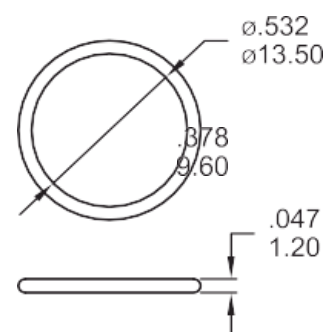

Technical Data

Wire Options

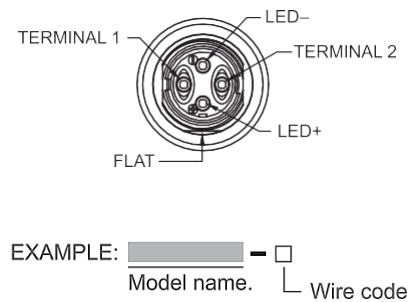
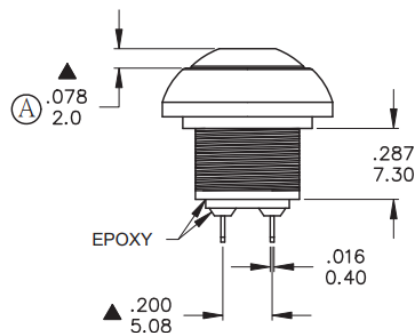
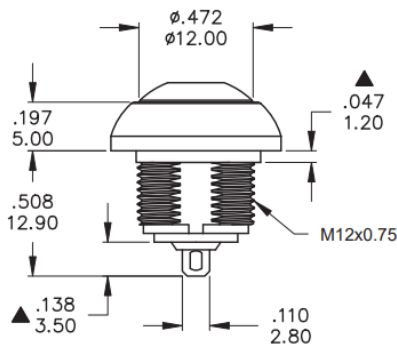

MPN - (no suffix) models

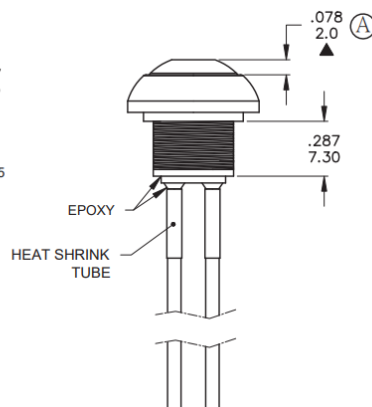
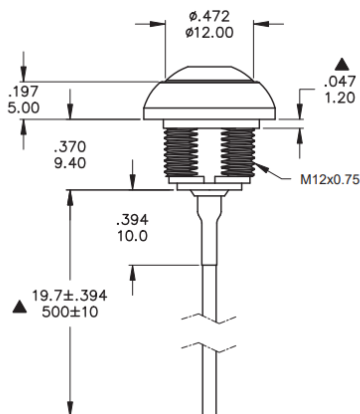

MPN - Y001 models

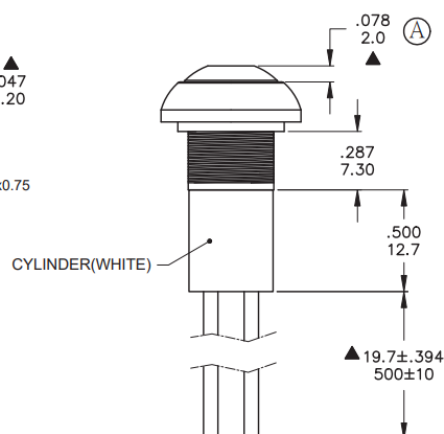
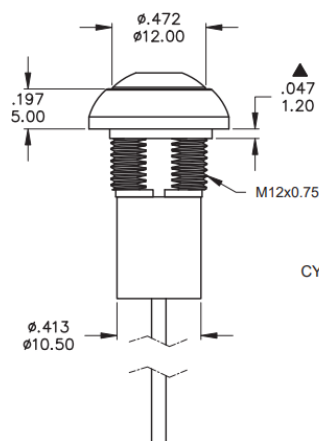

MPN - S001 models

Technical Data

Terminal Options

M1 Solder lug (STD)

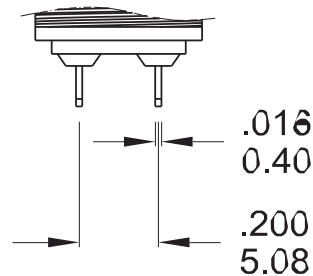
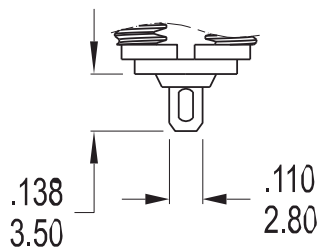

M2 Solder lug

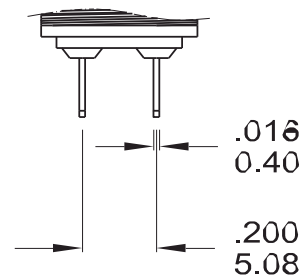
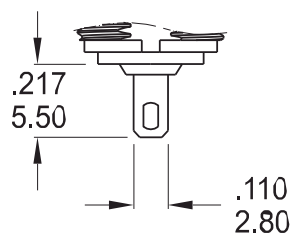

M3 Solder lug

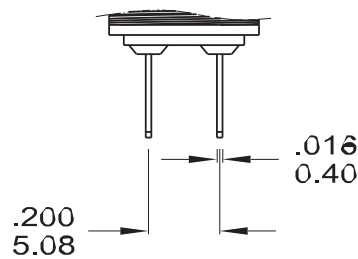
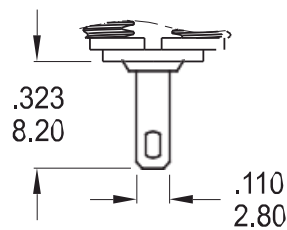

M4 PC Thru-hole

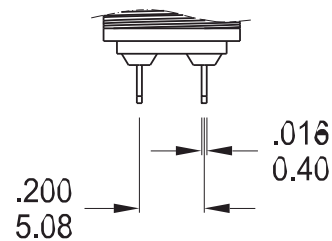
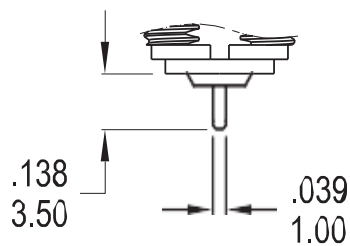

Diagram

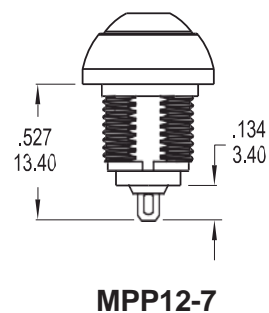
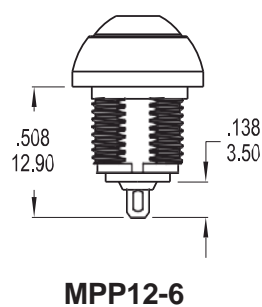

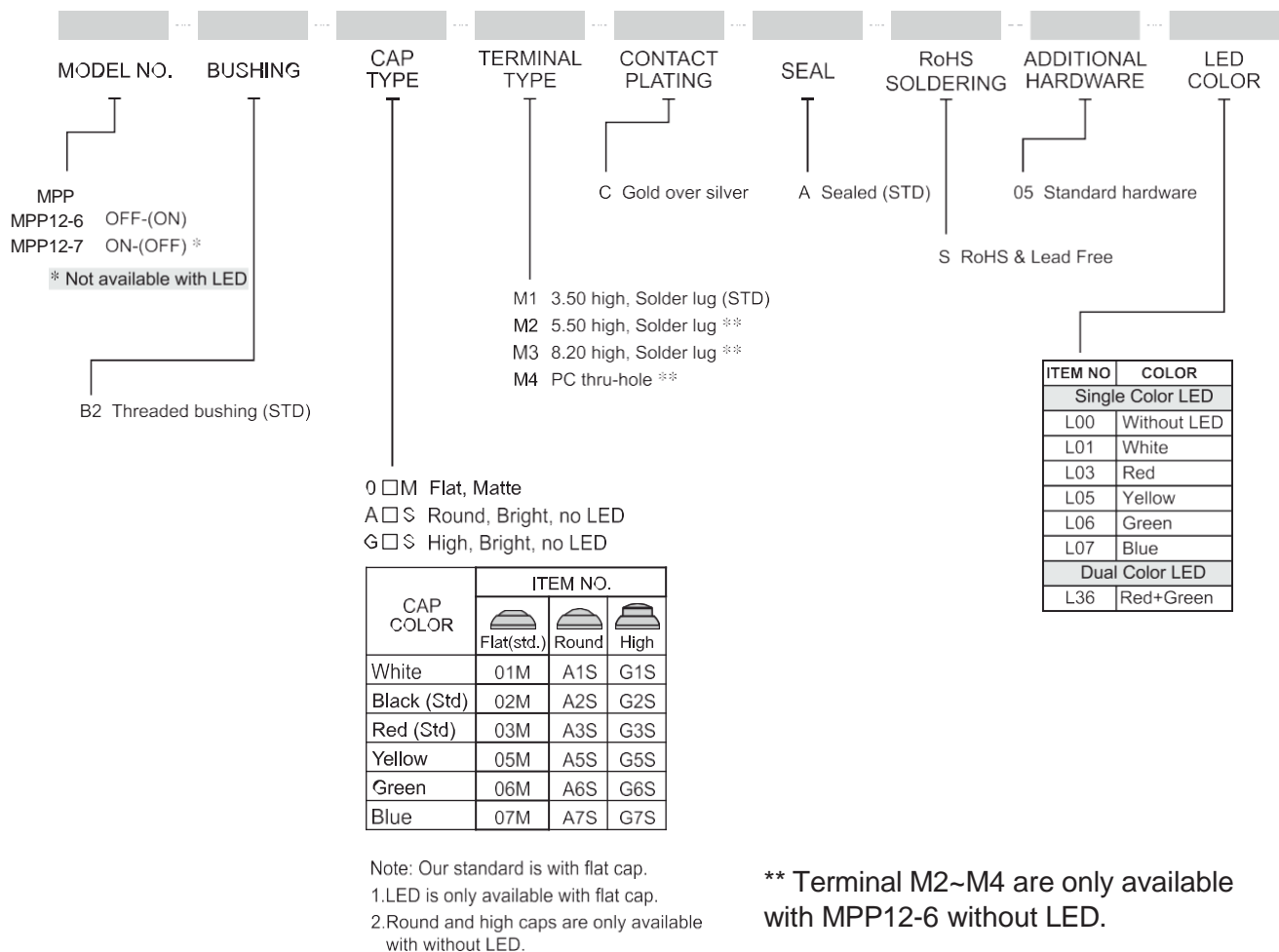

Product Selection Guide

Switches Selection



Example
MPP12-6 B2 M1CAS05L00
MPP12-7 B2 M1CAS05L00

Wiring Selection

EXAMPLE:  - 
Model name. Wire code

Example
MPN - Y001
MPN - S001

On-Off Round Flat Switches

Ordering Information

Description	Part number
Pushbutton Switch, On-Off, W/O LED	MPP12-7B202MM1CAS05L00
Pushbutton Switch, On-Off, W/O LED	MPP12-7B202MM1CAS05L00-Y001
Pushbutton Switch, On-Off, W/O LED	MPP12-7B203MM1CAS05L00
Pushbutton Switch, On-Off, W/O LED	MPP12-7B203MM1CAS05L00-Y001
Pushbutton Switch, On-Off, W/O LED	MPP12-7B205MM1CAS05L00
Pushbutton Switch, On-Off, W/O LED	MPP12-7B205MM1CAS05L00-Y001
Pushbutton Switch, On-Off, W/O LED	MPP12-7B206MM1CAS05L00
Pushbutton Switch, On-Off, W/O LED	MPP12-7B206MM1CAS05L00-Y001
Pushbutton Switch, On-Off, W/O LED	MPP12-7B207MM1CAS05L00
Pushbutton Switch, On-Off, W/O LED	MPP12-7B207MM1CAS05L00-Y001

On-Off Round Domed Switches

Ordering Information

Description	Part number
Pushbutton Switch, On-Off, W/O LED	MPP12-7B2A2SM1CAS05L00
Pushbutton Switch, On-Off, W/O LED	MPP12-7B2A2SM1CAS05L00-Y001
Pushbutton Switch, On-Off, W/O LED	MPP12-7B2A3SM1CAS05L00
Pushbutton Switch, On-Off, W/O LED	MPP12-7B2A3SM1CAS05L00-Y001
Pushbutton Switch, On-Off, W/O LED	MPP12-7B2A5SM1CAS05L00
Pushbutton Switch, On-Off, W/O LED	MPP12-7B2A5SM1CAS05L00-Y001
Pushbutton Switch, On-Off, W/O LED	MPP12-7B2A6SM1CAS05L00
Pushbutton Switch, On-Off, W/O LED	MPP12-7B2A6SM1CAS05L00-Y001
Pushbutton Switch, On-Off, W/O LED	MPP12-7B2A7SM1CAS05L00
Pushbutton Switch, On-Off, W/O LED	MPP12-7B2A7SM1CAS05L00-Y001

On-Off High Raised Switches

Ordering Information

Description	Part number
Pushbutton Switch, On-Off, W/O LED	MPP12-7B2G2SM1CAS05L00
Pushbutton Switch, On-Off, W/O LED	MPP12-7B2G2SM1CAS05L00-Y001
Pushbutton Switch, On-Off, W/O LED	MPP12-7B2G3SM1CAS05L00
Pushbutton Switch, On-Off, W/O LED	MPP12-7B2G3SM1CAS05L00-Y001
Pushbutton Switch, On-Off, W/O LED	MPP12-7B2G5SM1CAS05L00
Pushbutton Switch, On-Off, W/O LED	MPP12-7B2G5SM1CAS05L00-Y001
Pushbutton Switch, On-Off, W/O LED	MPP12-7B2G6SM1CAS05L00
Pushbutton Switch, On-Off, W/O LED	MPP12-7B2G6SM1CAS05L00-Y001
Pushbutton Switch, On-Off, W/O LED	MPP12-7B2G7SM1CAS05L00
Pushbutton Switch, On-Off, W/O LED	MPP12-7B2G7SM1CAS05L00-Y001

Off-On Round Flat Switches

Ordering Information

Description	Part Number
Pushbutton Switch, Off-On, W/O LED	MPP12-6B202MM1CAS05L00
Pushbutton Switch, Off-On, W/O LED	MPP12-6B202MM1CAS05L00-S001
Pushbutton Switch, Off-On, W/O LED	MPP12-6B202MM1CAS05L00-Y001
Pushbutton Switch, Off-On, White LED	MPP12-6B202MM1CAS05L01
Pushbutton Switch, Off-On, White LED	MPP12-6B202MM1CAS05L01-S001
Pushbutton Switch, Off-On, White LED	MPP12-6B202MM1CAS05L01-Y001
Pushbutton Switch, Off-On, Red LED	MPP12-6B202MM1CAS05L03
Pushbutton Switch, Off-On, Red LED	MPP12-6B202MM1CAS05L03-S001
Pushbutton Switch, Off-On, Red LED	MPP12-6B202MM1CAS05L03-Y001
Pushbutton Switch, Off-On, Yellow LED	MPP12-6B202MM1CAS05L05
Pushbutton Switch, Off-On, Yellow LED	MPP12-6B202MM1CAS05L05-S001
Pushbutton Switch, Off-On, Yellow LED	MPP12-6B202MM1CAS05L05-Y001
Pushbutton Switch, Off-On, Green LED	MPP12-6B202MM1CAS05L06
Pushbutton Switch, Off-On, Green LED	MPP12-6B202MM1CAS05L06-S001
Pushbutton Switch, Off-On, Green LED	MPP12-6B202MM1CAS05L06-Y001
Pushbutton Switch, Off-On, Blue LED	MPP12-6B202MM1CAS05L07
Pushbutton Switch, Off-On, Blue LED	MPP12-6B202MM1CAS05L07-S001
Pushbutton Switch, Off-On, Blue LED	MPP12-6B202MM1CAS05L07-Y001
Pushbutton Switch, Off-On, W/O LED	MPP12-6B202MM2CAS05L00
Pushbutton Switch, Off-On, W/O LED	MPP12-6B202MM3CAS05L00
Pushbutton Switch, Off-On, W/O LED	MPP12-6B202MM4CAS05L00
Pushbutton Switch, Off-On, W/O LED	MPP12-6B203MM1CAS05L00
Pushbutton Switch, Off-On, W/O LED	MPP12-6B203MM1CAS05L00-S001
Pushbutton Switch, Off-On, W/O LED	MPP12-6B203MM1CAS05L00-Y001
Pushbutton Switch, Off-On, White LED	MPP12-6B203MM1CAS05L01
Pushbutton Switch, Off-On, White LED	MPP12-6B203MM1CAS05L01-S001
Pushbutton Switch, Off-On, White LED	MPP12-6B203MM1CAS05L01-Y001
Pushbutton Switch, Off-On, Red LED	MPP12-6B203MM1CAS05L03
Pushbutton Switch, Off-On, Red LED	MPP12-6B203MM1CAS05L03-S001
Pushbutton Switch, Off-On, Red LED	MPP12-6B203MM1CAS05L03-Y001

Off-On Round Flat Switches

Pushbutton Switch, Off-On, Yellow LED	MPP12-6B203MM1CAS05L05
Pushbutton Switch, Off-On, Yellow LED	MPP12-6B203MM1CAS05L05-S001
Pushbutton Switch, Off-On, Yellow LED	MPP12-6B203MM1CAS05L05-Y001
Pushbutton Switch, Off-On, Green LED	MPP12-6B203MM1CAS05L06
Pushbutton Switch, Off-On, Green LED	MPP12-6B203MM1CAS05L06-S001
Pushbutton Switch, Off-On, Green LED	MPP12-6B203MM1CAS05L06-Y001
Pushbutton Switch, Off-On, Blue LED	MPP12-6B203MM1CAS05L07
Pushbutton Switch, Off-On, Blue LED	MPP12-6B203MM1CAS05L07-S001
Pushbutton Switch, Off-On, Blue LED	MPP12-6B203MM1CAS05L07-Y001
Pushbutton Switch, Off-On, W/O LED	MPP12-6B203MM2CAS05L00
Pushbutton Switch, Off-On, W/O LED	MPP12-6B203MM3CAS05L00
Pushbutton Switch, Off-On, W/O LED	MPP12-6B203MM4CAS05L00
Pushbutton Switch, Off-On, W/O LED	MPP12-6B205MM1CAS05L00
Pushbutton Switch, Off-On, W/O LED	MPP12-6B205MM1CAS05L00-S001
Pushbutton Switch, Off-On, W/O LED	MPP12-6B205MM1CAS05L00-Y001
Pushbutton Switch, Off-On, White LED	MPP12-6B205MM1CAS05L01
Pushbutton Switch, Off-On, White LED	MPP12-6B205MM1CAS05L01-S001
Pushbutton Switch, Off-On, White LED	MPP12-6B205MM1CAS05L01-Y001
Pushbutton Switch, Off-On, Red LED	MPP12-6B205MM1CAS05L03
Pushbutton Switch, Off-On, Red LED	MPP12-6B205MM1CAS05L03-S001
Pushbutton Switch, Off-On, Red LED	MPP12-6B205MM1CAS05L03-Y001
Pushbutton Switch, Off-On, Yellow LED	MPP12-6B205MM1CAS05L05
Pushbutton Switch, Off-On, Yellow LED	MPP12-6B205MM1CAS05L05-S001
Pushbutton Switch, Off-On, Yellow LED	MPP12-6B205MM1CAS05L05-Y001
Pushbutton Switch, Off-On, Green LED	MPP12-6B205MM1CAS05L06
Pushbutton Switch, Off-On, Green LED	MPP12-6B205MM1CAS05L06-S001
Pushbutton Switch, Off-On, Green LED	MPP12-6B205MM1CAS05L06-Y001
Pushbutton Switch, Off-On, Blue LED	MPP12-6B205MM1CAS05L07
Pushbutton Switch, Off-On, Blue LED	MPP12-6B205MM1CAS05L07-S001
Pushbutton Switch, Off-On, Blue LED	MPP12-6B205MM1CAS05L07-Y001
Pushbutton Switch, Off-On, W/O LED	MPP12-6B205MM2CAS05L00
Pushbutton Switch, Off-On, W/O LED	MPP12-6B205MM3CAS05L00
Pushbutton Switch, Off-On, W/O LED	MPP12-6B205MM4CAS05L00
Pushbutton Switch, Off-On, W/O LED	MPP12-6B206MM1CAS05L00
Pushbutton Switch, Off-On, W/O LED	MPP12-6B206MM1CAS05L00-S001
Pushbutton Switch, Off-On, W/O LED	MPP12-6B206MM1CAS05L00-Y001
Pushbutton Switch, Off-On, White LED	MPP12-6B206MM1CAS05L01
Pushbutton Switch, Off-On, White LED	MPP12-6B206MM1CAS05L01-S001
Pushbutton Switch, Off-On, White LED	MPP12-6B206MM1CAS05L01-Y001

Off-On Round Flat Switches

Pushbutton Switch, Off-On, Red LED	MPP12-6B206MM1CAS05L03
Pushbutton Switch, Off-On, Red LED	MPP12-6B206MM1CAS05L03-S001
Pushbutton Switch, Off-On, Red LED	MPP12-6B206MM1CAS05L03-Y001
Pushbutton Switch, Off-On, Yellow LED	MPP12-6B206MM1CAS05L05
Pushbutton Switch, Off-On, Yellow LED	MPP12-6B206MM1CAS05L05-S001
Pushbutton Switch, Off-On, Yellow LED	MPP12-6B206MM1CAS05L05-Y001
Pushbutton Switch, Off-On, Green LED	MPP12-6B206MM1CAS05L06
Pushbutton Switch, Off-On, Green LED	MPP12-6B206MM1CAS05L06-S001
Pushbutton Switch, Off-On, Green LED	MPP12-6B206MM1CAS05L06-Y001
Pushbutton Switch, Off-On, Blue LED	MPP12-6B206MM1CAS05L07
Pushbutton Switch, Off-On, Blue LED	MPP12-6B206MM1CAS05L07-S001
Pushbutton Switch, Off-On, Blue LED	MPP12-6B206MM1CAS05L07-Y001
Pushbutton Switch, Off-On, W/O LED	MPP12-6B206MM2CAS05L00
Pushbutton Switch, Off-On, W/O LED	MPP12-6B206MM3CAS05L00
Pushbutton Switch, Off-On, W/O LED	MPP12-6B206MM4CAS05L00
Pushbutton Switch, Off-On, W/O LED	MPP12-6B207MM1CAS05L00
Pushbutton Switch, Off-On, W/O LED	MPP12-6B207MM1CAS05L00-S001
Pushbutton Switch, Off-On, W/O LED	MPP12-6B207MM1CAS05L00-Y001
Pushbutton Switch, Off-On, White LED	MPP12-6B207MM1CAS05L01
Pushbutton Switch, Off-On, White LED	MPP12-6B207MM1CAS05L01-S001
Pushbutton Switch, Off-On, White LED	MPP12-6B207MM1CAS05L01-Y001
Pushbutton Switch, Off-On, Red LED	MPP12-6B207MM1CAS05L03
Pushbutton Switch, Off-On, Red LED	MPP12-6B207MM1CAS05L03-S001
Pushbutton Switch, Off-On, Red LED	MPP12-6B207MM1CAS05L03-Y001
Pushbutton Switch, Off-On, Yellow LED	MPP12-6B207MM1CAS05L05
Pushbutton Switch, Off-On, Yellow LED	MPP12-6B207MM1CAS05L05-S001
Pushbutton Switch, Off-On, Yellow LED	MPP12-6B207MM1CAS05L05-Y001
Pushbutton Switch, Off-On, Green LED	MPP12-6B207MM1CAS05L06
Pushbutton Switch, Off-On, Green LED	MPP12-6B207MM1CAS05L06-S001
Pushbutton Switch, Off-On, Green LED	MPP12-6B207MM1CAS05L06-Y001
Pushbutton Switch, Off-On, Blue LED	MPP12-6B207MM1CAS05L07
Pushbutton Switch, Off-On, Blue LED	MPP12-6B207MM1CAS05L07-S001
Pushbutton Switch, Off-On, Blue LED	MPP12-6B207MM1CAS05L07-Y001
Pushbutton Switch, Off-On, W/O LED	MPP12-6B207MM2CAS05L00
Pushbutton Switch, Off-On, W/O LED	MPP12-6B207MM3CAS05L00
Pushbutton Switch, Off-On, W/O LED	MPP12-6B207MM4CAS05L00

Off-On Round Domed Switches

Ordering Information

Description	Part number
Pushbutton Switch, Off-On, W/O LED	MPP12-6B2A2SM1CAS05L00
Pushbutton Switch, Off-On, W/O LED	MPP12-6B2A2SM1CAS05L00-S001
Pushbutton Switch, Off-On, W/O LED	MPP12-6B2A2SM1CAS05L00-Y001
Pushbutton Switch, Off-On, W/O LED	MPP12-6B2A2SM2CAS05L00
Pushbutton Switch, Off-On, W/O LED	MPP12-6B2A2SM3CAS05L00
Pushbutton Switch, Off-On, W/O LED	MPP12-6B2A2SM4CAS05L00
Pushbutton Switch, Off-On, W/O LED	MPP12-6B2A3SM1CAS05L00
Pushbutton Switch, Off-On, W/O LED	MPP12-6B2A3SM1CAS05L00-S001
Pushbutton Switch, Off-On, W/O LED	MPP12-6B2A3SM1CAS05L00-Y001
Pushbutton Switch, Off-On, W/O LED	MPP12-6B2A3SM2CAS05L00
Pushbutton Switch, Off-On, W/O LED	MPP12-6B2A3SM3CAS05L00
Pushbutton Switch, Off-On, W/O LED	MPP12-6B2A3SM4CAS05L00
Pushbutton Switch, Off-On, W/O LED	MPP12-6B2A5SM1CAS05L00
Pushbutton Switch, Off-On, W/O LED	MPP12-6B2A5SM1CAS05L00-S001
Pushbutton Switch, Off-On, W/O LED	MPP12-6B2A5SM1CAS05L00-Y001
Pushbutton Switch, Off-On, W/O LED	MPP12-6B2A5SM2CAS05L00
Pushbutton Switch, Off-On, W/O LED	MPP12-6B2A5SM3CAS05L00
Pushbutton Switch, Off-On, W/O LED	MPP12-6B2A5SM4CAS05L00
Pushbutton Switch, Off-On, W/O LED	MPP12-6B2A6SM1CAS05L00
Pushbutton Switch, Off-On, W/O LED	MPP12-6B2A6SM1CAS05L00-S001
Pushbutton Switch, Off-On, W/O LED	MPP12-6B2A6SM1CAS05L00-Y001
Pushbutton Switch, Off-On, W/O LED	MPP12-6B2A6SM2CAS05L00
Pushbutton Switch, Off-On, W/O LED	MPP12-6B2A6SM3CAS05L00
Pushbutton Switch, Off-On, W/O LED	MPP12-6B2A6SM4CAS05L00
Pushbutton Switch, Off-On, W/O LED	MPP12-6B2A7SM1CAS05L00
Pushbutton Switch, Off-On, W/O LED	MPP12-6B2A7SM1CAS05L00-S001
Pushbutton Switch, Off-On, W/O LED	MPP12-6B2A7SM1CAS05L00-Y001
Pushbutton Switch, Off-On, W/O LED	MPP12-6B2A7SM2CAS05L00
Pushbutton Switch, Off-On, W/O LED	MPP12-6B2A7SM3CAS05L00
Pushbutton Switch, Off-On, W/O LED	MPP12-6B2A7SM4CAS05L00

Off-On High Raised Switches

Ordering Information

Description	Part number
Pushbutton Switch, Off-On, W/O LED	MPP12-6B2G2SM1CAS05L00
Pushbutton Switch, Off-On, W/O LED	MPP12-6B2G2SM1CAS05L00-S001
Pushbutton Switch, Off-On, W/O LED	MPP12-6B2G2SM1CAS05L00-Y001
Pushbutton Switch, Off-On, W/O LED	MPP12-6B2G2SM2CAS05L00
Pushbutton Switch, Off-On, W/O LED	MPP12-6B2G2SM3CAS05L00
Pushbutton Switch, Off-On, W/O LED	MPP12-6B2G2SM4CAS05L00
Pushbutton Switch, Off-On, W/O LED	MPP12-6B2G3SM1CAS05L00
Pushbutton Switch, Off-On, W/O LED	MPP12-6B2G3SM1CAS05L00-S001
Pushbutton Switch, Off-On, W/O LED	MPP12-6B2G3SM1CAS05L00-Y001
Pushbutton Switch, Off-On, W/O LED	MPP12-6B2G3SM2CAS05L00
Pushbutton Switch, Off-On, W/O LED	MPP12-6B2G3SM3CAS05L00
Pushbutton Switch, Off-On, W/O LED	MPP12-6B2G3SM4CAS05L00
Pushbutton Switch, Off-On, W/O LED	MPP12-6B2G5SM1CAS05L00
Pushbutton Switch, Off-On, W/O LED	MPP12-6B2G5SM1CAS05L00-S001
Pushbutton Switch, Off-On, W/O LED	MPP12-6B2G5SM1CAS05L00-Y001
Pushbutton Switch, Off-On, W/O LED	MPP12-6B2G5SM2CAS05L00
Pushbutton Switch, Off-On, W/O LED	MPP12-6B2G5SM3CAS05L00
Pushbutton Switch, Off-On, W/O LED	MPP12-6B2G5SM4CAS05L00
Pushbutton Switch, Off-On, W/O LED	MPP12-6B2G6SM1CAS05L00
Pushbutton Switch, Off-On, W/O LED	MPP12-6B2G6SM1CAS05L00-S001
Pushbutton Switch, Off-On, W/O LED	MPP12-6B2G6SM1CAS05L00-Y001
Pushbutton Switch, Off-On, W/O LED	MPP12-6B2G6SM2CAS05L00
Pushbutton Switch, Off-On, W/O LED	MPP12-6B2G6SM3CAS05L00
Pushbutton Switch, Off-On, W/O LED	MPP12-6B2G6SM4CAS05L00
Pushbutton Switch, Off-On, W/O LED	MPP12-6B2G7SM1CAS05L00
Pushbutton Switch, Off-On, W/O LED	MPP12-6B2G7SM1CAS05L00-S001
Pushbutton Switch, Off-On, W/O LED	MPP12-6B2G7SM1CAS05L00-Y001
Pushbutton Switch, Off-On, W/O LED	MPP12-6B2G7SM2CAS05L00
Pushbutton Switch, Off-On, W/O LED	MPP12-6B2G7SM3CAS05L00
Pushbutton Switch, Off-On, W/O LED	MPP12-6B2G7SM4CAS05L00

The Engineer's Choice

multicomp^{PRO}



Learn more about our products at
uk.farnell.com/c/switches-relays/switches

This catalogue and its contents (the "Information") belong to the members of the AVNET group of companies (the "Group") or are licensed to it. No licence is granted for the use of it other than for information purposes in connection with the products to which it relates. No licence of any intellectual property rights is granted. The Information is subject to change without notice and replaces all catalogues previously supplied. The Information supplied is believed to be accurate but the Group assumes no responsibility for its accuracy or completeness, any error in or omission from it or for any use made of it. Users of this data sheet should check for themselves the Information and the suitability of the products for their purpose and not make any assumptions based on information included or omitted. Liability for loss or damage resulting from any reliance on the Information or use of it (including liability resulting from negligence or where the Group was aware of the possibility of such loss or damage arising) is excluded. This will not operate to limit or restrict the Group's liability for death or personal injury resulting from its negligence. Multicomp Pro is the registered trademark of Premier Farnell Limited 2019.