



1 W DC- 3 GHz SMA COAXIAL ATTENUATOR

issue  
05. jun. 97

Page  
1 / 1

**DRAWING**

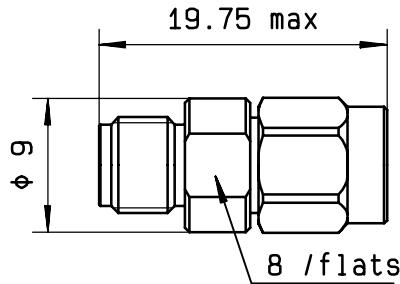

General tolerances: +/- 0.5 mm

**R F CHARACTERISTICS**

FREQUENCY RANGE : DC - 3 GHz  
 IMPEDANCE : 50 Ohms  
 ATTENUATION - NOMINAL : 20 dB

|                |             |             |
|----------------|-------------|-------------|
| FREQUENCY      | DC- 2 GHz   | 2 - 3 GHz   |
| V.S.W.R        | <= 1.20     | <= 1.30     |
| DEVIATION (dB) | +0.7 / -0.7 | +1.0 / -1.0 |

PEAK POWER at 25°C (1µs,1%\*) : 100 W  
 AVERAGE POWER at 25°C : 1 W

**MECHANICAL CHARACTERISTICS**

CONNECTORS : SMA male/female per MIL-C 39012  
 WEIGHT : < 5 g

**ENVIRONMENTAL CHARACTERISTICS**

OPERATING TEMPERATURE RANGE (°C) : -40 , +85  
 STORAGE TEMPERATURE RANGE (°C) : -40 , +85

Power derating  
Versus temperature

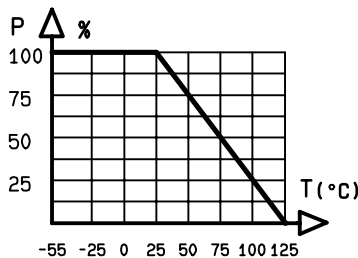

This information is given as an indication. In the continual goal to improve our products, we reserve the right to make any modifications judged necessary

4112-9212

|                 |              |  |             |              |
|-----------------|--------------|--|-------------|--------------|
| <b>CREATION</b> |              |  |             |              |
| N° :            |              |  |             |              |
| PEN/EP:EPH9403  | 05.jun.97    | Change of attenuation deviation (H97061) | JL          | VE           |
| Name:RP         | 08.sep.95    | Change of attenuation deviation          | RP          | VE           |
| Date:28.mar.95  | 29.jun.95    | Change of attenuation deviation          | RP          | VE           |
| APP.:VE         | <b>ISSUE</b> | <b>REVISIONS</b>                         | <b>NAME</b> | <b>APPR.</b> |

**RADIALL®**

101. rue P. Hoffmann -Z.I Ouest-  
 93116 ROSNY/BOIS Cedex-FRANCE  
 Phone :33(1)49353535  
 Fax :33(1)48546363  
 Tlx RADIA 235220F