

# 小形ハロゲン電球 / Miniature Halogen Lamps

## 携帯電灯用電球 / Flashlight Lamps 313-2213

タイプ番号 Type No.	電圧 Voltage (V)	電流又は ワット Current or Watts (A·W)	光束 Luminous flux (lm)	平均寿命 Ave. life (h)	ガラス球 Bulb	口金 Base	フィラメント 形状 Filament design- ation	光中心 距離 Light center length (mm)	最大全長 Max overall length (mm)	電球番号 Lamp No.	図番号 Fig. No.	電池個数/サイズ Battery Size/Qty
40125101	2.5	0.5A	12.0	50	T9	E10/12	C-6	16.5	29.0		8	2D
40128101	2.8	0.85A	35.0	10	T9	E10/12	C-6	16.5	29.0		8	2D
* 40128401	2.5	0.83A	23.0	25	T9	E10/12	C-6	16.5	29.0		8	2D
40148101	4.0	0.85A	60.0	25	T9	E10/12	C-6	16.5	29.0		8	3D
40155101	5.2	0.5A	46.0	20	T9	E10/12	C-6	16.5	29.0		8	4D
40158101	5.2	0.85A	83.0	25	T9	E10/12	C-6	16.5	29.0		8	4D
40225101	2.5	0.5A	12.0	50	T9	P13.5S	C-6	6.35	30.0	HPR56	9	2D
40228101	2.8	0.85A	35.0	10	T9	P13.5S	C-6	6.35	30.0	HPR52	9	2D
40228301	2.4	0.83A	18.5	40	T9	P13.5S	C-6	6.35	30.0		9	2D
40245202	4.8	0.5A	36.0	20	T9	P13.5S	C-6	6.35	30.0	HMP20	9	4D
40248102	4.0	0.85A	60.0	25	T9	P13.5S	C-6	6.35	30.0	HPR53	9	3D
40248202	4.8	0.85A	75.0	30	T9	P13.5S	C-6	6.35	30.0		9	4D
40258101	5.2	0.85A	83.0	25	T9	P13.5S	C-6	6.35	30.0	HPR50	9	4D
40259101	5.5	1.0A	93.0	40	T9	P13.5S	C-6	6.35	30.0	HPR36	9	5D
40267101	6.5	0.7A	90.0	25	T9	P13.5S	C-6	6.35	30.0	HPR51	9	5D
40278103	7.2	0.85A	120.0	40	T9	P13.5S	C-6	6.35	30.0		9	6D
40725101	2.5	0.5A	12.0	50	T5	G2.5	C-6	15.0	22.6		11	2D
40745101	4.8	0.5A	33.0	50	T5	G2.5	C-2R	15.0	22.5		11	4D

## 鉱山用ヘッドライト電球 / Miner's Head Light Lamps

40247201	4.0	0.75A	33.5	800	T9	P13.5S	C-6	6.55	30.0	HMP22	9	3D
40248102	4.0	1.0A	48.0	600	T9	P13.5S	C-6	6.55	30.0	HMP09	9	3D

## 自転車用電球 / Bicycle Lamps

40164101	6.0	2.4W	36.0	100	T9	E10/13	C-6	18.5	30.0		10	-
40165101	6.0	3W	46.0	100	T9	E10/13	C-6	18.5	30.0		10	-
40169101	6.0	6W	100.0	100	T9	E10/13	C-6	18.5	30.0		10	-

自転車用電球でバッテリー使用設計の場合は、携帯電灯用電球より選んで下さい。  
For battery-operated bicycle lamps, select from among the flashlight lamps.

## ビデオライト用電球 / Video Light Lamps

40765101	6.0	3W	45.0	100	T5	G2.5	C-2R	15.0	22.5		11	-
40468301	6.0	5W	85.0	100	T9	G4	C-2R	19.5	30.0		12	-
40469101	5.0	10W	201.0	100	T9	G4	C-6	19.5	30.0		12	-
40460202	6.0	15W	300.0	100	T9	G4	C-6	19.5	30.0		12	-
40494201	12.0	5W	95.0	100	T9	G4	C-2R	19.5	30.0		12	-
40498401	12.0	10W	200.0	100	T9	G4	C-2R	19.5	30.0		12	-

## 一般照明用 / General Lighting

40494102	12.0	5W	55.0	2000	T9	G4	C-2R	19.5	30.0		12	-
40498202	12.0	10W	135.0	2000	T9	G4	C-2R	19.5	30.0		12	-

口金 : IEC E10/13 = JIS E10/14 / Base: IEC E10/13 = JIS E10/14

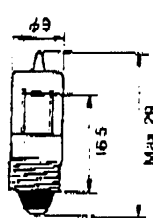

Fig. 8

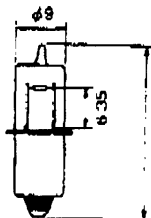

Fig. 9

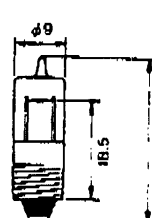

Fig. 10

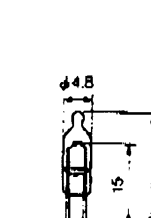

Fig. 11

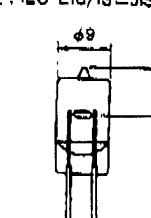

Fig. 12

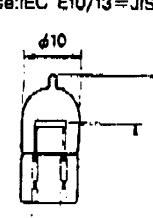

Fig. 13