

---

**ALPHA WIRE COMPANY  
CUSTOMER PRODUCT SPECIFICATION**

---

Part Number: SW40-SW45  
Page 1 of 3 Pages

Issue: 4  
Issue Date: 3/20/2007  
Effective Date: 4/20/2007

---

-NOTE: ALL DIMENSIONS ARE IN INCHES UNLESS OTHERWISE SPECIFIED-

CONSTRUCTION

Product	Spiral Wrap Tubing
Material	Ultraviolet Resistant Polyethylene, Black

PHYSICAL PROPERTIES

Appearance	Homogeneous Surface, Free From Pinholes, Defects, Cracks, Seams, Inclusions and Chemical Bloom
Dimensions	See Figure 1 and Table 1
Colors	Black
Temperature Rating, Continuous	-60°C to + 88°C
Tensile Strength	2000 psi

ELECTRICAL PROPERTIES

Abrasion Resistance (Taber)	20
-----------------------------	----

FLAMMABILITY

Flammability	Not Flame Rated
--------------	-----------------

FINISHED PRODUCT REQUIREMENTS

Product Print Legend	None
Standard Package	See Table 2
Length Tolerance	-0 / +1%
Multiple Length Spools	Maximum of 3 lengths per reel, 10 ft. minimum length of an individual piece
Governing Documents	MIL-I-631D, Type A MIL-P-21922B Fed Spec L-P-390C A-A-59602, Type 1

**ALPHA WIRE COMPANY  
CUSTOMER PRODUCT SPECIFICATION**

Part Number: SW40-SW45  
Page 2 of 3 Pages

Issue: 4  
Issue Date: 3/20/2007  
Effective Date: 4/20/2007

INCOMING INSPECTION CRITERIA

Physical Construction  
Packaging & Labeling  
Appearance

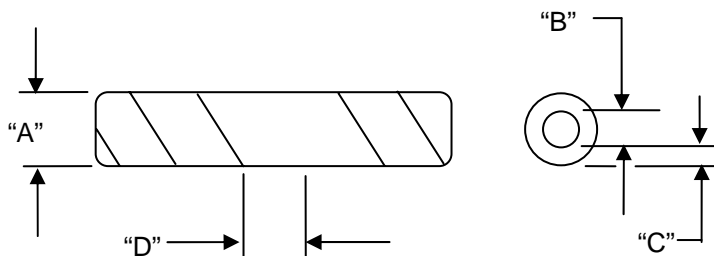

**FIGURE 1**

<b>TABLE 1: DIMENSIONAL INFORMATION</b>				
Alpha P/N	Outside Dia "A"	Nominal ID "B"	Wall Thickness "C"	Right Hand Pitch "D"
SW-40	0.125 +/-0.020	0.061	0.032 +/-0.010	0.187 +/- 1/16
SW-41	0.250 +/-0.020	0.160	0.045 +/-0.010	0.375 +/- 1/8
SW-42	0.375 +/-0.020	0.271	0.052 +/-0.010	0.438 +/- 1/8
SW-43	0.500 +/-0.020	0.376	0.062 +/-0.010	0.500 +/- 1/8
SW-44	0.750 +/-0.025	0.620	0.065 +/-0.010	0.750 +/- 1/4
SW-45	1.000 +/-0.035	0.840	0.080 +/-0.010	1.000 +/- 1/4

Alpha P/N	Standard package
SW-40	25, 100, 500 ft spools
SW-41	25, 100, 500 ft spools
SW-42	25, 100 ft spools
SW-43	25, 100 ft spools
SW-44	25, 100, 500 ft spools
SW-45	25, 100, 500 ft spools

Note: All sizes may contain a maximum of 3 lengths

---

**ALPHA WIRE COMPANY  
CUSTOMER PRODUCT SPECIFICATION**

---

**Part Number: SW40-SW45**  
**Page 3 of 3 Pages**

**Issue: 4**  
**Issue Date: 3/20/2007**  
**Effective Date: 4/20/2007**

---

10 ft. minimum length of an individual piece

**Table 2**