



## JB8 Jumper Bars

### Terminal Blocks Accessories

#### Features and Benefits

Facilitate & secure your jumper bar assembly process:

- Screwless mounting,
- Pre-cut poles for various circuits configurations,
- Insulated,
- Positive locking.

#### Main Technical Data

	IEC	cULus - CSA	Ex e
Rated current	57 A	42 A	
Rated voltage	Standard use 1000 V	600 V	630 V
	Cut extremities 800 V	300 V	Not authorized
	Cut poles 400 V	300 V	Not authorized
Impulse withstand voltage	6000 V		
Protection	IP 20	NEMA 1	

#### Mounting Instructions

Screwless

Tool

Torque

Material Specifications	Insulating material	Polyamide	
	Flammability	V0	
	NF F 16 101	I2F2	
Ambient temperature min/max	Service IEC 60068-2-1	-55 +110 °C	-67 +230 F
	Storage	-55 +110 °C	-67 +230 F
	Installing	-5 +40 °C	-23 +104 F

#### Ordering Details

##### JB8 Jumper Bars

Description	Type	Order Code	Pack <sup>(ng)</sup> pieces	Weight g (1 pce)
8 mm 0.315 in spacing	2 poles	JB8-2	1SNK 908 302 R0000	50 2.70
	3 poles	JB8-3	1SNK 908 303 R0000	50 4.10
	4 poles	JB8-4	1SNK 908 304 R0000	50 5.60
	5 poles	JB8-5	1SNK 908 305 R0000	40 7.00
	10 poles	JB8-10	1SNK 908 310 R0000	20 14.20

##### JB8 Accessories

Description	Type	Order Code	Pack <sup>(ng)</sup> pieces	Weight g (1 pce)
1 Circuit Separators	Dark Grey	CS	1SNK 900 101 R0000	20 0.20

#### JB8 Mounting Instructions

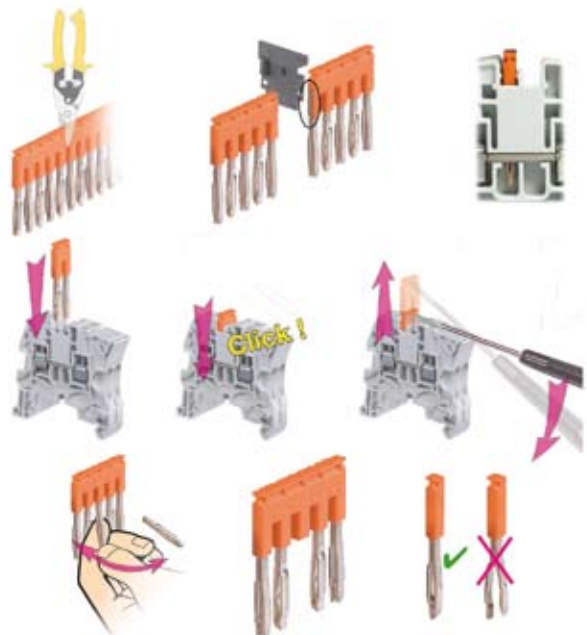

Caution:

use of cut jumper bars is not allowed in Explosive atmospheres,

- Jumper bar with cut extremities: when mounted on feed-through or ground terminal blocks: the circuit separator CS must be installed on the cut side,
- Jumper bar with cut poles: for alternated jumpering between terminal blocks.