

## Pluggable PCB terminals and headers

# wiecon PCB

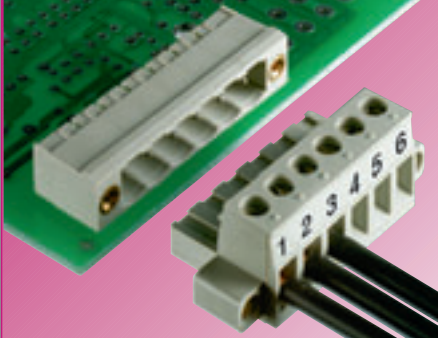
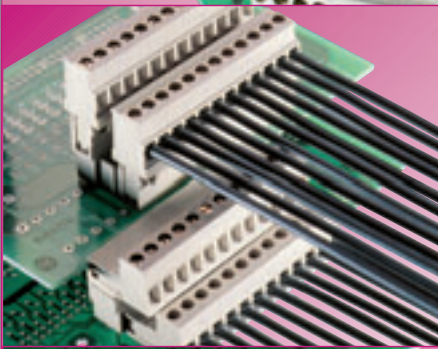
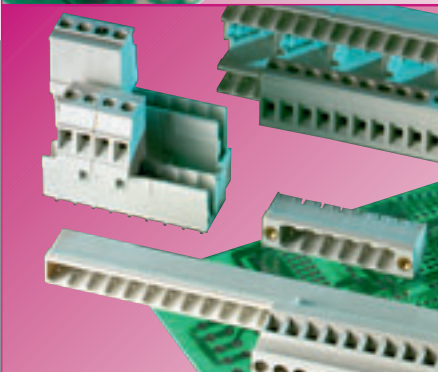

**Pluggable connection** describes the method used to connect an external conductor to a PCB, via a terminal connector and header

### System features

- plug in system is simple to maintain
- screw termination by means of rising cage clamp for security
- screw connection is easy to operate
- spring clamp connection for speed
- comprehensive range means that the direction of insertion/withdrawal and conductor guide methodology can be individually matched to the application
- simple, clear and secure method of connecting and disconnecting
- multiple pole configuration
- connection of single core and finely stranded conductors up to 1.5 mm<sup>2</sup> and 2.5 mm<sup>2</sup>
- metric and imperial pitch options  
The pitch measured in inches can be identified by a pip on the conductor guide funnel
- clamping with TOP connection

### Applications

- designed for frequent and ongoing equipment maintenance and system changes as the pluggable terminal connector and PCB header are easily connected and disconnected
- prefabricated wiring arrangements can be easily interfaced to connect and enable the system

### Type range

- 2 - 24 pole
- different variants of terminals and headers allow for horizontal, vertical and angled connection of wiring in relation to the PCB (eg. 35°)

- PCB terminals with closed side walls: ensure no miss-connection
- PCB terminals with open side walls enable expansion with no effect on the pitch to the circuit board
- pitch options: 3.81/5.00/5.08/7.50/7.62/10.00/10.16 mm
- two tier headers

### Flange version

- terminal connectors and headers can also incorporate additional fixing elements such as screw flanges which helps prevent them being separated accidentally
- secure electrical and mechanical connection even under shock and vibration

### Coding

- a coding system is available to prevent the connection of non-interchangeable components. The coding parts can be inserted into special slots in either or both the terminal connector and header
- coding does not effect number of available poles
- coding possible with a minimum of 4 poles

### Marking

- clear pole marking which is easy to read enabling easy connection
- by means of ink jet printing directly onto the terminal connector using indelible ink
- special marking is possible on request

### DQS certification for all product areas

- Quality standard in accordance with DIN ISO 9001
- In development, production and installation
- Continued control of the quality standard by means of regular internal and external quality audits
- Compatible with certificates of other countries:
  - BSI, Great Britain
  - SQS, Switzerland
  - Aib-Vincotte, Belgium
  - ÖQS, Austria

# wiecon

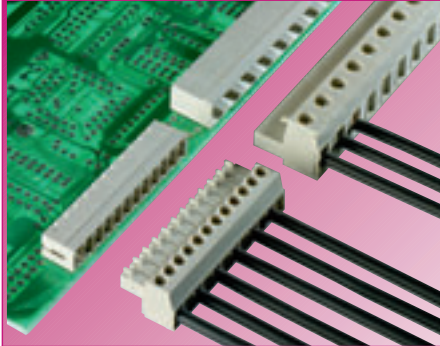

## System 8813

- mini-PCB terminals 2 to 20 pole
- terminal and header horizontal or vertical in relation to the PCB
- total design height: 11 mm, of which only 8 mm is above the PCB
- in the space saving 3.81 mm pitch
- conductor size 1.5 mm<sup>2</sup>
- suitable for coding:
  - plug terminal with coding pins
  - socket header with coding channels
- also with locking flange

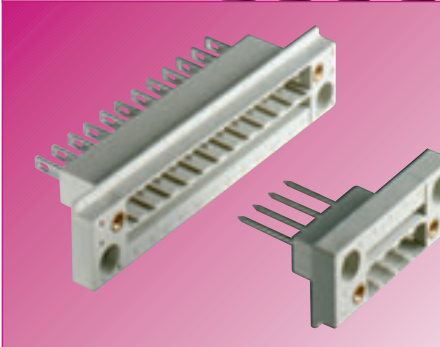

## Panel mount header

- header can be inserted in the unit wall (see inset)
- plug in connection through the wall
- header = bush housing
- threaded bush for vibration resistant screw connection of flange designs
- can be screwed to the housing wall
- connecting wiring inside the housing via termi-point or solder connection

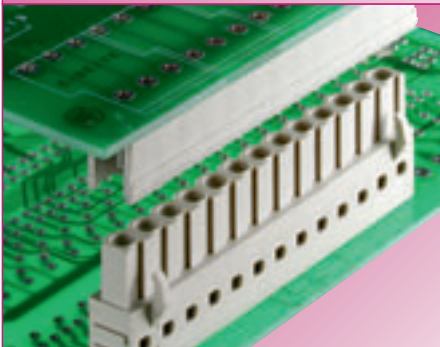

## Inverted version

- solderable terminal as header with straight and angled socket solder pins
- can be coded using coding parts in special slots
- the mounting holder enables locking with the header



## Top version

- screw connection and conductor feed in line with connection
- plug with connection in line with conductor
- very easy to use in restricted installation conditions
- with and without integral LED

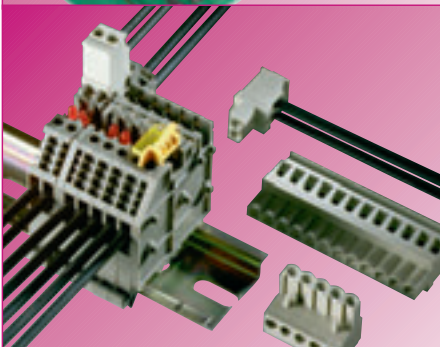

## Special types

- for the control panel:
  - terminal blocks with integral header
  - assembles to 5.00 mm-pitch
  - can be mounted on DIN rail
- terminals with header for system 8113
- with vertical socket outlet
- with horizontal socket outlet

## Materials

### Metal components

- made from special alloys and/ or special surface treatments for:
- clamping part and clamping screw: made from nickel plated brass  
top version: galvanised and chromated steel
- socket contact: tinned bronze
- header and solder pins: made from a high quality copper alloy
- minimum contact resistance
- high corrosion protection
- secure, dynamic clamping function

### Insulating housing:

- Polyamide 66/6, used on account of its excellent electrical, chemical and mechanical properties (see **facts & DATA** section)
- material in accordance with UL 94 V-0
- colour grey, similar to RAL 7032
- glass filled for additional reinforcement (no glass reinforcement in tier-type header and solderable parts)

## Abbreviations for plastic material markings:

- PA 66/6 = Polyamide 66/6
- PC = Polycarbonate
- PBT = Polybutylenterephthalate

## Note:

The conductor size and connecting capacity relate to unprepared conductors without ferrules.

The rated current specified corresponds to the maximum load of PCB terminal with connected conductor with the given conductor size.

The rated voltage is specified in accordance with DIN VDE 0110 Part 1 (IEC 60 664-1) – Insulation coordination for electrical equipment in low voltage installations and refers to the received condition of the PCB terminals.

When fitting PCB terminals to the PCB, the appropriate PCB must be selected and given the relevant dimensions (e.g. as regards the resistance of the PCB to creepage, spacing of the conductors and soldering pads).

In addition, the influences of the environment (level of pollution) to which the equipment is to be exposed are to be taken into account. The specified rate voltages for the whole module only apply if the PCB and PCB terminal have been matched correctly and carefully.

# Pluggable PCB terminal, rising cage clamp system, pitch 3.50/3.81 mm

# wiecon PCB

cable size  
1.5 mm<sup>2</sup>

Rated cross section:  
1.5 mm<sup>2</sup>

Rated current:  
8 A

Wire range:  
0.14 – 1.5 mm<sup>2</sup> single core/finely stranded

125 V/2.5 kV/3 – overvoltage category III  
250 V/2.5 kV/2 – overvoltage category II  
\* 690 V/2.5 kV/1 – overvoltage category I

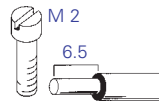
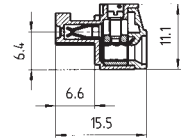
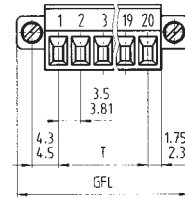
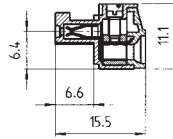
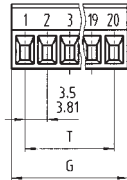

**Type 8513 B/..., 8813 B/...**  
Connection in line with conductor

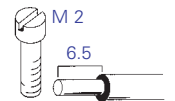

**Type 8513 B/...F, 8813 B/...F**  
Connection in line with conductor

\* max. 600V for non earthed systems or expected overvoltage  
≤ 3 kV for L ≥ 2.00 mm and ≤ 2.5 kV for 2.0 mm > L ≥ 1.5 mm

Rated voltages VDE 0110

UL Data

CSA Data

Approvals

No. 30 – 16 AWG

300 V

8 A

No. 22 – 14 AWG

300 V

5 A



No. 30 – 16 AWG

300 V

8 A

No. 22 – 14 AWG

300 V

5 A



Box Qty	GFL	G	T	Pole	Part No.	Part No.	Part No.	Part No.
<b>Pitch 3.50 mm</b>					unmarked	marked	unmarked	marked
100	17.40	7.00	3.50	2	25.640.3253.0	25.640.0253.0	25.641.3253.0	25.641.0253.0
100	20.90	10.50	7.00	3	25.640.3353.0	25.640.0353.0	25.641.3353.0	25.641.0353.0
50	24.40	14.00	10.50	4	25.640.3453.0	25.640.0453.0	25.641.3453.0	25.641.0453.0
50	27.90	17.50	14.00	5	25.640.3553.0	25.640.0553.0	25.641.3553.0	25.641.0553.0
50	31.40	21.00	17.50	6	25.640.3653.0	25.640.0653.0	25.641.3653.0	25.641.0653.0
50	34.90	24.50	21.00	7	25.640.3753.0	25.640.0753.0	25.641.3753.0	25.641.0753.0
50	38.40	28.00	24.50	8	25.640.3853.0	25.640.0853.0	25.641.3853.0	25.641.0853.0
50	41.90	31.50	28.00	9	25.640.3953.0	25.640.0953.0	25.641.3953.0	25.641.0953.0
50	45.40	35.00	31.50	10	25.640.4053.0	25.640.1053.0	25.641.4053.0	25.641.1053.0
50	48.90	38.50	35.00	11	25.640.4153.0	25.640.1153.0	25.641.4153.0	25.641.1153.0
50	52.40	42.00	38.50	12	25.640.4253.0	25.640.1253.0	25.641.4253.0	25.641.1253.0
50	55.90	45.50	42.00	13	25.640.4353.0	25.640.1353.0	25.641.4353.0	25.641.1353.0
50	59.40	49.00	45.50	14	25.640.4453.0	25.640.1453.0	25.641.4453.0	25.641.1453.0
50	62.90	52.50	49.00	15	25.640.4553.0	25.640.1553.0	25.641.4553.0	25.641.1553.0
50	66.40	56.00	52.50	16	25.640.4653.0	25.640.1653.0	25.641.4653.0	25.641.1653.0
<b>Pitch 3.81 mm</b>					unmarked	marked	unmarked	marked
100	18.01	8.41	3.81	2	25.620.3253.0	25.620.0253.0	25.621.3253.0	25.621.0253.0
100	21.82	12.22	7.62	3	25.620.3353.0	25.620.0353.0	25.621.3353.0	25.621.0353.0
50	25.63	16.03	11.43	4	25.620.3453.0	25.620.0453.0	25.621.3453.0	25.621.0453.0
50	29.44	19.84	15.24	5	25.620.3553.0	25.620.0553.0	25.621.3553.0	25.621.0553.0
50	33.25	23.65	19.05	6	25.620.3653.0	25.620.0653.0	25.621.3653.0	25.621.0653.0
50	37.06	27.46	22.86	7	25.620.3753.0	25.620.0753.0	25.621.3753.0	25.621.0753.0
50	40.87	31.27	26.67	8	25.620.3853.0	25.620.0853.0	25.621.3853.0	25.621.0853.0
50	44.68	35.08	30.48	9	25.620.3953.0	25.620.0953.0	25.621.3953.0	25.621.0953.0
50	48.49	38.89	34.29	10	25.620.4053.0	25.620.1053.0	25.621.4053.0	25.621.1053.0
50	52.30	42.70	38.10	11	25.620.4153.0	25.620.1153.0	25.621.4153.0	25.621.1153.0
50	56.11	46.51	41.91	12	25.620.4253.0	25.620.1253.0	25.621.4253.0	25.621.1253.0
50	59.92	50.32	45.72	13	25.620.4353.0	25.620.1353.0	25.621.4353.0	25.621.1353.0
50	63.73	54.13	49.53	14	25.620.4453.0	25.620.1453.0	25.621.4453.0	25.621.1453.0
50	67.54	57.94	53.34	15	25.620.4553.0	25.620.1553.0	25.621.4553.0	25.621.1553.0
50	71.35	61.75	57.15	16	25.620.4653.0	25.620.1653.0	25.621.4653.0	25.621.1653.0



# Pluggable PCB terminals, spring clamp system, pitch 3.50 mm



cable size  
1.5 mm<sup>2</sup>

Rated cross section:  
1.5 mm<sup>2</sup>

Rated current:  
8 A

Wire range:  
0.14 – 1.5 mm<sup>2</sup> single core/finely stranded

125 V/2.5 kV/3 – overvoltage category III  
250 V/2.5 kV/2 – overvoltage category II  
\* 690 V/2.5 kV/1 – overvoltage category I

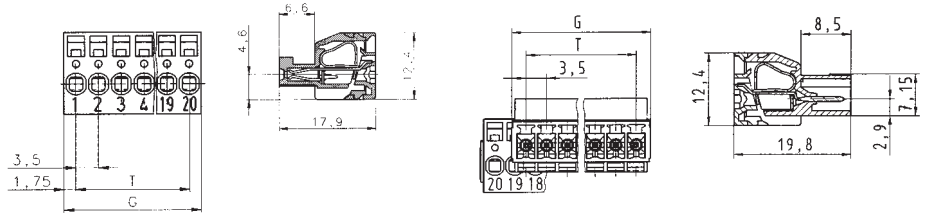

\* max. 600V for non earthed systems or expected overvoltage  
≤ 3 kV for L ≥ 2.00 mm and ≤ 2.5 kV for 2.0 mm > L ≥ 1.5 mm

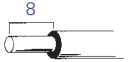
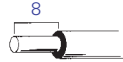
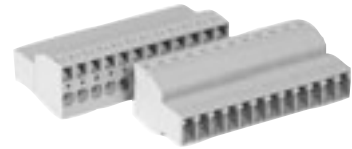
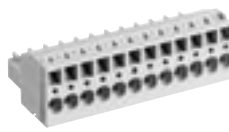

**Type 8513 BFK**

**Type 8513 SUFK**

VDE 0110  
UL Data  
CSA Data  
Approvals

No. 30 – 16 AWG  
No. 22 – 14 AWG

300 V 8 A  
300 V 5 A



No. 30 – 16 AWG  
No. 22 – 14 AWG

300 V 8 A  
300 V 5 A



Pitch 3.50 mm	Box Qty	G	T	Pole	Part No.	Part No.	Part No.	Part No.	
		Type 8513 BFK				unmarked	marked		
	100	6.90	3.50	2	25.630.3253.0	25.630.0253.0			
	100	10.40	7.00	3	25.630.3353.0	25.630.0353.0			
	50	13.90	10.50	4	25.630.3453.0	25.630.0453.0			
	50	17.40	14.00	5	25.630.3553.0	25.630.0553.0			
	50	20.90	17.50	6	25.630.3653.0	25.630.0653.0			
	50	24.40	21.00	7	25.630.3753.0	25.630.0753.0			
	50	27.90	24.50	8	25.630.3853.0	25.630.0853.0			
	50	31.40	28.00	9	25.630.3953.0	25.630.0953.0			
	50	34.90	31.50	10	25.630.4053.0	25.630.1053.0			
	50	38.40	35.00	11	25.630.4153.0	25.630.1153.0			
	50	41.90	38.50	12	25.630.4253.0	25.630.1253.0			
	50	45.40	42.00	13	25.630.4353.0	25.630.1353.0			
	50	48.90	45.50	14	25.630.4453.0	25.630.1453.0			
	50	52.40	49.00	15	25.630.4553.0	25.630.1553.0			
	50	55.90	52.50	16	25.630.4653.0	25.630.1653.0			
		Type 8513 SUFK				unmarked	marked		
	100	8.40	3.50	2			25.642.3253.0	25.642.0253.0	
	100	11.90	7.00	3			25.642.3353.0	25.642.0353.0	
	50	15.40	10.50	4			25.642.3453.0	25.642.0453.0	
	50	18.90	14.00	5			25.642.3553.0	25.642.0553.0	
	50	22.40	17.50	6			25.642.3653.0	25.642.0653.0	
	50	25.90	21.00	7			25.642.3753.0	25.642.0753.0	
	50	29.40	24.50	8			25.642.3853.0	25.642.0853.0	
	50	32.90	28.00	9			25.642.3953.0	25.642.0953.0	
	50	36.40	31.50	10			25.642.4053.0	25.642.1053.0	
	50	39.90	35.00	11			25.642.4153.0	25.642.1153.0	
	50	43.40	38.50	12			25.642.4253.0	25.642.1253.0	
		46.90	42.00	13			25.642.4353.0	25.642.1353.0	
		50.40	45.50	14			25.642.4453.0	25.642.1453.0	
		53.90	49.00	15			25.642.4553.0	25.642.1553.0	
		57.40	52.50	16			25.642.4653.0	25.642.1653.0	
<b>Accessories:</b>									
DIN 5264 A 0.4 x 2.5	5				06.502.4300.0				

Pluggable PCB terminals,  
rising cage clamp system, Pitch 3.81 mm

**wiecon** PCB

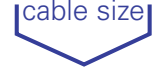

1.5 mm<sup>2</sup>

Rated cross section:  
1.5 mm<sup>2</sup>

Rated current:  
8 A

Wire range:  
0.14 – 1.5 mm<sup>2</sup> single core/finely stranded

125 V/2.5 kV/3 – overvoltage category III  
250 V/2.5 kV/2 – overvoltage category II  
\*690 V/2.5 kV/1 – overvoltage category I

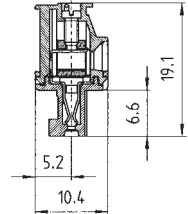
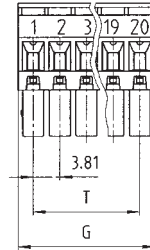
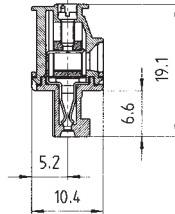
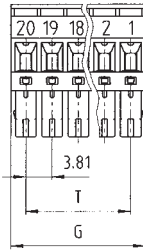

\* max. 600V for non earthed systems or expected overvoltage  
≤ 3 kV for L ≥ 2.00 mm and ≤ 2.5 kV for 2.0 mm > L ≥ 1.5 mm

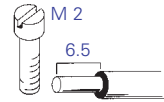

**Type 8813 B/... VR**

Connection at 90° to conductor

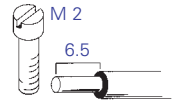

**Type 8813 B/... VL**

Connection at 90° to conductor

Rated voltages VDE 0110

UL Data

CSA Data

Approvals

No. 30 – 16 AWG

300 V

8 A

No. 22 – 14 AWG

300 V

5 A



No. 30 – 16 AWG

300 V

8 A

No. 22 – 14 AWG

300 V

5 A



Box Qty	GFL	G	T	Pole	Part No.	Part No.	Part No.	Part No.
Pitch 3.81 mm					unmarked	marked	unmarked	marked
100	18.01	8.41	3.81	2	25.622.3253.0	25.622.0253.0	25.624.3253.0	25.624.0253.0
100	21.82	12.22	7.62	3	25.622.3353.0	25.622.0353.0	25.624.3353.0	25.624.0353.0
50	25.63	16.03	11.43	4	25.622.3453.0	25.622.0453.0	25.624.3453.0	25.624.0453.0
50	29.44	19.84	15.24	5	25.622.3553.0	25.622.0553.0	25.624.3553.0	25.624.0553.0
50	33.25	23.65	19.05	6	25.622.3653.0	25.622.0653.0	25.624.3653.0	25.624.0653.0
50	37.06	27.46	22.86	7	25.622.3753.0	25.622.0753.0	25.624.3753.0	25.624.0753.0
50	40.87	31.27	26.67	8	25.622.3853.0	25.622.0853.0	25.624.3853.0	25.624.0853.0
50	44.68	35.08	30.48	9	25.622.3953.0	25.622.0953.0	25.624.3953.0	25.624.0953.0
50	48.49	38.89	34.29	10	25.622.4053.0	25.622.1053.0	25.624.4053.0	25.624.1053.0
50	52.30	42.70	38.10	11	25.622.4153.0	25.622.1153.0	25.624.4153.0	25.624.1153.0
50	56.11	46.51	41.91	12	25.622.4253.0	25.622.1253.0	25.624.4253.0	25.624.1253.0
50	59.92	50.32	45.72	13	25.622.4353.0	25.622.1353.0	25.624.4353.0	25.624.1353.0
50	63.73	54.13	49.53	14	25.622.4453.0	25.622.1453.0	25.624.4453.0	25.624.1453.0
50	67.54	57.94	53.34	15	25.622.4553.0	25.622.1553.0	25.624.4553.0	25.624.1553.0
50	71.35	61.75	57.15	16	25.622.4653.0	25.622.1653.0	25.624.4653.0	25.624.1653.0

# wiecon

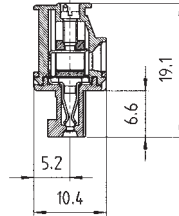
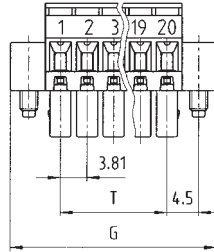
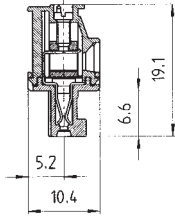
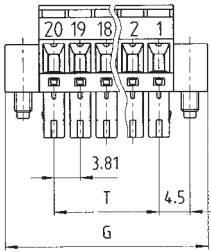

with screw flange

### Type 8813 B/... VR F

Connection at 90° to conductor

No. 30 – 16 AWG

300 V

8 A

No. 22 – 14 AWG

300 V

5 A

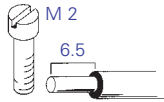

with screw flange

### Type 8813 B/... VL F

Connection at 90° to conductor

No. 30 – 16 AWG

300 V

8 A

No. 22 – 14 AWG

300 V

5 A

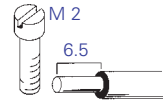

Part No.	Part No.	Part No.	Part No.	
unmarked	marked	unmarked	marked	
25.623.3253.0	25.623.0253.0	25.625.3253.0	25.625.0253.0	
25.623.3353.0	25.623.0353.0	25.625.3353.0	25.625.0353.0	
25.623.3453.0	25.623.0453.0	25.625.3453.0	25.625.0453.0	
25.623.3553.0	25.623.0553.0	25.625.3553.0	25.625.0553.0	
25.623.3653.0	25.623.0653.0	25.625.3653.0	25.625.0653.0	
25.623.3753.0	25.623.0753.0	25.625.3753.0	25.625.0753.0	
25.623.3853.0	25.623.0853.0	25.625.3853.0	25.625.0853.0	
25.623.3953.0	25.623.0953.0	25.625.3953.0	25.625.0953.0	
25.623.4053.0	25.623.1053.0	25.625.4053.0	25.625.1053.0	
25.623.4153.0	25.623.1153.0	25.625.4153.0	25.625.1153.0	
25.623.4253.0	25.623.1253.0	25.625.4253.0	25.625.1253.0	
25.623.4353.0	25.623.1353.0	25.625.4353.0	25.625.1353.0	
25.623.4453.0	25.623.1453.0	25.625.4453.0	25.625.1453.0	
25.623.4553.0	25.623.1553.0	25.625.4553.0	25.625.1553.0	
25.623.4653.0	25.640.1653.0	25.625.4653.0	25.625.1653.0	

# PCB headers, pitch 3.50/3.81 mm

# wiecon PCB

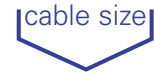

1.5 mm<sup>2</sup>

Rated current:  
8 A

- 125 V/2.5 kV/3 – overvoltage category III
- 250 V/2.5 kV/2 – overvoltage category II
- \* 690 V/2.5 kV/1 – overvoltage category I

Approvals for type 8513 have been applied for

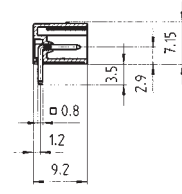
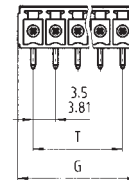
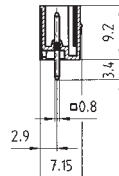
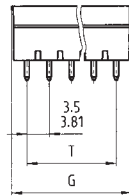

\* max. 600V for non earthed systems or expected overvoltage  
≤ 3 kV for L ≥ 2.00 mm and ≤ 2.5 kV for 2.0 mm > L ≥ 1.5 mm

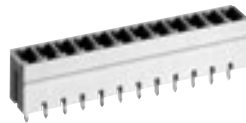

Solder pin 0.8 x 0.8 mm  
Bore hole Ø 1.2 mm

### Type 8513 S/... G, 8813 S/... G

Connection vertical to PCB

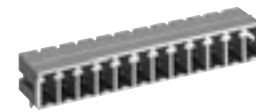

Solder pin 0.8 x 0.8 mm  
Bore hole Ø 1.2 mm

### Type 8513 S/... W, 8813 S/... W

Connection horizontal to PCB

Rated voltages VDE 0110

UL Data

CSA Data

Approvals

300 V

8 A

300 V

8 A

300 V

5 A

300 V

5 A



Box Qty	GFL	G	T	Pole	Part No.	Part No.	Part No.	Part No.
<b>Pitch 3.50 mm</b>					unmarked	unmarked		
100	17.40	8.40	3.50	2	25.646.0253.0	25.647.0253.0		
100	20.90	11.90	7.00	3	25.646.0353.0	25.647.0353.0		
50	24.40	15.40	10.50	4	25.646.0453.0	25.647.0453.0		
50	27.90	18.90	14.00	5	25.646.0553.0	25.647.0553.0		
50	31.40	22.40	17.50	6	25.646.0653.0	25.647.0653.0		
50	34.90	25.90	21.00	7	25.646.0753.0	25.647.0753.0		
50	38.40	29.40	24.50	8	25.646.0853.0	25.647.0853.0		
50	41.90	32.90	28.00	9	25.646.0953.0	25.647.0953.0		
50	45.40	36.40	31.50	10	25.646.1053.0	25.647.1053.0		
50	48.90	39.90	35.00	11	25.646.1153.0	25.647.1153.0		
50	52.40	43.40	38.50	12	25.646.1253.0	25.647.1253.0		
50	55.90	46.90	42.00	13	25.646.1353.0	25.647.1353.0		
50	59.40	50.40	45.50	14	25.646.1453.0	25.647.1453.0		
50	62.90	53.90	49.00	15	25.646.1553.0	25.647.1553.0		
50	66.40	57.40	52.50	16	25.646.1653.0	25.647.1653.0		
<b>Pitch 3.81 mm</b>					unmarked	unmarked		
100	18.01	9.01	3.81	2	25.626.0253.0	25.627.0253.0		
100	21.82	12.82	7.62	3	25.626.0353.0	25.627.0353.0		
50	25.63	16.63	11.43	4	25.626.0453.0	25.627.0453.0		
50	29.44	20.44	15.24	5	25.626.0553.0	25.627.0553.0		
50	33.25	24.25	19.05	6	25.626.0653.0	25.627.0653.0		
50	37.06	28.06	22.86	7	25.626.0753.0	25.627.0753.0		
50	40.87	31.87	26.67	8	25.626.0853.0	25.627.0853.0		
50	44.68	35.68	30.48	9	25.626.0953.0	25.627.0953.0		
50	48.49	39.49	34.29	10	25.626.1053.0	25.627.1053.0		
50	52.30	43.30	38.10	11	25.626.1153.0	25.627.1153.0		
50	56.11	47.11	41.91	12	25.626.1253.0	25.627.1253.0		
50	59.92	50.92	45.72	13	25.626.1353.0	25.627.1353.0		
50	63.73	54.73	49.53	14	25.626.1453.0	25.627.1453.0		
50	67.54	58.54	53.34	15	25.626.1553.0	25.627.1553.0		
50	71.35	62.35	57.15	16	25.626.1653.0	25.627.1653.0		
<b>Accessories:</b>								
Coding part (branch)	100				05.561.0053.0	05.561.0053.0		
When using coding parts, the coding fins on the terminal connector should be removed								

# wiecon

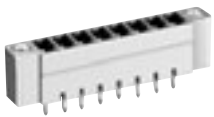
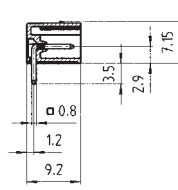
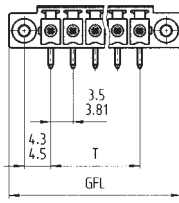
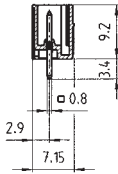
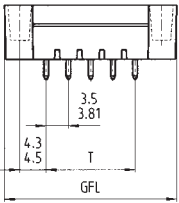

with screw flange

Solder pin 0.8 x 0.8 mm  
Bore hole Ø 1.2 mm



with screw flange

Solder pin 0.8 x 0.8 mm  
Bore hole Ø 1.2 mm

## Type 8513 S/... GF, 8813 S/... GF

Connection vertical to PCB

300 V 8 A  
300 V 5 A



## Type 8513 S/... WF, 8813 S/... WF

Connection horizontal to PCB

300 V 8 A  
300 V 5 A



Part No.	Part No.	Part No.	Part No.
unmarked		unmarked	
25.646.3253.0		25.647.3253.0	
25.646.3353.0		25.647.3353.0	
25.646.3453.0		25.647.3453.0	
25.646.3553.0		25.647.3553.0	
25.646.3653.0		25.647.3653.0	
25.646.3753.0		25.647.3753.0	
25.646.3853.0		25.647.3853.0	
25.646.3953.0		25.647.3953.0	
25.646.4053.0		25.647.4053.0	
25.646.4153.0		25.647.4153.0	
25.646.4253.0		25.647.4253.0	
25.646.4353.0		25.647.4353.0	
25.646.4453.0		25.647.4453.0	
25.646.4553.0		25.647.4553.0	
25.646.4653.0		25.647.4653.0	
unmarked		unmarked	
25.626.3253.0		25.627.3253.0	
25.626.3353.0		25.627.3353.0	
25.626.3453.0		25.627.3453.0	
25.626.3553.0		25.627.3553.0	
25.626.3653.0		25.627.3653.0	
25.626.3753.0		25.627.3753.0	
25.626.3853.0		25.627.3853.0	
25.626.3953.0		25.627.3953.0	
25.626.4053.0		25.627.4053.0	
25.626.4153.0		25.627.4153.0	
25.626.4253.0		25.627.4253.0	
25.626.4353.0		25.627.4353.0	
25.626.4453.0		25.627.4453.0	
25.626.4553.0		25.627.4553.0	
25.626.4653.0		25.627.4653.0	
05.561.0053.0		05.561.0053.0	



# Pluggable PCB terminals, rising cage clamp, pitch 5.00/5.08 mm

# wiecon PCB

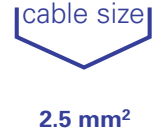

Rated cross section:  
2.5 mm<sup>2</sup>

Rated current:  
12 A

Wire range:  
0.14 – 2.5 mm<sup>2</sup> single core/finely stranded

250 V/4 kV/3 – overvoltage category III  
400 V/4 kV/2 – overvoltage category II  
1000 V/4 kV/1 – overvoltage category I

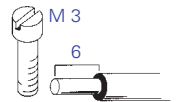
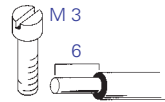
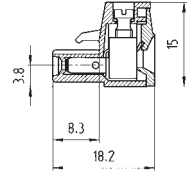
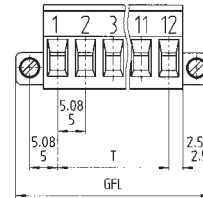
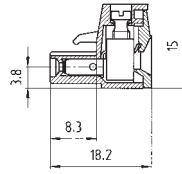
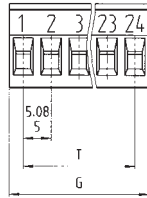

**Type 8113 B/... 8213 B/...**  
Connection in line with conductor

**Type 8113 B/... F, 8213 B/... F**  
Connection in line with conductor

Rated voltages VDE 0110  
UL Data  
CSA Data  
Approvals

No. 22 – 12 AWG 300 V 15 A  
No. 22 – 12 AWG 300 V 15 A

No. 22 – 12 AWG 300 V 15 A  
No. 22 – 12 AWG 300 V 15 A

Box Qty	GFL	G	T	Pole	Part No.	Part No.	Part No.	Part No.	
<b>Pitch 5.00 mm</b>				<b>Type 8113</b>		unmarked	marked	unmarked	marked
100	20	10	5	2	25.320.3253.0	25.320.0253.0	25.322.3253.0	25.322.0253.0	
100	25	15	10	3	25.320.3353.0	25.320.0353.0	25.322.3353.0	25.322.0353.0	
50	30	20	15	4	25.320.3453.0	25.320.0453.0	25.322.3453.0	25.322.0453.0	
50	35	25	20	5	25.320.3553.0	25.320.0553.0	25.322.3553.0	25.322.0553.0	
50	40	30	25	6	25.320.3653.0	25.320.0653.0	25.322.3653.0	25.322.0653.0	
50	45	35	30	7	25.320.3753.0	25.320.0753.0	25.322.3753.0	25.322.0753.0	
50	50	40	35	8	25.320.3853.0	25.320.0853.0	25.322.3853.0	25.322.0853.0	
50	55	45	40	9	25.320.3953.0	25.320.0953.0	25.322.3953.0	25.322.0953.0	
50	60	50	45	10	25.320.4053.0	25.320.1053.0	25.322.4053.0	25.322.1053.0	
50	65	55	50	11	25.320.4153.0	25.320.1153.0	25.322.4153.0	25.322.1153.0	
50	70	60	55	12	25.320.4253.0	25.320.1253.0	25.322.4253.0	25.322.1253.0	
50	75	65	60	13	25.320.4353.0	25.320.1353.0	25.322.4353.0	25.322.1353.0	
50	80	70	65	14	25.320.4453.0	25.320.1453.0	25.322.4453.0	25.322.1453.0	
50	85	75	70	15	25.320.4553.0	25.320.1553.0	25.322.4553.0	25.322.1553.0	
50	90	80	75	16	25.320.4653.0	25.320.1653.0	25.322.4653.0	25.322.1653.0	
					17 to 24 pole on request		17 to 22 pole on request		
<b>Pitch 5.08 mm</b>				<b>Type 8213</b>		unmarked	marked	unmarked	marked
100	20.32	10.16	5.08	2	25.340.3253.0	25.340.0253.0	25.323.3253.0	25.323.0253.0	
100	25.40	15.24	10.16	3	25.340.3353.0	25.340.0353.0	25.323.3353.0	25.323.0353.0	
50	30.48	20.32	15.24	4	25.340.3453.0	25.340.0453.0	25.323.3453.0	25.323.0453.0	
50	35.56	25.40	20.32	5	25.340.3553.0	25.340.0553.0	25.323.3553.0	25.323.0553.0	
50	40.64	30.48	25.40	6	25.340.3653.0	25.340.0653.0	25.323.3653.0	25.323.0653.0	
50	45.72	35.56	30.48	7	25.340.3753.0	25.340.0753.0	25.323.3753.0	25.323.0753.0	
50	50.80	40.64	35.56	8	25.340.3853.0	25.340.0853.0	25.323.3853.0	25.323.0853.0	
50	55.88	45.72	40.64	9	25.340.3953.0	25.340.0953.0	25.323.3953.0	25.323.0953.0	
50	60.96	50.80	45.72	10	25.340.4053.0	25.340.1053.0	25.323.4053.0	25.323.1053.0	
50	66.04	55.88	50.80	11	25.340.4153.0	25.340.1153.0	25.323.4153.0	25.323.1153.0	
50	71.12	60.96	55.88	12	25.340.4253.0	25.340.1253.0	25.323.4253.0	25.323.1253.0	
50	76.20	66.04	60.96	13	25.340.4353.0	25.340.1353.0	25.323.4353.0	25.323.1353.0	
50	81.28	71.12	66.04	14	25.340.4453.0	25.340.1453.0	25.323.4453.0	25.323.1453.0	
50	86.36	76.20	71.12	15	25.340.4553.0	25.340.1553.0	25.323.4553.0	25.323.1553.0	
50	91.44	81.28	76.20	16	25.340.4653.0	25.340.1653.0	25.323.4653.0	25.323.1653.0	
							17 to 22 pole on request		
<b>Accessories:</b>									
Coding part (branch)	100				05.561.9153.0	05.561.9153.0			



# Pluggable PCB terminals, rising cage clamp system, Pitch 7.50/7.62 mm

# wiecon PCB



Rated cross section:  
2.5 mm<sup>2</sup>

Rated current:  
12 A

Wire range:  
0.14 – 2.5 mm<sup>2</sup> single core/finely stranded

400 V/4 kV/3 – overvoltage category III  
690 V/4 kV/2 – overvoltage category II  
1000 V/4 kV/1 – overvoltage category I

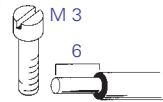
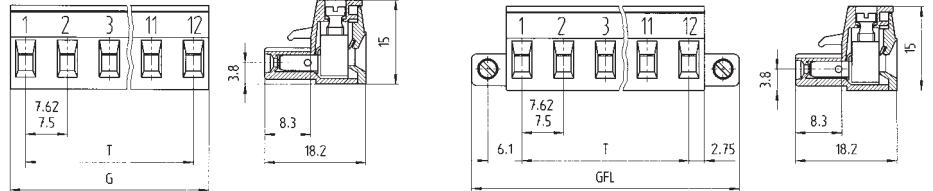

### Type 8313 B/..., 8413 B/...

Connection in line with conductor

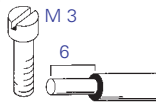

### with screw flange

### Type 8313 B/... F, 8413 B/... F

Connection in line with conductor

Rated voltages VDE 0110

UL Data

CSA Data

Approvals

No. 22 – 12 AWG

300 V

15 A

No. 22 – 12 AWG

300 V

15 A



No. 22 – 12 AWG

300 V

15 A

No. 22 – 12 AWG

300 V

15 A



Box Qty	GFL	G	T	Pole	Part No.	Part No.	Part No.	Part No.	
<b>Pitch 7.50 mm</b>				<b>Type 8313</b>		unmarked	marked	unmarked	marked
100	25.54	13.00	7.50	2	25.360.3253.0	25.360.0253.0	25.324.2253.0	25.324.0253.0	
100	33.04	20.50	15.00	3	25.360.3353.0	25.360.0353.0	25.324.2353.0	25.324.0353.0	
50	40.54	28.00	22.50	4	25.360.3453.0	25.360.0453.0	25.324.2453.0	25.324.0453.0	
50	48.04	35.50	30.00	5	25.360.3553.0	25.360.0553.0	25.324.2553.0	25.324.0553.0	
50	55.54	43.00	37.50	6	25.360.3653.0	25.360.0653.0	25.324.2653.0	25.324.0653.0	
50	63.04	50.50	45.00	7	25.360.3753.0	25.360.0753.0	25.324.2753.0	25.324.0753.0	
50	70.54	58.00	52.50	8	25.360.3853.0	25.360.0853.0	25.324.2853.0	25.324.0853.0	
50	78.04	65.50	60.00	9	25.360.3953.0	25.360.0953.0	25.324.2953.0	25.324.0953.0	
50	85.54	73.00	67.50	10	25.360.4053.0	25.360.1053.0	25.324.3053.0	25.324.1053.0	
50	93.04	80.50	75.00	11	25.360.4153.0	25.360.1153.0	25.324.3153.0	25.324.1153.0	
50	100.54	88.00	82.50	12	25.360.4253.0	25.360.1253.0	25.324.3253.0	25.324.1253.0	
<b>Pitch 7.62 mm</b>				<b>Type 8413</b>		unmarked	marked	unmarked	marked
100	25.66	13.12	7.62	2	25.380.3253.0	25.380.0253.0	25.324.6253.0	25.324.4253.0	
100	33.28	20.74	15.24	3	25.380.3353.0	25.380.0353.0	25.324.6353.0	25.324.4353.0	
50	40.90	28.36	22.86	4	25.380.3453.0	25.380.0453.0	25.324.6453.0	25.324.4453.0	
50	48.52	35.98	30.48	5	25.380.3553.0	25.380.0553.0	25.324.6553.0	25.324.4553.0	
50	56.14	43.60	38.10	6	25.380.3653.0	25.380.0653.0	25.324.6653.0	25.324.4653.0	
50	63.76	51.22	45.72	7	25.380.3753.0	25.380.0753.0	25.324.6753.0	25.324.4753.0	
50	71.38	58.84	53.34	8	25.380.3853.0	25.380.0853.0	25.324.6853.0	25.324.4853.0	
50	79.00	66.46	60.96	9	25.380.3953.0	25.380.0953.0	25.324.6953.0	25.324.4953.0	
50	86.62	74.08	68.58	10	25.380.4053.0	25.380.1053.0	25.324.7053.0	25.324.5053.0	
50	94.24	81.70	76.20	11	25.380.4153.0	25.380.1153.0	25.324.7153.0	25.324.5153.0	
50	101.86	89.32	83.82	12	25.380.4253.0	25.380.1253.0	25.324.7253.0	25.324.5253.0	
<b>Accessories:</b>									
Coding part (branch)	100					05.561.9153.0	05.561.9153.0		

# Pluggable PCB terminals, rising cage clamp system, Pitch 5.00/5.08 mm



cable size  
**2.5 mm<sup>2</sup>**

Rated cross section:  
2.5 mm<sup>2</sup>

Rated current:  
12 A

Wire range:  
0.14 – 2.5 mm<sup>2</sup> single core/finely stranded

250 V/4 kV/3 – overvoltage category III  
400 V/4 kV/2 – overvoltage category II  
1000 V/4 kV/1 – overvoltage category I

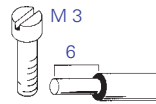
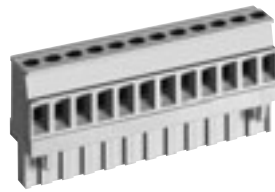
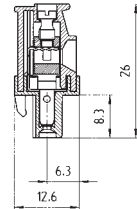
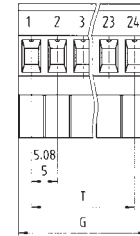
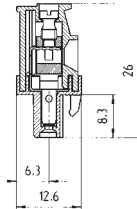
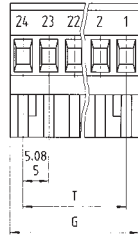

**Type 8113 B/... VR, 8213 B/... VR**

Connection 90° to conductor

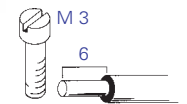
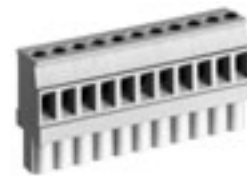

**Type 8113 B/... VL, 8213 B/... VL**

Connection 90° to conductor

Rated voltages VDE 0110

UL Data

CSA Data

Approvals

No. 22 – 12 AWG

300 V

15 A

No. 22 – 12 AWG

300 V

15 A



No. 22 – 12 AWG

300 V

15 A

No. 22 – 12 AWG

300 V

15 A



Box Qty	G	T	Pole	Part No.	Part No.	Part No.	Part No.
<b>Pitch 5.00 mm</b>				Type 8113			
				unmarked	marked	unmarked	marked
100	10	5	2	25.325.3253.0	25.325.0253.0	25.326.3253.0	25.326.0253.0
100	15	10	3	25.325.3353.0	25.325.0353.0	25.326.3353.0	25.326.0353.0
50	20	15	4	25.325.3453.0	25.325.0453.0	25.326.3453.0	25.326.0453.0
50	25	20	5	25.325.3553.0	25.325.0553.0	25.326.3553.0	25.326.0553.0
50	30	25	6	25.325.3653.0	25.325.0653.0	25.326.3653.0	25.326.0653.0
50	35	30	7	25.325.3753.0	25.325.0753.0	25.326.3753.0	25.326.0753.0
50	40	35	8	25.325.3853.0	25.325.0853.0	25.326.3853.0	25.326.0853.0
50	45	40	9	25.325.3953.0	25.325.0953.0	25.326.3953.0	25.326.0953.0
50	50	45	10	25.325.4053.0	25.325.1053.0	25.326.4053.0	25.326.1053.0
50	55	50	11	25.325.4153.0	25.325.1153.0	25.326.4153.0	25.326.1153.0
50	60	55	12	25.325.4253.0	25.325.1253.0	25.326.4253.0	25.326.1253.0
50	65	60	13	25.325.4353.0	25.325.1353.0	25.326.4353.0	25.326.1353.0
50	70	65	14	25.325.4453.0	25.325.1453.0	25.326.4453.0	25.326.1453.0
50	75	70	15	25.325.4553.0	25.325.1553.0	25.326.4553.0	25.326.1553.0
50	80	75	16	25.325.4653.0	25.325.1653.0	25.326.4653.0	25.326.1653.0
17 to 24 pole on request							
<b>Pitch 5.08 mm</b>				Type 8213			
				unmarked	marked	unmarked	marked
100	10.16	5.08	2	25.345.3253.0	25.345.0253.0	25.346.3253.0	25.346.0253.0
100	15.24	10.16	3	25.345.3353.0	25.345.0353.0	25.346.3353.0	25.346.0353.0
50	20.32	15.24	4	25.345.3453.0	25.345.0453.0	25.346.3453.0	25.346.0453.0
50	25.40	20.32	5	25.345.3553.0	25.345.0553.0	25.346.3553.0	25.346.0553.0
50	30.48	25.40	6	25.345.3653.0	25.345.0653.0	25.346.3653.0	25.346.0653.0
50	35.56	30.48	7	25.345.3753.0	25.345.0753.0	25.346.3753.0	25.346.0753.0
50	40.64	35.56	8	25.345.3853.0	25.345.0853.0	25.346.3853.0	25.346.0853.0
50	45.72	40.64	9	25.345.3953.0	25.345.0953.0	25.346.3953.0	25.346.0953.0
50	50.80	45.72	10	25.345.4053.0	25.345.1053.0	25.346.4053.0	25.346.1053.0
50	55.88	50.80	11	25.345.4153.0	25.345.1153.0	25.346.4153.0	25.346.1153.0
50	60.96	55.88	12	25.345.4253.0	25.345.1253.0	25.346.4253.0	25.346.1253.0
50	66.04	60.96	13	25.345.4353.0	25.345.1353.0	25.346.4353.0	25.346.1353.0
50	71.12	66.04	14	25.345.4453.0	25.345.1453.0	25.346.4453.0	25.346.1453.0
50	76.20	71.12	15	25.345.4553.0	25.345.1553.0	25.346.4553.0	25.346.1553.0
50	81.28	76.20	16	25.345.4653.0	25.345.1653.0	25.346.4653.0	25.346.1653.0
17 to 24 pole on request							
<b>Accessories:</b>							
Coding part (branch)	100				05.561.9153.0	05.561.9153.0	

# Pluggable PCB terminals, rising cage clamp system, pitch 7.62 mm

# wiecon PCB

cable size

2.5 mm<sup>2</sup>

Rated cross section:  
2.5 mm<sup>2</sup>

Rated current:  
12 A

Wire range:  
0.14 – 2.5 mm<sup>2</sup> single core/finely stranded

400 V/4 kV/3 – overvoltage category III  
690 V/4 kV/2 – overvoltage category II  
1000 V/4 kV/1 – overvoltage category I

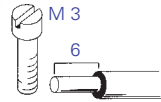
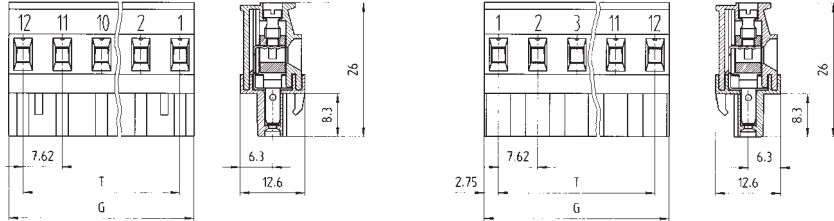

### Type 8413 B/... VR

Connection 90° to conductor

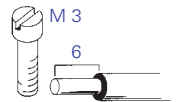

### Type 8413 B/... VL

Connection 90° to conductor

Rated voltages VDE 0110

UL Data

CSA Data

Approvals

No. 22 – 12 AWG

300 V

15 A

No. 22 – 12 AWG

300 V

15 A



No. 22 – 12 AWG

300 V

15 A

No. 22 – 14 AWG

300 V

15 A



Box Qty	G	T	Pole	Part No.	Part No.	Part No.	Part No.
<b>Pitch 7.62 mm</b>				Type 8413		Type 8413	
				unmarked	marked	unmarked	marked
100	13.12	7.62	2	25.385.2253.0	25.385.0253.0	25.386.2253.0	25.386.0253.0
100	20.74	15.24	3	25.385.2353.0	25.385.0353.0	25.386.2353.0	25.386.0353.0
50	28.36	22.86	4	25.385.2453.0	25.385.0453.0	25.386.2453.0	25.386.0453.0
50	35.98	30.48	5	25.385.2553.0	25.385.0553.0	25.386.2553.0	25.386.0553.0
50	43.60	38.10	6	25.385.2653.0	25.385.0653.0	25.386.2653.0	25.386.0653.0
50	51.22	45.72	7	25.385.2753.0	25.385.0753.0	25.386.2753.0	25.386.0753.0
50	58.84	53.34	8	25.385.2853.0	25.385.0853.0	25.386.2853.0	25.386.0853.0
50	66.46	60.96	9	25.385.2953.0	25.385.0953.0	25.386.2953.0	25.386.0953.0
50	74.08	68.58	10	25.385.3053.0	25.385.1053.0	25.386.3053.0	25.386.1053.0
50	81.70	76.20	11	25.385.3153.0	25.385.1153.0	25.386.3153.0	25.386.1153.0
50	89.32	83.82	12	25.385.3253.0	25.385.1253.0	25.386.3253.0	25.386.1253.0
<b>Accessories:</b>							
Coding part (branch)	100			05.561.9153.0		05.561.9153.0	



## Crimp connection

# wiecon

Rated cross section:  
2.5 mm<sup>2</sup>

Rated current:  
10 A when using a 1.0 mm<sup>2</sup> Leiter

12 A when using a 2.5 mm<sup>2</sup> Leiter

Contact for wire range:  
0.5 – 1.0 mm<sup>2</sup> finely stranded  
(Diameter of insulation 1.4 – 2.3 mm)

Wire range:  
1.5 – 2.5 mm<sup>2</sup> finely stranded  
(Diameter of insulation 1.4 – 3.1 mm)

250 V/4 kV/3 – overvoltage category III  
400 V/4 kV/2 – overvoltage category II  
1000 V/4 kV/1 – overvoltage category I

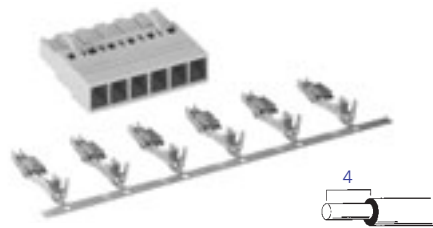
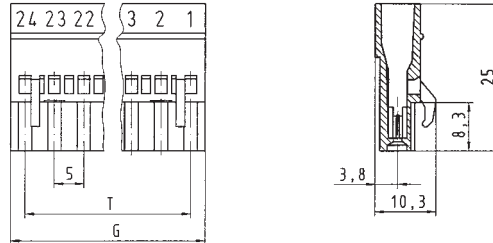

**Type 8113 BK**

Rated voltages VDE 0110

UL Data

CSA Data

Approvals



	Box Qty	G	T	Pole	Part No.	Part No.	Part No.	Part No.
<b>Pitch 5.00 mm</b>					unmarked	marked		
	100	10	5	2	01.060.3253.0	01.060.0253.0		
	100	15	10	3	01.060.3353.0	01.060.0353.0		
	50	20	15	4	01.060.3453.0	01.060.0453.0		
	50	25	20	5	01.060.3553.0	01.060.0553.0		
	50	30	25	6	01.060.3653.0	01.060.0653.0		
	50	35	30	7	01.060.3753.0	01.060.0753.0		
	50	40	35	8	01.060.3853.0	01.060.0853.0		
	50	45	40	9	01.060.3953.0	01.060.0953.0		
	50	50	45	10	01.060.4053.0	01.060.1053.0		
	50	55	50	11	01.060.4153.0	01.060.1153.0		
	50	60	55	12	01.060.4253.0	01.060.1253.0		
	50	65	60	13	01.060.4353.0	01.060.1353.0		
	50	70	65	14	01.060.4453.0	01.060.1453.0		
	50	75	70	15	01.060.4553.0	01.060.1553.0		
	50	80	75	16	01.060.4653.0	01.060.1653.0		
					17 to 24 pole on request			
<b>Accessories:</b>								
<b>Crimp contacts</b>								
Single contacts	500	0.5 – 1.0 mm <sup>2</sup>			02.125.1629.0			
Single contacts	500	1.5 – 2.5 mm <sup>2</sup>			02.125.1729.0			
Strip	4000	0.5 – 1.0 mm <sup>2</sup>			02.125.1600.0			
Strip	3500	1.5 – 2.5 mm <sup>2</sup>			02.125.1700.0			
<b>Crimping tool:</b>								
Crimping tool					95.101.0800.0			
Crimp dies					05.502.2500.0			

# Pluggable PCB terminals – spring clamp system pitch 5.00/5.08 mm

# wiecon PCB

Rated cross section\*:  
2.5 mm<sup>2</sup>

Rated current:  
12 A

Wire range:  
0.14 – 2.5 mm<sup>2</sup> single core/finely stranded

250 V/4 kV/3 – overvoltage category III  
400 V/4 kV/2 – overvoltage category II  
1000 V/4 kV/1 – overvoltage category I

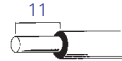
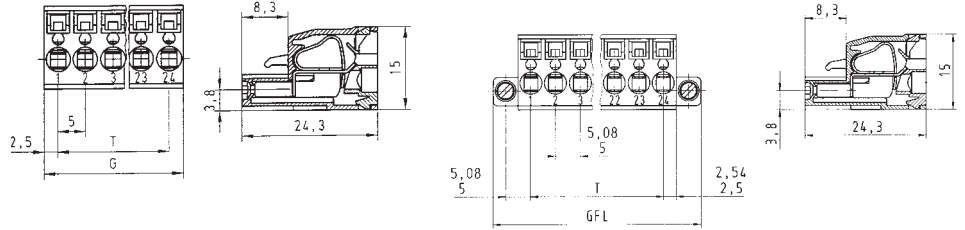

**Type 8113/8213 BFK**



**Type 8113/8213 BFK .../F**

\* When using ferrules for wire range 2.5 mm, only ferrules with part number 2.5 mm 05.596.6127.0 should be used.

Rated voltages VDE 0110

UL Data

CSA Data

Approvals

No. 22 – 12 AWG

300 V

12 A

No. 22 – 12 AWG

300 V

12 A



Box Qty	GFL	G	T	Pole	Part No.	Part No.	Part No.	Part No.
<b>Pitch 5.00 mm</b>					unmarked	marked	unmarked	marked
100	22.54	10	5	2	25.820.3253.0	25.820.0253.0	25.821.3253.0	25.821.0253.0
100	27.54	15	10	3	25.820.3353.0	25.820.0353.0	25.821.3353.0	25.821.0353.0
50	32.54	20	15	4	25.820.3453.0	25.820.0453.0	25.821.3453.0	25.821.0453.0
50	37.54	25	20	5	25.820.3553.0	25.820.0553.0	25.821.3553.0	25.821.0553.0
50	42.54	30	25	6	25.820.3653.0	25.820.0653.0	25.821.3653.0	25.821.0653.0
50	47.54	35	30	7	25.820.3753.0	25.820.0753.0	25.821.3753.0	25.821.0753.0
50	52.54	40	35	8	25.820.3853.0	25.820.0853.0	25.821.3853.0	25.821.0853.0
50	57.54	45	40	9	25.820.3953.0	25.820.0953.0	25.821.3953.0	25.821.0953.0
50	62.54	50	45	10	25.820.4053.0	25.820.1053.0	25.821.4053.0	25.821.1053.0
50	67.54	55	50	11	25.820.4153.0	25.820.1153.0	25.821.4153.0	25.821.1153.0
50	72.54	60	55	12	25.820.4253.0	25.820.1253.0	25.821.4253.0	25.821.1253.0
50	77.54	65	60	13	25.820.4353.0	25.820.1353.0	25.821.4353.0	25.821.1353.0
50	82.54	70	65	14	25.820.4453.0	25.820.1453.0	25.821.4453.0	25.821.1453.0
50	87.54	75	70	15	25.820.4553.0	25.820.1553.0	25.821.4553.0	25.821.1553.0
50	92.54	80	75	16	25.820.4653.0	25.820.1653.0	25.821.4653.0	25.821.1653.0
					17 to 24 pole on request		17 to 24 pole on request	
<b>Pitch 5.08 mm</b>					unmarked	marked	unmarked	marked
100	22.70	10.16	5.08	2	25.840.3253.0	25.840.0253.0	25.841.3253.0	25.841.0253.0
100	27.78	15.24	10.16	3	25.840.3353.0	25.840.0353.0	25.841.3353.0	25.841.0353.0
50	32.86	20.32	15.24	4	25.840.3453.0	25.840.0453.0	25.841.3453.0	25.841.0453.0
50	37.94	25.40	20.32	5	25.840.3553.0	25.840.0553.0	25.841.3553.0	25.841.0553.0
50	43.02	30.48	25.40	6	25.840.3653.0	25.840.0653.0	25.841.3653.0	25.841.0653.0
50	48.10	35.56	30.48	7	25.840.3753.0	25.840.0753.0	25.841.3753.0	25.841.0753.0
50	53.18	40.64	35.56	8	25.840.3853.0	25.840.0853.0	25.841.3853.0	25.841.0853.0
50	58.26	45.72	40.64	9	25.840.3953.0	25.840.0953.0	25.841.3953.0	25.841.0953.0
50	63.34	50.80	45.72	10	25.840.4053.0	25.840.1053.0	25.841.4053.0	25.841.1053.0
50	68.42	55.88	50.80	11	25.840.4153.0	25.840.1153.0	25.841.4153.0	25.841.1153.0
50	73.50	60.96	55.88	12	25.840.4253.0	25.840.1253.0	25.841.4253.0	25.841.1253.0
50	78.58	66.04	60.96	13	25.840.4353.0	25.840.1353.0	25.841.4353.0	25.841.1353.0
50	83.66	71.12	66.04	14	25.840.4453.0	25.840.1453.0	25.841.4453.0	25.841.1453.0
50	88.74	76.20	71.12	15	25.840.4553.0	25.840.1553.0	25.841.4553.0	25.841.1553.0
50	93.82	81.28	76.20	16	25.840.4653.0	25.840.1653.0	25.841.4653.0	25.841.1653.0
					17 to 24 pole on request		17 to 24 pole on request	

# Pluggable PCB terminal - spring clamp system pitch 5.08 mm

# wiecon

cable size

2.5 mm<sup>2</sup>

Rated cross section\*:  
2.5 mm<sup>2</sup>

Rated current:  
12 A

Wire range:  
0.14 – 2.5 mm<sup>2</sup> single core/finely stranded

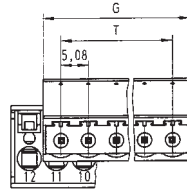

250 V/4 kV/3 – overvoltage category III  
400 V/4 kV/2 – overvoltage category II  
1000 V/4 kV/1 – overvoltage category I



\* When using ferrules for wire range 2.5 mm, only ferrules with part number 2.5 mm 05.596.6127.0 should be used.

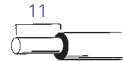

## Type 8213 SUFK

Rated voltages VDE 0110

UL Data

CSA Data

Approvals in preparation

No. 22 – 12 AWG

300 V

12 A

No. 22 – 12 AWG

300 V

12 A



	Box Qty	G	T	Pole	Part No.	Part No.	
<b>Pitch 5.08 mm</b>					unmarked	marked	
	100	10.16	5.08	2	25.857.3253.0	25.857.0253.0	
	100	15.24	10.16	3	25.857.3353.0	25.857.0353.0	
	50	20.32	15.24	4	25.857.3453.0	25.857.0453.0	
	50	25.40	20.32	5	25.857.3553.0	25.857.0553.0	
	50	30.48	25.40	6	25.857.3653.0	25.857.0653.0	
	50	35.56	30.48	7	25.857.3753.0	25.857.0753.0	
	50	40.64	35.56	8	25.857.3853.0	25.857.0853.0	
	50	45.72	40.64	9	25.857.3953.0	25.857.0953.0	
	50	50.80	45.72	10	25.857.4053.0	25.857.1053.0	
	50	55.88	50.80	11	25.857.4153.0	25.857.1153.0	
	50	60.96	55.88	12	25.857.4253.0	25.857.1253.0	
	50	66.04	60.96	13	25.857.4353.0	25.857.1353.0	
	50	71.12	66.04	14	25.857.4453.0	25.857.1453.0	
	50	76.20	71.12	15	25.857.4553.0	25.857.1553.0	
	50	81.28	76.20	16	25.857.4653.0	25.857.1653.0	
	17 to 24 pole on request						
<b>Accessories:</b>							
Coding part (branch)	100				05.561.9153.0		
Screwdriver DIN 5264 A 0.6 x 3.5	5				06.502.4000.0		

# Pluggable PCB terminal - spring clamp system pitch 7.62 mm

# wiecon PCB

Rated cross section\*:  
2.5 mm<sup>2</sup>

Rated current:  
12 A

Wire range:  
0.14 – 2.5 mm<sup>2</sup> single core/finely stranded

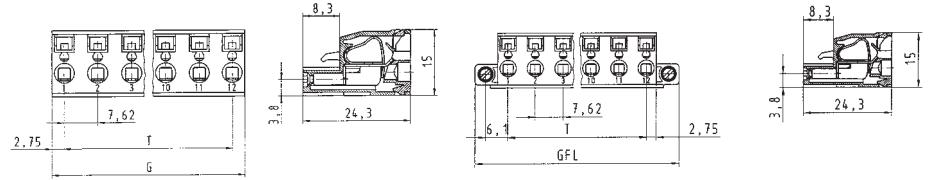

400 V/6 kV/3 – overvoltage category III  
\*\* 690 V/6 kV/2 – overvoltage category II  
1000 V/6 kV/1 – overvoltage category I

\* When using ferrules for wire range 2.5 mm, only ferrules with part number 05.596.6127.0 should be used.

\*\* max. 600 V for non-earthed systems or expected overvoltage  
≤ 3 kV for L ≥ 2.00 mm and ≤ 2.5 kV for 2.0 mm > L ≥ 1.5 mm

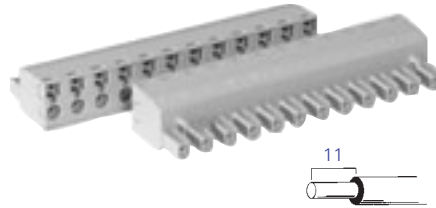

**Type 8413 BFK**

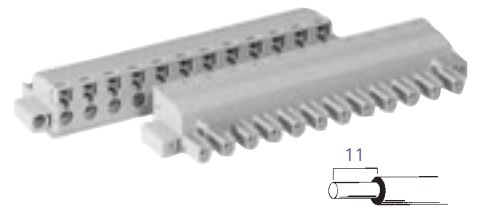

**Type 8413 BFK/... F**

VDE 0110  
UL Data  
CSA Data  
Approvals

No. 22 – 12 AWG

300 V 12 A

No. 22 – 12 AWG

300 V 12 A

Box Qty	GFL	G	T	Pole	Part No.	Part No.	Part No.	Part No.
Pitch 7.62 mm					unmarked	marked	unmarked	marked
100	25.66	13.12	7.62	2	25.880.3253.0	25.880.0253.0	25.881.3253.0	25.881.0253.0
100	33.28	20.74	15.24	3	25.880.3353.0	25.880.0353.0	25.881.3353.0	25.881.0353.0
50	40.90	28.36	22.86	4	25.880.3453.0	25.880.0453.0	25.881.3453.0	25.881.0453.0
50	48.52	35.98	30.48	5	25.880.3553.0	25.880.0553.0	25.881.3553.0	25.881.0553.0
50	56.14	43.60	38.10	6	25.880.3653.0	25.880.0653.0	25.881.3653.0	25.881.0653.0
50	63.76	51.22	45.72	7	25.880.3753.0	25.880.0753.0	25.881.3753.0	25.881.0753.0
50	71.38	58.84	53.34	8	25.880.3853.0	25.880.0853.0	25.881.3853.0	25.881.0853.0
50	79.00	66.46	60.96	9	25.880.3953.0	25.880.0953.0	25.881.3953.0	25.881.0953.0
50	86.62	74.08	68.58	10	25.880.4053.0	25.880.1053.0	25.881.4053.0	25.881.1053.0
50	94.24	81.70	76.20	11	25.880.4153.0	25.880.1153.0	25.881.4153.0	25.881.1153.0
50	101.86	89.32	83.82	12	25.880.4253.0	25.880.1253.0	25.881.4253.0	25.881.1253.0

# Pluggable PCB terminal, inverted header, solder version pitch 5.08 mm

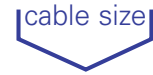

Rated current:  
12 A

250 V/4 kV/3 – overvoltage category III  
\*690 V/4 kV/2 – overvoltage category II  
1000 V/4 kV/1 – overvoltage category I

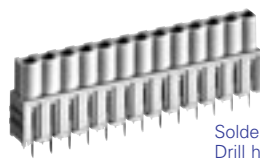
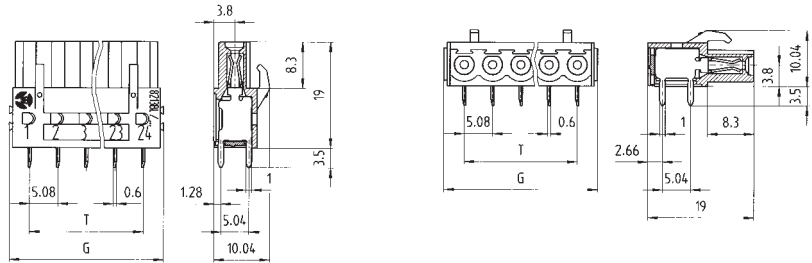

Solder pin 0.6 x 1 mm  
Drill hole Ø 1.2 mm

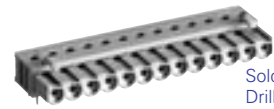

Solder pin 0.6 x 1 mm  
Drill hole Ø 1.2 mm

\* max. 600V for non earthed systems or expected overvoltage  
≤ 3 kV for L ≥ 2.00 mm and ≤ 2.5 kV for 2.0 mm > L ≥ 1.5 mm

## Type 8213 BL/... G

Connection vertical to PCB

## Type 8213 BL/... W

Connection vertical to PCB

Rated voltages VDE 0110

UL Data

CSA Data

Approvals

300 V 15 A  
300 V 15 A

300 V 15 A  
300 V 15 A



Box Qty	G	T	Pole	Part No.	Part No.	Part No.	Part No.
				unmarked	marked	unmarked	marked
<b>Pitch 5.08 mm</b>							
100	12.36	5.08	2	25.342.3253.0	25.342.0253.0	25.343.3253.0	25.343.0253.0
100	17.44	10.16	3	25.342.3353.0	25.342.0353.0	25.343.3353.0	25.343.0353.0
50	22.52	15.24	4	25.342.3453.0	25.342.0453.0	25.343.3453.0	25.343.0453.0
50	27.60	20.32	5	25.342.3553.0	25.342.0553.0	25.343.3553.0	25.343.0553.0
50	32.68	25.40	6	25.342.3653.0	25.342.0653.0	25.343.3653.0	25.343.0653.0
50	37.76	30.48	7	25.342.3753.0	25.342.0753.0	25.343.3753.0	25.343.0753.0
50	42.84	35.56	8	25.342.3853.0	25.342.0853.0	25.343.3853.0	25.343.0853.0
50	47.92	40.64	9	25.342.3953.0	25.342.0953.0	25.343.3953.0	25.343.0953.0
50	53.00	45.72	10	25.342.4053.0	25.342.1053.0	25.343.4053.0	25.343.1053.0
50	58.08	50.80	11	25.342.4153.0	25.342.1153.0	25.343.4153.0	25.343.1153.0
50	63.16	55.88	12	25.342.4253.0	25.342.1253.0	25.343.4253.0	25.343.1253.0
50	68.24	60.96	13	25.342.4353.0	25.342.1353.0	25.343.4353.0	25.343.1353.0
50	73.32	66.04	14	25.342.4453.0	25.342.1453.0	25.343.4453.0	25.343.1453.0
50	78.40	71.12	15	25.342.4553.0	25.342.1553.0	25.343.4553.0	25.343.1553.0
50	83.48	76.20	16	25.342.4653.0	25.342.1653.0	25.343.4653.0	25.343.1653.0
17 to 24 pole on request							
<b>Accessories:</b>							
Coding part (branch)	100			05.561.9153.0		05.561.9153.0	
Mounting bracket	100			Z5.523.7853.0		Z5.523.7753.0	



# Pluggable PCB terminals, TOP connection system pitch 5.00/5.08 mm

# wiecon PCB

Rated cross section:  
2.5 mm<sup>2</sup>

Rated current:  
12 A, On state current 2.2 mA per LED

Rated voltages:  
Type 8113 B/... TOP, 8213 B/... TOP  
250 V/4 kV/3 – overvoltage category III  
400 V/4 kV/2 – overvoltage category II  
1000 V/4 kV/1 – overvoltage category I

Type 8113 B/... TOP LED  
24 V/4 kV/3 – overvoltage category III  
24 V/4 kV/2 – overvoltage category II  
24 V/4 kV/1 – overvoltage category I

Wire range:  
0.14 – 2.5 mm<sup>2</sup> single core/finely stranded

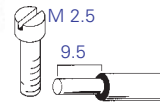
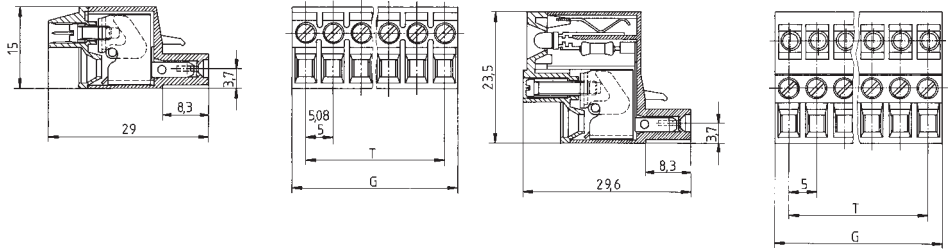

**Type 8113 B/... TOP, 8213 B/... TOP**  
Connection in line with conductor

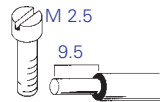

**Type 8113 B/... TOP LED**  
Connection in line with conductor

**TOP connector  
with LED  
common  
negative pole**

Rated voltages VDE 0110  
UL Data  
CSA Data  
Approvals

No. 22 – 12 AWG      300 V    15 A  
No. 22 – 12 AWG      300 V    15 A

No. 22 – 12 AWG      24 V    15 A  
No. 22 – 12 AWG      24 V    15 A

Box Qty	TOP	G	T	Pole	Part No.	Part No.	Part No.	Part No.
<b>Pitch 5.00 mm</b>					unmarked	marked	unmarked	marked
100	250	10	5	2	25.220.3253.0	25.220.0253.0	25.230.3253.0	25.230.0253.0
100	250	15	10	3	25.220.3353.0	25.220.0353.0	25.230.3353.0	25.230.0353.0
50	200	20	15	4	25.220.3453.0	25.220.0453.0	25.230.3453.0	25.230.0453.0
50	200	25	20	5	25.220.3553.0	25.220.0553.0	25.230.3553.0	25.230.0553.0
50	200	30	25	6	25.220.3653.0	25.220.0653.0	25.230.3653.0	25.230.0653.0
50	100	35	30	7	25.220.3753.0	25.220.0753.0	25.230.3753.0	25.230.0753.0
50	100	40	35	8	25.220.3853.0	25.220.0853.0	25.230.3853.0	25.230.0853.0
50	100	45	40	9	25.220.3953.0	25.220.0953.0	25.230.3953.0	25.230.0953.0
50	100	50	45	10	25.220.4053.0	25.220.1053.0	25.230.4053.0	25.230.1053.0
50	100	55	50	11	25.220.4153.0	25.220.1153.0	25.230.4153.0	25.230.1153.0
50	100	60	55	12	25.220.4253.0	25.220.1253.0	25.230.4253.0	25.230.1253.0
50	50	65	60	13	25.220.4353.0	25.220.1353.0	25.230.4353.0	25.230.1353.0
50	50	70	65	14	25.220.4453.0	25.220.1453.0	25.230.4453.0	25.230.1453.0
50	50	75	70	15	25.220.4553.0	25.220.1553.0	25.230.4553.0	25.230.1553.0
50	50	80	75	16	25.220.4653.0	25.220.1653.0	25.230.4653.0	25.230.1653.0
117 to 24 pole on request								
<b>Pitch 5.08 mm</b>					unmarked	marked		
100	250	10.16	5.08	2	25.240.3253.0	25.240.0253.0		
100	250	15.24	10.16	3	25.240.3353.0	25.240.0353.0		
50	200	20.32	15.24	4	25.240.3453.0	25.240.0453.0		
50	200	25.40	20.32	5	25.240.3553.0	25.240.0553.0		
50	200	30.48	25.40	6	25.240.3653.0	25.240.0653.0		
50	100	35.56	30.48	7	25.240.3753.0	25.240.0753.0		
50	100	40.64	35.56	8	25.240.3853.0	25.240.0853.0		
50	100	45.72	40.64	9	25.240.3953.0	25.240.0953.0		
50	100	50.80	45.72	10	25.240.4053.0	25.240.1053.0		
50	100	55.88	50.80	11	25.240.4153.0	25.240.1153.0		
50	100	60.96	55.88	12	25.240.4253.0	25.240.1253.0		
50	50	66.04	60.96	13	25.240.4353.0	25.240.1353.0		
50	50	71.12	66.04	14	25.240.4453.0	25.240.1453.0		
50	50	76.20	71.12	15	25.240.4553.0	25.240.1553.0		
50	50	81.28	76.20	16	25.240.4653.0	25.240.1653.0		
17 to 24 pole on request								

# PCB headers pitch 5.00/5.08 mm

# wiecon

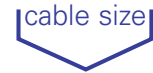

Rated current:  
12 A

250 V/4 kV/3 – overvoltage category III  
400 V/4 kV/2 – overvoltage category II  
1000 V/4 kV/1 – overvoltage category I

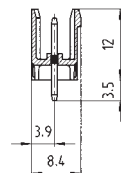
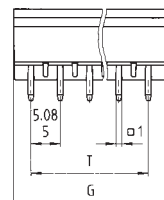
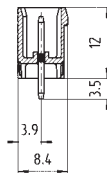
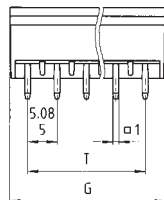

Solder pin 1 x 1 mm  
Drill hole Ø 1.4 mm



Solder pin 1 x 1 mm  
Drill hole Ø 1.4 mm

**closed version**

**Type 8113 S/... G, 8213 S/... G**

Connection vertical to PCB

**open version**

**Type 8113 S/... GOF, 8213 S/... GOF**

Connection vertical to PCB

Rated voltages VDE 0110

UL Data

CSA Data

Approvals

300 V 15 A

300 V 15 A

300 V 15 A

300 V 15 A



Box Qty	G	T	Pole	Part No.	G	T	Part No.
<b>Pitch 5.00 mm</b>				unmarked	unmarked		
100	10.16	5	2	25.330.3253.0	10	5	99.202.9996.0
100	15.24	10	3	25.330.3353.0	15	10	99.203.9996.0
50	20.32	15	4	25.330.3453.0	20	15	99.204.9996.0
50	25.40	20	5	25.330.3553.0	25	20	99.205.9996.0
50	30.48	25	6	25.330.3653.0	30	25	99.206.9996.0
50	35.56	30	7	25.330.3753.0	35	30	99.207.9996.0
50	40.64	35	8	25.330.3853.0	40	35	99.208.9996.0
50	45.72	40	9	25.330.3953.0	45	40	99.209.9996.0
50	50.80	45	10	25.330.4053.0	50	45	99.210.9996.0
50	55.88	50	11	25.330.4153.0	55	50	99.211.9996.0
50	60.96	55	12	25.330.4253.0	60	55	99.212.9996.0
50	66.04	60	13	25.330.4353.0	65	60	99.213.9996.0
50	71.12	65	14	25.330.4453.0	70	65	99.214.9996.0
50	76.20	70	15	25.330.4553.0	75	70	99.215.9996.0
50	81.28	75	16	25.330.4653.0	80	75	99.216.9996.0
17 to 24 pole on request					17 to 24 pole on request		
<b>Pitch 5.08 mm</b>				unmarked	unmarked		
100	11.56	5.08	2	25.350.3253.0	10.16	5.08	99.232.9996.1
100	16.64	10.16	3	25.350.3353.0	15.24	10.16	99.233.9996.1
50	21.72	15.24	4	25.350.3453.0	20.32	15.24	99.234.9996.1
50	26.80	20.32	5	25.350.3553.0	25.40	20.32	99.235.9996.1
50	31.88	25.40	6	25.350.3653.0	30.48	25.40	99.236.9996.1
50	36.96	30.48	7	25.350.3753.0	35.56	30.48	99.237.9996.1
50	42.04	35.56	8	25.350.3853.0	40.64	35.56	99.238.9996.1
50	47.12	40.64	9	25.350.3953.0	45.72	40.64	99.239.9996.1
50	52.20	45.72	10	25.350.4053.0	50.80	45.72	99.240.9996.1
50	57.28	50.80	11	25.350.4153.0	55.88	50.80	99.241.9996.1
50	62.36	55.88	12	25.350.4253.0	60.96	55.88	99.242.9996.1
50	67.44	60.96	13	25.350.4353.0	66.04	60.96	99.243.9996.1
50	72.52	66.04	14	25.350.4453.0	70.12	66.04	99.244.9996.1
50	77.60	71.12	15	25.350.4553.0	75.20	71.12	99.245.9996.1
50	82.68	76.20	16	25.350.4653.0	80.28	76.20	99.246.9996.1
17 to 24 pole on request					17 to 24 pole on request		
<b>Accessories:</b>							
Coding part (branch)	100			05.561.0053.0	05.561.0053.0		
Mounting bracket assembly - for double ended screw fixing of header	100			Z5.523.2453.0			

# PCB headers pitch 5.00/5.08 mm

# wiecon PCB

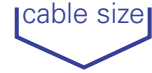

Rated current:  
12 A

Rated voltages:  
250 V/4 kV/3 – overvoltage category III  
400 V/4 kV/2 – overvoltage category II  
1000 V/4 kV/1 – overvoltage category I

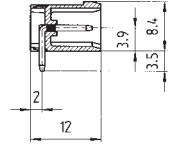
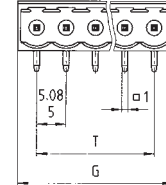
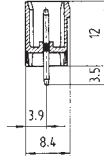
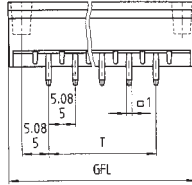

Solder pin 1 x 1 mm  
Drill hole Ø 1.4 mm

**with screw flange**

**Type 8113 S/... GF, 8213 S/... GF**

Connection vertical to PCB



Solder pin 1 x 1 mm  
Drill hole Ø 1.4 mm

**closed version**

**Type 8113 S/... W, 8213 S/... W**

Connection horizontal to PCB

Rated voltages VDE 0110

UL Data

CSA Data

Approvals

300 V 15 A  
300 V 15 A

300 V 15 A  
300 V 15 A



Box Qty	G	T	Pole	Part No.	GFL	T	Part No.
<b>Pitch 5.00 mm</b>				unmarked	unmarked		
100	11.40	5	2	25.338.3253.0	20	5	25.332.3253.0
100	16.40	10	3	25.338.3353.0	25	10	25.332.3353.0
50	21.40	15	4	25.338.3453.0	30	15	25.332.3453.0
50	26.40	20	5	25.338.3553.0	35	20	25.332.3553.0
50	31.40	25	6	25.338.3653.0	40	25	25.332.3653.0
50	36.40	30	7	25.338.3753.0	45	30	25.332.3753.0
50	41.40	35	8	25.338.3853.0	50	35	25.332.3853.0
50	46.40	40	9	25.338.3953.0	55	40	25.332.3953.0
50	51.40	45	10	25.338.4053.0	60	45	25.332.4053.0
50	56.40	50	11	25.338.4153.0	65	50	25.332.4153.0
50	61.40	55	12	25.338.4253.0	70	55	25.332.4253.0
50	66.40	60	13	25.338.4353.0	75	60	25.332.4353.0
50	71.40	65	14	25.338.4453.0	80	65	25.332.4453.0
50	76.40	70	15	25.338.4553.0	85	70	25.332.4553.0
50	81.40	75	16	25.338.4653.0	90	75	25.332.4653.0
				17 to 22 pole on request	17 to 24 pole on request		
<b>Pitch 5.08 mm</b>				unmarked	unmarked		
100	11.56	5.08	2	25.359.3253.0	20.32	5.08	25.352.3253.0
100	16.64	10.16	3	25.359.3353.0	25.40	10.16	25.352.3353.0
50	21.72	15.24	4	25.359.3453.0	30.48	15.24	25.352.3453.0
50	26.80	20.32	5	25.359.3553.0	35.56	20.32	25.352.3553.0
50	31.88	25.40	6	25.359.3653.0	40.64	25.40	25.352.3653.0
50	36.96	30.48	7	25.359.3753.0	45.72	30.48	25.352.3753.0
50	42.04	35.56	8	25.359.3853.0	50.80	35.56	25.352.3853.0
50	47.12	40.64	9	25.359.3953.0	55.88	40.64	25.352.3953.0
50	52.20	45.72	10	25.359.4053.0	60.96	45.72	25.352.4053.0
50	57.28	50.80	11	25.359.4153.0	66.04	50.80	25.352.4153.0
50	62.36	55.88	12	25.359.4253.0	71.12	55.88	25.352.4253.0
50	67.44	60.96	13	25.359.4353.0	76.20	60.96	25.352.4353.0
50	72.52	66.04	14	25.359.4453.0	81.28	66.04	25.352.4453.0
50	77.60	71.12	15	25.359.4553.0	86.36	71.12	25.352.4553.0
50	82.68	76.20	16	25.359.4653.0	91.44	76.20	25.352.4653.0
				17 to 22 pole on request	17 to 24 pole on request		
<b>Accessories:</b>							
Coding part (branch)	100			05.561.0053.0	05.561.0053.0		
Mounting bracket assembly - for double ended screw fixing of header	100			Z5.523.2453.0	Z5.523.2453.0		

# PCB header pitch 5.00/5.08 mm

# wiecon

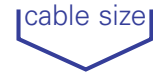

Rated current:  
12 A

250 V/4 kV/3 – overvoltage category III  
400 V/4 kV/2 – overvoltage category II  
1000 V/4 kV/1 – overvoltage category I

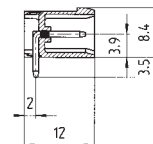
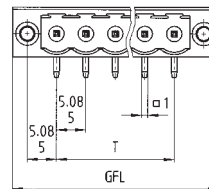
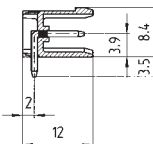
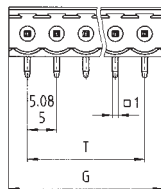

Solder pin 1 x 1 mm  
Drill hole Ø 1.4 mm

**open version**

**Type 8113 S/... WOF, 8213 S/... WOF**  
Connection horizontal to PCB



Solder pin 1 x 1 mm  
Drill hole Ø 1.4 mm

**with screw flange**

**Type 8113 S/... WF, 8213 S/... WF**  
Connection horizontal to PCB

Rated voltages VDE 0110  
UL Data  
CSA Data  
Approvals

300 V 15 A  
300 V 15 A



300 V 15 A  
300 V 15 A

	Box Qty	G	T	Pole	Part No.	GFL	G	T	Part No.
<b>Pitch 5.00 mm</b>					unmarked				unmarked
	100	11.40	5	2	99.262.9996.0	20	10	5	25.339.3253.0
	100	16.40	10	3	99.263.9996.0	25	15	10	25.339.3353.0
	50	21.40	15	4	99.264.9996.0	30	20	15	25.339.3453.0
	50	26.40	20	5	99.265.9996.0	35	25	20	25.339.3553.0
	50	31.40	25	6	99.266.9996.0	40	30	25	25.339.3653.0
	50	36.40	30	7	99.267.9996.0	45	35	30	25.339.3753.0
	50	41.40	35	8	99.268.9996.0	50	40	35	25.339.3853.0
	50	46.40	40	9	99.269.9996.0	55	45	40	25.339.3953.0
	50	51.40	45	10	99.270.9996.0	60	50	45	25.339.4053.0
	50	56.40	50	11	99.271.9996.0	65	55	50	25.339.4153.0
	50	61.40	55	12	99.272.9996.0	70	60	55	25.339.4253.0
	50	66.40	60	13	99.273.9996.0	75	65	60	25.339.4353.0
	50	71.40	65	14	99.274.9996.0	80	70	65	25.339.4453.0
	50	76.40	70	15	99.275.9996.0	85	75	70	25.339.4553.0
	50	81.40	75	16	99.276.9996.0	90	80	75	25.339.4653.0
	17 to 24 pole on request					17 to 22 pole on request			
<b>Pitch 5.08 mm</b>					unmarked				unmarked
	100	11.56	5.08	2	99.202.9996.2	20.32	10.16	5.08	25.358.3253.0
	100	16.64	10.16	3	99.203.9996.2	25.40	15.24	10.16	25.358.3353.0
	50	21.72	15.24	4	99.204.9996.2	30.48	20.32	15.24	25.358.3453.0
	50	26.80	20.32	5	99.205.9996.2	35.56	25.40	20.32	25.358.3553.0
	50	31.88	25.40	6	99.206.9996.2	40.64	30.48	25.40	25.358.3653.0
	50	36.96	30.48	7	99.207.9996.2	45.72	35.56	30.48	25.358.3753.0
	50	42.04	35.56	8	99.208.9996.2	50.80	40.64	35.56	25.358.3853.0
	50	47.12	40.64	9	99.209.9996.2	55.88	45.72	40.64	25.358.3953.0
	50	52.20	45.72	10	99.210.9996.2	60.96	50.80	45.72	25.358.4053.0
	50	57.28	50.80	11	99.211.9996.2	66.04	55.88	50.80	25.358.4153.0
	50	62.36	55.88	12	99.212.9996.2	71.12	60.96	55.88	25.358.4253.0
	50	67.44	60.96	13	99.213.9996.2	76.20	66.04	60.96	25.358.4353.0
	50	72.52	66.04	14	99.214.9996.2	81.28	71.12	66.04	25.358.4453.0
	50	77.60	71.12	15	99.215.9996.2	86.36	76.20	71.12	25.358.4553.0
	50	82.68	76.20	16	99.216.9996.2	91.44	81.28	76.20	25.358.4653.0
	17 to 24 pole on request					17 to 22 pole on request			
<b>Accessories:</b>									
Coding part (branch)	100				05.561.0053.0	05.561.0053.0			
Mounting bracket assembly - for double ended screw fixing of header	100				Z5.523.2453.0				

# PCB headers pitch 7.50/7.62 mm

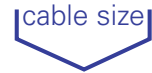

# wiecon PCB

Rated current:  
12 A

250 V/4 kV/3 – overvoltage category III  
400 V/4 kV/2 – overvoltage category II  
1000 V/4 kV/1 – overvoltage category I

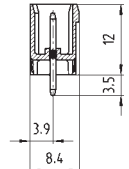
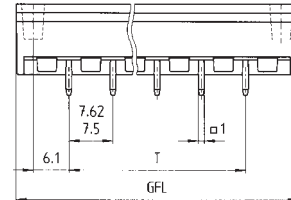
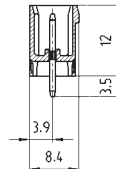
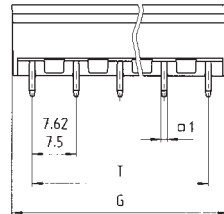

Solder pin 1 x 1 mm  
Drill hole Ø 1.4 mm

**closed version**

**Type 8313 S/... G, 8413 S/... G**

Connection vertical to PCB



Solder pin 1 x 1 mm  
Drill hole Ø 1.4 mm

**with screw flange**

**Type 8313 S/... GF, 8413 S/... GF**

Connection vertical to PCB

Rated voltages VDE 0110

UL Data

CSA Data

Approvals

300 V 15 A  
300 V 15 A

300 V 15 A  
300 V 15 A



Box Qty	G	T	Pole	Part No.	GFL	T	Part No.
<b>Pitch 7.50 mm</b>				unmarked			unmarked
100	14.20	7.50	2	25.370.3253.0	25.54	7.50	25.374.6253.0
100	21.70	15.00	3	25.370.3353.0	33.04	15.00	25.374.6353.0
50	29.20	22.50	4	25.370.3453.0	40.54	22.50	25.374.6453.0
50	36.70	30.00	5	25.370.3553.0	48.04	30.00	25.374.6553.0
50	44.20	37.50	6	25.370.3653.0	55.54	37.50	25.374.6653.0
50	51.70	45.00	7	25.370.3753.0	63.04	45.00	25.374.6753.0
50	59.20	52.50	8	25.370.3853.0	70.54	52.50	25.374.6853.0
50	66.70	60.00	9	25.370.3953.0	78.04	60.00	25.374.6953.0
50	74.20	67.50	10	25.370.4053.0	85.54	67.50	25.374.7053.0
50	81.70	75.00	11	25.370.4153.0	93.04	75.00	25.374.7153.0
50	89.20	82.50	12	25.370.4253.0	100.54	82.50	25.374.7253.0
<b>Pitch 7.62 mm</b>				unmarked			unmarked
100	14.32	7.62	2	25.390.3253.0	25.66	7.62	25.398.6253.0
100	21.94	15.24	3	25.390.3353.0	33.25	15.24	25.398.6353.0
50	29.56	22.86	4	25.390.3453.0	40.90	22.86	25.398.6453.0
50	37.18	30.48	5	25.390.3553.0	48.52	30.48	25.398.6553.0
50	44.80	38.10	6	25.390.3653.0	56.14	38.10	25.398.6653.0
50	52.42	45.72	7	25.390.3753.0	63.76	45.72	25.398.6753.0
50	60.04	53.34	8	25.390.3853.0	71.38	53.34	25.398.6853.0
50	67.66	60.64	9	25.390.3953.0	79.00	60.64	25.398.6953.0
50	75.28	68.58	10	25.390.4053.0	86.62	68.58	25.398.7053.0
50	82.90	76.20	11	25.390.4153.0	94.24	76.20	25.398.7153.0
50	90.52	83.82	12	25.390.4253.0	101.86	83.82	25.398.7253.0
<b>Accessories:</b>							
Coding part (branch)	100			05.561.0053.0	05.561.0053.0		
Mounting bracket assembly - for double ended screw fixing of header	100			Z5.523.2453.0			



# PCB headers pitch 7.50/7.62 mm

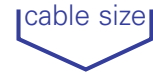

Rated current:  
12 A

400 V/6 kV/3 – overvoltage category III  
690 V/6 kV/2 – overvoltage category II  
1000 V/6 kV/1 – overvoltage category I

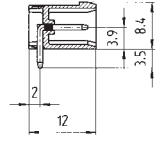
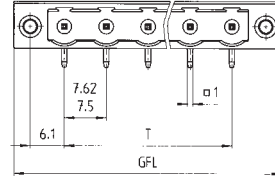
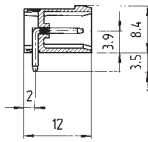
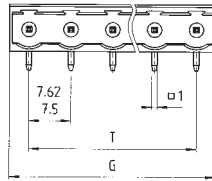

Solder pin 1 x 1 mm  
Drill hole Ø 1.4 mm

**closed version**

**Type 8313 S/... W, 8413 S/... W**

Connection horizontal to PCB



Solder pin 1 x 1 mm  
Drill hole Ø 1.4 mm

**with screw flange**

**Type 8313 S/... WF, 8413 S/... WF**

Connection horizontal to PCB

Rated voltages VDE 0110

UL Data

CSA Data

Approvals

300 V 15 A  
300 V 15 A



300 V 15 A  
300 V 15 A

Box Qty	G	T	Pole	Part No.	GFL	T	Part No.
<b>Pitch 7.50 mm</b>				unmarked	unmarked		
100	14.40	7.50	2	25.372.3253.0	25.54	7.50	25.374.2253.0
100	21.90	15.00	3	25.372.3353.0	33.04	15.00	25.374.2353.0
50	29.40	22.50	4	25.372.3453.0	40.54	22.50	25.374.2453.0
50	36.90	30.00	5	25.372.3553.0	48.04	30.00	25.374.2553.0
50	44.40	37.50	6	25.372.3653.0	55.54	37.50	25.374.2653.0
50	51.90	45.00	7	25.372.3753.0	63.04	45.00	25.374.2753.0
50	59.40	52.50	8	25.372.3853.0	70.54	52.50	25.374.2853.0
50	66.90	60.00	9	25.372.3953.0	78.04	60.00	25.374.2953.0
50	74.40	67.50	10	25.372.4053.0	85.54	67.50	25.374.3053.0
50	81.90	75.00	11	25.372.4153.0	93.04	75.00	25.374.3153.0
50	89.40	82.50	12	25.372.4253.0	100.54	82.50	25.374.3253.0
<b>Pitch 7.62 mm</b>				unmarked	unmarked		
100	14.52	7.62	2	25.392.3253.0	25.66	7.62	25.398.2253.0
100	22.14	15.24	3	25.392.3353.0	33.25	15.24	25.398.2353.0
50	29.76	22.86	4	25.392.3453.0	40.90	22.86	25.398.2453.0
50	37.38	30.48	5	25.392.3553.0	48.52	30.48	25.398.2553.0
50	45.00	38.10	6	25.392.3653.0	56.14	38.10	25.398.2653.0
50	52.62	45.72	7	25.392.3753.0	63.76	45.72	25.398.2753.0
50	60.24	53.34	8	25.392.3853.0	71.38	53.34	25.398.2853.0
50	67.86	60.64	9	25.392.3953.0	79.00	60.64	25.398.2953.0
50	75.48	68.58	10	25.392.4053.0	86.62	68.58	25.398.3053.0
50	83.10	76.20	11	25.392.4153.0	94.24	76.20	25.398.3153.0
50	90.72	83.82	12	25.392.4253.0	101.86	83.82	25.398.3253.0
<b>Accessories:</b>							
Coding part (branch)	100			05.561.0053.0	05.561.0053.0		
Mounting bracket assembly - for double ended screw fixing of header	100			Z5.523.2453.0			

**PCB headers**  
pitch 5.00/5.08 mm

**wiecon** PCB

cable size

Rated current:  
12 A

250 V/4 kV/3 – overvoltage category III  
400 V/4 kV/2 – overvoltage category II  
1000 V/4 kV/1 – overvoltage category I

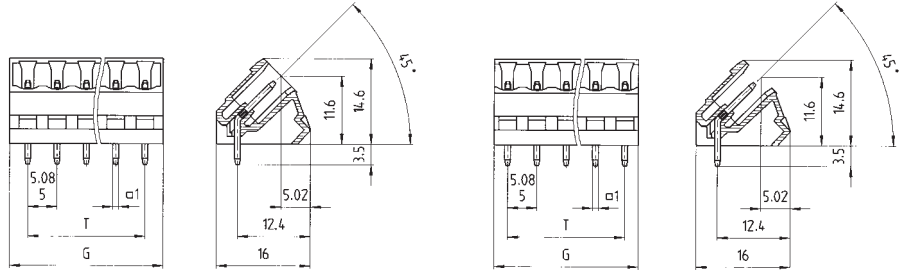

Solder pin 1 x 1 mm  
Drill hole Ø 1.4 mm



Solder pin 1 x 1 mm  
Drill hole Ø 1.4 mm

**closed version**

**open version**

**Type 8113 S/... S, 8213 S/... S**

**Type 8113 S/... S1, 8213 S/... S1**

Connection at 45° to PCB

Connection at 45° to PCB

Rated voltages VDE 0110

UL Data

CSA Data

Approvals

300 V 15 A  
300 V 15 A

300 V 15 A  
300 V 15 A



Box Qty	G	T	Pole	Part No.	G	T	Part No.
<b>Pitch 5.00 mm</b>				unmarked	unmarked		
100	11.20	5	2	25.394.3253.0	9.60	5	25.395.3253.0
100	16.20	10	3	25.394.3353.0	14.60	10	25.395.3353.0
50	21.20	15	4	25.394.3453.0	19.60	15	25.395.3453.0
50	26.20	20	5	25.394.3553.0	24.60	20	25.395.3553.0
50	31.20	25	6	25.394.3653.0	29.60	25	25.395.3653.0
50	36.20	30	7	25.394.3753.0	34.60	30	25.395.3753.0
50	41.20	35	8	25.394.3853.0	39.60	35	25.395.3853.0
50	46.20	40	9	25.394.3953.0	44.60	40	25.395.3953.0
50	51.20	45	10	25.394.4053.0	49.60	45	25.395.4053.0
50	56.20	50	11	25.394.4153.0	54.60	50	25.395.4153.0
50	61.20	55	12	25.394.4253.0	59.60	55	25.395.4253.0
50	66.20	60	13	25.394.4353.0	64.60	60	25.395.4353.0
50	71.20	65	14	25.394.4453.0	69.60	65	25.395.4453.0
50	76.20	70	15	25.394.4553.0	74.60	70	25.395.4553.0
50	81.20	75	16	25.394.4653.0	79.60	75	25.395.4653.0
17 to 24 pole on request							
<b>Pitch 5.08 mm</b>				unmarked	unmarked		
100	11.36	5.08	2	25.396.3253.0	9.76	5.08	25.397.3253.0
100	16.44	10.16	3	25.396.3353.0	14.84	10.16	25.397.3353.0
50	21.52	15.24	4	25.396.3453.0	19.92	15.24	25.397.3453.0
50	26.60	20.32	5	25.396.3553.0	25.00	20.32	25.397.3553.0
50	31.68	25.40	6	25.396.3653.0	30.08	25.40	25.397.3653.0
50	36.76	30.48	7	25.396.3753.0	35.16	30.48	25.397.3753.0
50	41.84	35.56	8	25.396.3853.0	40.24	35.56	25.397.3853.0
50	46.92	40.64	9	25.396.3953.0	45.32	40.64	25.397.3953.0
50	52.00	45.72	10	25.396.4053.0	50.40	45.72	25.397.4053.0
50	57.08	50.80	11	25.396.4153.0	55.48	50.80	25.397.4153.0
50	62.19	55.88	12	25.396.4253.0	60.56	55.88	25.397.4253.0
50	67.24	60.96	13	25.396.4353.0	65.64	60.96	25.397.4353.0
50	72.32	66.04	14	25.396.4453.0	70.72	66.04	25.397.4453.0
50	77.40	71.12	15	25.396.4553.0	75.80	71.12	25.397.4553.0
50	82.48	76.20	16	25.396.4653.0	80.88	76.20	25.397.4653.0
17 to 24 pole on request							
<b>Accessories:</b>							
Coding part (branch)	100				05.561.0053.0	05.561.0053.0	

# PCB headers pitch 5.00/5.08 mm



Rated current:  
10 A

250 V/4 kV/3 – overvoltage category III  
400 V/4 kV/2 – overvoltage category II  
1000 V/4 kV/1 – overvoltage category I

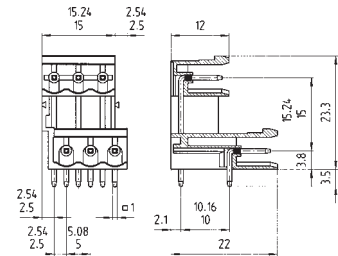
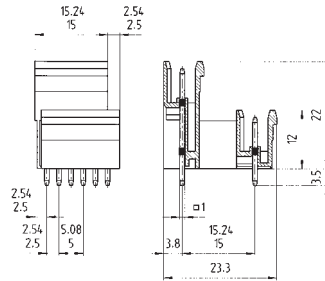

Solder pin 1 x 1 mm  
Drill hole Ø 1.4 mm



Solder pin 1 x 1 mm  
Drill hole Ø 1.4 mm

## Type 8113 SE/... G, 8213 SE/... G

Connection vertical to PCB

## Type 8113 SE/... W, 8213 SE/... W

Connection horizontal to PCB

Rated voltages VDE 0110

UL Data

CSA Data

Approvals

300 V 15 A  
300 V 10 A

300 V 15 A  
300 V 10 A



Box Qty	T	Pole	Part No.	Part No.
<b>Pitch 5.00 mm</b>			unmarked	unmarked
100	5	2 x 2	25.334.3253.0	25.336.3253.0
100	10	2 x 3	25.334.3353.0	25.336.3353.0
Larger pole numbers can be achieved by latching together				
<b>Pitch 5.08 mm</b>			unmarked	unmarked
100	5.08	2 x 2	25.354.3253.0	25.356.3253.0
100	10.16	2 x 3	25.354.3353.0	25.356.3353.0
Larger pole numbers can be achieved by latching together				
<b>Accessories:</b>				
End plate	50		07.310.9853.0	07.310.9853.0
Mounting bracket assembly - for double ended screw fixing of header			on request	Only in connection with end plate 07.310.9853.0 Z5.523.2453.0

**PCB Headers**  
pitch 5.00/5.08 mm

**wiecon** PCB

Rated current: 10 A

250 V/4 kV/3 – overvoltage category III  
400 V/4 kV/2 – overvoltage category III  
400 V/4 kV/2 – overvoltage category II

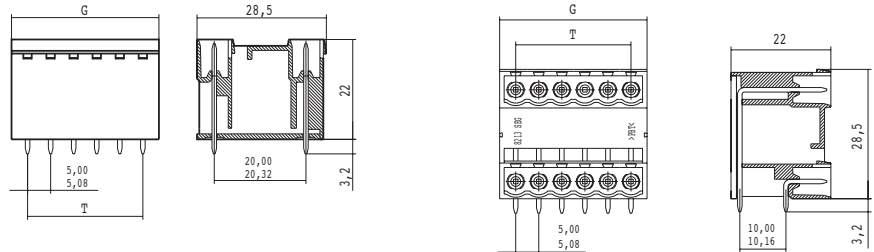

Solder pin 1 x 1 mm  
Drill hole Ø 1.3 mm



Solder pin 1 x 1 mm  
Drill hole Ø 1.3 mm

**Type 81-8213 SEG .../G**

**Type 81-8213 SEG .../W**

Rated voltages VDE 0110  
UL Data  
CSA Data  
Approvals

300 V 10 A  
300 V 10 A

300 V 10 A  
300 V 10 A



Box Qty	G	T	Pole	Part No.	Part No.
<b>Pitch 5.00 mm</b>				unmarked	unmarked
100	12	5	4	27.334.0253.0	27.336.0253.0
100	17	10	6	27.334.0353.0	27.336.0353.0
50	22	15	8	27.334.0453.0	27.336.0453.0
50	27	20	10	27.334.0553.0	27.336.0553.0
50	32	25	12	27.334.0653.0	27.336.0653.0
50	37	30	14	27.334.0753.0	27.336.0753.0
50	42	35	16	27.334.0853.0	27.336.0853.0
50	47	40	18	27.334.0953.0	27.336.0953.0
50	52	45	20	27.334.1053.0	27.336.1053.0
50	57	50	22	27.334.1153.0	27.336.1153.0
50	62	55	24	27.334.1253.0	27.336.1253.0
50	67	60	26	27.334.1353.0	27.336.1353.0
50	72	65	28	27.334.1453.0	27.336.1453.0
50	77	70	30	27.334.1553.0	27.336.1553.0
50	82	75	32	27.334.1653.0	27.336.1653.0
1 to 24 pole on request					
<b>Pitch 5.08 mm</b>				unmarked	unmarked
100	12.16	5.08	4	27.354.0253.0	27.356.0253.0
100	17.24	10.16	6	27.354.0353.0	27.356.0353.0
50	22.32	15.24	8	27.354.0453.0	27.356.0453.0
50	27.40	20.32	10	27.354.0553.0	27.356.0553.0
50	32.48	25.40	12	27.354.0653.0	27.356.0653.0
50	37.56	30.48	14	27.354.0753.0	27.356.0753.0
50	42.64	35.56	16	27.354.0853.0	27.356.0853.0
50	47.72	40.64	18	27.354.0953.0	27.356.0953.0
50	52.80	45.72	20	27.354.1053.0	27.356.1053.0
50	57.88	50.80	22	27.354.1153.0	27.356.1153.0
50	62.96	55.88	24	27.354.1253.0	27.356.1253.0
50	68.04	60.96	26	27.354.1353.0	27.356.1353.0
50	73.12	66.04	28	27.354.1453.0	27.356.1453.0
50	78.20	71.12	30	27.354.1553.0	27.356.1553.0
50	83.28	76.20	32	27.354.1653.0	27.356.1653.0
1 to 24 pole on request					
				Coding available on request	Coding available on request

# Headers for panel mounting, pitch 5.08 mm

# wiecon

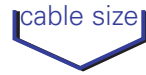

### Wire wrap connection 1 x 1

Max. diameter of interconnecting wire Ø: 0.8 mm

Rated current: 6.5 A

### Solder connection

Rated cross section  
1.5 mm<sup>2</sup> single core/  
1.0 mm<sup>2</sup> finely stranded

Rated current: 12 A

### Plug connection 2.8 x 0.8 DIN 46249

Rated cross section  
1.0 mm<sup>2</sup> finely stranded

Rated current: 8 A

250 V/4 kV/3 – overvoltage category III  
400 V/4 kV/2 – overvoltage category II  
1000 V/4 kV/1 – overvoltage category I

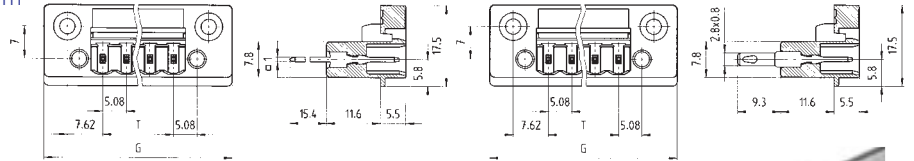

**Wire-Wrap**

**Type 8213 S/... DFWW,  
8213 S/... DFWW M**



**with solder connection**

**Type 8213 S/... DFLS,  
8213 S/... DFLS M**

Rated voltages VDE 0110

UL Data

CSA Data

Approvals

No. 22 – 12 AWG

300 V

6.5 A

No. 22 – 12 AWG

300 V

6.5 A



No. 22 – 12 AWG

300 V

12/8 A

No. 22 – 12 AWG

300 V

12/8 A



Box Qty	G	T	Pole	Part No.	Part No.	Part No.	Part No.
<b>Pitch 5.08 mm</b>							
				unmarked	unmarked	unmarked	unmarked
100	30.48	5.08	2	25.303.0253.0	25.313.0253.0	25.303.3253.0	25.313.3253.0
100	35.56	10.16	3	25.303.0353.0	25.313.0353.0	25.303.3353.0	25.313.3353.0
50	40.64	15.24	4	25.303.0453.0	25.313.0453.0	25.303.3453.0	25.313.3453.0
50	45.72	20.32	5	25.303.0553.0	25.313.0553.0	25.303.3553.0	25.313.3553.0
50	50.80	25.40	6	25.303.0653.0	25.313.0653.0	25.303.3653.0	25.313.3653.0
50	55.88	30.48	7	25.303.0753.0	25.313.0753.0	25.303.3753.0	25.313.3753.0
50	60.96	35.56	8	25.303.0853.0	25.313.0853.0	25.303.3853.0	25.313.3853.0
50	66.04	40.64	9	25.303.0953.0	25.313.0953.0	25.303.3953.0	25.313.3953.0
50	71.12	45.72	10	25.303.1053.0	25.313.1053.0	25.303.4053.0	25.313.4053.0
50	76.20	50.80	11	25.303.1153.0	25.313.1153.0	25.303.4153.0	25.313.4153.0
50	81.28	55.88	12	25.303.1253.0	25.313.1253.0	25.303.4253.0	25.313.4253.0
50	86.36	60.96	13	25.303.1353.0	25.313.1353.0	25.303.4353.0	25.313.4353.0
50	91.44	66.04	14	25.303.1453.0	25.313.1453.0	25.303.4453.0	25.313.4453.0
50	96.52	71.12	15	25.303.1553.0	25.313.1553.0	25.303.4553.0	25.313.4553.0
50	101.60	76.20	16	25.303.1653.0	25.313.1653.0	25.303.4653.0	25.313.4653.0
17 to 22 pole on request				without press in nut	with press in nut for screw flange	without press in nut	with press in nut for screw flange
<b>Dimensions for panel cut out</b>							
	a	b					
	13.18	20.32	2				
	18.26	25.40	3				
	23.34	30.48	4				
	28.42	35.56	5				
	33.50	40.64	6				
	38.58	45.72	7				
	43.66	50.80	8				
	48.74	55.08	9				
	53.82	60.96	10				
	58.90	66.04	11				
	68.98	71.12	12				
	69.06	76.20	13				
	74.14	81.28	14				
	79.22	86.36	15				
	84.30	91.44	16				
1 to 24 pole on request							
<b>Accessories:</b>							
Coding part (branch)	100			05.561.0053.0		05.561.0053.0	
Screw assembly	100			Z6.012.0812.0		Z6.012.0812.0	

# Accessories for 8113 – 8413/8813 and 8213 BL

# wiecon PCB

Drilling plan for mounting bracket Z5.523.2453.0

Type 8113 SE/... and 8213 SE/...

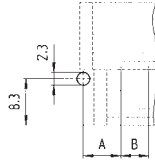

	A	B
8113	6.3	5.00
8213	6.8	5.08

Drilling plan for mounting bracket Z5.523.2453.0

Type 81 – 8413 S/...

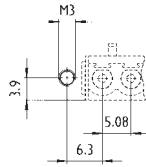
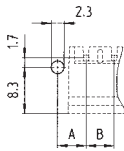
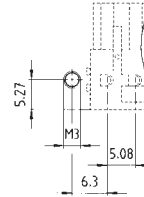
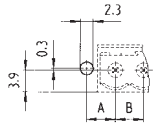

	A	B
8113	5.1	5.00
8213	5.2	5.08
8313	5.4	7.50
8413	5.4	7.62

## 8113 – 8413/8813

## 8213 BL

		Part No.	Box Qty	Part No.	Box Qty																										
<p>Mounting bracket (Type 8113 – 8413)</p> <p>End plate for two tier header (Type 8113 – 8213 SE)</p> <p>Coding branch for header (Type 8113 – 8413, Type 8813)</p> <p>– socket connector (Type 8113 – 8413)</p>	Z5.523.2453.0	100	Adhesive marking strips for socket connectors and headers with 5/5.08 mm pitch																												
	07.310.9853.0	50	<table border="1"> <tbody> <tr><td>1 – 12</td><td>04.007.4089.0</td><td>1</td></tr> <tr><td>13 – 24</td><td>04.007.4189.0</td><td>1</td></tr> <tr><td>25 – 36</td><td>04.007.4289.0</td><td>1</td></tr> <tr><td>37 – 68</td><td>04.007.4389.0</td><td>1</td></tr> <tr><td>49 – 60</td><td>04.007.4489.0</td><td>1</td></tr> <tr><td>61 – 72</td><td>04.007.4589.0</td><td>1</td></tr> <tr><td>73 – 84</td><td>04.007.4689.0</td><td>1</td></tr> <tr><td>85 – 96</td><td>04.007.4789.0</td><td>1</td></tr> <tr><td>97 – 108</td><td>04.007.4889.0</td><td>1</td></tr> </tbody> </table>		1 – 12	04.007.4089.0	1	13 – 24	04.007.4189.0	1	25 – 36	04.007.4289.0	1	37 – 68	04.007.4389.0	1	49 – 60	04.007.4489.0	1	61 – 72	04.007.4589.0	1	73 – 84	04.007.4689.0	1	85 – 96	04.007.4789.0	1	97 – 108	04.007.4889.0	1
	1 – 12	04.007.4089.0			1																										
	13 – 24	04.007.4189.0			1																										
25 – 36	04.007.4289.0	1																													
37 – 68	04.007.4389.0	1																													
49 – 60	04.007.4489.0	1																													
61 – 72	04.007.4589.0	1																													
73 – 84	04.007.4689.0	1																													
85 – 96	04.007.4789.0	1																													
97 – 108	04.007.4889.0	1																													
05.561.0053.0	a 100																														
05.561.9153.0	100																														
<p>Mounting bracket assembly for headers</p> <p>Mounting bracket assembly with end plate for two tier headers</p>			<p>Mounting bracket</p> <p>Z5.523.7753.0</p> <p>100</p> <p>Z5.523.7853.0</p> <p>100</p>																												