

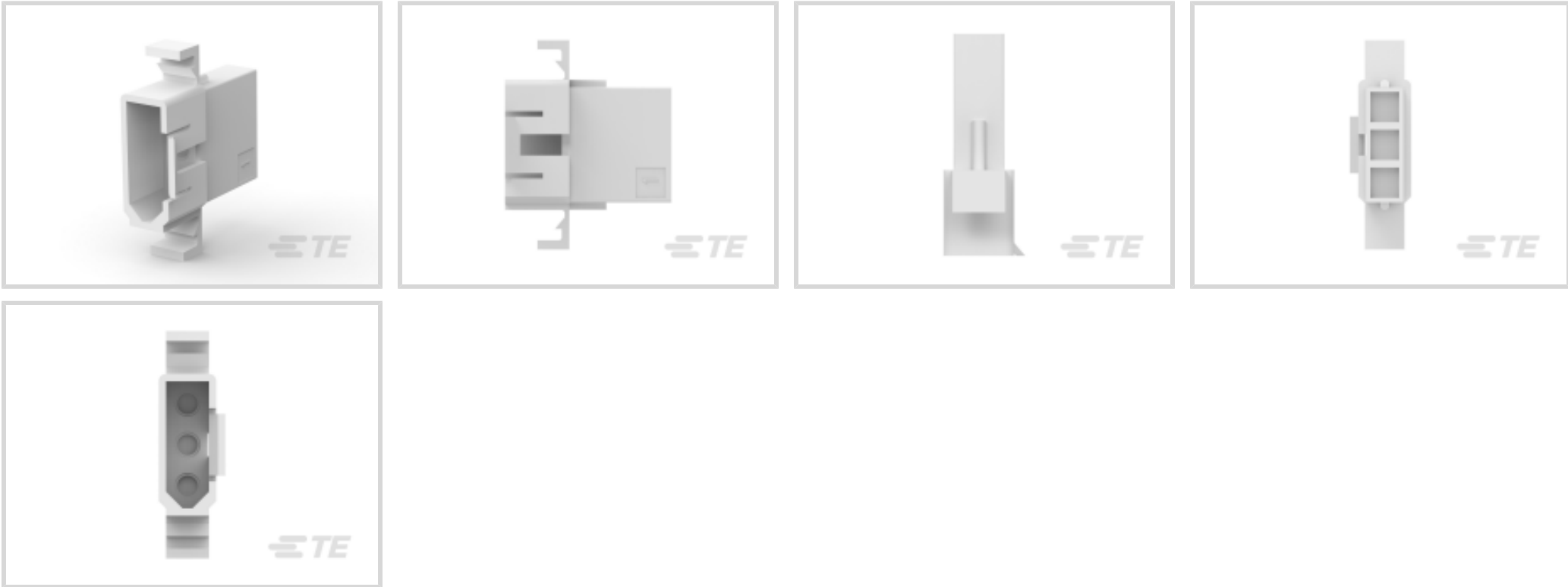

Connectors > Power Connectors > Rectangular Power > Rectangular Power Connectors



EU RoHS Compliance: **Compliant**  
EU ELV Compliance: **Compliant**  
Rectangular Power Connector Type: **Housing**  
Connector & Housing Type: **Plug**  
Connector System: **Wire-to-Panel, Wire-to-Wire**

Features

Other

EU RoHS Compliance	Compliant
EU ELV Compliance	Compliant

Product Type Features

Rectangular Power Connector Type	Housing
Connector & Housing Type	Plug
Connector System	Wire-to-Panel, Wire-to-Wire
Sealable	No
Connector & Contact Terminates To	Wire & Cable

Configuration Features

Number of Positions	3
Number of Signal Positions	3
Number of Rows	1

Electrical Characteristics

Operating Voltage	600 VAC
-------------------	---------



Contact Features

Contact Layout	Inline
Contact Retention Within Housing	Without
Contact Type	Pin

Termination Features

Termination Method to Wire & Cable	Crimp
------------------------------------	-------

Mechanical Attachment

Panel Mount Feature	With
Panel Mount Feature Type	Mounting Ears
Connector Mounting Type	Panel Mount

Housing Features

Centerline (Pitch)	6.35 mm[.25 in]
Housing Color	Natural
Housing Material	Nylon

Dimensions

Panel Thickness (Recommended)	1.57 mm[.062 in]
-------------------------------	------------------

Usage Conditions

Operating Temperature Range	-55 – 105 °C[-67 – 221 °F]
-----------------------------	----------------------------

Operation/Application

Circuit Application	Power & Signal
---------------------	----------------

Industry Standards

Compatible With Agency/Standards Products	UL, CSA
UL Rating	Recognized
Compatible With Approved Standards Products	UL E28476
CSA Rating	LR 7189, Certified
UL Flammability Rating	UL 94V-2
Glow Wire Rating	Standard Part - Not Glow Wire

Packaging Features

Packaging Quantity	1
Packaging Method	Package



Product Compliance

For compliance documentation, visit the product page on TE.com>

EU RoHS Directive 2011/65/EU	Compliant
EU ELV Directive 2000/53/EC	Compliant
China RoHS 2 Directive MIIT Order No 32, 2016	No Restricted Materials Above Threshold
EU REACH Regulation (EC) No. 1907/2006	Current ECHA Candidate List: JUNE 2024 (241) Candidate List Declared Against: JUNE 2024 (241) Does not contain REACH SVHC
Halogen Content	Low Halogen - Br, Cl, F, I < 900 ppm per homogenous material. Also BFR/CFR/PVC Free
Solder Process Capability	Not applicable for solder process capability

Product Compliance Disclaimer

This information is provided based on reasonable inquiry of our suppliers and represents our current actual knowledge based on the information they provided. This information is subject to change. The part numbers that TE has identified as EU RoHS compliant have a maximum concentration of 0.1% by weight in homogenous materials for lead, hexavalent chromium, mercury, PBB, PBDE, DBP, BBP, DEHP, DIBP, and 0.01% for cadmium, or qualify for an exemption to these limits as defined in the Annexes of Directive 2011/65/EU (RoHS2). Finished electrical and electronic equipment products will be CE marked as required by Directive 2011/65/EU. Components may not be CE marked. Additionally, the part numbers that TE has identified as EU ELV compliant have a maximum concentration of 0.1% by weight in homogenous materials for lead, hexavalent chromium, and mercury, and 0.01% for cadmium, or qualify for an exemption to these limits as defined in the Annexes of Directive 2000/53/EC (ELV). Regarding the REACH Regulation, the information TE provides on SVHC in articles for this part number is based on the latest European Chemicals Agency (ECHA) 'Guidance on requirements for substances in articles' posted at this URL: <https://echa.europa.eu/guidance-documents/guidance-on-reach>

Compatible Parts



TE Part # 770144-1  
.093 CP&S SOK PTPBR L/P 20-14



TE Part # 770147-1  
.093 CP&S PIN PTPBR LP 24-18



TE Part # 770339-1  
03P .093 COMM P&S RECPT .250CL



TE Part # 350416-1  
.093 COMM P&S PIN 14-20 PTPBR





TE Part # 770529-1  
.093 COMM P&S SOK 14-20 PTPBR



TE Part # 770530-1  
.093 COMM P&S PIN 14-20 PTPBR



TE Part # 350415-1  
.093 COMM P&S SOK 14-20 PTPBR



TE Part # 350418-1  
.093 COMM P&S PIN 18-24 PTPBR



TE Part # 350417-1  
.093 COMM P&S SOK 18-24 PTPBR



TE Part # 350415-5  
.093 COMM P&S SOK 20-14 AUBR



TE Part # 770145-1  
.093 COMM P&S PIN PTPBR LP



TE Part # 770146-1  
.093 CP&S SOK PTPBR LP 24-18



TE Part # 770269-1  
03P .093 COMM P&S RECPT .250CL



TE Part # 350416-5  
.093 COMM P&S PIN AU/NI/BR



TE Part # 770144-5  
.093 CP&S SOC AUBR L/P 20-14



TE Part # 350415-6  
.093 COMM P&S SOK 14-20 PTPHBZ



TE Part # 350417-5  
.093 COMM P&S SOK AU/NI/BR



TE Part # 770145-5  
.093 CP&S PIN AUBR LP 20-14



TE Part # 770146-5  
.093 CP&S SOK AUBR LP 24-18



TE Part # 770147-5  
.093 CP&S PIN AUBR LP 24-18

Also in the Series | Commercial Pin and Socket Connectors



Connector Contacts(41)



Insertion & Extraction Tools(3)



Rectangular Connector Housings(10)



Rectangular Power Connectors(84)



Standard Circular Connectors(1)

Customers Also Bought



TE Part #770276-1  
03P .093 COMM P&S PLUG .250CL

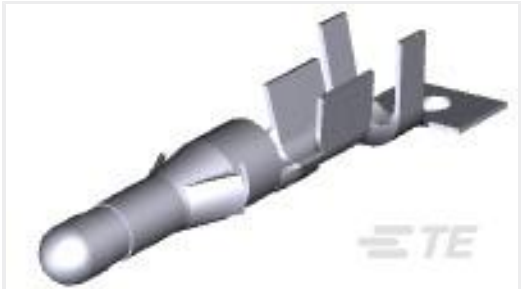

TE Part #350416-1  
.093 COMM P&S PIN 14-20 PTPBR



TE Part #1565917-4  
EMBOSS ASSY DDR2 SODIMM  
SOCKET 200P 5.2H

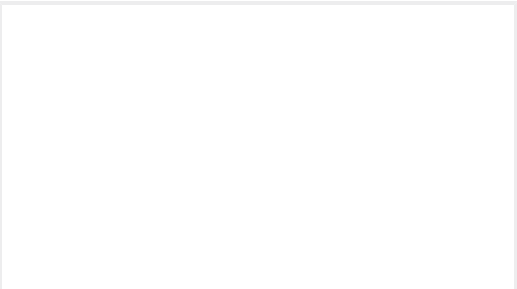

TE Part #154565  
3 WAY PIN HOUSING M-N-L

Documents

Product Drawings

03P .093 COMM P&S PLUG .250CL

English

CAD Files

Customer View Model

ENG\_CVM\_770338-1\_E.3d\_igs.zip

English

Customer View Model

ENG\_CVM\_770338-1\_E.3d\_stp.zip

English

Customer View Model

ENG\_CVM\_770338-1\_E.2d\_dxf.zip

English

3D PDF

English

3D PDF

3D

Customer View Model

ENG\_CVM\_CVM\_770338-1\_H.2d\_dxf.zip

English

Customer View Model

ENG\_CVM\_CVM\_770338-1\_H.3d\_igs.zip

English

Customer View Model





[ENG\\_CVM\\_CVM\\_770338-1\\_H.3d\\_stp.zip](#)

English

By downloading the CAD file I accept and agree to the [Terms and Conditions](#) of use.

Datasheets & Catalog Pages

[SOFT\\_SHELL\\_PIN\\_SOCKET\\_CONNECTORS\\_STANDARD\\_DENSITY](#)

English

Product Specifications

[Application Specification](#)

English

Agency Approvals

[CSA Certificate](#)

English