

HDMI female to female keystone coupler



HDMI female to female keystone coupler (KCHDbk, KCHDwh)

This HDMI female to female coupler can be used for easy snap-in mounting in a keystone patch panel, face plate or surface-mount box. It allows a connection in the end user's custom wall plate or panel and features gold-plated female connectors to assist HDMI high speed signal.

Features

- Keystone style HDMI Female/Female coupler
- HDMI High Speed compatible, supports HDMI 1.4, 2.0 and 2.1*
- Gold plated connectors and contacts for maximum signal quality and integrity
- Designed to fit industry standard keystone outlets and patch panels
- Also available as part of our Euro shutterless coupler, 6C coupler, panel mount coupler (standard and low profile) and our XLR style coupler – see below

Specifications

- Dimensions: 33 x 16.17 x 22.5mm (LxWxH)
- Colour: black or white
- Materials: ABS UL94V-0
- Connector: gold plated 19 pin contacts

Packaging: supplied in individual polythene bags, then in bags of 20.

EAN Numbers: **KCHDbk** – 5055386503725; **KCHDwh** – 5055386508690

KCHDBpm – 5055386509482

KCHDdpm – 5055386501639

KCHDpm – 5055386501707

KCHD45BKpt – 5055386512956

KCHD645bkpt – 5055386508720

Commodity Code: 85444920

Country of Origin: China

*KCHD is compliant with HDMI 2.1 providing it is used with HDMI 2.1 cables and the **total** cable length is no more than 5m



Low profile panel mount - KCHDBpm



D Universal - KCHDDpm



Panel mount - KCHDpm



Euro outlet - KCHD45BKpt



6c outlet - KCHD645bkpt

(HDMI is a registered trademark of HDMI Licensing)

ROHS Compliant

Code: KCHD

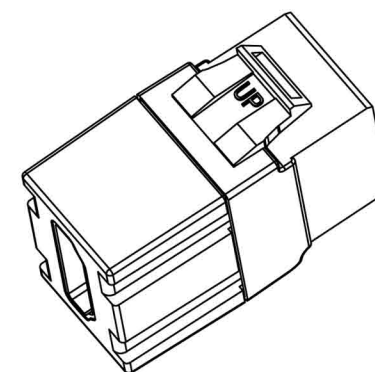
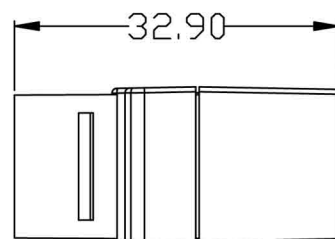
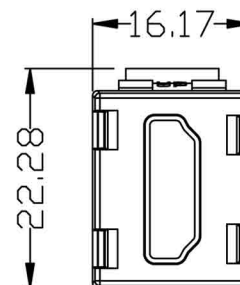
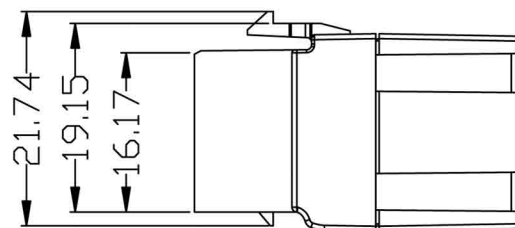
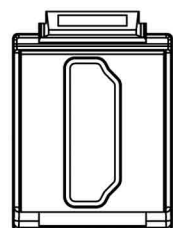
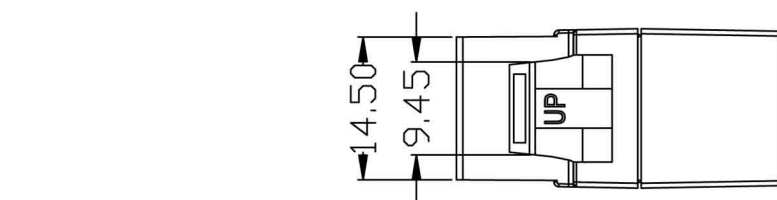

Specification:

Housing: High-impact Acrylonitrile Butadiene Styrene (ABS+PC resin)

UL 94 V-0 rated

PCB: FR-4 UL 94 V-0 rated

Electrical :

Volage Rating : 30VDC (rms)

Current Rating : 0.5AMPS Max

Insulation Resistance : 1000 megohms Min

Contact Resistance: 30 milliohms Max

Application:

HDMI Connector :

Shell: Copper alloy, plated with Nickel

Plastic: High-impact polybutylene terephthalate (PBT)

UL 94 V-0 rated, Glass filled 130°C

Contact: Copper alloy

CN1		CN2	
1	TMDS Data2+	1	TMDS Data2+
2	TMDS Data2-	2	TMDS Data2-
3	TMDS Data1+	3	TMDS Data1+
4	TMDS Data1-	4	TMDS Data1-
5	TMDS Data0+	5	TMDS Data0+
6	TMDS Data0-	6	TMDS Data0-
7	TMDS CLOCK+	7	TMDS CLOCK+
8	TMDS CLOCK-	8	TMDS CLOCK-
9	CEC	9	CEC
10	Reserved	10	Reserved
11	SCL	11	SCL
12	SDA	12	SDA
13	DDC/CEC	13	DDC/CEC
14	+5V	14	+5V
15	Hot Plug	15	Hot Plug