

# Sub-Subminiature Switch

## DG series



### Features

- Extremely small dimensions – only 12.8 x 5.8 x 6.6 mm
- Breaking capacity ranges from small switching currents and voltages to low-voltage applications up to 3 A 250 VAC, DC rating up to 3 A 30 VDC (UL)
- Approved according IEC 61058-1 / UL 61058-1
- CQC certified
- Available with or without auxiliary actuator
- Use on circuit boards with connections to the left or right and straight
- High mechanical operating life, depending on model > 1,000,000 operations

### Standard parts<sup>1</sup>

DGE3-E4AA	DGE3-E5RD	DGG3-E5LC	DGG3-E7RD
DGE3-E4LC	DGE3-E7AA	DGG3-E5RD	DGG3-E7LC
DGE3-E4RD	DGE3-E7LC	DGG3-E7AA	DGG3-E4RD
DGE3-E5LC	DGE3-E7RD	DGG3-E4LC	

<sup>1</sup>The part number configuration matrix below provides details to the part numbers above.

For configurable part numbers that are not listed above, not listed in your region, or for custom part numbers, contact the factory or your distributor.

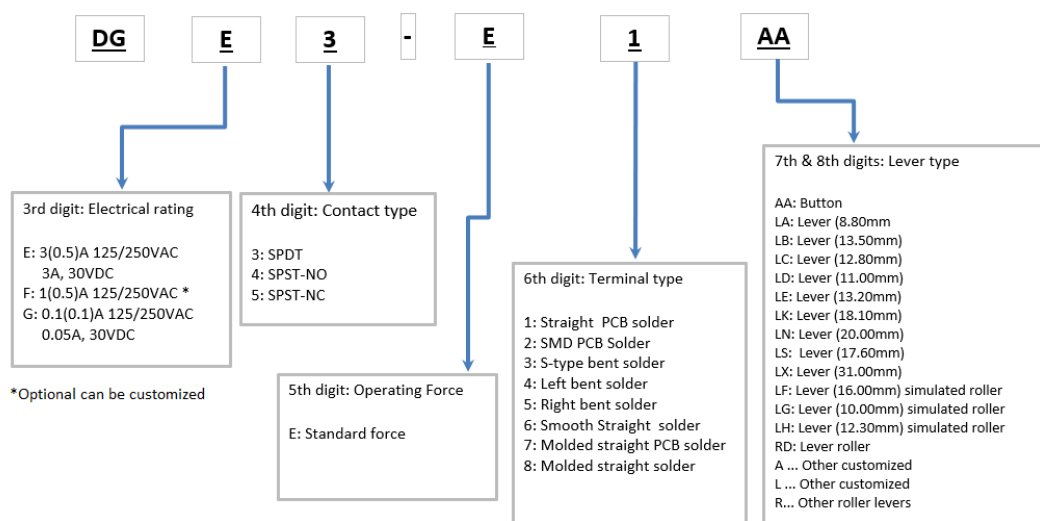

### Order Code Matrix

#### Order Code - DG



Please contact the factory if you are interested in lever types not covered in the matrix above. The length and shape of the lever can be adapted.

Materials

Base	PBT (UL 94V-0)
Cover	PBT (UL 94V-0)
Actuator	PBT (UL 94V-0)
Auxiliary actuator	Stainless steel
Terminals	CuZn striped silver-plated
Contacts DG E	Ag-Ni
DG G	Ag-Ni, gal. Au
Degree of protection switch interior	IP40
Approvals	 

Technical specifications

Contact configuration	S.P.D.T
Contact gap	< 3 mm (μ)
Switching voltage max.	250 V AC
Switching current	3 A
Electrical life (max. load)	25,000 operations
Operating force	140 cN without auxiliary actuator
Mechanical life	> 1 x 10 <sup>6</sup> operations
Total travel	0.7 mm without auxiliary actuator
Operating temperature	-25 °C to + 125 °C

Dimensions in mm

Terminals

PCB Terminal

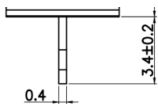

PCB Terminal RH side

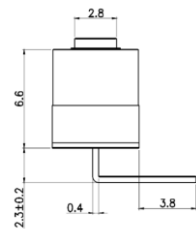
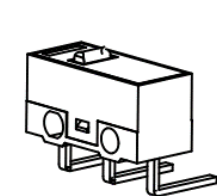

PCB Terminal LH side

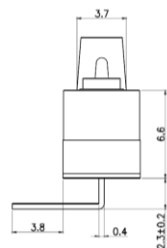
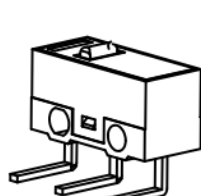

Drilling pattern

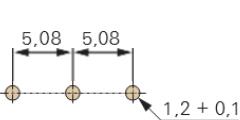

## Auxiliary actuator

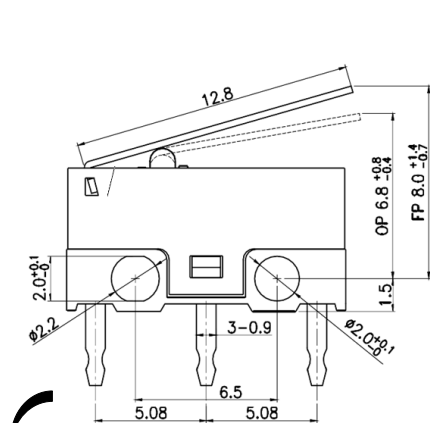

Different lever lengths available

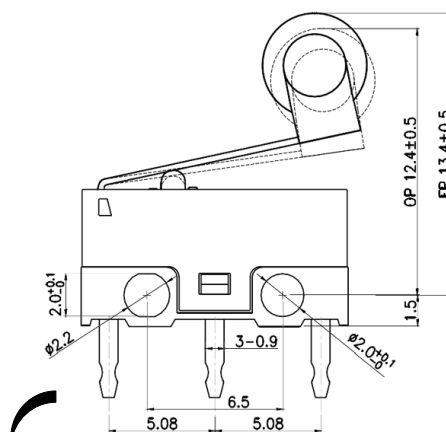

Lever roller (part nr. code "RD")

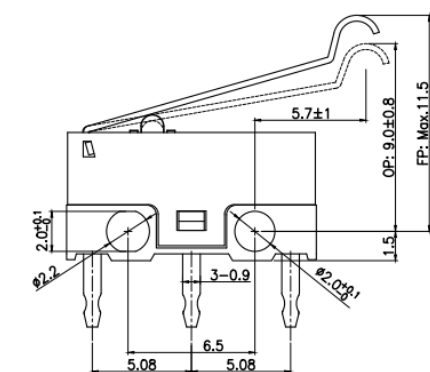

Different lever lengths with simulated roller available

