

| REV. NO. | | REV. DATE | | REV. DESCRIPTION | |
|----------|----|-----------|-----|------------------|------------------------------------|
| GP | 00 | | | | |
| 9 | | 01APR2005 | NLR | NLR | UPDATE LED PLATING DIMS, ADD MATTE |
| A | | 11APR2006 | TY | TX | ECO-06-003967 |
| B | | 30AUG2006 | TY | TX | PER ECO-06-020736 |

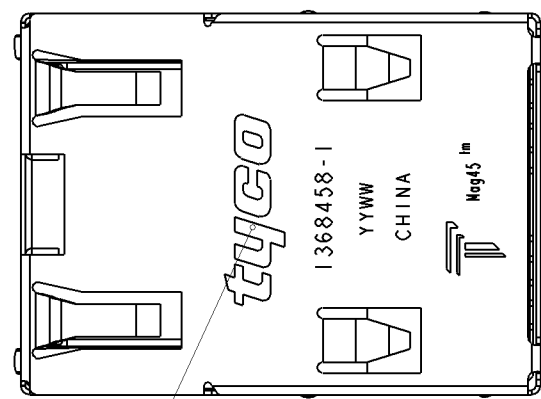
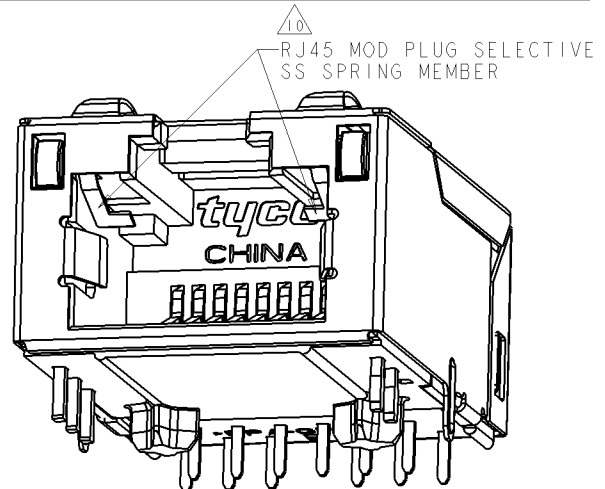

- MATERIALS:**
- HOUSING: HIGH TEMPERATURE NYLON, BLACK, UL 94V-0
 - SHIELD: 0.20mm THICK, BRASS PREPLATED WITH 1.27µm MIN SEMI-BRIGHT NICKEL; POST-DIPPED WITH 2µm MIN SAC 305 ALLOY LEAD FREE SOLDER (TIN PRIMARY, 3% SILVER, 0.5% COPPER)
 - CONTACT TAILS: 0.25mm THICK, PHOSPHOR BRONZE, 1.27 µm MIN OVERALL NICKEL UNDERPLATE, 3µm MIN TIN PLATE
 - MOD JACK CONTACTS: 0.25mm THICK, PHOSPHOR BRONZE, 1.27 µm MIN OVERALL NICKEL UNDERPLATE, WITH 0.76µm MIN LOCALIZED GOLD PLATE AT PLUG INTERFACE
 - LIGHT EMITTING DIODE (LED): DIFFUSED EPOXY LENS, 0.5mm X 0.5mm CARBON STEEL WIREFRAME LEADS PREPLATED WITH 2.03µm MIN. SILVER PLATE OVER 1.02µm MIN. NICKEL OVER 1.02µm MIN. COPPER UNDERPLATE; LEADS POST-PLATED WITH 3.05µm MIN. MATTE TIN.
 - LIGHT PIPE: POLYCARBONATE

RJ45 JACK CAVITY CONFORMS TO FCC RULES AND REGULATIONS PART 68, SUB-PART F.

- MAGNETICS:**
- IMPEDANCE: 100 OHMS
 - TRANSMIT OPEN CIRCUIT INDUCTANCE (OCL): 350µH (MIN) @100KHZ, 0.1 VRMS WITH 8 mA DC BIAS.
 - TURNS RATIO (CHIP:CABLE): TX 1:1, RX: 1:1
- PERFORMANCE:**

| FREQUENCY | INSERTION LOSS (dB MAX) | RETURN LOSS (dB MIN) CIRCUIT IMPEDANCE = 100 OHMS ±15% | COMMON MODE REJECTION RATIO (dB MIN) | CROSSTALK (dB MIN) |
|-----------------|-------------------------|--|--------------------------------------|--------------------|
| 0.5MHz-30 MHz | 1.3 | 18 | 33 | 43 |
| 30.1 MHz-60 MHz | | 18-20 log(f/30) | | |
| 60.1 MHz-80 MHz | | 12 | | 38 |

ALL MAGNETIC ELECTRICAL CHARACTERISTICS RATED @ 25°C

DIELECTRIC (ISOLATION VOLTAGE):

- 2250 VDC (1 mA CUTOFF CURRENT) FOR 60 SECONDS DURATION BETWEEN CABLE CONTACTS AND PCB CONTACTS (INCLUDING SHIELD).
- 1500 VRMS (10mA CUTOFF CURRENT) FOR 60 SECONDS DURATION BETWEEN CABLE CONTACTS AND PCB CONTACTS (INCLUDING SHIELD).
- ALL BRIDGED ON EITHER SIDE OF MAGNETICS PACKAGE FOR RJ-45 CONTACTS.

OPERATING TEMPERATURE: FROM 0° TO +70°C.

- THE MAGNETICS ARE ASYMMETRICAL, AND THEREFORE ARE NOT AUTO-MDI/MDIX CAPABLE.
- LED COMPLIANT WITH IEC60825-1 SAFETY OF LASER PRODUCTS. WHEN OPERATED UP TO 20mA.
- LED PEAK WAVELENGTH: GREEN = 565±5nm, YELLOW = 591±5nm, ORANGE = 607±5nm
- LED 2 WILL EMULATE "YELLOW" LIGHT WHEN BOTH GREEN AND ORANGE DIODES ARE DRIVEN AT CONSTANT CURRENT (20mA RECOMMENDED) TO INDICATE THE THIRD COLOR STATES.
- ALL DIMENSIONS NOMINAL UNLESS OTHERWISE NOTED.

9. 1368458-1 SHOWN UNLESS OTHERWISE NOTED.

RJ45 MOD PLUG SELECTIVE - THIS CONNECTOR UTILIZES STAINLESS STEEL SPRING MEMBER WHICH PREVENTS THE INSERTION OF A RJ11 (6 POSITION) PLUG INTO THE JACK PORT, WHILE ALLOWING A RJ45 (8 POSITION) PLUG TO MATE FREELY.

WARNING: THIS FEATURE WAS DEVELOPED FOR TYPICAL PLUG INSERTION FORCES. EXCESSIVE INSERTION FORCE MAY OVERCOME THE SELECTIVE FEATURES AND DAMAGE THE CONNECTOR.

TYCO & TRANSPower LOGO, PART NUMBER, DATE CODE, PLACE OF ORIGIN, AGENCY LOGO TO BE MARKED IN APPROXIMATE LOCATION AS SHOWN.

APPLIES ONLY TO 1368458-2.

| | |
|---------------|-----------|
| TOP AND SIDES | 1368458-2 |
| TOP ONLY | 1368458-1 |
| GROUND TABS | PART NO. |

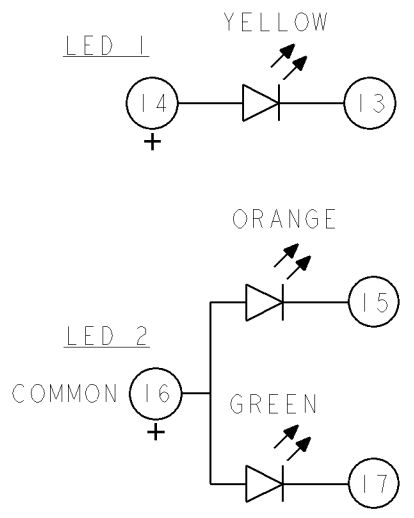
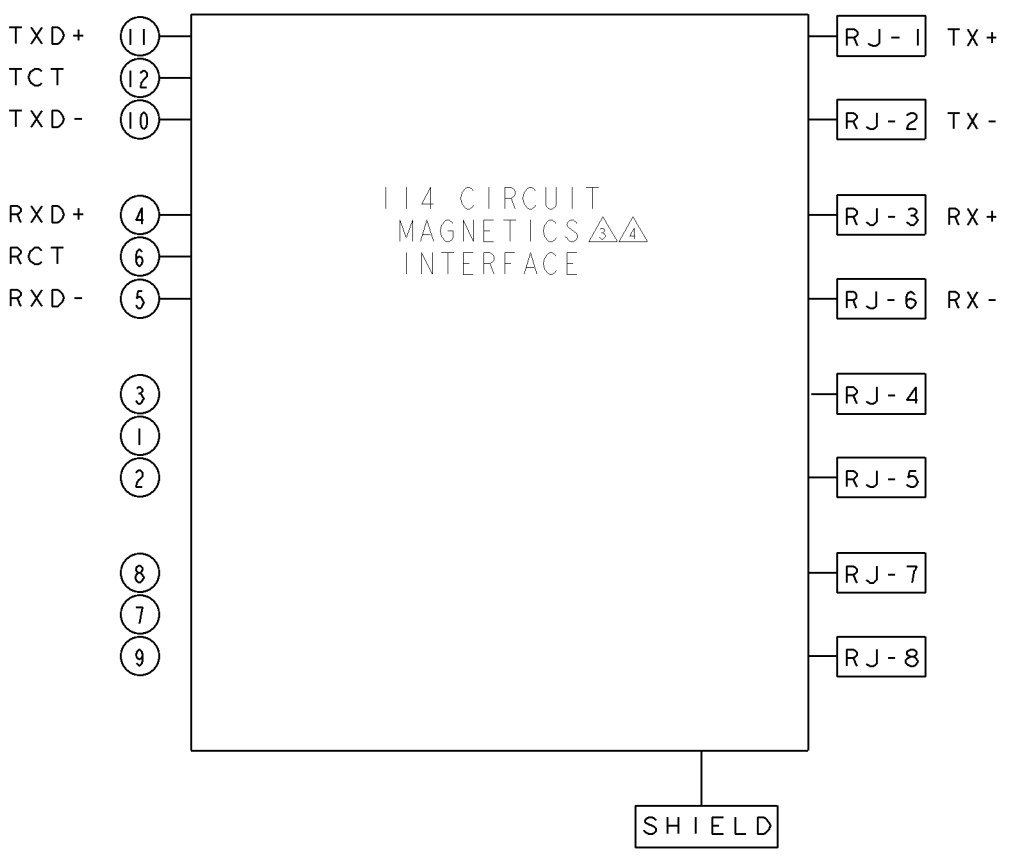
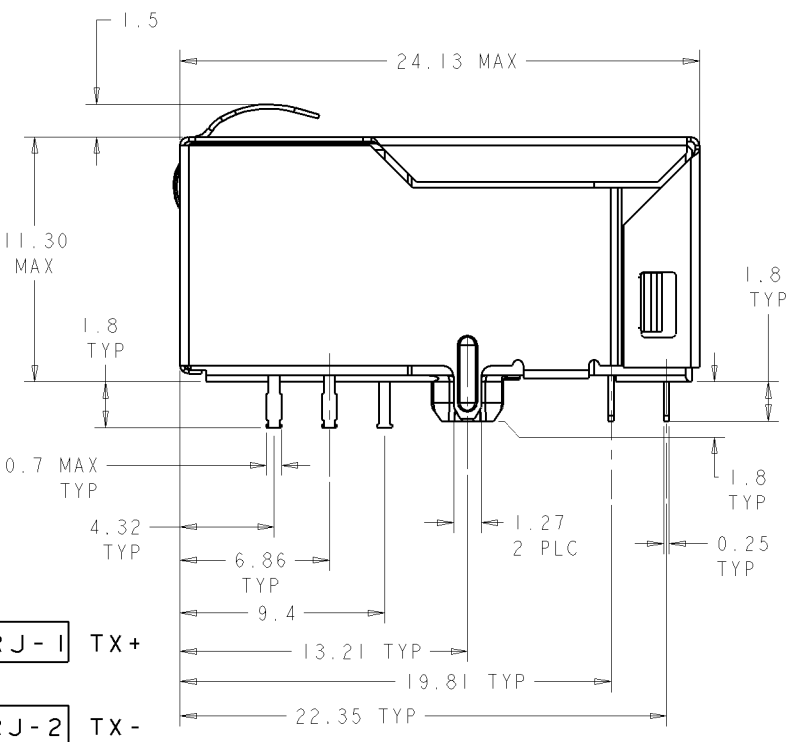
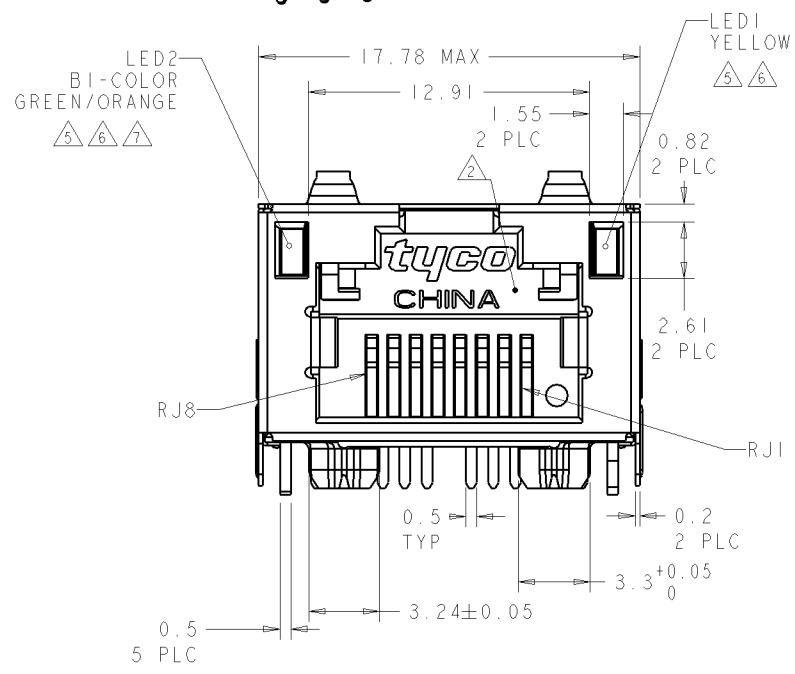

| | | | | | | | | | | | |
|------------------|---|--|-------|--------------------------|-------|------------------------------|---|----------------------------|---|---|---|
| DIMENSIONS: mm | | TOLERANCES UNLESS OTHERWISE SPECIFIED: | | DWG: VJC SLACK 16SEP2003 | | CHK: RANDY SIMMONS 16SEP2003 | | APPRO: N. REISER 08FEB2004 | | NAME: 1X1 MAG45(TM), MODULAR JACK, 114 SERIES 10/100 CIRCUIT SHIELDED, LEDS, SELECTIVE CAPABILITY | |
| 0 PLC | ± | 1 PLC | ±0.25 | 2 PLC | ±0.25 | 3 PLC | ± | 4 PLC | ± | ANGLE | ± |
| MATERIAL: A | | FINISH: A | | WEIGHT: - | | SIZE: A | | CASE CODE: 00779 | | DRAWING NO: 1368458 | |
| CUSTOMER DRAWING | | SCALE: NTS | | SHEET: 1 | | OF: 2 | | REV: B | | RESTRICTED TO: - | |

| REV | DATE | DESCRIPTION | DATE | DWN | APPV |
|-----|------|-------------|------|-----|------|
| 1 | | SEE SHEET 1 | | | |

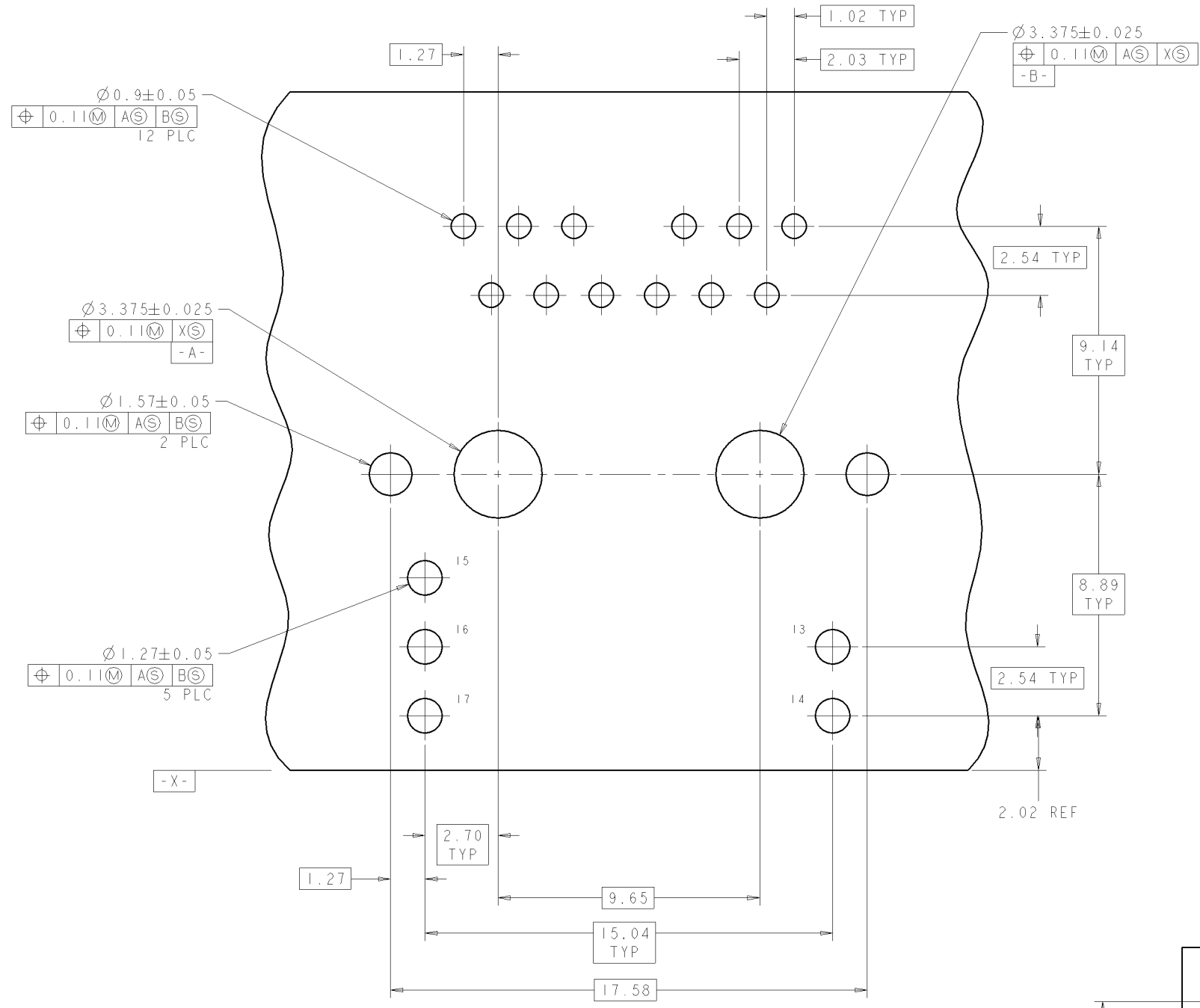

SUGGESTED PCB LAYOUT
(COMPONENT SIDE)

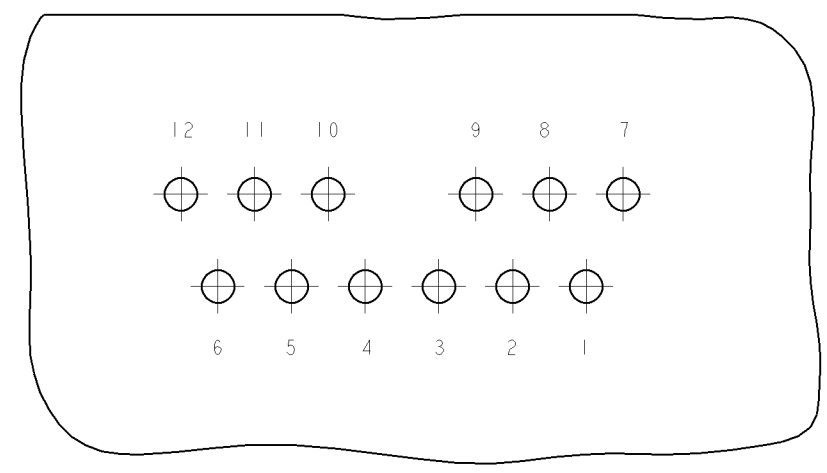

PIN DESIGNATIONS

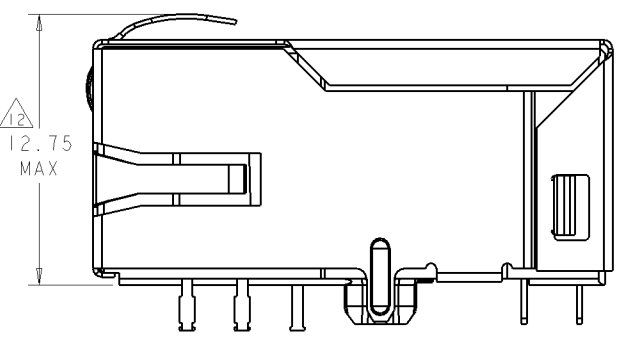
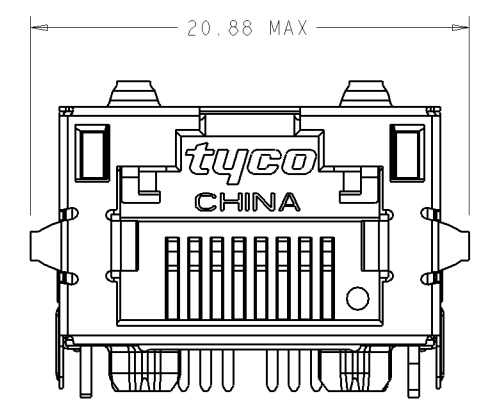

1368458-2

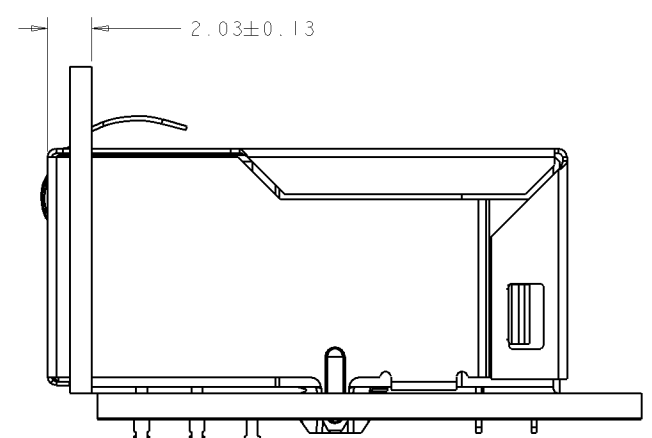
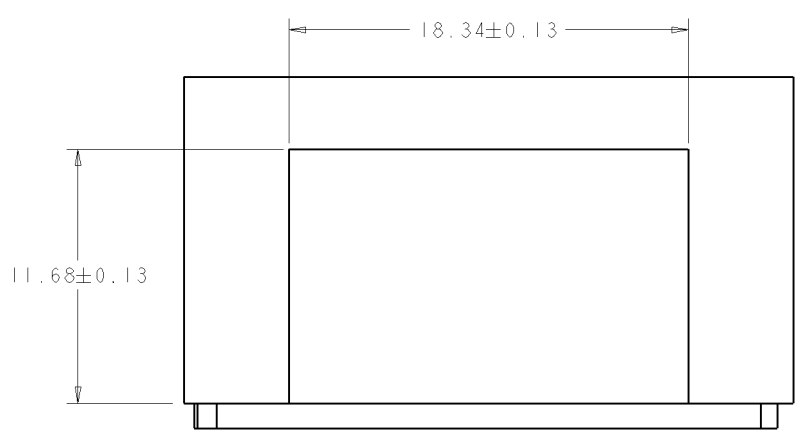

SUGGESTED PANEL OPENING

| | | | | | | | |
|--|--|---|--|---|--|---|--|
| DIMENSIONS: mm 0 PLC ±0.25 1 PLC ±0.25 2 PLC ±0.25 3 PLC ±0.25 4 PLC ±0.25 ANGLE ±0.5 FINISH : | | TOLERANCES UNLESS OTHERWISE SPECIFIED: ±0.13 ±0.13 ±0.13 ±0.13 ±0.13 ±0.13 ±0.13 | | DWN: VIC SLACK 16SEP2003 CHK: RANDY SIMMONS 16SEP2003 APD: W. REISER 8FEB2004 PRODUCT SPEC APPLICATION SPEC WEIGHT CUSTOMER DRAWING | | Tyco Electronics Harrisburg, PA 17105-3608 NAME: 1X1 MAG45(TM), MODULAR JACK, 114 SERIES 10/100 CIRCUIT SHIELDED, LEDS, SELECTIVE CAPABILITY SIZE: A CASE CODE: 00779 DRAWING NO: 1368458 RESTRICTED TO: - SCALE: NTS SHEET: 2 OF 2 REV: B | |
|--|--|---|--|---|--|---|--|