ALPHA WIRE COMPANY
CUSTOMER PRODUCT SPECIFICATION

Part Number: SW30-SW35
Page 1 of 3 Pages

Issue: 5
Issue Date: 5/20/2008
Effective Date: 6/20/2008

-NOTE: ALL DIMENSIONS ARE IN INCHES UNLESS OTHERWISE SPECIFIED-

CONSTRUCTION

Product	Spiral Wrap Tubing
Material	PTFE

PHYSICAL PROPERTIES

Appearance	Homogeneous Surface, Free From Pinholes, Defects, Cracks, Seams, Inclusions and Chemical Bloom
Dimensions	See Figure 1 and Table 1
Colors	Natural, Black
Temperature Rating, Continuous	-268°C to + 260°C
Tensile Strength	3000 psi

ELECTRICAL PROPERTIES

Abrasion Resistance (Taber)	7
-----------------------------	---

FLAMMABILITY

Flammability	UL VW-1
--------------	---------

FINISHED PRODUCT REQUIREMENTS

Product Print Legend	None
Standard Package	See Table 2
Length Tolerance	-0 / +1%
Multiple Length Spools	Maximum of 3 lengths per reel, 10 ft. minimum length of an individual piece
Governing Documents	MIL-T-47287, Type 1 AMS3653, AMS3654, AMS3655 AS1294, ASTM-D-3295-01, group 4 ASTM-D-1710-22 A-A-59602, Type 3

**ALPHA WIRE COMPANY
CUSTOMER PRODUCT SPECIFICATION**

Part Number: SW30-SW35
Page 2 of 3 Pages

Issue: 5
Issue Date: 5/20/2008
Effective Date: 6/20/2008

INCOMING INSPECTION CRITERIA

Physical Construction
Packaging & Labeling
Appearance

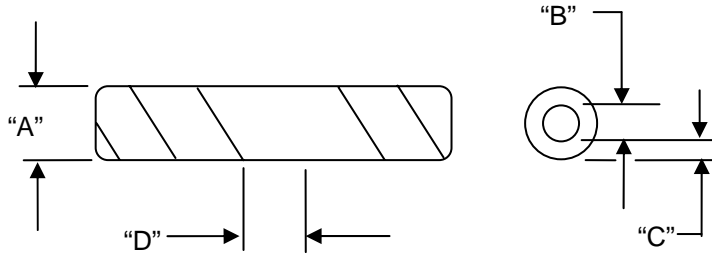

FIGURE 1

TABLE 1: DIMENSIONAL INFORMATION				
Alpha P/N	Outside Dia "A"	Nominal ID "B"	Wall Thickness "C"	Right Hand Pitch "D"
SW-30	0.125 +/-0.010	0.065	0.030 +/-0.010	0.187 +/- 1/16
SW-31	0.250 +/-0.010	0.190	0.030 +/-0.010	0.375 +/- 1/8
SW-32	0.375 +/-0.010	0.315	0.030 +/-0.010	0.438 +/- 1/8
SW-33	0.500 +/-0.015	0.440	0.030 +/-0.010	0.500 +/- 1/8
SW-34	0.750 +/-0.020	0.686	0.032 +/-0.010	0.750 +/- 1/4
SW-35	1.000 +/-0.020	0.920	0.040 +/-0.010	1.000 +/- 1/4

Alpha P/N	Standard package	
	Natural	Black
SW-30	25, 100 ft spools	100 ft spools
SW-31	25, 100 ft spools	100 ft spools
SW-32	25, 100 ft spools	100 ft spools
SW-33	25, 100 ft spools	100 ft spools
SW-34	25, 100 ft spools	100 ft spools
SW-35	25, 100 ft spools	100 ft spools

Note: All sizes may contain a maximum of 3 lengths
10 ft. minimum length of an individual piece

**ALPHA WIRE COMPANY
CUSTOMER PRODUCT SPECIFICATION**

**Part Number: SW30-SW35
Page 3 of 3 Pages**

**Issue: 5
Issue Date: 5/20/2008
Effective Date: 6/20/2008**

Table 2