

Termination Cover
(1 Places)

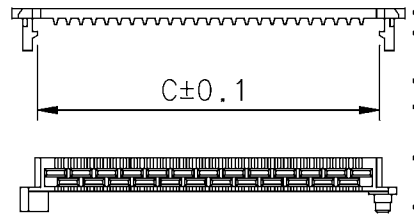

Wire Holder
(2 Places)

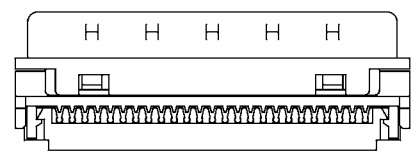
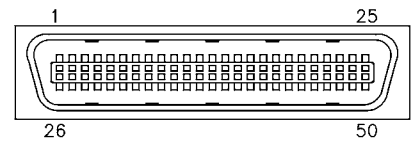
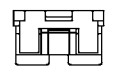
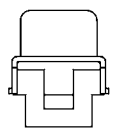
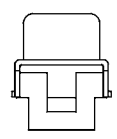
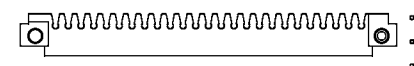

M Type
o (without hood,)

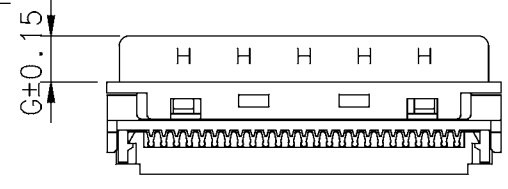
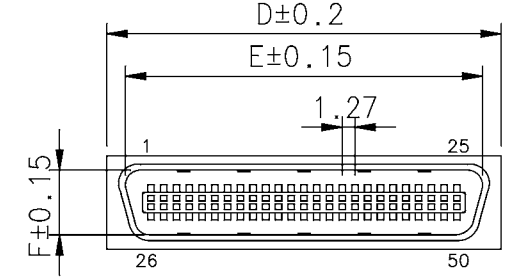
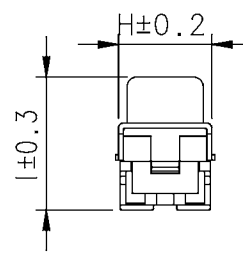

A Type
o (with hood,)

NO OF CONTACTS	A	B	C	D	E	F	G	H	I
14	14.38	16.38	11.18	16.45	12.80	6.46	4.60	8.50	13.10
20	18.10	20.10	14.90	20.00	16.60	6.40	4.60	9.30	13.10
26	22.00	24.00	18.70	24.00	20.40	6.46	4.60	9.30	13.10
36	28.35	30.35	25.21	30.40	26.70	6.46	4.60	8.50	13.10
50	37.30	39.30	34.10	39.30	35.60	6.46	4.60	9.30	13.70
68	48.73	50.70	45.50	50.60	46.95	6.46	4.60	9.30	13.60

FEATURES:

- Half pitch 1.27mm(.050") series
- Ribbon male connector I.D.C type for cable
- Assembly hood with plastic steel inner shell or Die-Cast metal hood
- Without hood with or without spring latch
- Fully EMI/RFI shielded

MATERIALS:

- Housing And Cover: Plastic thermoplastic P.B.T UL94V-0 black
- Contacts: Phosphor bronze gold selective plated
- Shell: Steel nickel plated over copper

ELECTRICAL:

- Current Rating: 1 Amp
- Insulation Resistance: >500M /MIn
- Withstanding Voltage: AC 500V/r.m.s for 1 Minute
- Contact Resistance: 35m WMax
- Temperature Range: -55°C ~ +105°C



SERIES

Flat cable IDC termination

NUMBER OF CONTACT:
14, 20, 26, 36, 50, 68

CONTACT TYPES:
M = Male

CONTACT PLATING:

- 0 = selective flash gold
- 1 = selective 15u" gold
- 2 = selective 30u" gold

Hood Option:

- M : without hood
- A : with hood

WIRE HOLDER:

- 6= 0.62mm
- 7= 0.75mm
- 9= 0.9mm

MD5 ID 26 M 0 x 7

Amphenol Socapex Usine de Dole		TOL. GEN.							
		VOLUME PIECE							
		SURFACE PIECE							
		PROTECTION							
		TRAITEMENT							
		MATIERE							
ECH.	ENS.	DOSSIER		CLIENT	CREATION PLAN	ATO	30/05/2005	ATO	A
N SERIE				MODIFICATIONS	EXEC.	DATE	Approb	IND.	
DATE DU TIRAGE	DESIGNATION	MINI D SERIES		N INTERNE	MD5 ID xx M				