

**nominal voltage:** 1,2V  
**max. charge voltage:** 1,5V

**capacity**  
 nominal : 2400mAh  
 >2020mAh  
 minimum: 2150mAh

**max. continuous discharge current:** 4600mA

**charge**  
 standard charge: charge current 240mA, charge time 16hrs at 20°C  
 quick charge: 850mA, 3,25hrs  
 fast charge: 2400mA, 1,1hrs

recommended charge termination control parameters:  
 -dV: 5...10mV  
 dT/dt: 0,8...1°C per min  
 TCO: 40...50°C

trickle charge current: 20...100mA (recommended)

continuous overcharge: ≤100mA (less than 1 year) no conspicuous deformation, no leakage

**internal resistance:** approx. 25mOhms at 1000Hz, battery fully charged

**life expectancy:** >500 cycles IEC standard

**ambient temperature range:** 0...45°C, 0...40°C, 0...50°C, -20...50°C, -20...40°C, -20...30°C  
 standard charge, fast charge, discharge, storage less than 30 days, storage less than 3 months, storage less than 1 year

conditions

at standard charge (0,1C / 20°C)

discharge at 0,2C  
 discharge at 1C  
 discharge at 0,2C  
 1,0V end discharge voltage  
 ambient temperature 20°C

ambient temperature 20...50°C

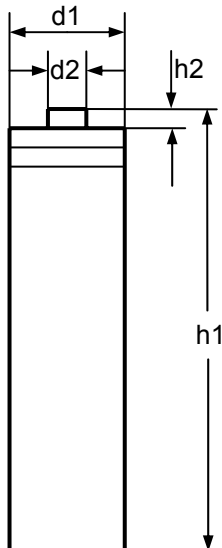
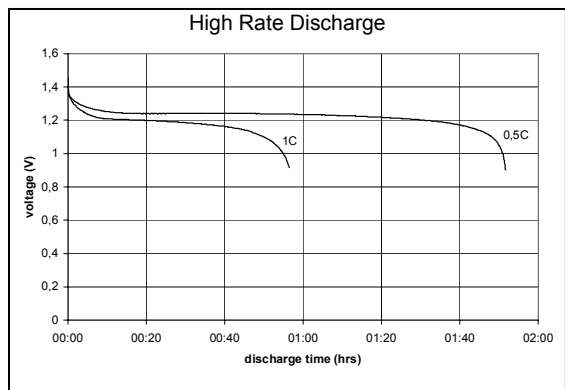
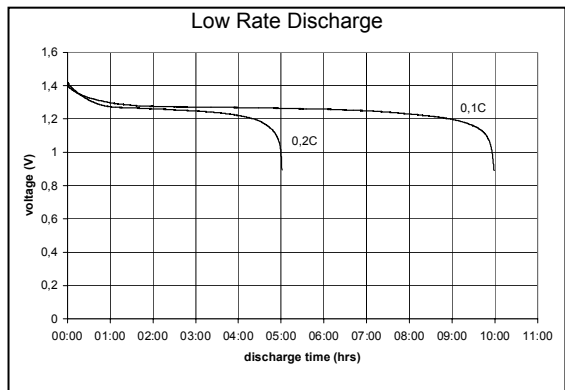
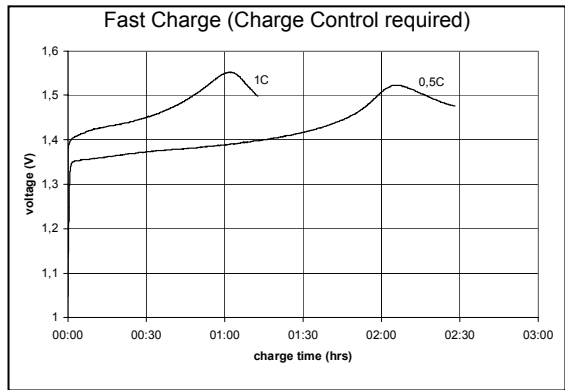
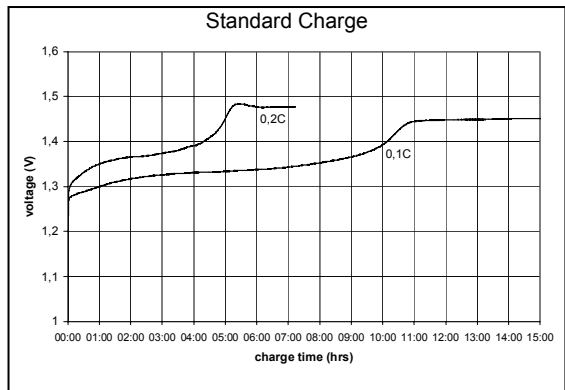

**mechanical specifications**

cell dimensions (with sleeve)  
 diameter d1: 14,35-0,4mm  
 diameter d2: 5,5-0,5mm  
 height h1: 50,4-0,5mm  
 height h2: 1,8+/-0,3mm  
 weight: approx. 30g

	specifications for model/type:	AA – NiMH 2400mAh
	Ansmann drawing number / part number:	5030531
	drawn by / date:	Gramlich / 21.10.2004