

**nominal voltage:** 1,2V  
**max. charge voltage:** 1,5V

**capacity**  
 nominal : 2500mAh  
 minimum: 2500mAh  
 2250mAh

**max. continuous discharge current:** 2500mA

**charge**  
 standard charge: charge current 250mA  
 rapid charge: charge current 1250mA

recommended charge termination control parameters:  
 -dV: 0....10mV  
 dT/dt: 0,8....1°C per min  
 TCO: 45....50°C

trickle charge current: 25....125mA (recommended)

continuous overcharge: ≤250mA (less than 1 year)

**internal resistance:** <30mOhms

**life expectancy:** >500 cycles

**ambient temperature range:** 0....45°C  
 10....40°C  
 -20....60°C  
 -20....35°C

conditions  
 at standard charge (0,1C / 20°C)  
 discharge at 0,2C  
 discharge at 0,2C  
 discharge at 0,5C  
 1,0V end discharge voltage  
 ambient temperature 20°C  
 ambient temperature -20....60°C  
 charge time 16hrs at 20°C  
 2,2hrs  
 at 1000Hz, battery fully charged  
 IEC standard  
 standard charge  
 rapid charge  
 discharge  
 storage less than 6 months

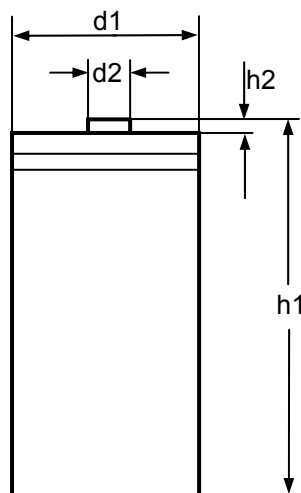
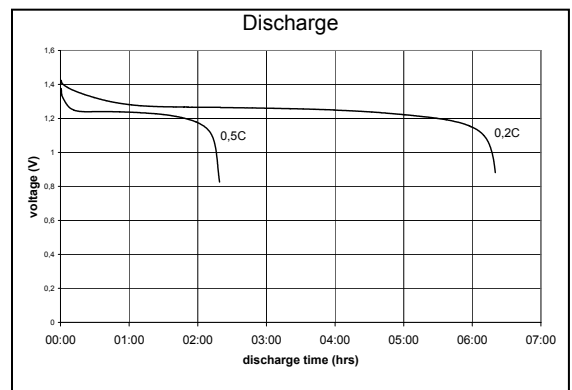
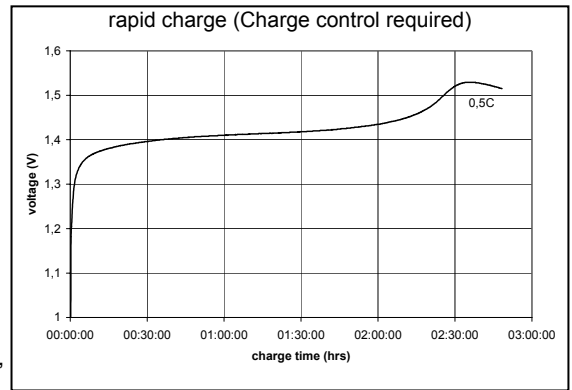
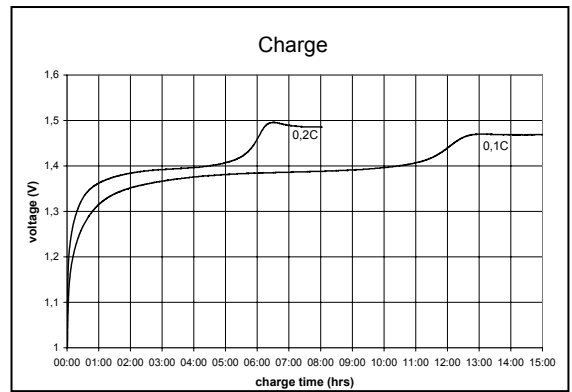

**mechanical specifications**  
 cell dimensions (with sleeve)  
 diameter d1: 25,8 – 1,0mm  
 diameter d2: 7,5 – 2,5mm  
 height h1: 50,0 -1,0mm  
 height h2: min. 1,5 mm  
 weight: approx. 68g

	specifications for model/type:	C – NiMH 2500mAh
	Ansmann drawing number / part number:	5030911
	drawn by / date:	Brandt / 19.01.2006